

Excavate & Remove Exist. Conc. Curb & Gutter. Replace w/ Reinf. Conc. Pavt.

CAUTION! Paving Contractor is to Be Aware That Storm Drainage Pipe May Be Within The Subgrade in This Area.

PAVING GENERAL NOTES:

1. Unless otherwise noted, all materials and construction shall conform to applicable specifications of the Town of Addison with amendments - The North Central Texas Council of Governments "Standard Specifications for Public Works Construction", Parts 1 and 4, latest edition.
2. All curb dimensions are to back of curb.
3. Pavement reinforcing will be grade 60.
4. All on-site concrete pavement will be 6" thick and have a minimum strength of 3000 PSI at 28 days.
5. Construct a barrier-free curb and ramp at all intersections. See Sheet P-2 for details.
6. The Contractor will be responsible for field verifying the location of all existing utilities prior to his operations.
7. Hydrated lime will be spotted as a slurry.
8. No flyash is allowed.

PAVING GENERAL NOTES:

- A. Construction Joints: Transverse construction joints shall be sawed joints perpendicular to the centerline and surface of the pavement. Where sawed joints are used, contraction joints at 20-foot intervals shall be formed as soon as paving can be accomplished without damage to the pavement.
- B. Expansion Joints: Transverse expansion joints shall be formed perpendicular to the centerline and surface of the pavement and shall be constructed as shown on the plans.

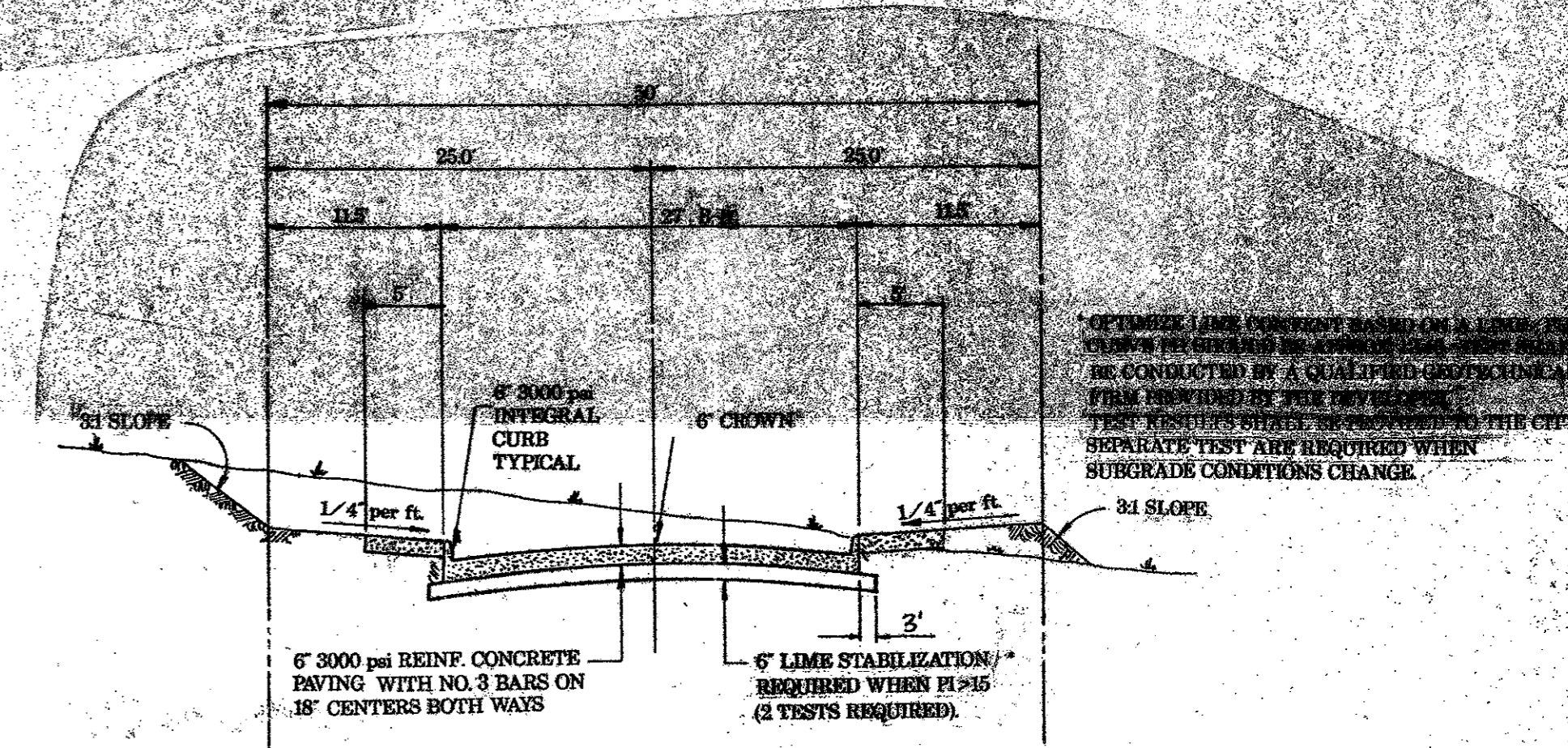
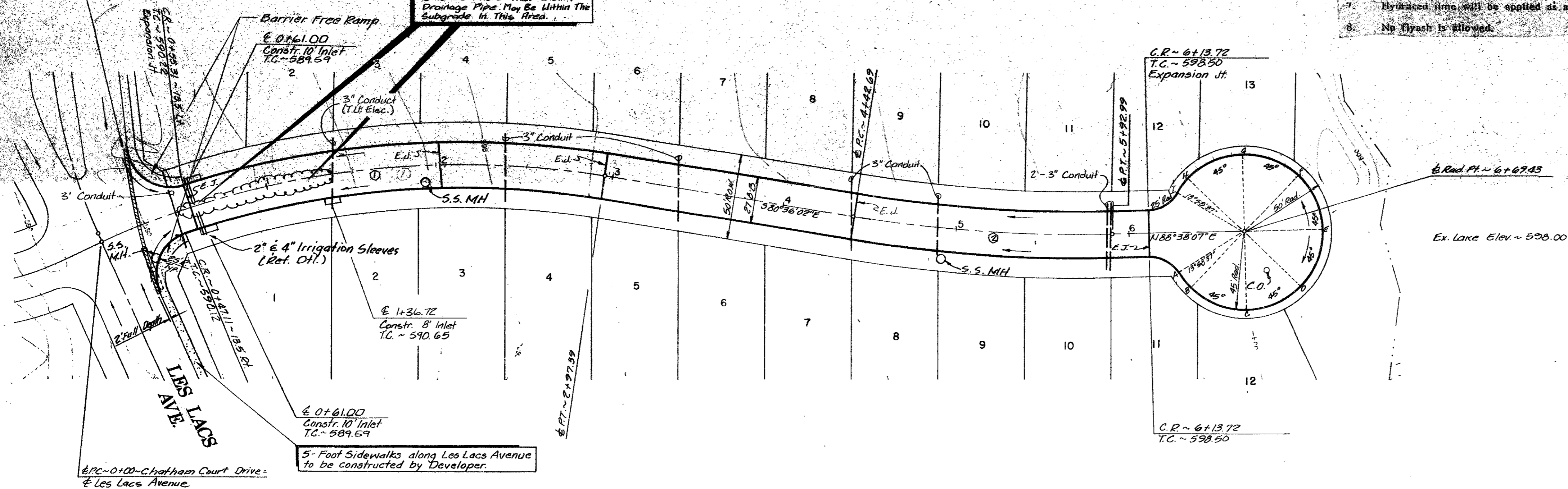

TYPICAL SECTION

BENCHMARKS

- Cut in the northwest corner of inlet southside of Proton Drive at west of Les Lacs Drive. ELEV. 607.35
- Cut on the north top of curb of Les Lacs Drive at Southeast Addition Corner. ELEV. 593.38
- Center of second inlet west of the East Addition Line and on the north side of Les Lacs. ELEV. 586.17
- In center of the third inlet west of the East Addition Line on the north side of Les Lacs Drive. ELEV. 587.61
- In center of the first inlet south of Beltway Drive and on the east side of Les Lacs Drive. ELEV. 589.88

CURVE DATA

#	A	R	T	L
①	34°04'43"	500.00'	193.24'	291.39'
②	10°45'51"	800.00'	75.39'	150.30'

CHATHAM COURT DRIVE

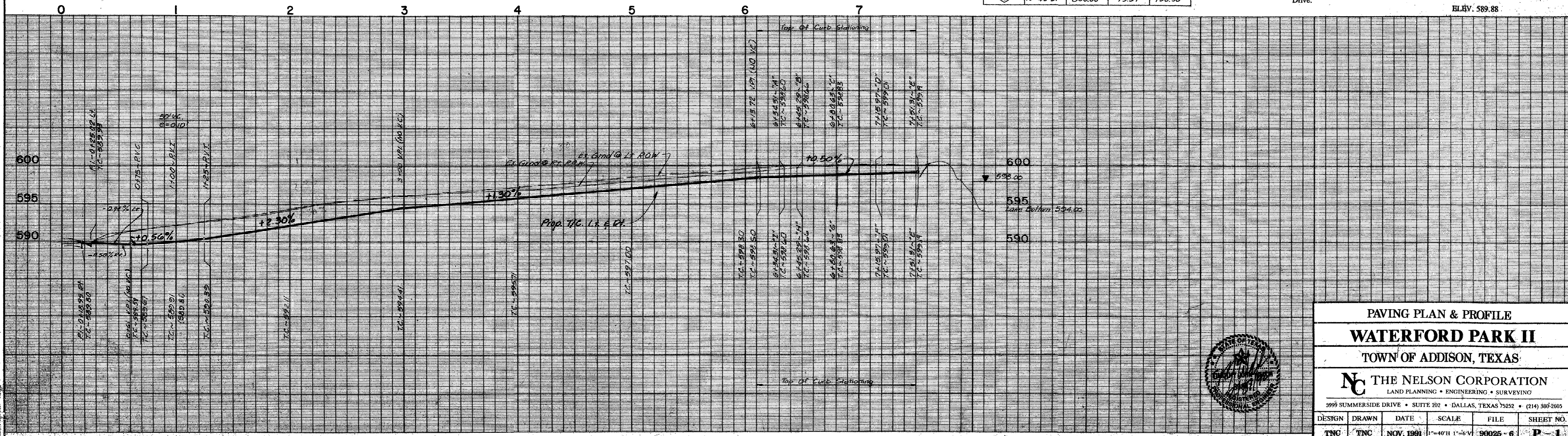

PAVING PLAN & PROFILE
WATERFORD PARK II
 TOWN OF ADDISON, TEXAS

THE NELSON CORPORATION
 LAND PLANNING • ENGINEERING • SURVEYING

9999 SUMMERSIDE DRIVE • SUITE 202 • DALLAS, TEXAS 75252 • (214) 380-2605

DESIGN	DRAWN	DATE	SCALE	FILE	SHEET NO.
TNC	TNC	NOV. 1991	1"=40' H 1"=50' V	90025-6	P-1