



DESCRIPTION CODES:
.. = AREA UNDER CONSTRUCTION
BC = BUILDING CORNER
BK = BREAK
BOT = BOTTOM OF THRESHOLD
CD = SANITARY CLEAMOUT
DP = DRAINAGE PIPE
EP = EDGE OF PAVEMENT
EPI = EDGE OF PAVEMENT INTERSECTION
FF = FINISH FLOOR
FH = FIRE HYDRANT
FL = FLOW LINE
FRL = FIRE LANE
GP = GUARD POST
PS = PARKING SPACE
PSNP = PARKING SPACE/NO PARKING
RPNT = RED PAINT/ELECTRIC
WM = WATER METER
WV = WATER VALVE
SBM = SITE BENCH MARK
SCOL = STUCCO COLUMN
YPNT = YELLOW PAINT/GAS

NOTES:

1. THIS PLAN HAS BEEN PREPARED FOR THE EXCLUSIVE USE OF SODESIGN, INC.
2. SERVICE DETAILS SHOULD BE CONFIRMED WITH THE RELEVANT SERVICE AUTHORITY DURING DESIGN & PRIOR TO ANY CONSTRUCTION.
3. GROUND SURFACE IS UNEVEN AND UNULATING AND THE CONTOURS ARE INDICATIVE ONLY.
4. CONTOUR INTERVAL : MAJOR 5.0 MINOR 1.0
5. AT THE REQUEST OF THE CLIENT, NO TREES HAVE BEEN SURVEYED.
6. AT THE REQUEST OF THE CLIENT, NO BOUNDARIES HAVE BEEN SURVEYED. THIS SURVEY WAS PERFORMED WITHOUT THE BENEFIT OF AN ABSTRACTOR, THEREFORE, NO SEARCH OF RECORD EASEMENTS WAS PERFORMED ON THE SUBJECT PROPERTY.
7. BENCH MARK NOTE:
-ALL ELEVATIONS ARE RELATIVE TO TOWN OF ADDISON MONUMENT #13.
-LOCATION OF MONUMENT IS 630' WEST FROM THE INTERSECTION OF ADDISON RD. AND WESTGROVE DR. THEN 15.7' SOUTH FROM BACK OF CURB, 2' FROM STREET SIGN AND 8' SOUTH TO BACK OF CURB OF WESTGROVE RD.
-ELEVATION= 642.08
-MONUMENT: 2" BRASS DISK STAMPED "TXDOT COA-13 GPS"

MATCH LINE

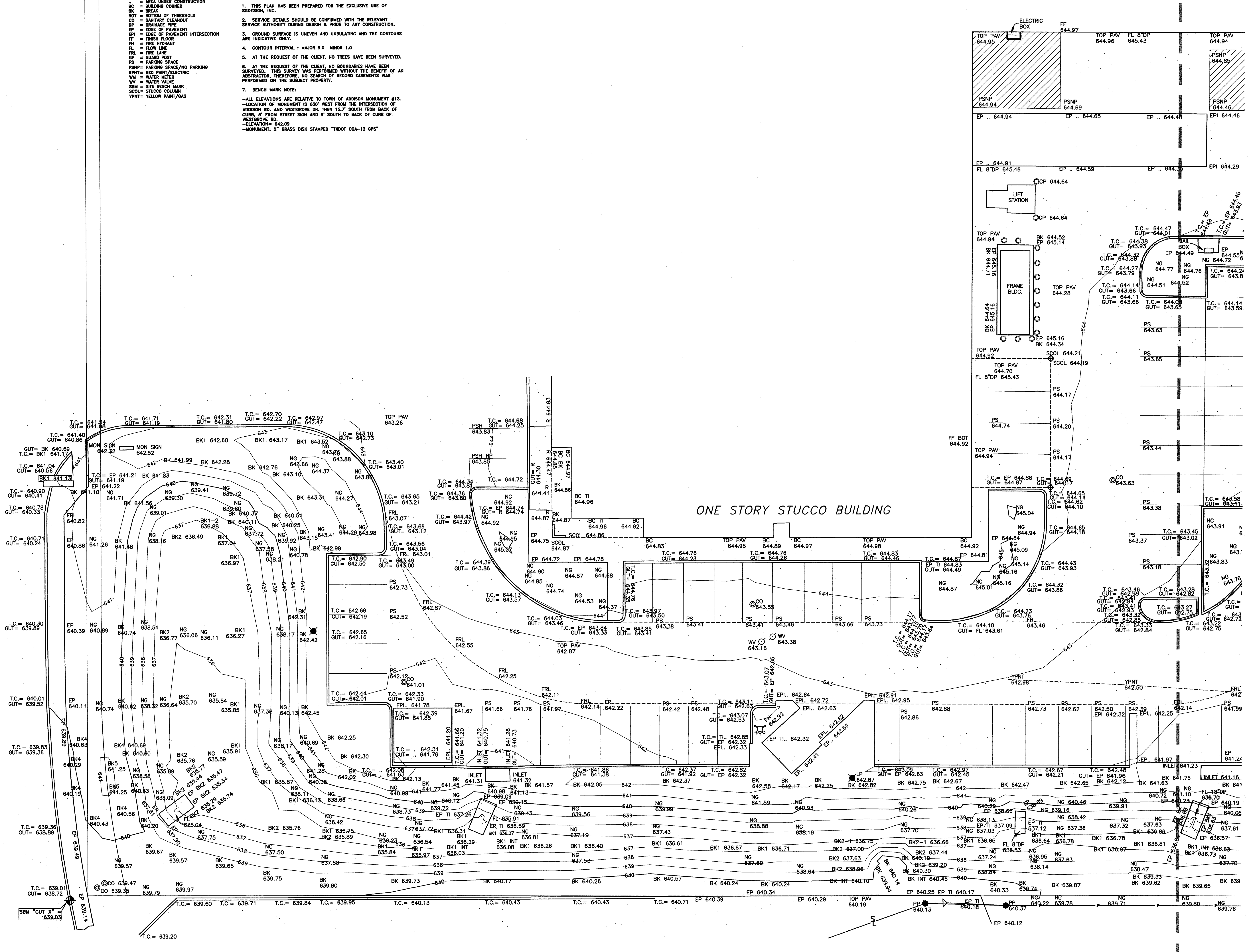

ONE STORY STUCCO BUILDING

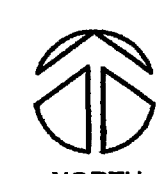

MATCH LINE