

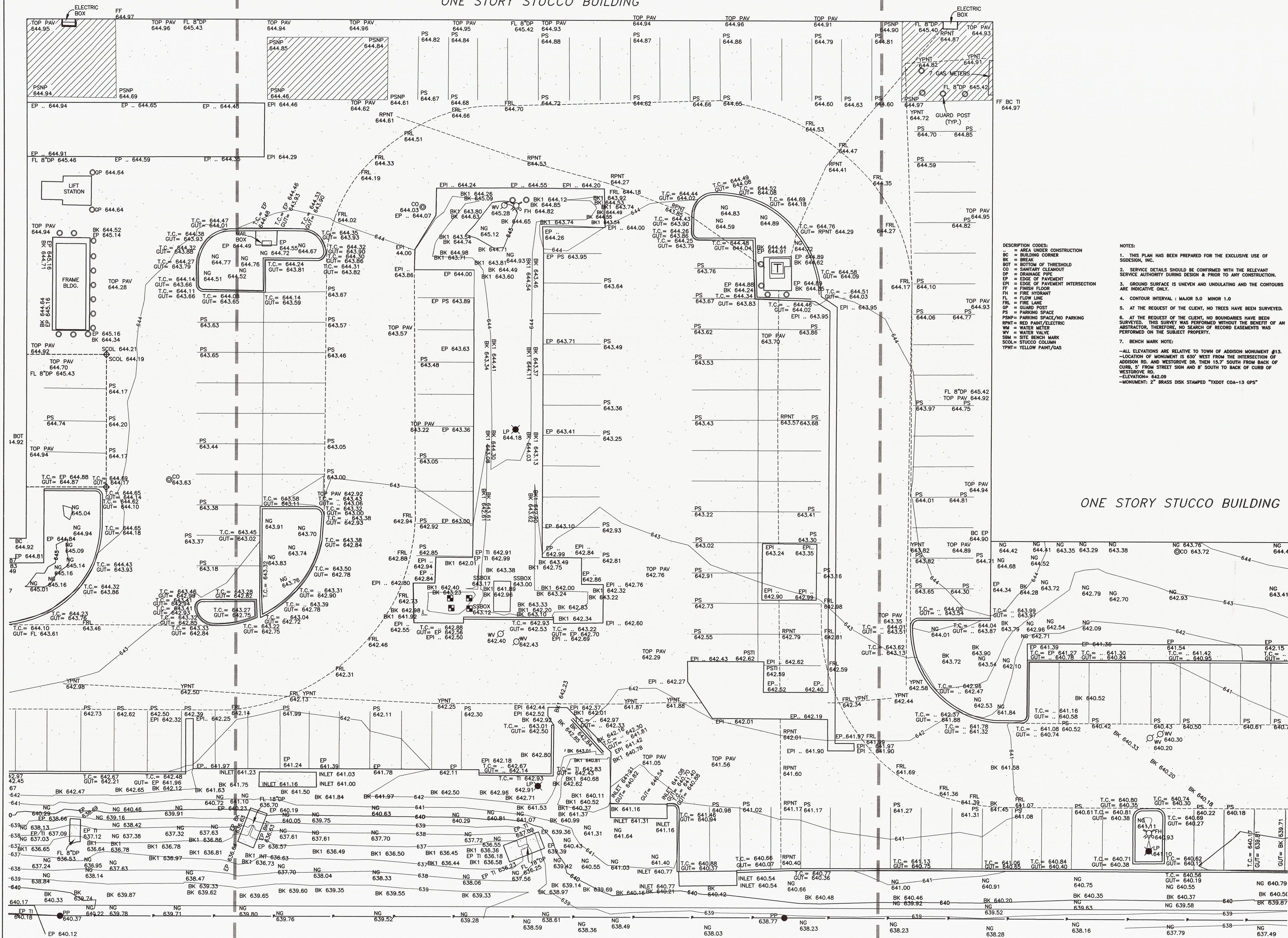

MATCH LINE

MATCH LINE

ONE STORY STUCCO BUILDING



DESCRIPTION CODES:
 .. = AREA UNDER CONSTRUCTION
 BC = BUILDING CORNER
 BK = BREAK
 BOT = BOTTOM OF THRESHOLD
 CO = SANITARY CLEANOUT
 DP = DRAINAGE PIPE
 EP = EDGE OF PAVEMENT
 EPI = EDGE OF PAVEMENT INTERSECTION
 FF = FINISH FLOOR
 FH = FIRE HYDRANT
 FL = FLOW LINE
 GP = GUARD POST
 NG = PARKING SPACE
 PSNP = PARKING SPACE/NO PARKING
 PS = PARKING SPACE
 RPNT = RED PAINT/ELECTRIC
 WM = WATER METER
 WV = WATER VALVE
 SBM = SITE BENCHMARK
 SCOL = STUCCO COLUMN
 YPNT = YELLOW PAINT/GAS

NOTES:
 1. THIS PLAN HAS BEEN PREPARED FOR THE EXCLUSIVE USE OF SODDISON, INC.
 2. SERVICE DETAILS SHOULD BE CONFIRMED WITH THE RELEVANT SERVICE AUTHORITY DURING DESIGN & PRIOR TO ANY CONSTRUCTION.
 3. GROUND SURFACE IS UNEVEN AND UNUNDULATING AND THE CONTOURS ARE INDICATIVE ONLY.
 4. CONTOUR INTERVAL: MAJOR 5.0 MINOR 1.0
 5. AT THE REQUEST OF THE CLIENT, NO TREES HAVE BEEN SURVEYED.
 6. AT THE REQUEST OF THE CLIENT, NO BOUNDARIES HAVE BEEN SURVEYED. THIS SURVEY WAS PERFORMED WITHOUT THE BENEFIT OF AN ABSTRACTOR. THEREFORE, NO SEARCH OF RECORD EASEMENTS WAS PERFORMED ON THE SUBJECT PROPERTY.
 7. BENCHMARK NOTE:
 -ALL ELEVATIONS ARE RELATIVE TO TOWN OF ADDISON MONUMENT #13.
 -LOCATION OF MONUMENT IS 630' WEST FROM THE INTERSECTION OF ADDISON RD. AND WESTGROVE DR. THEN 15.7' SOUTH FROM BACK OF CURB, 5' FROM STREET SIGN AND 8' SOUTH TO BACK OF CURB OF WESTGROVE RD.
 -ELEVATION= 642.09
 -MONUMENT: 2" BRASS DISK STAMPED "TWOOT COA-13 GPS"

ONE STORY STUCCO BUILDING

MATCH LINE

MATCH LINE

