

- PAVING NOTES**
- UNLESS OTHERWISE NOTED, ALL CONCRETE SHALL BE CLASS "A", (3000 PSI).
  - UNLESS NOTED, ALL FILL PLACED UNDER PAVING SHALL BE COMPACTED TO 95% STANDARD PROCTOR DENSITY IN 6 INCH LIFTS. REFER TO STRUCTURAL SPECIFICATION FOR FILL PLACED BENEATH BUILDING AREAS. ALL OTHER FILL AREAS TO BE COMPACTED TO 90% STANDARD PROCTOR.
  - THE CONTRACTOR SHALL SUBMIT A JOINT SPACING PLAN TO THE ENGINEER FOR APPROVAL. UNLESS NOTED, EXPANSION JOINT SPACING SHALL BE 90' MAXIMUM EACH WAY WITH NO KEYWAYS AND SAVED DUMMY JOINTS SHALL BE 15' EACH WAY.
  - TRANSVERSE CONSTRUCTION JOINTS SHALL BE USED AT THE END OF EACH DAY'S PAVING AND WHERE INTERRUPTIONS SUSPEND OPERATIONS FOR 30 MINUTES OR MORE.
  - ALL PAVEMENTS TO BE REMOVED SHALL BE FULL DEPTH SAWCUT TO A NEAT LINE, AND THE PAVEMENT REMOVED IN SUCH A MANNER AS TO PRESERVE THE EXISTING TRANSVERSE REINFORCING STEEL TO THE MAXIMUM EXTENT POSSIBLE.
  - ALL CURBS AND GUTTERS SHALL BE INTEGRAL WITH THE PAVEMENT AND HAVE THE SAME COMPRESSIVE STRENGTH.
  - PAVEMENT REINFORCEMENT SHALL BE #3 BARS, SPACED AT 18" CENTER TO CENTER EACH WAY EXCEPT WHERE NOTED IN THE PLANS.
  - BAR LAPS SHALL BE 30 DIAMETERS IN LENGTH.
  - ALL STRIPES SHALL BE 4" WIDE, UNLESS OTHERWISE NOTED.
  - INSTALLATION AND PLACEMENT OF IRRIGATION SLEEVES AND UTILITY CONDUITS SHALL BE IN ACCORDANCE WITH LANDSCAPE ARCHITECTS AND MEP PLANS.
  - SIDEWALKS SHALL HAVE A SLOPE NO GREATER THAN 5% AND A CROSS FALL NO GREATER THAN 2% UNLESS NOTED OTHERWISE.
  - DEVELOPER WILL BE REQUIRED TO REHAB OR REPLACE ALL EXISTING CRACKED OR DETERIORATED SIDEWALKS.

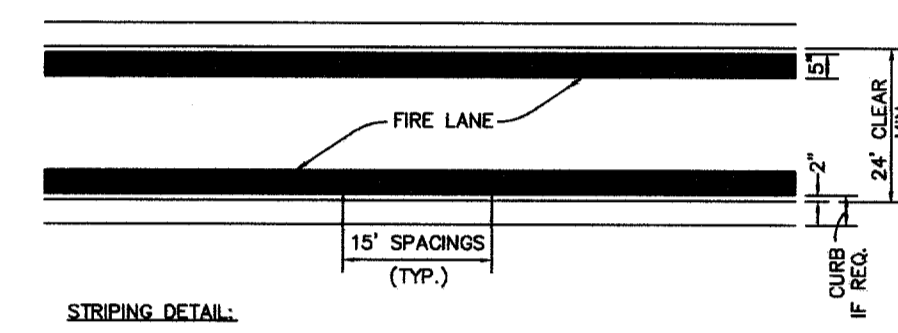

- STRIPING DETAIL**
- A. PAINT:
- STRIPES SHALL BE FIVE (5) INCHES WIDE PAINTED WITH AN EXTERIOR ACRYLIC LATEX PAINT.
  - COLOR SHALL BE "TRAFFIC RED" GILDED NO. 63251 OR EQUAL.
  - LETTERS SHALL BE FOUR (4) INCHES HIGH PAINTED WITH AN EXTERIOR ACRYLIC LATEX PAINT.
  - COLOR SHALL BE "TRAFFIC WHITE" GILDED NO. 563245 OR EQUAL.
- B. APPLICATION:
- STRIPES MAY BE BRUSHED OR SPRAYED, ONE COAT TO FINISH.
  - LETTERS SHALL BE STENCIL FORMED, BRUSH APPLIED AND SPACED AS DETAILED ON THIS SHEET.

**3 Firelane Striping Detail**  
NOT TO SCALE

- PAVING LEGEND:**
- 5" 3,000 PSI CLASS "A" CONC. PVMT. DRIVE AND PARKING AREAS
  - 6" 3,600 PSI CLASS "C" CONC. PVMT. FIRELANES AND DOCK AREAS

**1 CONSTRUCTION JOINT**  
NOT TO SCALE

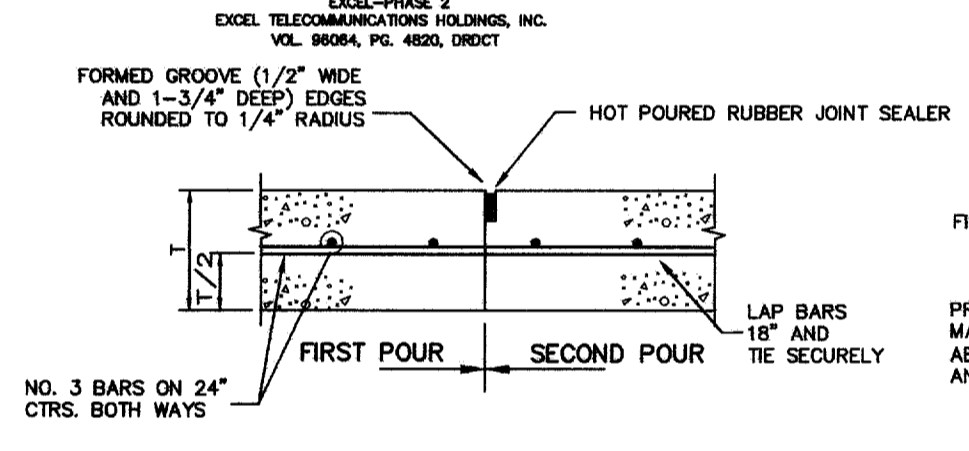

**2 Concrete Walk**  
NOT TO SCALE

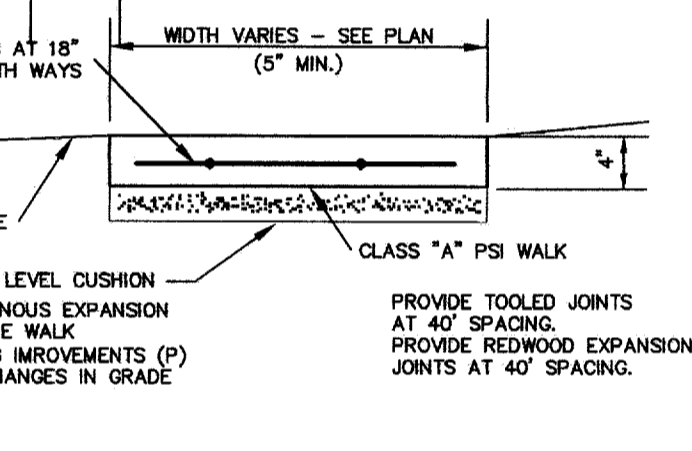

**9 Sawed Dummy Joint**  
NOT TO SCALE

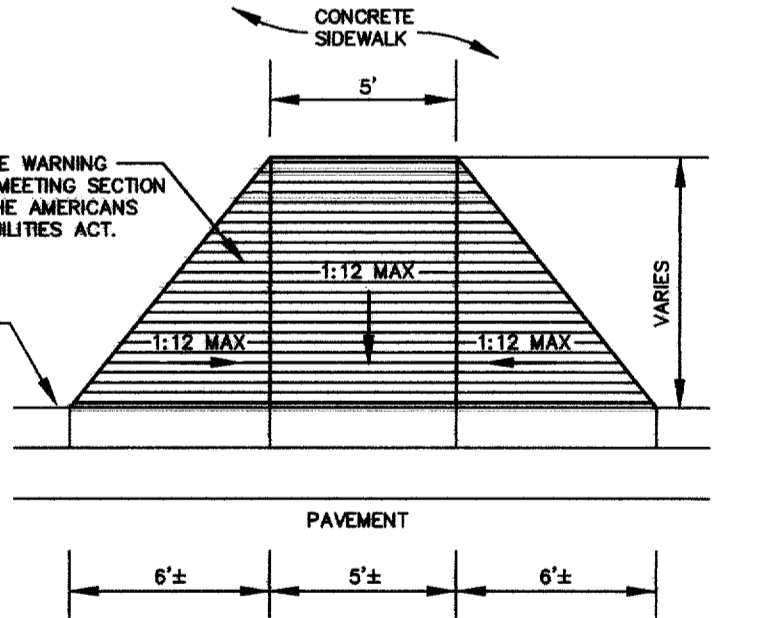
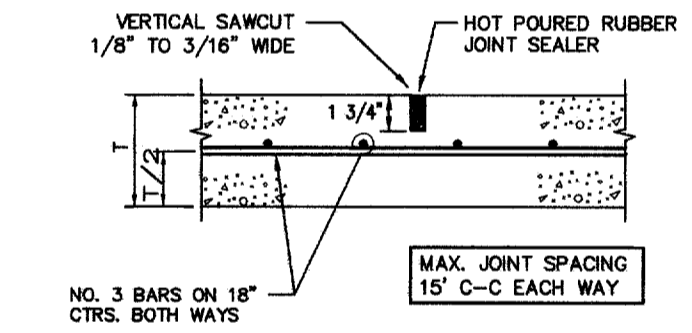

**4 Plan at Flare Side Handicapped Ramp**  
NOT TO SCALE

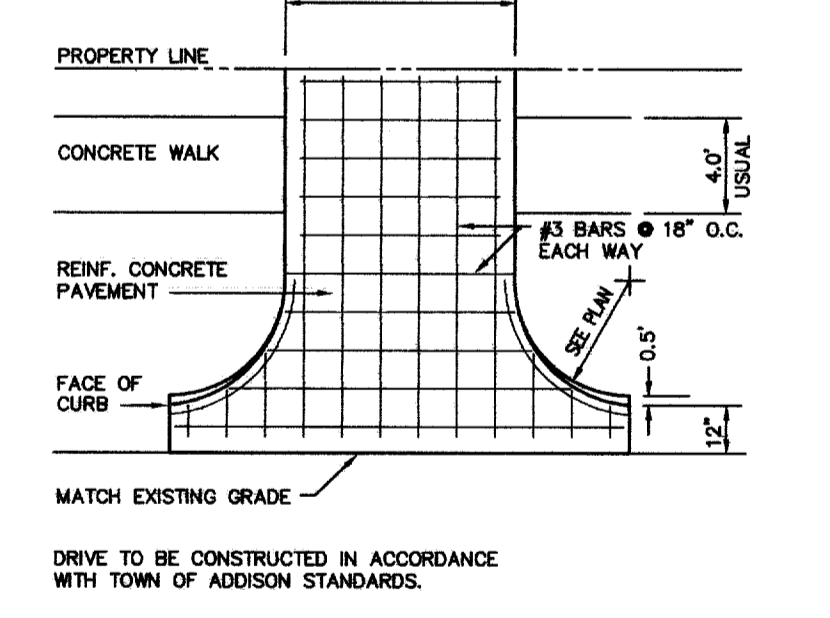

**5 Driveway Approach**  
NOT TO SCALE

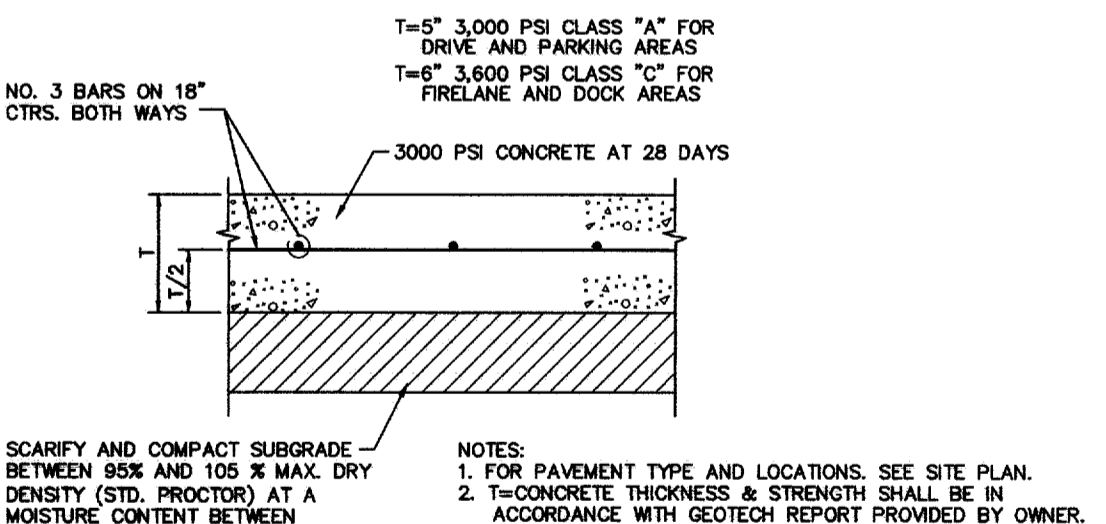

**6 Pavement Section**  
NOT TO SCALE

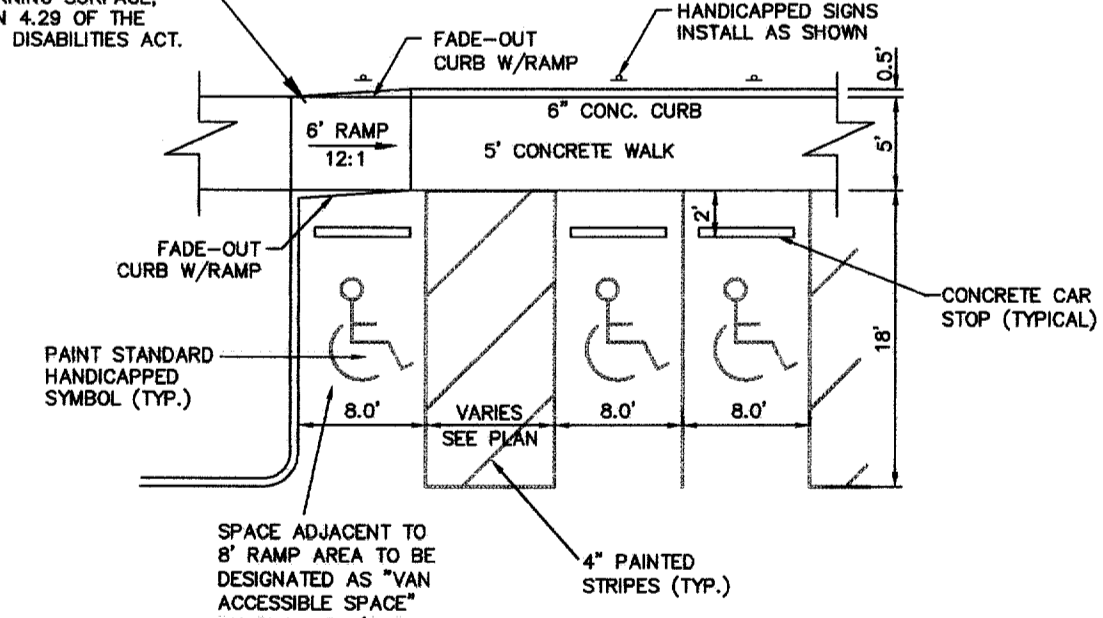

**7 Handicap Parking Detail**  
NOT TO SCALE

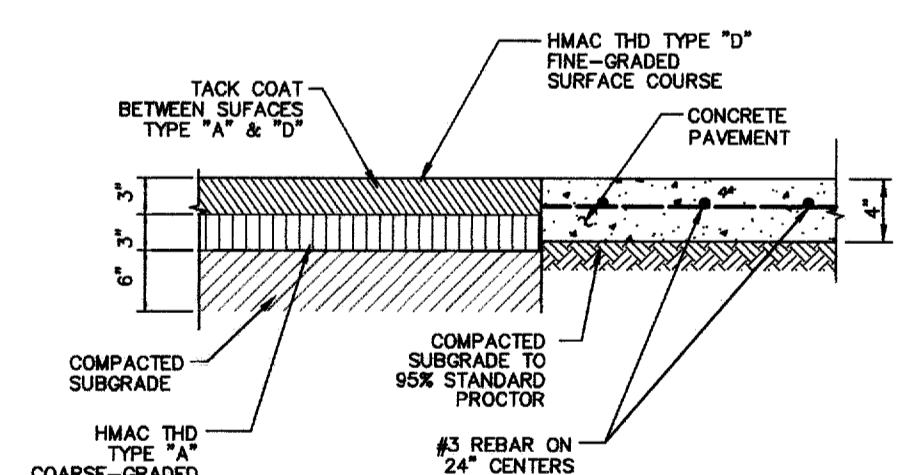

**8 Asphalt/Concrete Transition**  
NOT TO SCALE

**RECORD DRAWING**

THIS DRAWING HAS BEEN REVISED TO REFLECT CONSTRUCTION RECORDS MAINTAINED AND PROVIDED BY THE CONTRACTOR FOR THIS PROJECT.

CONTRACTOR: HILL & WILKINSON  
DATE REVISED: 05/04/01

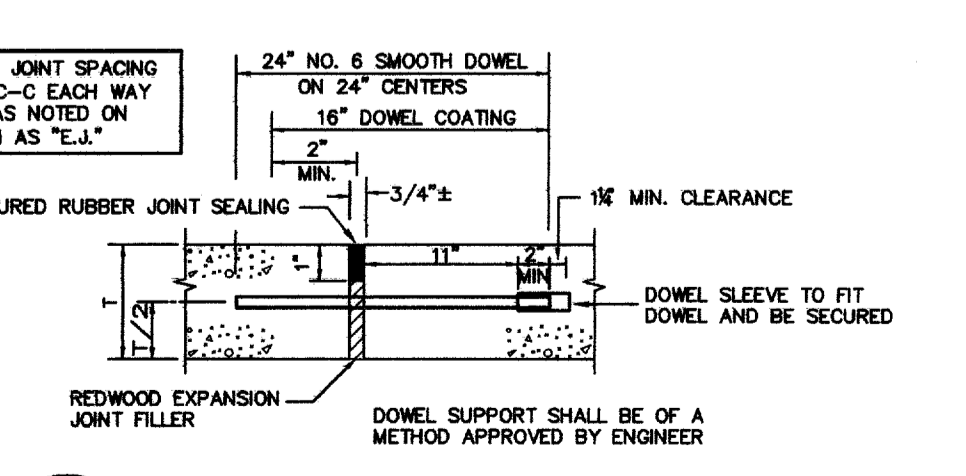

**10 Expansion Joint**  
NOT TO SCALE

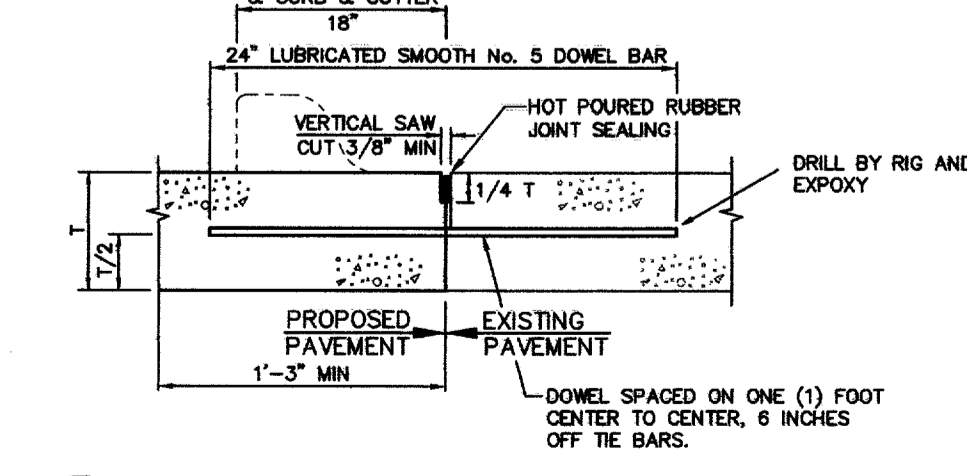

**11 Pavement Connection**  
NOT TO SCALE

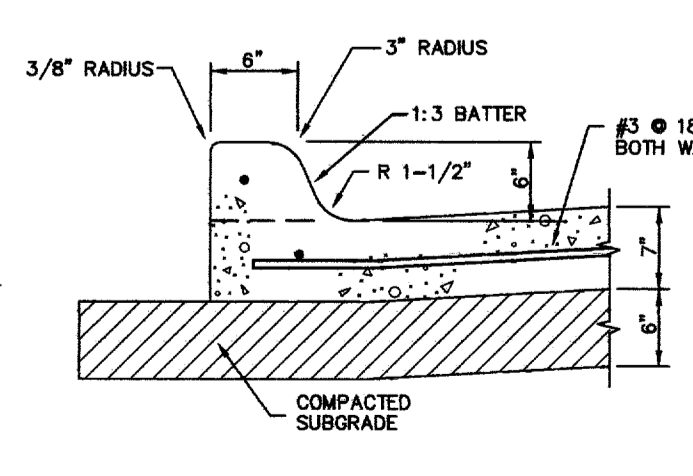

**12 Integral Curb**  
NOT TO SCALE

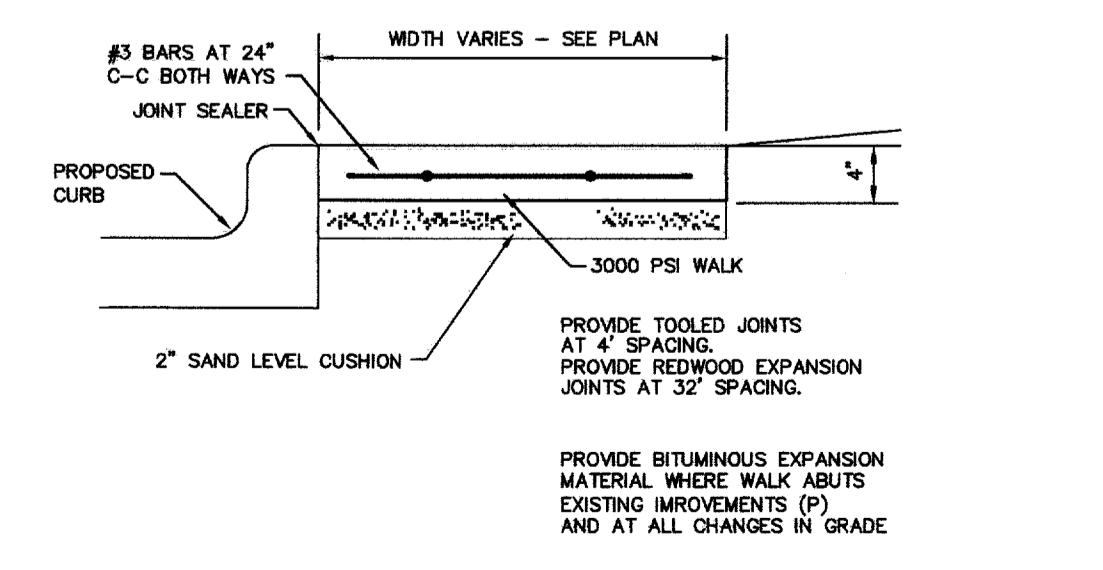

**13 Curb Walk**  
NOT TO SCALE



THE SEAL APPEARING ON THIS DOCUMENT WAS AUTHORIZED BY STEVEN A. MARKUSSEN, P.E. 70090 ON 07/26/00. ALTERATION OF A SEALED DOCUMENT WITHOUT PROPER NOTIFICATION TO THE RESPONSIBLE ENGINEER IS AN OFFENSE UNDER THE TEXAS ENGINEERING PRACTICE ACT.

REVISD 05/04/01

**Pacheco Koch Consulting Engineers**  
9401 LBJ FREEWAY SUITE 300 DALLAS, TEXAS 75243 972.235.3031

**PAVING PLAN**  
ADDISON OFFICE / WAREHOUSE COMPLEX  
LOTS 1 & 2, BLOCK A  
WESTGROVE/BENT TREE PLAZA ADDITION  
TOWN OF ADDISON, TEXAS

DESIGN	DRAWN	DATE	SCALE	NOTES	FILE	NO.
CJE	JLM	JULY 26, 2000	1"=80'			<b>C6.1</b>

CONTRACTOR: HILL & WILKINSON  
DATE REVISED: 05/04/01

PROJECT NO.: 9956  
PREPARED BY: JLM  
CHECKED BY: CJL  
DATE: 07/26/00  
REVISIONS:

SHEET NO. + TITLE:  
**C6.1**

PAVING PLAN