

# THE TOWN OF ADDISON, TEXAS

## CIVIL SITE IMPROVEMENTS

TO SERVE

### LOT 4, BLOCK A SOJOURN PLAZA 16800 WESTGROVE DRIVE ADDISON, TX

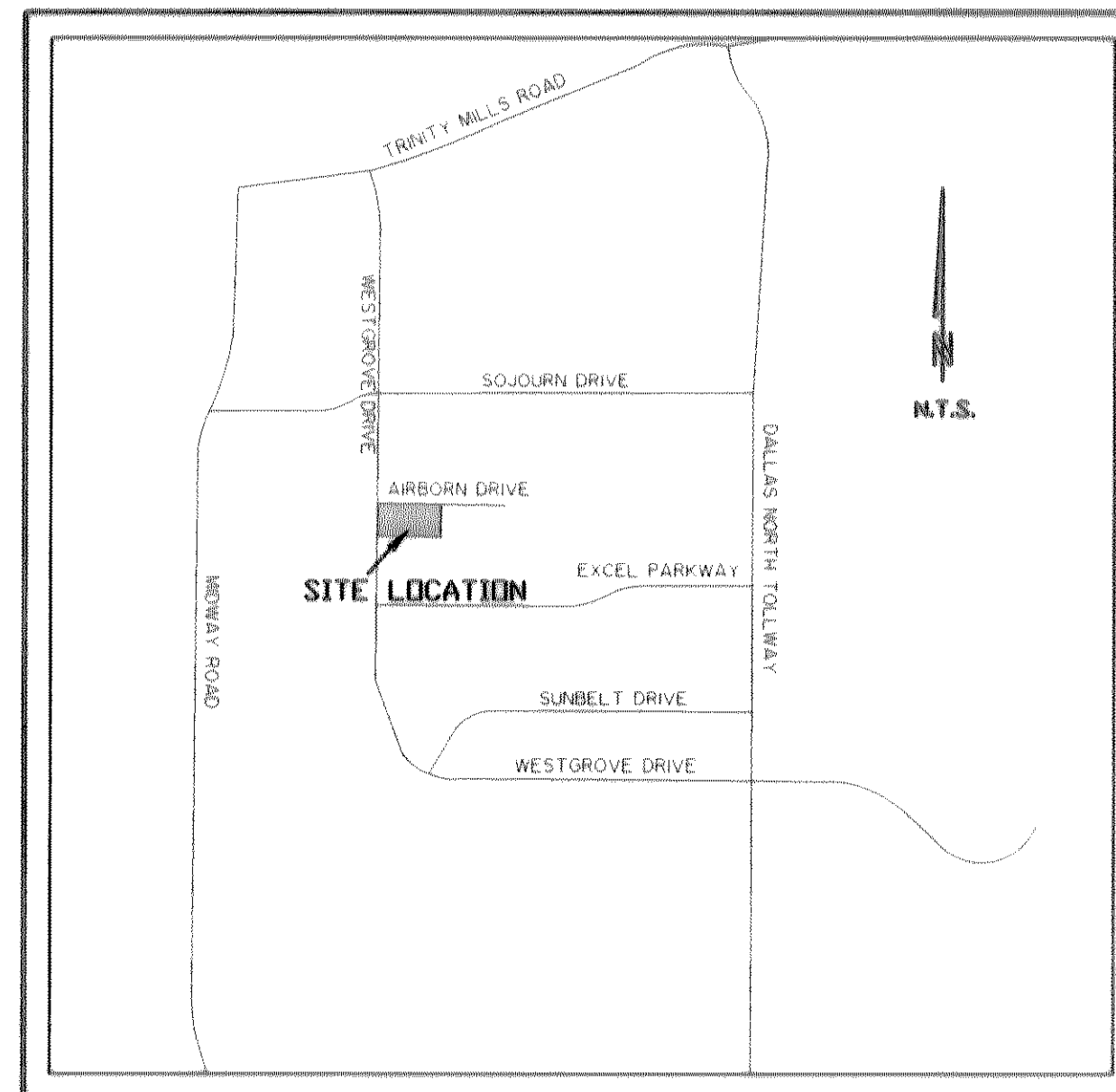

**VICINITY MAP**

**SHEET INDEX**

COVER
COPY OF PLAT
N101 PRIVATE IMPROVEMENTS GENERAL CONSTRUCTION NOTES (1 OF 2)
N102 PRIVATE IMPROVEMENTS GENERAL CONSTRUCTION NOTES (2 OF 2)
P101 PAVING PLAN
P201 PRIVATE PAVING DETAILS
P202 PRIVATE HANDICAP DETAILS
G101 GRADING PLAN
D001 DRAINAGE AREA MAP
D101 STORM DRAIN PLAN
D201 STORM DRAIN PROFILES
U101 UTILITY PLAN
U201 UTILITY DETAILS
E001 STORM WATER POLLUTION PREVENTION NOTES (1 OF 2)
E002 STORM WATER POLLUTION PREVENTION NOTES (2 OF 2)
E101 STORM WATER POLLUTION PREVENTION PLAN
E201 STORM WATER POLLUTION PREVENTION DETAILS
L1 LANDSCAPE PLAN
L2 LANDSCAPE NOTES & DETAILS

1. ALL REFERENCES TO 'CITY' SHALL MEAN 'TOWN OF ADDISON'.
2. ALL CONSTRUCTION SHALL BE IN ACCORDANCE WITH THE TOWN OF ADDISON AND NORTH TEXAS COUNCIL OF GOVERNMENT STANDARD SPECIFICATIONS.

TOWN OF ADDISON  
STANDARD DETAIL  
SHEETS INCORPORATED  
HEREIN BY REFERENCE



PREPARED BY:  
**WIA WIER & ASSOCIATES, INC.**  
ENGINEERS SURVEYORS LAND PLANNERS  
701 HIGHLANDER BLVD., SUITE 300 ARLINGTON, TEXAS 76015 METRO (817)467-7700  
1380 U.S. HIGHWAY 287 N. SUITE 101 MANSFIELD, TEXAS 76063 METRO (817)477-8700  
6849 ELM STREET FISCO, TEXAS 75034 METRO (214)387-8000  
www.WierAssociates.com

**RECORD DRAWINGS**  
07-16-08

THE INFORMATION SHOWN ON THESE PLANS HAS BEEN REVISED TO REFLECT CHANGES TO THE PUBLIC IMPROVEMENTS MADE DURING CONSTRUCTION PROVIDED TO THE ENGINEER BY THE CONTRACTOR UNLESS NOTED OTHERWISE. THE CONSTRUCTION OF THE PUBLIC IMPROVEMENTS IS IN GENERAL CONFORMANCE WITH THESE PLANS BASED ON THE INFORMATION PROVIDED BY THE CONTRACTOR AND THE RESPONSIBILITY FOR ACCURACY AND COMPLETENESS BELONGS TO THE CONTRACTOR.

ULYS LANE, III      DATE 7-16-08