

TIME 12:07 FILE: 0109503-UT PLAN.dwg

WESTGROVE DRIVE

(CALLED 60' R.O.W.)

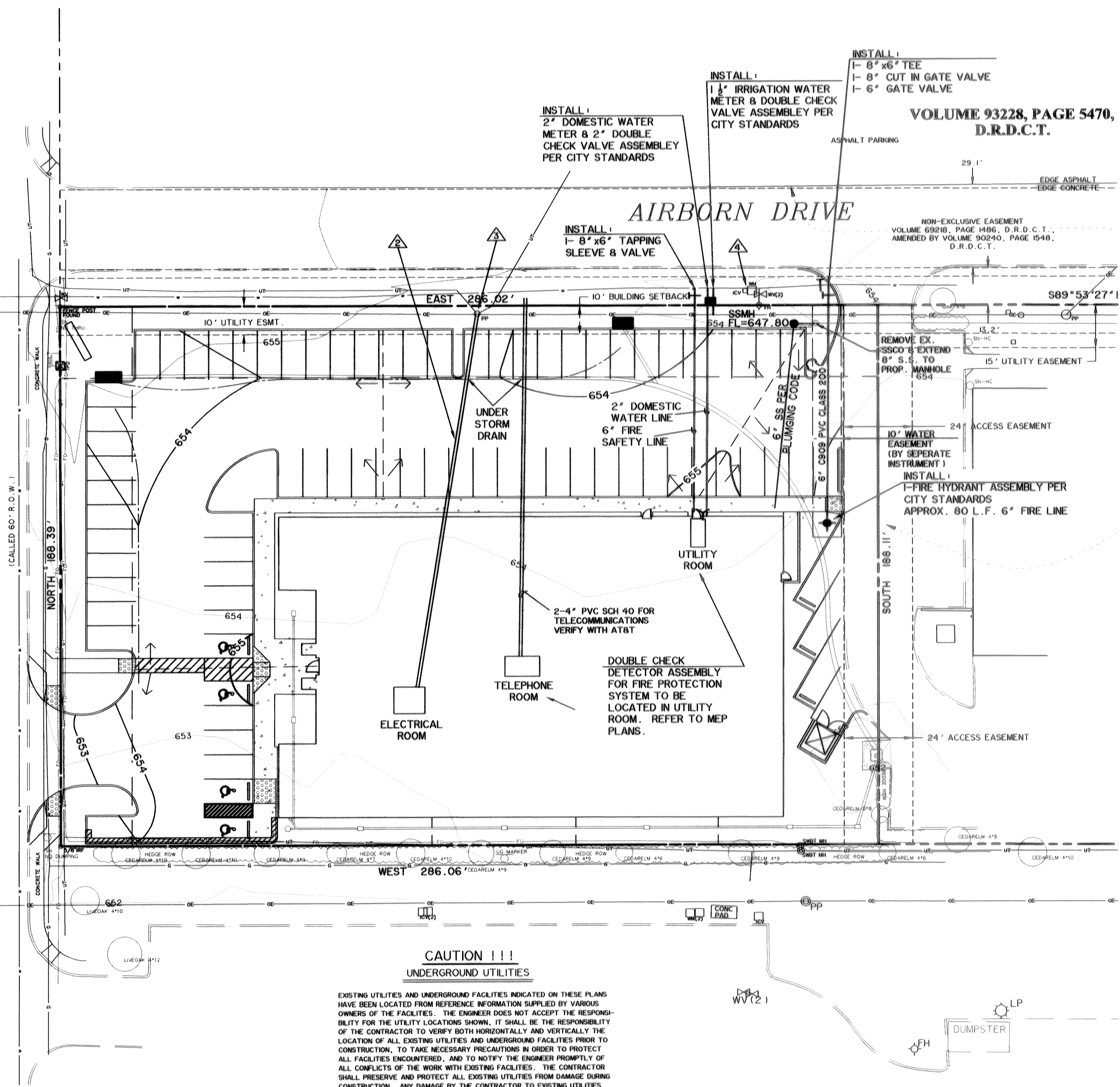

LEGEND	
SS	EXISTING SANITARY SEWER
---	EXISTING WATER
GAS	EXISTING GAS
---	EXISTING UNDERGROUND ELECTRIC
FG	EXISTING FIBER OPTIC CABLE
CATV	EXISTING CABLE TV
⊗	EXISTING GATE VALVE
⊙	EXISTING FIRE HYDRANT
⊕	EXISTING IRRIGATION CONTROL VALVE
●	PROPOSED FIRE HYDRANT
○	PROPOSED SS CLEAN OUT
●	PROPOSED SS MANHOLE
⊕	PROPOSED WATER METER
⊕	PROPOSED GATE VALVE

**NOTES:**

- UTILITY CONTRACTOR TO PROVIDE TAPS AND METERS FOR PLUMBER TO CONNECT TO PER TOWN OF ADDISON SPECIFICATIONS.
  - CONTRACTOR TO PROVIDE BACK FLOW PREVENTION VALVES FOR ALL WATER SERVICE LINES. BACK FLOW PREVENTION VALVES FOR FIRE SPRINKLER PROTECTION SYSTEM TO BE LOCATED IN UTILITY ROOM. REFER TO MEP PLANS FOR DETAILS.
  - CONTRACTOR SHALL VERIFY LOCATION AND INSTALL ALL ELECTRICAL, TELEPHONE, IRRIGATION AND MISC. CONDUITS PRIOR TO PAVING PARKING AND DRIVING ISLE.
- ▲ PROVIDE 2-4" PVC CONDUITS SCH 40 FROM TELEPHONE PEDESTAL (TO BE PROVIDED) TO 4' x 8' PLYWOOD CONTROL PANEL
- ▲ PROVIDE 2-4" GRAY ELECTRICAL CONDUIT SCH 40 FROM POWER POLE TO ELECTRIC ROOM COORDINATE WITH MEP & ELECTRIC COMPANY
- ▲ VERIFY POLE FOR POLE MOUNTED TRANSFORMER COORDINATE WITH ELECTRIC COMPANY & MEP
- ▲ CONTRACTOR SHALL VERIFY TAP SIZE OF EXISTING METER. CONTRACTOR SHALL UTILIZE EXISTING METER LOCATION IN LIEU OF PROPOSED DOMESTIC OR IRRIGATION METER LOCATION IF EXISTING METER TAP SIZE IS COMPATIBLE. IF EXISTING METER CAN NOT BE UTILIZED, CONTRACTOR SHALL REMOVE METER AND PLUG.

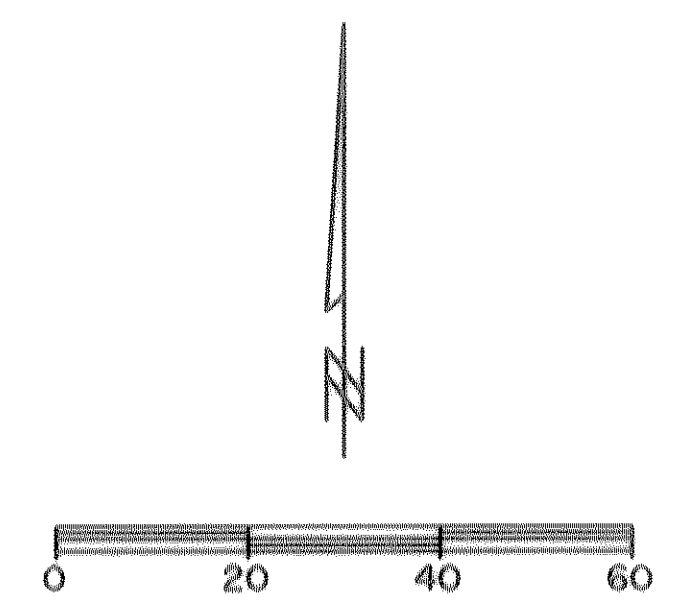

**CAUTION !!!  
UNDERGROUND UTILITIES**

EXISTING UTILITIES AND UNDERGROUND FACILITIES INDICATED ON THESE PLANS HAVE BEEN LOCATED FROM REFERENCE INFORMATION SUPPLIED BY VARIOUS OWNERS OF THE FACILITIES. THE ENGINEER DOES NOT ACCEPT THE RESPONSIBILITY FOR THE UTILITY LOCATIONS SHOWN. IT SHALL BE THE RESPONSIBILITY OF THE CONTRACTOR TO VERIFY BOTH HORIZONTALLY AND VERTICALLY THE LOCATION OF ALL EXISTING UTILITIES AND UNDERGROUND FACILITIES PRIOR TO CONSTRUCTION, TO TAKE NECESSARY PRECAUTIONS IN ORDER TO PROTECT ALL FACILITIES ENCOUNTERED, AND TO NOTIFY THE ENGINEER PROMPTLY OF ALL CONFLICTS OF THE WORK WITH EXISTING FACILITIES. THE CONTRACTOR SHALL PRESERVE AND PROTECT ALL EXISTING UTILITIES FROM DAMAGE DURING CONSTRUCTION. ANY DAMAGE BY THE CONTRACTOR TO EXISTING UTILITIES SHALL BE REPAIRED BY THE CONTRACTOR AT HIS EXPENSE.

**RECORD DRAWINGS**  
07-16-08

THE INFORMATION SHOWN ON THESE PLANS HAS BEEN REVISED TO REFLECT CHANGES TO THE PUBLIC IMPROVEMENTS MADE DURING CONSTRUCTION PROVIDED TO THE ENGINEER BY THE CONTRACTOR UNLESS NOTED OTHERWISE. THE CONSTRUCTION OF THE PUBLIC IMPROVEMENTS IS IN GENERAL CONFORMANCE WITH THESE PLANS BASED ON THE INFORMATION PROVIDED BY THE CONTRACTOR AND THE RESPONSIBILITY FOR ACCURACY AND COMPLETENESS BELONGS TO THE CONTRACTOR.

ULYS LANE, III  
DATE 7/16/08

PREPARED BY:  
**WIA WIER & ASSOCIATES, INC.**  
**ENGINEERS SURVEYORS LAND PLANNERS**  
 701 HIGHLANDER BLVD., SUITE 300 ARLINGTON, TEXAS 76015 METRO (817)467-7700  
 1300 U.S. HIGHWAY 287 N. SUITE 101 MANSFIELD, TEXAS 76063 METRO (817)477-0700  
 6649 ELM STREET FRIEDSO, TEXAS 75004 METRO (214)387-8000  
 www.WierAssociates.com

NO.	DATE	DESCRIPTION	BY

LOT 4, BLOCK A  
 SOJOURN PLAZA  
 TOWN OF ADDISON  
 DALLAS COUNTY, TEXAS

**UTILITY PLAN**

STATE OF TEXAS  
 ULYS LANE III  
 40864  
 REGISTERED PROFESSIONAL ENGINEER  
 7/16/08

COPYRIGHT ©  
 WIER & ASSOCIATES, INC.  
 LAST SHEET EDIT  
 DATE 07-16-2008  
 WAW 01095.03

**SHEET NO.**  
U101