

FILE: 0109503-PAVING-DETAILS.dwg  
TIME: 11:26

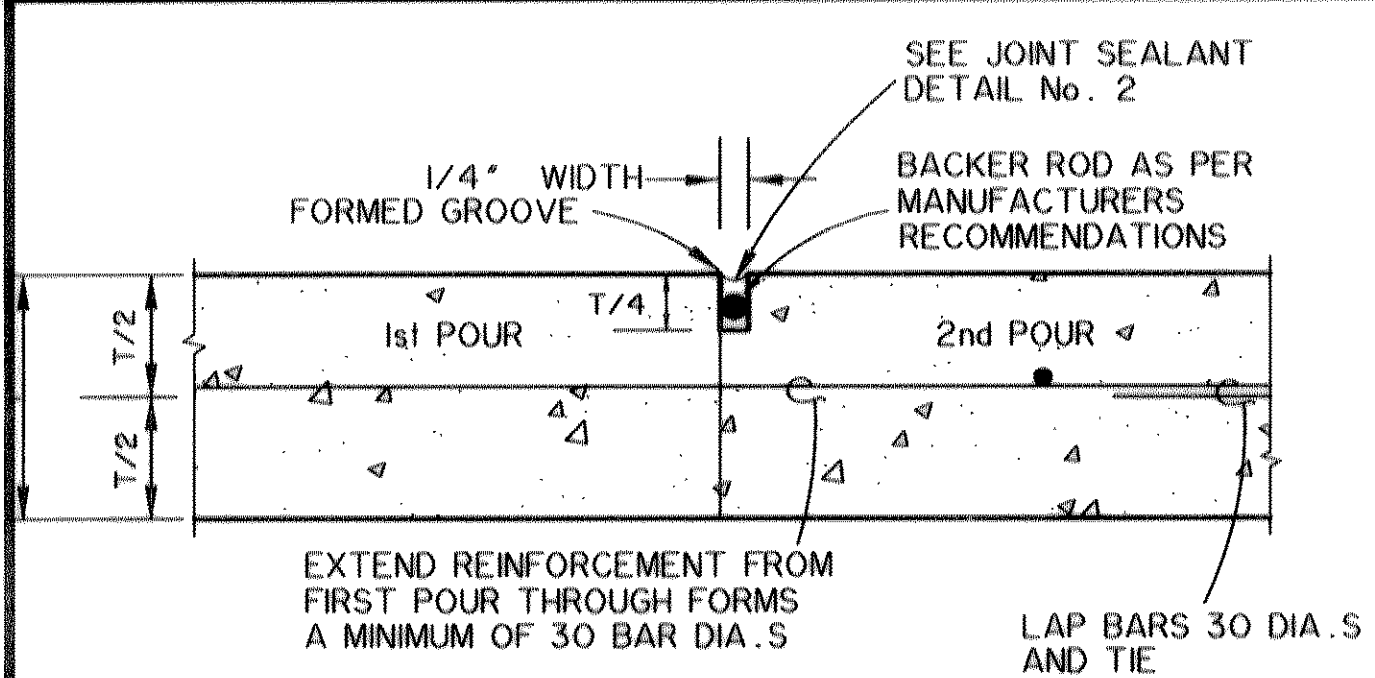

**CONSTRUCTION JOINT**

N.T.S.  
USE CONSTRUCTION JOINT BETWEEN PAVEMENT POURS IF CONCRETE PLACEMENT IS INTERRUPTED OR STOPPED FOR MORE THAN 30 MINUTES.

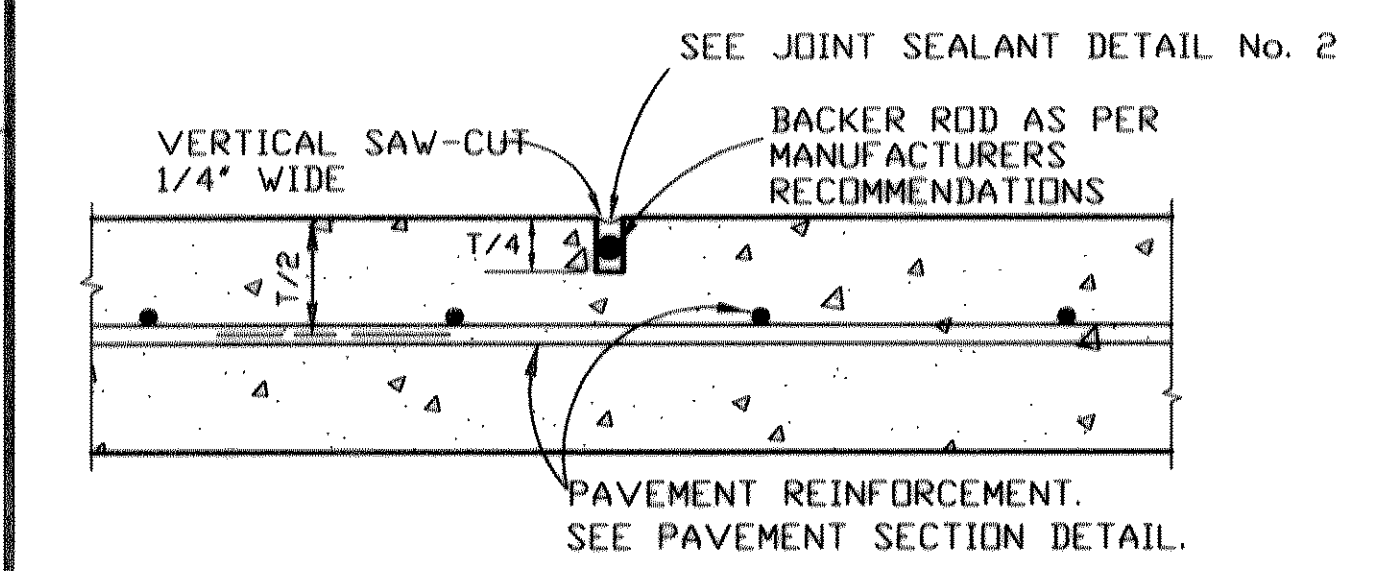

**SAWED CONTRACTION JOINT**

N.T.S.

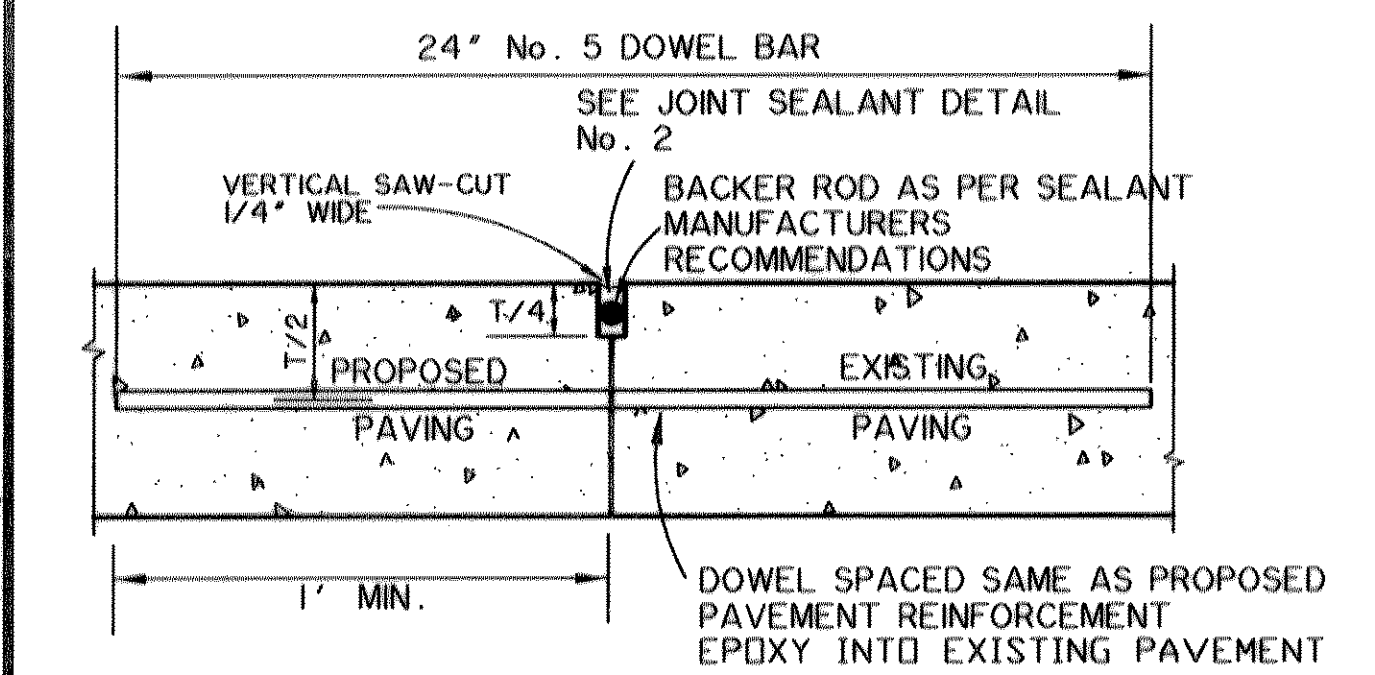

**BUTT JOINT**

N.T.S.

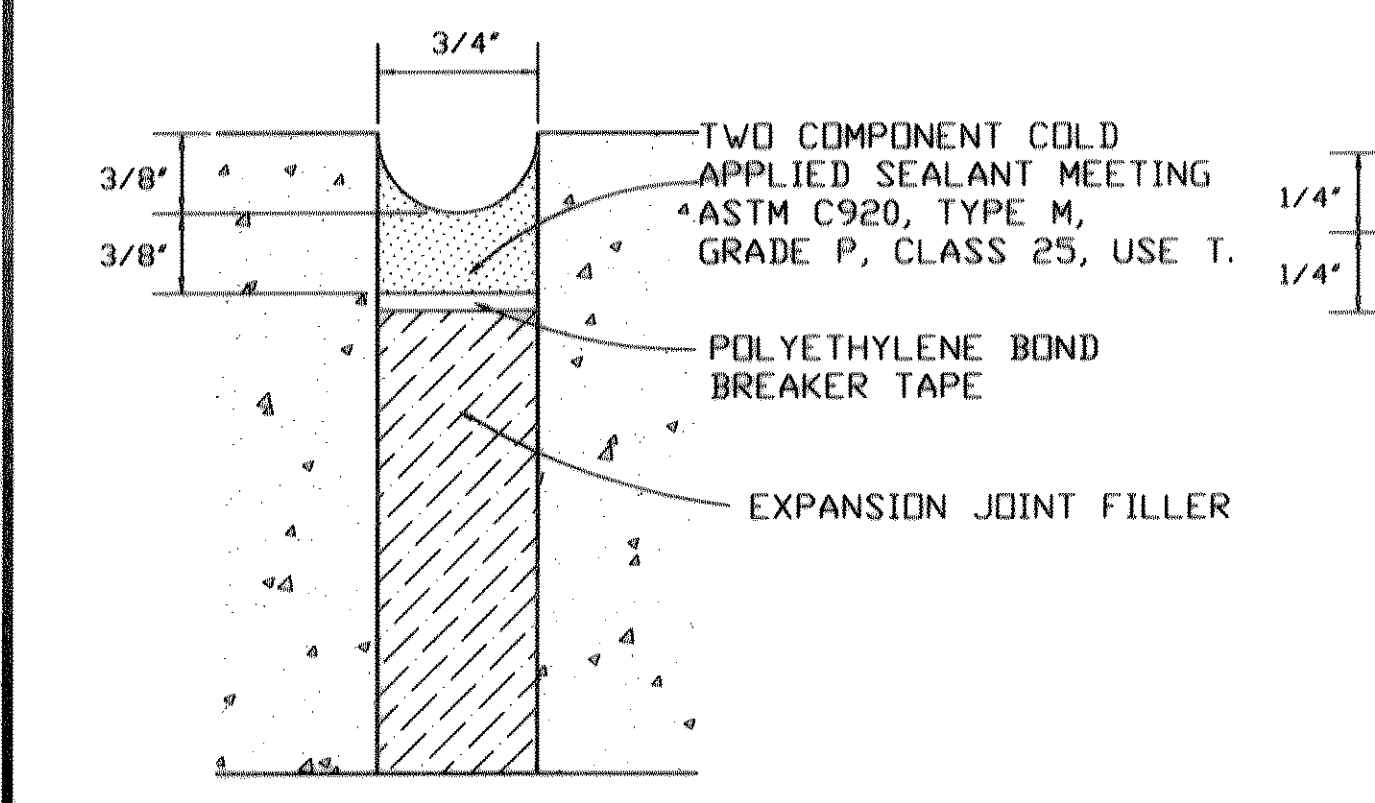

**JOINT SEALANT DETAIL No.1 SEAL FOR EXPANSION JOINT**

N.T.S.

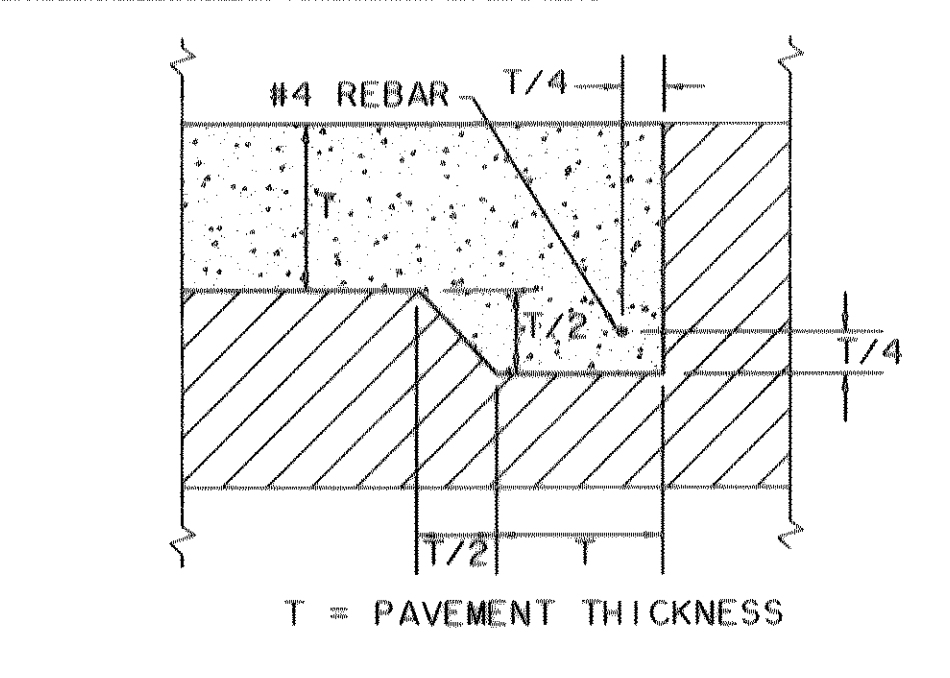

**THICKENED EDGE DETAIL**

N.T.S.

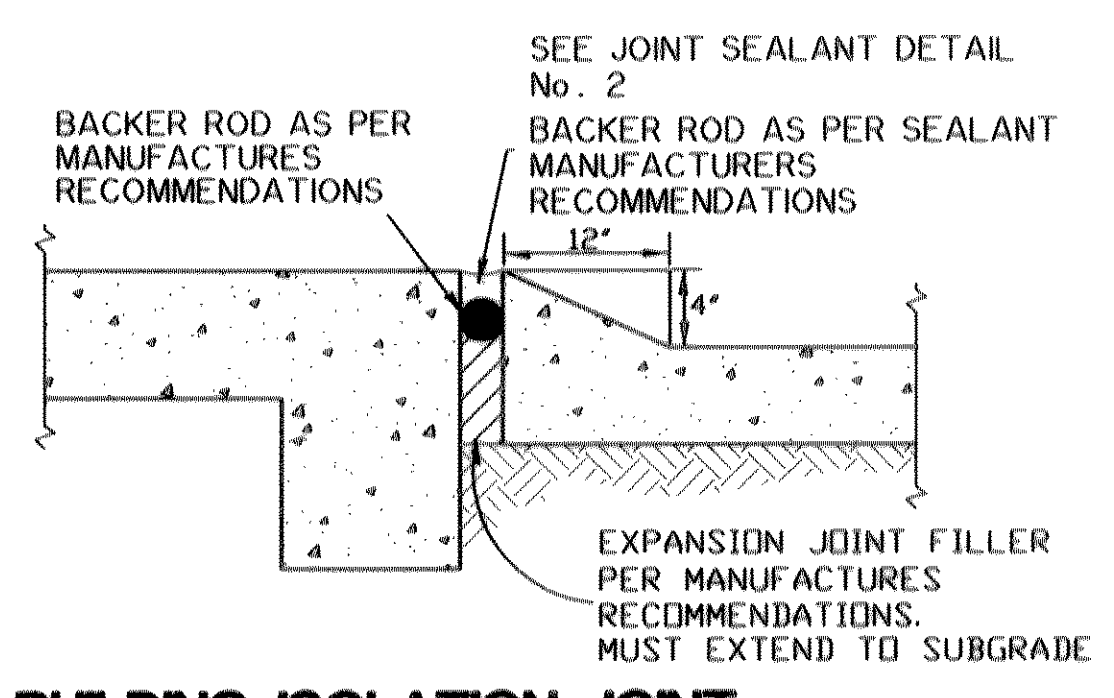

**BUILDING ISOLATION JOINT**

N.T.S.

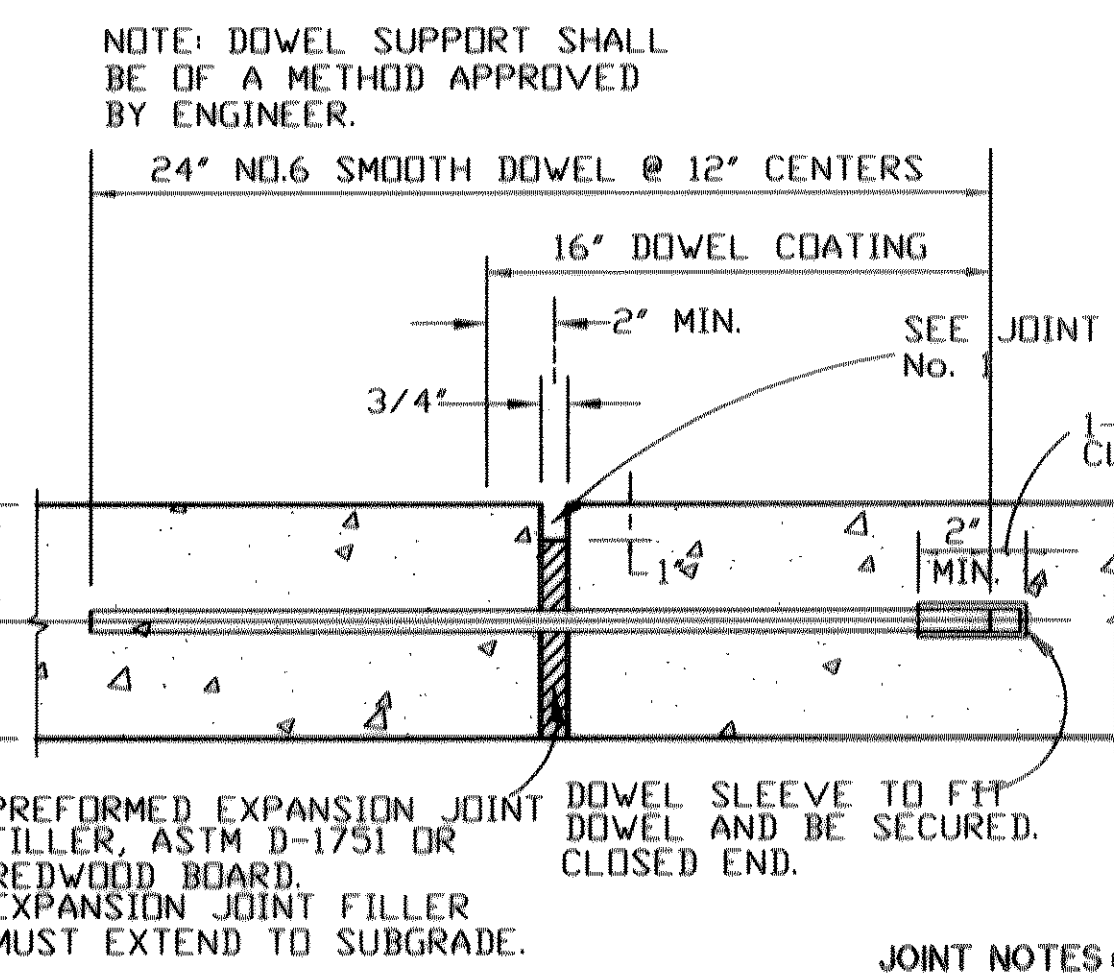

**EXPANSION JOINT**

N.T.S.

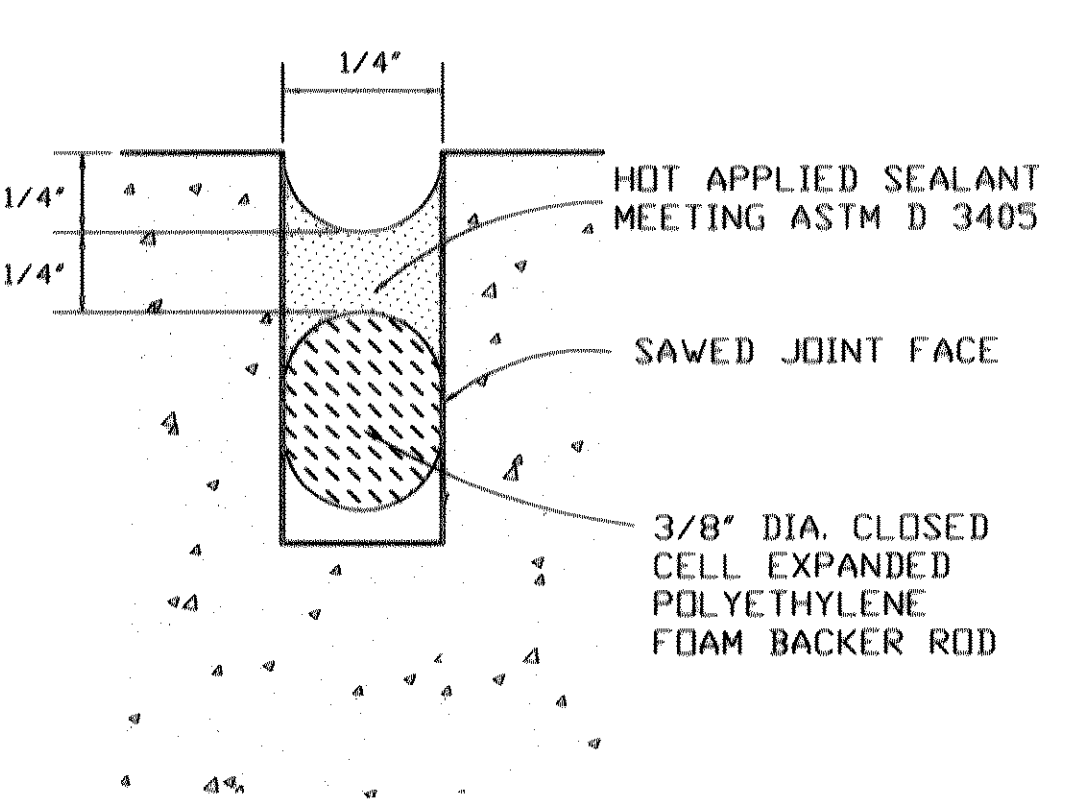

**JOINT SEALANT DETAIL No.2 SEAL FOR SAWED, CONSTRUCTION, & BUTT JOINT**

N.T.S.

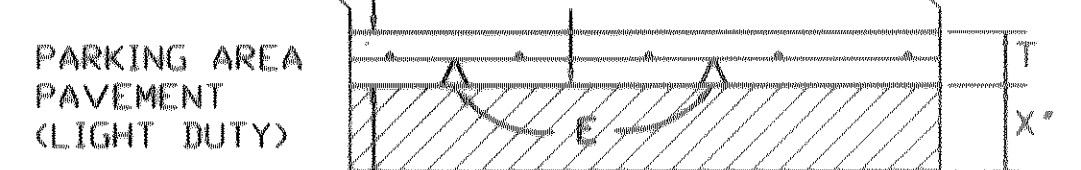

**TYPICAL PAVEMENT SECTION**

N.T.S.

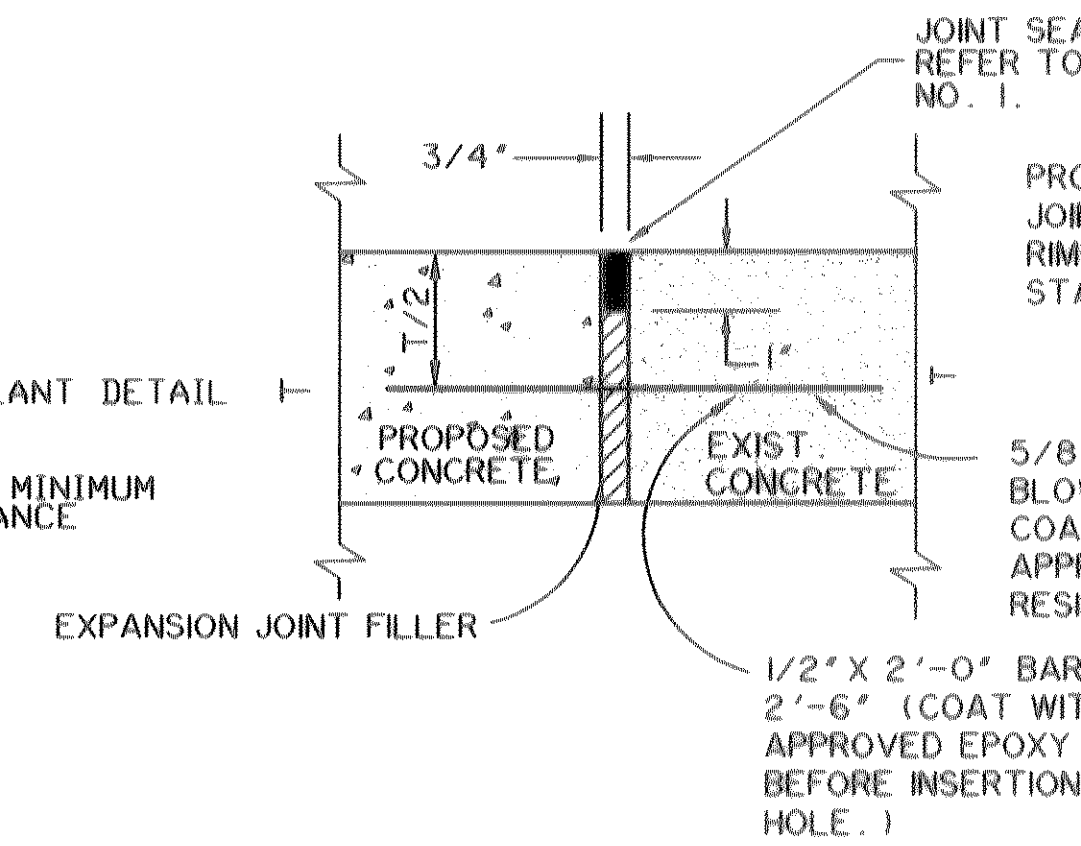

**TYPICAL ISOLATION JOINT**

N.T.S.

**NOTES:**

- A 5' - 3000 PSI CONC. REINFORCED WITH #3 BARS @ 18" C/C ON CHAIRS
- B 6' - 3500 PSI CONC. REINFORCED WITH #3 BARS @ 18" C/C ON CHAIRS
- C 6' - 3500 PSI CONC. REINFORCED WITH #3 BARS @ 18" C/C ON CHAIRS
- D 6' - COMPACTED SUBGRADE, MIN. 95% OF STANDARD PROCTOR DENSITY (ASTM D 698) AND WITH IN 1 PERCENTAGE POINT BELOW TO 3 PERCENTAGE POINTS ABOVE THE MATERIAL'S OPTIMUM MOISTURE CONTENT. SUBGRADE TREATMENT AND METHODS SHALL BE CONFIRMED BY THE PROJECT GEOTECHNICAL ENGINEER AFTER EXCAVATION AND FILLING OPERATIONS ARE COMPLETED. CONTRACTOR SHALL REVIEW PROJECT GEOTECHNICAL REPORT AND CURRENT CITY STANDARDS AND MEET OR EXCEED RECOMMENDATIONS.
- E PLACE ALL REINFORCING STEEL ON CHAIRS AT T/2 HEIGHT, SPACED A SUFFICIENT DISTANCE TO PREVENT SAGGING.
- MATERIAL AND CONSTRUCTION METHODS SHALL CONFORM TO THE APPLICABLE PROVISIONS OF THE STANDARD SPECIFICATIONS FOR PUBLIC WORKS CONSTRUCTION PREPARED BY THE NORTH CENTRAL TEXAS COUNCIL OF GOVERNMENTS.
- DO NOT PLACE SAND OR SELECT FILL BENEATH PAVEMENT FOR LEVEL UP COURSE. UTILIZE ONLY ONSITE NATIVE SOIL MATERIALS.
- COMPACTION OF THE PAVEMENT SUBGRADES, BASES, AND NEW FILL SHALL BE VERIFIED BY FIELD MOISTURE/DENSITY TESTS MADE AT A MAXIMUM FREQUENCY OF ONE TEST PER 5,000 SQUARE FEET OF PARKING AREA.
- PERIMETER/MAIN DRIVING ISLE TO BE 6' MINIMUM 3,500 psi CONCRETE ON COMPACTED SUBGRADE. PARKING STALLS TO BE 5' MINIMUM 3,000 psi CONCRETE ON COMPACTED SUBGRADE.

**JOINT NOTES:**

- CONTRACTOR MAY ELECT TO USE DOWELED CURB OR MONOLITHIC CURB
- DOWEL BARS PLACED INTO EXISTING PAVEMENT SHALL BE DRILLED INTO PAVEMENT HORIZONTALLY BY USE OF A MECHANICAL RIG. DRILLING BY HAND IS NOT ACCEPTABLE. PUSHING DOWEL BARS INTO GREEN CONCRETE IS NOT ACCEPTABLE. SECURE DOWEL BARS IN EXISTING PAVING WITH EPOXY GROUT.
- POLYETHYLENE FOAM BACKER ROD DOES NOT SIT ON BOTTOM OF SAW-CUT JOINT. PLACE AT DEPTH INDICATED IN DETAIL.
- IF SEALANT PROTRUDES ABOVE THE SURFACE OF THE PAVEMENT, IT MUST BE REMOVED AND REPLACED.
- SUBMIT MANUFACTURER'S LITERATURE FOR SEALANT, DOCUMENTING PRODUCT COMPLIES WITH ASTM SPECIFICATIONS AND PROVIDING MANUFACTURER'S RECOMMENDATIONS FOR APPLICATION. FOLLOW MANUFACTURER'S RECOMMENDATIONS ON USE OF THE PRODUCT.
- THE CONSTRUCTION JOINT IS TO BE USED BETWEEN SEPARATE POURS OF PROPOSED PAVEMENT. NOTE THAT IT REQUIRES THE REINFORCEMENT TO BE EXTENDED THROUGH THE FORM TO TIE TO THE NEXT POUR. THE BUTT JOINT IS TO BE USED BETWEEN EXISTING CONCRETE PAVEMENT (STREET OR DRIVEWAY) AND PROPOSED PAVEMENT, UNLESS AN EXPANSION JOINT IS CALLED FOR.
- JOINT SEALANTS SHALL BE INSTALL SOON AFTER JOINTS ARE SAWED AND/OR COMPLETED. THE JOINTS SHALL BE SEALED BEFORE A RAIN EVENT OCCURS AFTER SAWING OR COMPLETING THE JOINT.

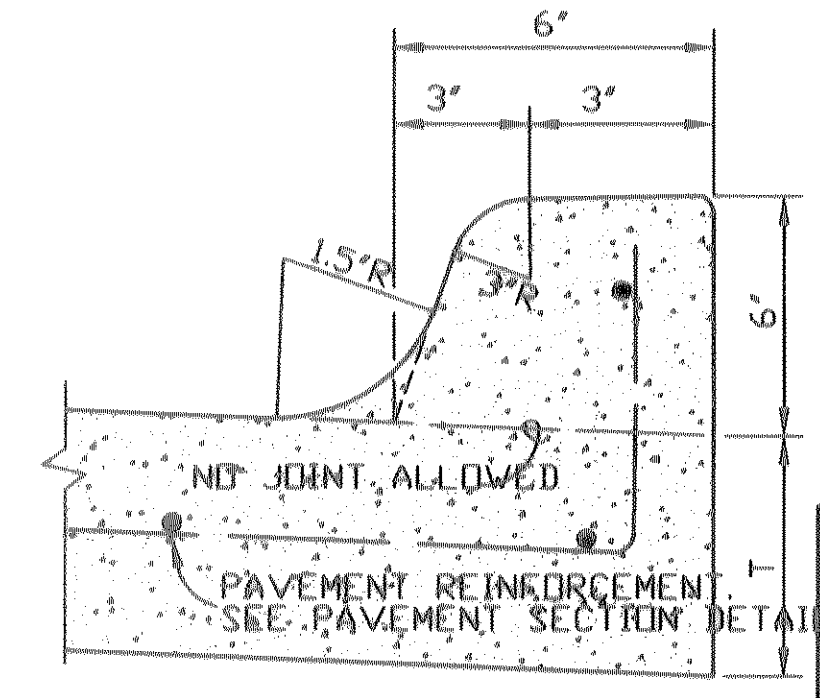

**MONOLITHIC CURB DETAIL**

N.T.S.

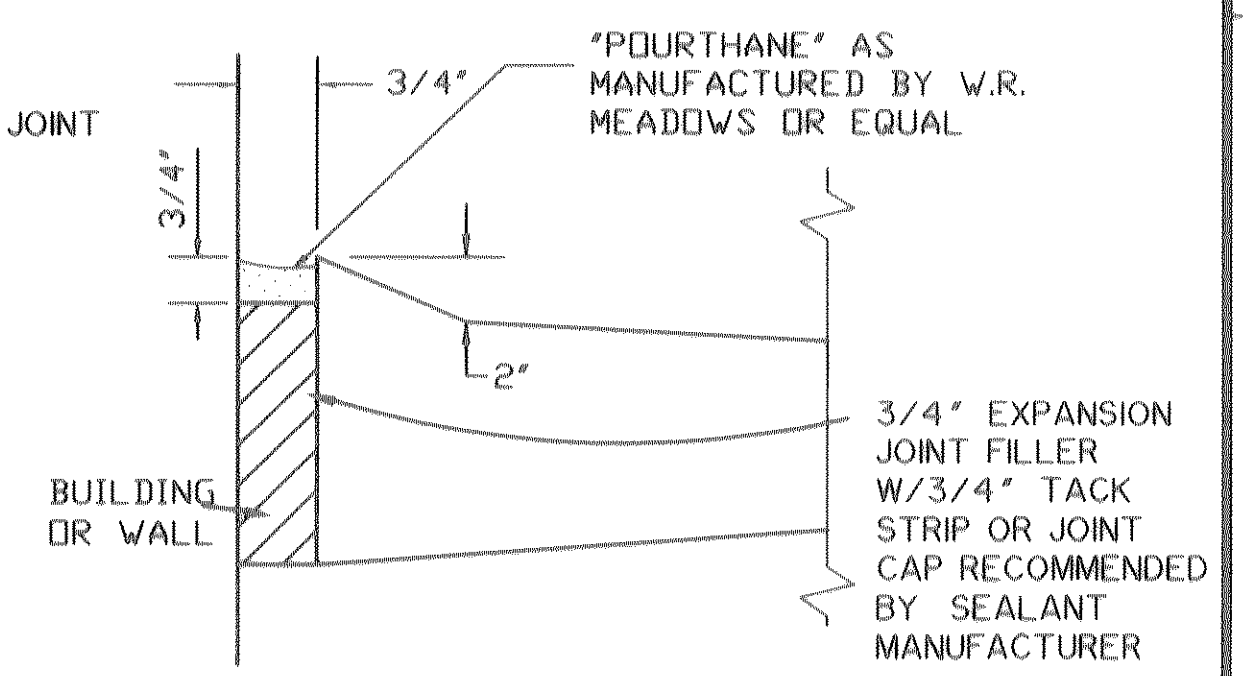

**WALKWAY ISOLATION JOINT AT BUILDING**

N.T.S.

RECORD DRAWINGS  
07-16-08

THE INFORMATION SHOWN ON THESE PLANS HAS BEEN REVISED TO REFLECT CHANGES TO THE PUBLIC IMPROVEMENTS MADE DURING CONSTRUCTION PROVIDED TO THE ENGINEER BY THE CONTRACTOR UNLESS NOTED OTHERWISE. THE CONSTRUCTION OF THE PUBLIC IMPROVEMENTS IS IN GENERAL CONFORMANCE WITH THESE PLANS BASED ON THE INFORMATION PROVIDED BY THE CONTRACTOR AND THE RESPONSIBILITY FOR ACCURACY AND COMPLETENESS BELONGS TO THE CONTRACTOR.

ULYS LANE, III  
40864  
REGISTERED PROFESSIONAL ENGINEER

DATE: 07-16-2009  
WA# 01095.03

ULYS LANE, III  
DATE: 7/16/08

PREPARED BY:  
**WIER & ASSOCIATES, INC.**  
ENGINEERS SURVEYORS LAND PLANNERS  
701 HIGHLANDER BLVD., SUITE 300 ARLINGTON, TEXAS 76015 METRO (817)467-7700  
1380 U.S. HIGHWAY 287 N. SUITE 101 WANSFIELD, TEXAS 76083 METRO (817)477-8700  
8849 ELM STREET FRISCO, TEXAS 75034 METRO (214)387-8000  
www.wierassociates.com

NO.	DATE	DESCRIPTION	BY

LOT 4, BLOCK A  
SOJOURN PLAZA  
TOWN OF ADDISON  
DALLAS COUNTY, TEXAS

PAVING DETAILS

COPYRIGHT ©  
WIER & ASSOCIATES, INC.  
LAST SHEET EDIT  
DATE: 07-16-2009  
WA# 01095.03  
SHEET NO.  
P201