

TSAY CONCRETE PARKING LOT ADDITION

PINEAPPLE PLACE

WESTGROVE ROAD

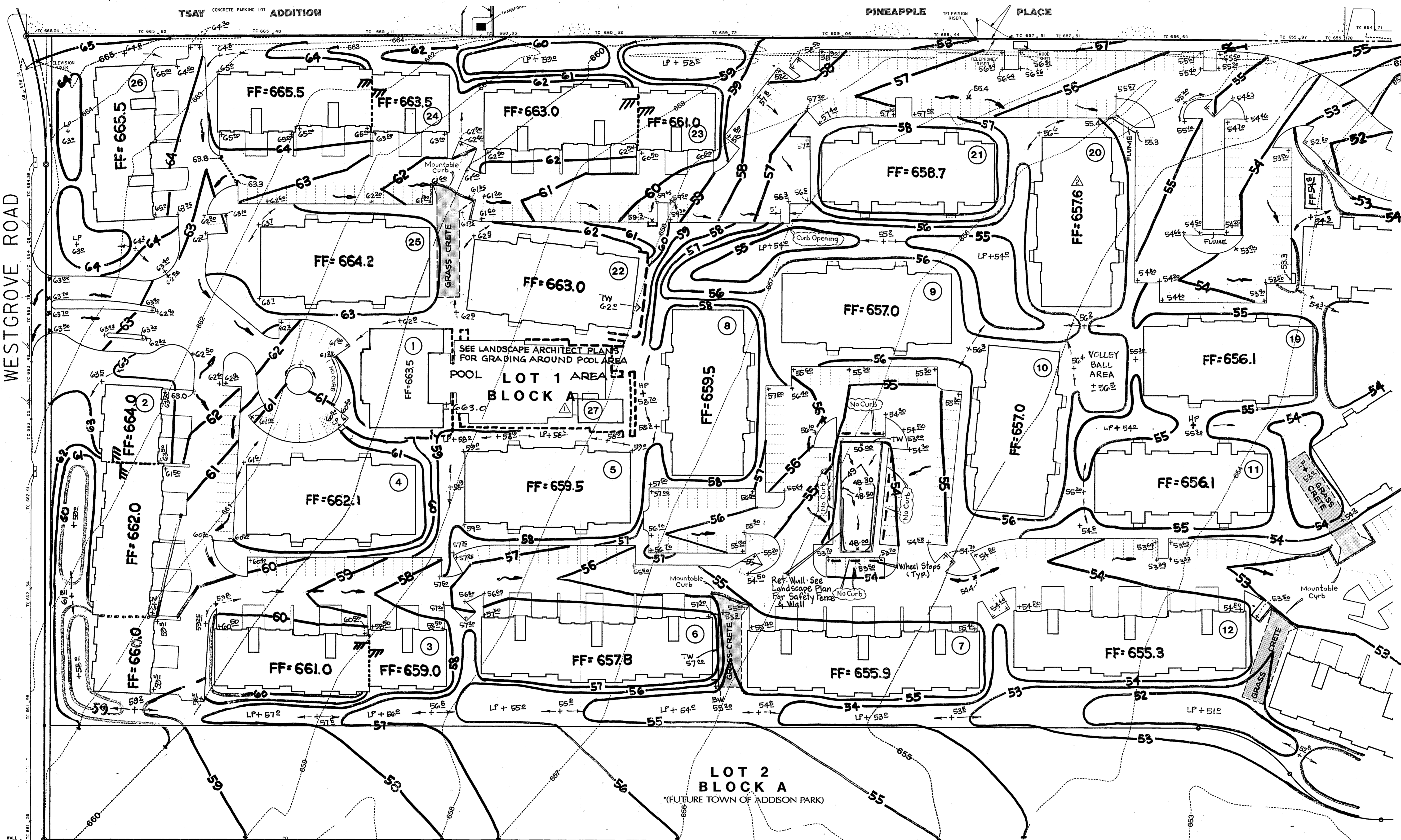
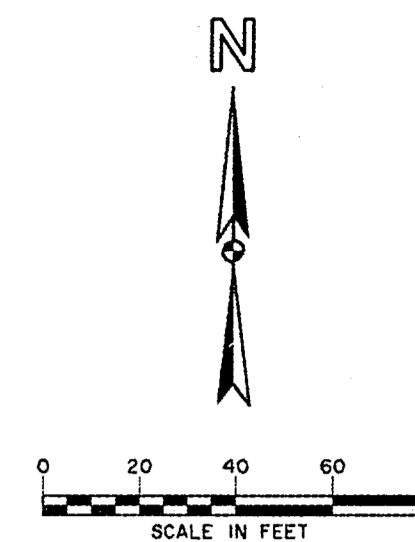

NOTE:
Grading on site of future park is intended to provide for interim surface drainage consistent with requirements for detention. Development of the park by the Town of Addison may result in a combination of surface drainage and collection systems which will discharge into detention basins along the common property line. For most effective use of the detention system, park flows should honor the drainage area map as closely as possible.

DATE	DESCRIPTION	REF. NO.
2/24/95	REVISE F.F.	
2/23/95	REVISE BLDG. 27	
12/28/94	CITY SUBMITTAL	
REVISIONS & ISSUE DATES		

LEGEND	
654	EXISTING CONTOUR
54	PROPOSED CONTOUR
50.0-x	PROPOSED SPOT ELEVATION
→	FLOW DIRECTION
FF=659.4	FINISH FLOOR ELEVATION

BENCH MARK:
Top Disk South End Of Curb Inlet On The West Side Of Addison Road 735' +/- North Of Sojourn Drive.
ELEVATION = 640.12
* Cut North End Of Recessed Inlet On The West Side Of Westgrove 665' +/- North Of Sojourn Drive.
ELEVATION = 661.37

GRADING PLAN THE DOMINION 25.408 ACRES IN 2 LOTS

SITUATED IN THE ELI SHEPHERD SURVEY, ABSTRACT No. 1361 AND LEVI NOBLE SURVEY, ABSTRACT No. 1098 TOWN OF ADDISON DALLAS COUNTY, TEXAS

CAMDEN PROPERTY TRUST 3200 SOUTHWEST FREWAY 1500 PHOENIX TOWER HOUSTON, TEXAS 77027	Sheet No. C3 OF 18	HUIT - ZOLLARS 3131 MCKINNEY AVENUE/SUITE 600 DALLAS, TEXAS/214-871-3311 DALLAS / FORT WORTH / PHOENIX / ORANGE COUNTY
	Project No. 01-1751-03	

