

FIRE LANE GENERAL NOTES

Designated Fire Lanes:
To meet the requirements of the Carrollton Fire Department for adequate horizontal emergency access, all parts of ALL buildings must be within one hundred fifty (150) feet of a public street or a designated fire lane.

- FIRE LANE WIDTH:**
Minimum fire lane width shall be at least twenty-four (24) feet clear (face to face of curbs) without horizontal obstructions.
- FIRE LANE VERTICAL CLEARANCE:**
Minimum fire lane vertical clearance shall be at least thirteen feet and six inches (13'-6").
- INTERSECTION:**
The fire lane must intersect with a dedicated street r.o.w. In addition if this fire lane exceeds one hundred fifty (150) feet in length, it must intersect with a dedicated street r.o.w. at each end of the fire lane or terminate in a configuration as detailed in the following standard details.
- PAVING SURFACE:**
The fire lane shall be paved in accordance with the City of Carrollton standards as herein detailed.
- MARKING:**
The designated fire lane shall be marked as detailed in the following standard details.

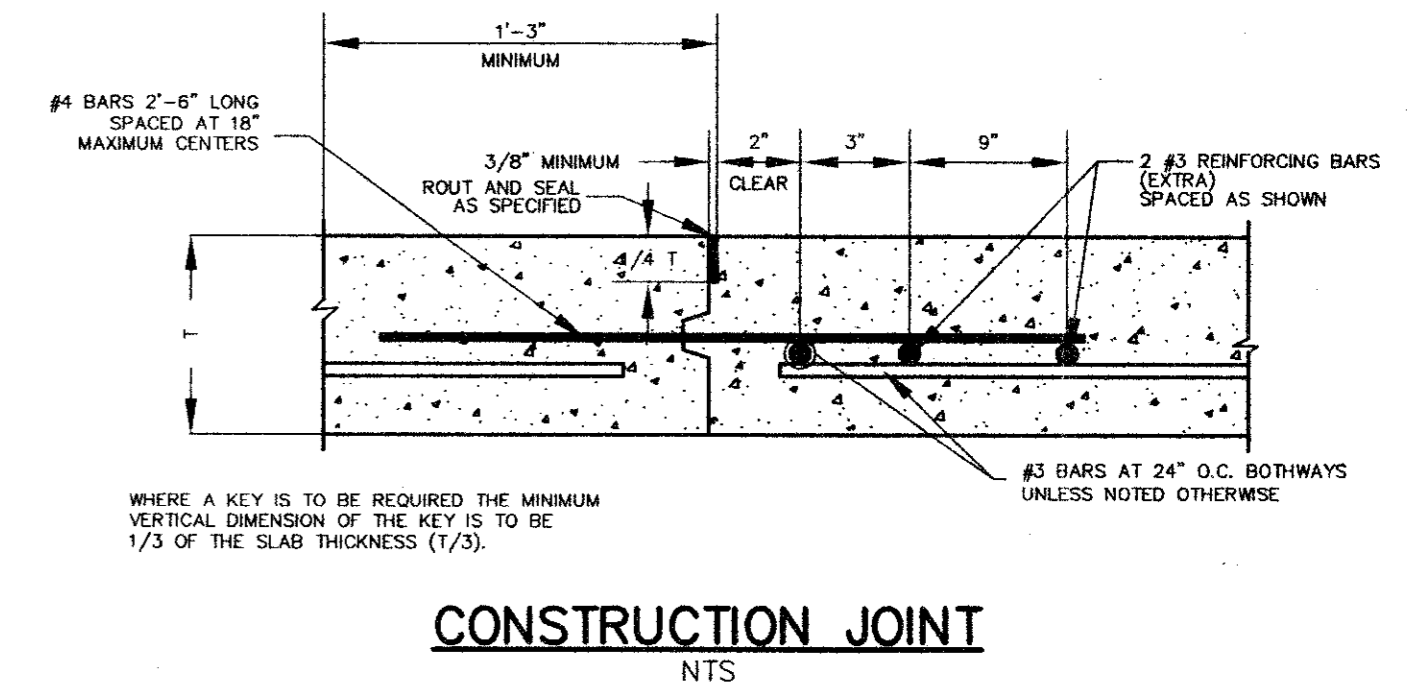
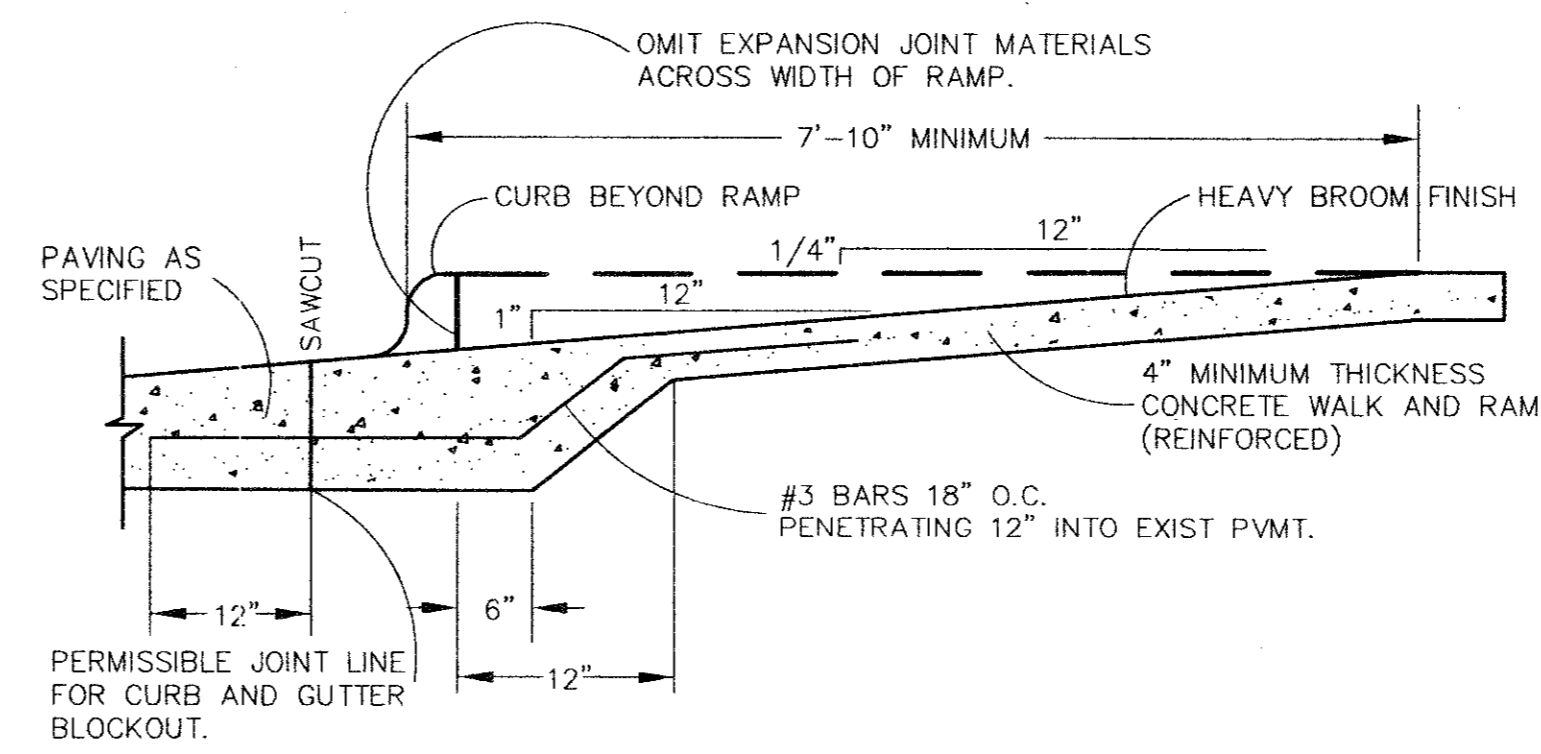
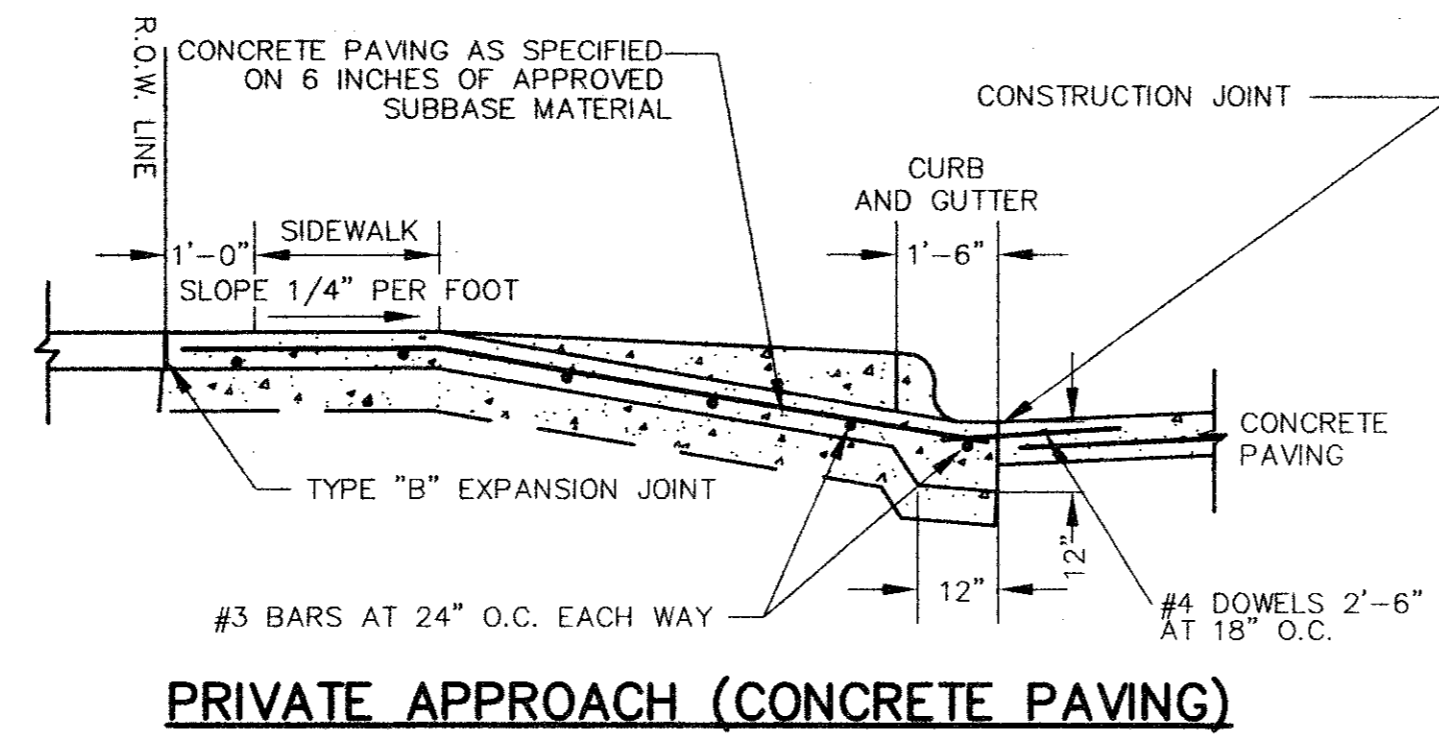

TYPICAL SECTION THRU RESIDENTIAL RAMP

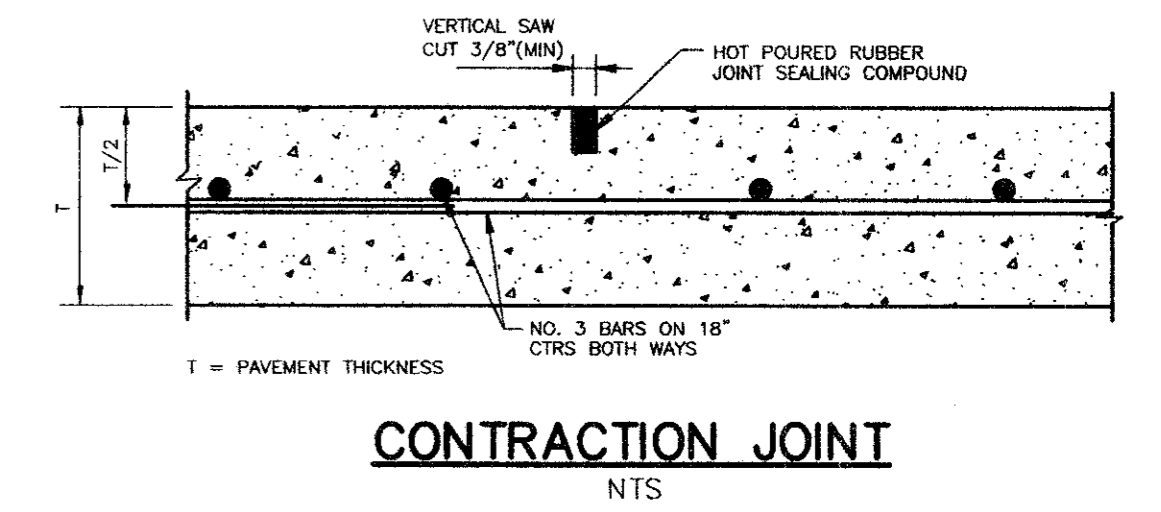
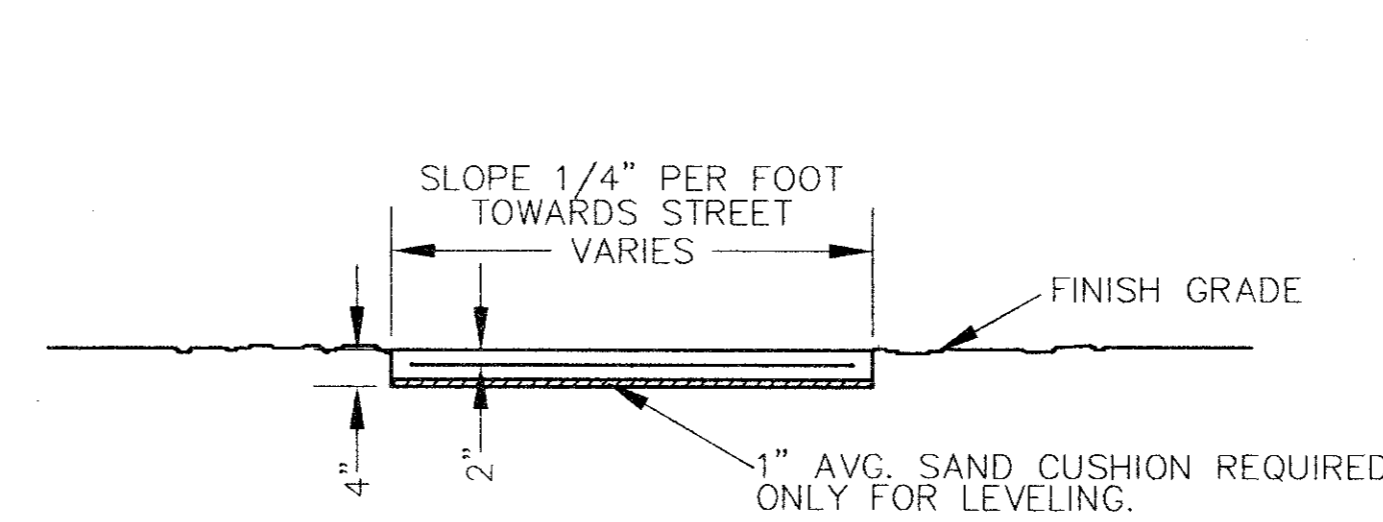

TYPICAL MARKING

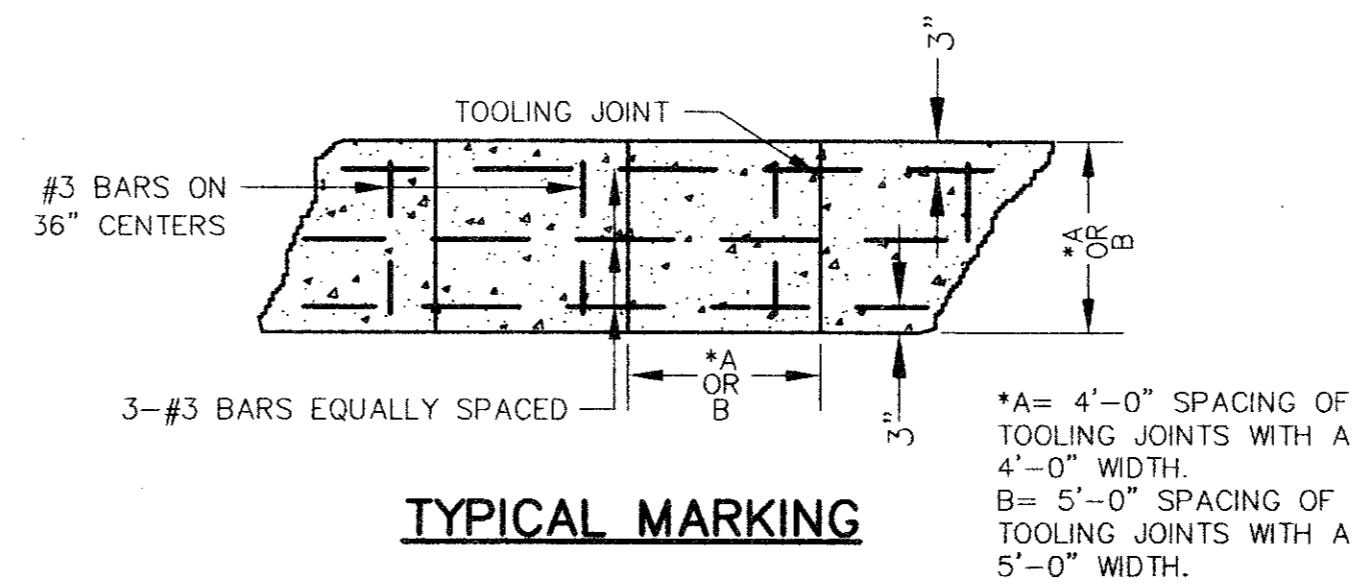

- ALL MARKINGS SHALL BE CUT 1" DEEP, FOLLOWED BY GROOVING TOOL. 1/2" PREMOLDED EXPANSION JOINT MATERIAL SHALL BE PLACED WHERE NEW WORK ABUTS OLD OR NEW WORK IS ADJACENT TO OTHER CONCRETE WORK, WALL, FOUNDATIONS, CURBS, ETC... MAXIMUM SPACING OF TRANSVERSE EXPANSION JOINTS SHALL BE 40'-0".
- GENERAL NOTES:**
- CONCRETE STRENGTH SHALL BE A MINIMUM OF 3000 P.S.I. AT 28 DAYS.
 - EXPANSION JOINTS SHALL BE 1/2" THICK REDWOOD FOR FULL DEPTH OF SIDEWALK AND SHALL INCLUDE GREASED 24" SMOOTH 1/2" DIA. DOWEL STEEL BARS WITH CAPS.

SIDEWALK DETAILS STEEL DETAILING
NTS

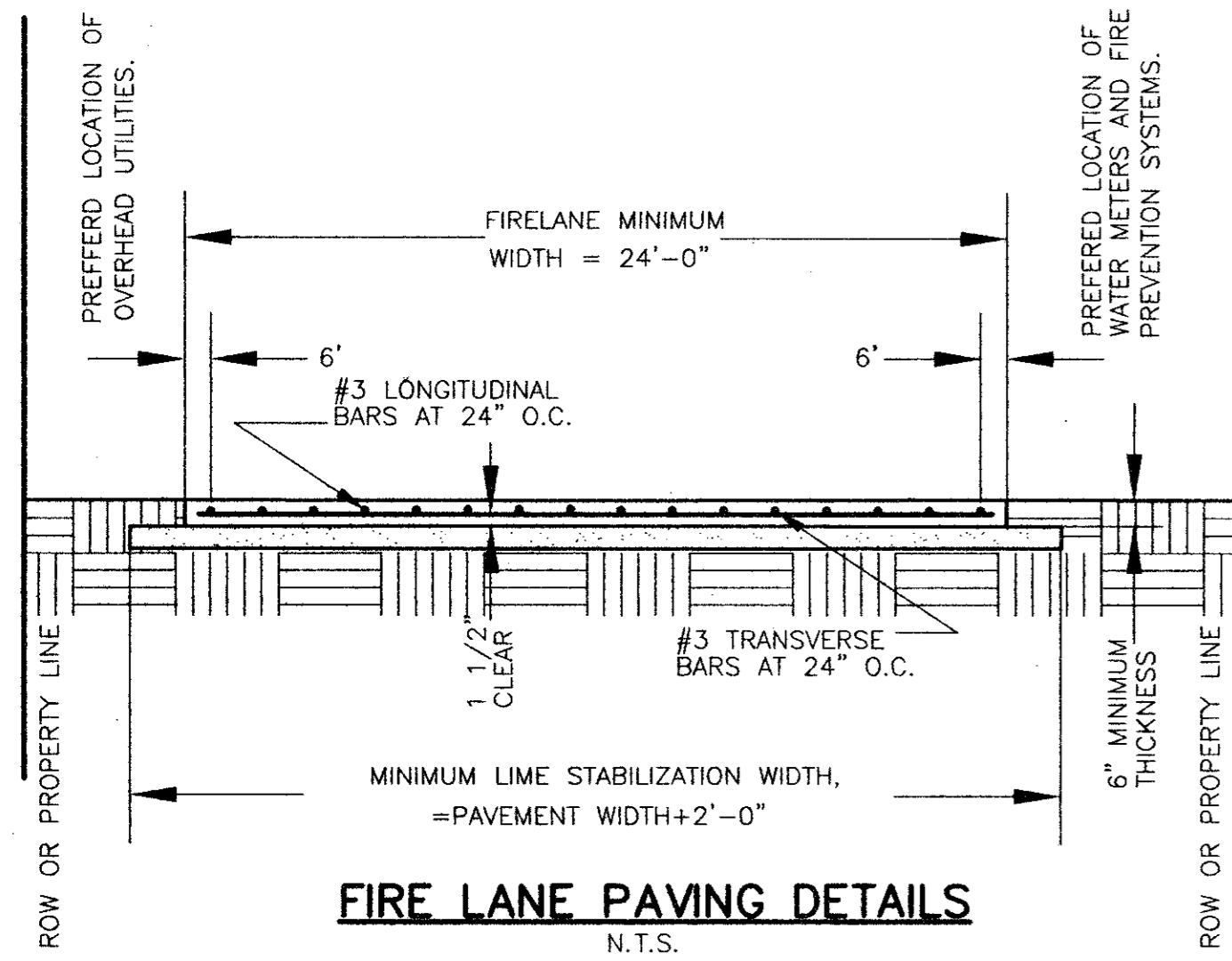

- GENERAL NOTES:**
- SEE PAVING IMPROVEMENT DETAIL GENERAL NOTES FOR HYDRATED LIME REQUIREMENTS FOR SOIL STABILIZATION AND DENSITY REQUIREMENTS. CONCRETE PAVING SHALL BE A MINIMUM FIVE AND ONE-HALF (5 1/2) SACK PER CUBIC YARD MIX WITH A MINIMUM FLEXURAL STRENGTH OF 650 P.S.I. AT 28 DAYS AND A MAXIMUM SLUMP OF 3 INCHES.
 - REINFORCING SHALL BE NEW BILLET STEEL ASTM A615 GRADE 60 REINFORCING BARS WHICH SHALL BE FREE OF RUST, LOOSE SCALE, PAINT, OIL OR OTHER FOREIGN SUBSTANCES WHICH SHALL PREVENT BONDING OF THE CONCRETE AND REINFORCING BARS.
 - EXPANSION JOINTS SHALL BE PROVIDED AT THE R.O.W. LINE OF THE FIRE LANE APPROACH AND AT A MAXIMUM OF 400 FOOT SPACINGS. TRANSVERSE SAW JOINTS SHALL BE PROVIDED AT 20' MAXIMUM SPACINGS.
 - WHERE A CURB IS USED, THE REQUIRED CLEARANCE SHALL BE MEASURED FROM THE CURB FACE TO ANY PERMANENT TRAFFIC OBSTACLE.

- GENERAL NOTES:**
- FOR REAR ENTRANCE DRIVE APPROACHES THE SIDEWALKS AND CURB RETURNS ARE TO BE OMITTED.
 - FOR CONSTRUCTION JOINT DETAILS SEE DRAWING P-10.
 - FOR EXPANSION JOINT DETAILS SEE DRAWING P-11.

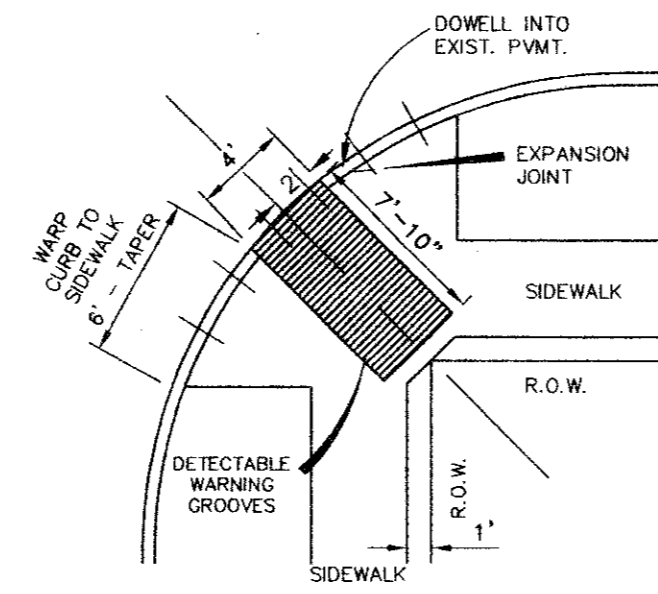

- GENERAL NOTES:**
- BARRIER FREE RAMPS SHALL BE CONSTRUCTED AS EXTENSIONS OF STANDARD CONCRETE SIDEWALKS EXCEPT AS NOTED IN THESE DETAILS.
 - MAXIMUM SLOPE ON BARRIER FREE RAMPS SHALL NOT EXCEED 1" PER FOOT ANY LOCATION.
 - DESIGNS SHOWN ARE FOR 6" CURBS. FOR CURBS WITH HEIGHT GREATER THAN 6", DIMENSIONS SHALL BE INCREASED PROPORTIONATELY.
 - STREETS ON STEEP GRADE WILL REQUIRE LONGER TRANSITIONS ON UPGRADE SIDE.
 - LOCATION OF BARRIER FREE RAMP MAY BE SHIFTED TO CLEAR OBSTRUCTIONS WITH THE APPROVAL OF THE CITY ENGINEER.
 - DETECTABLE WARNING GROVES SHALL BE 1/4" TO 3/4" WIDE, 1/8" DEEP, SPACED 3" TO 4 1/2" APART.

BARRIER FREE RAMP

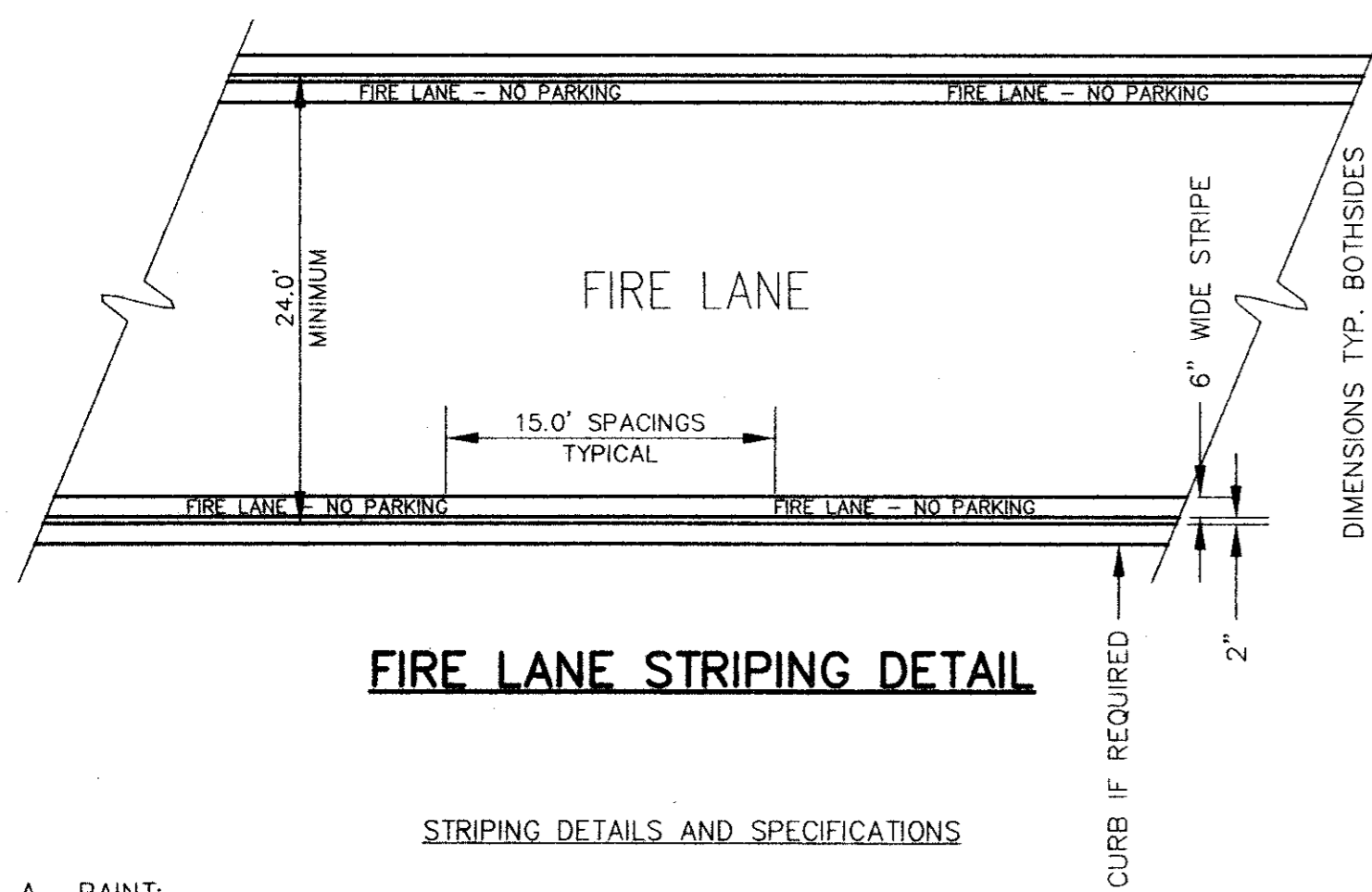

- A. PAINT:**
- STRIPES SHALL BE SIX(6) INCHES WIDE PAINTED WITH AN EXTERIOR ACRYLIC LATEX PAINT. COLOR SHALL BE "TRAFFIC RED" GILDDEN NO. 63251 OR EQUAL.
 - LETTERS SHALL BE FOUR(4) INCHES HIGH PAINTED WITH AN EXTERIOR ACRYLIC PAINT. COLOR SHALL BE "TRAFFIC WHITE" GILDDEN NO. 563245 OR EQUAL.
- B. APPLICATION:**
- STRIPES MAY BE BRUSHED OR SPRAYED. ONE COAT TO FINISH.
 - LETTERS SHALL BE STENCIL FORMED, BRUSH APPLIED AND SPACED AS DETAILED ON THIS SHEET.

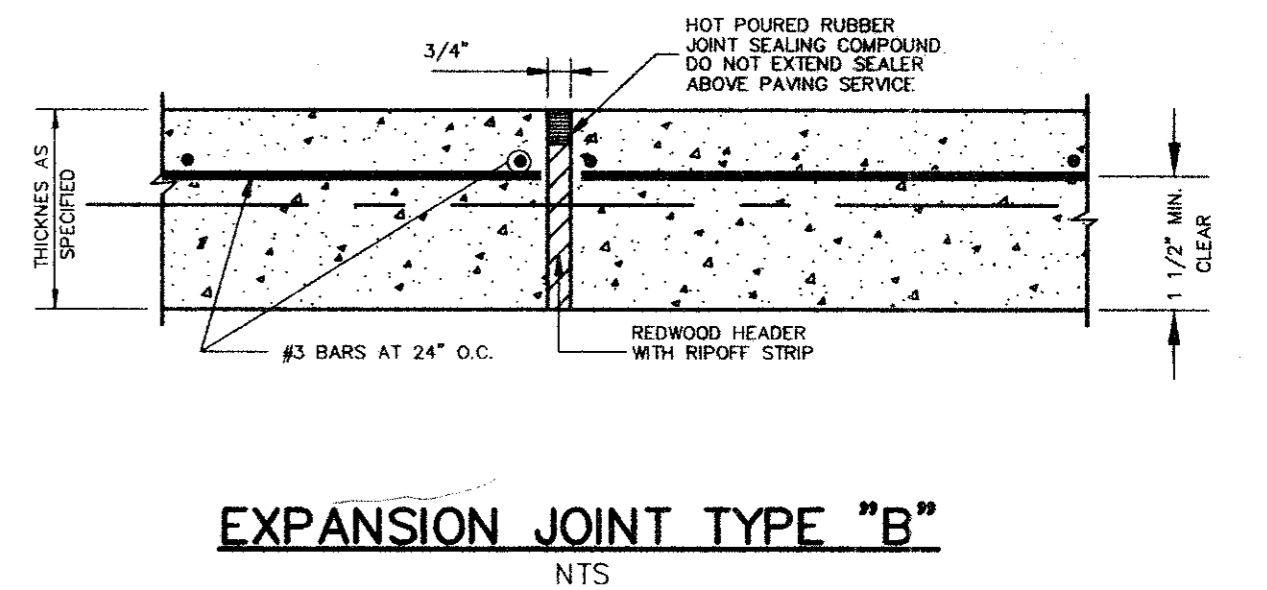

HCE Hickman Consulting Engineers, Inc.
1315 E. 10th Street, Suite 2A
Carrollton, Texas 76074
(972) 509-1544 • Fax (972) 578-0644
(800) 579-4367
E-MAIL: HCE@AOLMAIL.NET
Planners Engineers Surveyors

DETAILS
MAN'S BEST FRIEND
CARROLLTON, TEXAS
D/B CONSTRUCTORS, INC.
2400 GREAT SOUTHWEST PKWY.
FORT WORTH, TEXAS 76106

SCALE: AS SHOWN
DATE: JUNE 1999
DRAWN BY: A.B.C.
CHK'D BY: M.H.H.
JOB NO: 9001-73
FILE: 90017301.DWG
DATE SUBMITTED: 06/23/99(3)



REVISION	DATE	BY	DESCRIPTION