

- LEGEND**
- FIR Found Iron Rod
  - UP Utility Pole
  - LP Light Pole
  - A Anchor
  - FH Fire Hydrant
  - WM Water Meter
  - WV Water Valve
  - SS Sanitary Sewer
  - SD Storm Drain
  - RCP Reinforced Concrete Pipe
  - LL Landscape Light
  - DCVA Double Check Valve Assembly
  - TV Telephone Vault
  - TCM Telephone Cable Marker
  - 643 Ex. Contour
  - x643.1 Ex. Spot Elevation
  - 640.6 Proposed Spot Elevation
  - FF Finish Floor
  - TC Top of Curb
  - RW Retaining Wall
  - G Gutter

**WESTGROVE ROAD**  
(60' R.O.W.)

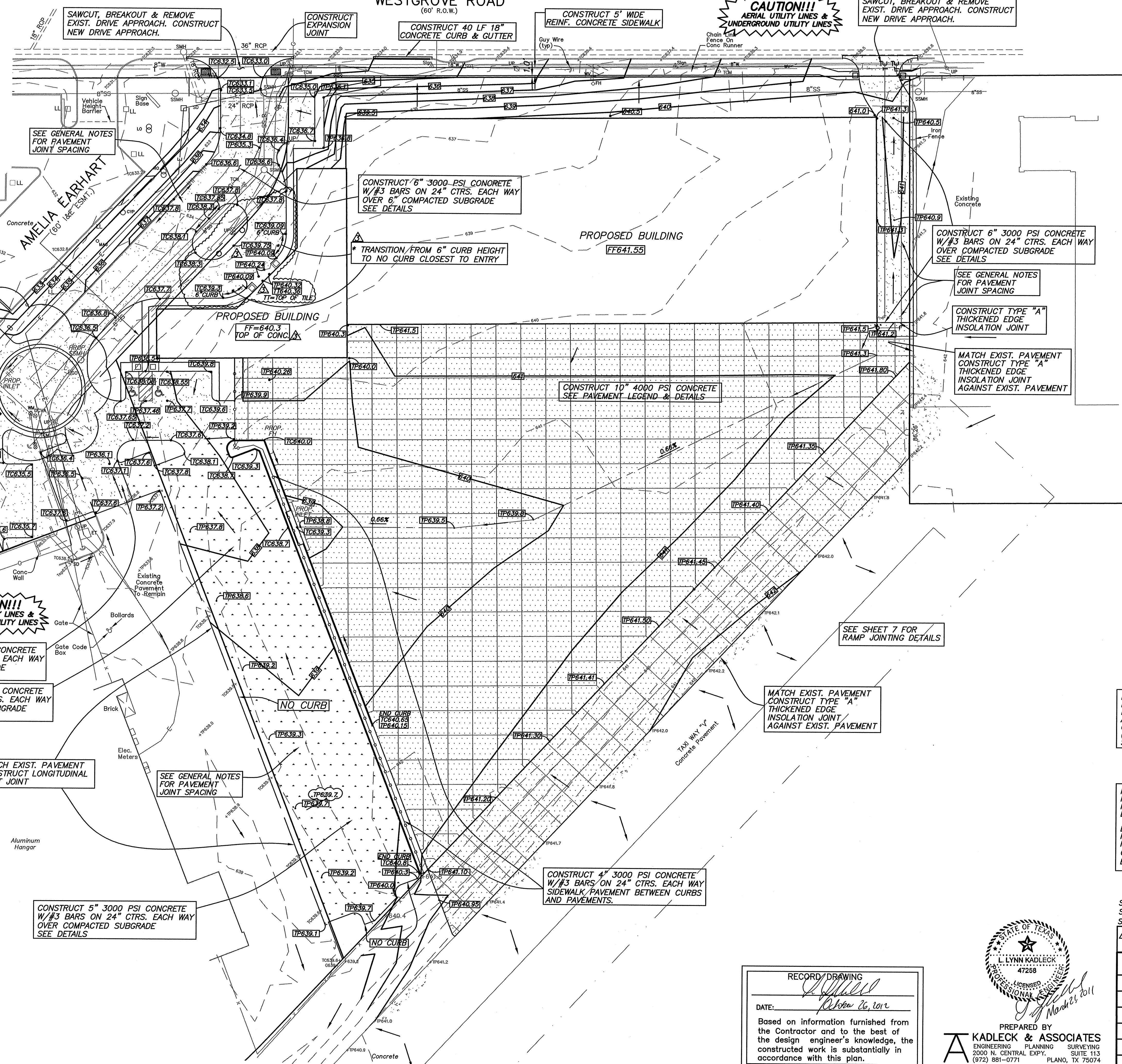

- PAVING LEGEND**
- RAMP PAVEMENT**  
10" 4000 PSI CONCRETE  
W/ #4 BARS ON 24" CTRS. EACH WAY OVER  
6" FLEXIBLE BASE TxDOT ITEM 247 GRADE 2,  
TYPE D OR BETTER, COMPACTED TO A MINIMUM  
95% OF MODIFIED PROCTOR (ASTM D 1557)  
AT OR ABOVE OPTIMUM MOISTURE. OVER  
6" SUBGRADE, SCARIFIED AND RECOMPACTED TO  
A MINIMUM OF 95% STANDARD PROCTOR  
ASTM D 698, AT OR ABOVE OPTIMUM MOISTURE.
  - HEAVY DUTY PAVEMENT**  
6" 3000 PSI CONCRETE  
W/ #3 BARS ON 24" CTRS. EACH WAY  
OVER 6" COMPACTED SUBGRADE  
SEE DETAIL SHEET
  - LIGHT DUTY PAVEMENT**  
5" 3000 PSI CONCRETE  
W/ #3 BARS ON 24" CTRS. EACH WAY  
OVER 6" COMPACTED SUBGRADE  
SEE DETAIL SHEET
  - EXISTING CONCRETE PAVEMENT**

SEE GRADING AND  
PAVING PLAN  
SHEET 6  
FOR THIS AREA

**CAUTION!!!**  
AERIAL UTILITY LINES &  
UNDERGROUND UTILITY LINES

NOTE: THE RAMP PAVING SECTION SHOWN HEREON WAS  
DESIGNED BY REED ENGINEERING GROUP USING THE  
FAARFIELD AIRPORT PAVEMENT DESIGN SOFTWARE IN  
ACCORDANCE WITH FEDERAL AVIATION ADMINISTRATION  
GUIDELINES OF ADVISORY CIRCULAR AC 150/5320-6E  
(AIRPORT PAVEMENT DESIGN AND EVALUATION) DATED  
SEPTEMBER 30, 2009.

NOTE: EXISTING FEATURES AND TOPOGRAPHIC  
INFORMATION SHOWN WAS FURNISHED BY OWNER  
FROM SURVEY PREPARED BY: BRAD SPARR  
DATED: \_\_\_\_\_

BENCH MARK:  
FOUND SQUARE CUT AT NORTHWEST CORNER OF BOX  
INLET, 13.5' SOUTH OF INTERSECTION OF SOUTH LINE  
OF WESTGROVE ROAD & EAST LINE OF AMELIA EARHART.  
ELEV. 632.80

SEE TOWN OF ADDISON CONSTRUCTION DETAILS  
SEE SHEET 7 FOR RAMP PAVEMENT JOINT LAYOUT  
SEE SHEETS 13 & 14 FOR DETAILS AND NOTES

REVISOR DEC. 13, 2011; REVISE GRADES AT ENTRY AND DROP OFF,  
ADD CURB TRANSITION AT ENTRY.

<b>GRADING &amp; PAVING PLAN</b>			
<b>MILLION AIR - PHASE TWO</b>			
<b>LEASE PARCEL No. 70-WESTGROVE RD.</b>			
<b>ADDISON MUNICIPAL AIRPORT</b>			
<b>TOWN OF ADDISON, TEXAS</b>			
DESIGN	DRAWN	DATE	SCALE
K&A	K&A	SEPT.2010	1"=40'
			PROJECT No. 10544

RECORD DRAWING  
*[Signature]*  
DATE: *October 26, 2012*

Based on information furnished from the Contractor and to the best of the design engineer's knowledge, the constructed work is substantially in accordance with this plan.

STATE OF TEXAS  
L. LYNN KADLECK  
47268  
LICENSED PROFESSIONAL ENGINEER

PREPARED BY  
**KADLECK & ASSOCIATES**  
ENGINEERING PLANNING SURVEYING  
2000 N. CENTRAL EXPY., SUITE 113  
(972) 691-0771 PLANO, TX 75074  
TBPE Reg. No. F-6480 TPLS Reg. No. 100955-00

5  
15

F:\10544-1\0544 Millon Air - Westgrove\CVL55 GRAD-PAV PLAN.dwg, 10/31/2012 1:30:26 PM