

**EXCESS EXCAVATION AREA (SPOIL AREA)**  
 THIS DITCH MAY BE USED FOR EXCESS EXCAVATION FROM DITCH CONSTRUCTION AT CONTRACTOR'S OPTION. DITCH MAY NOT BE FILLED IN UNTIL ALL CONSTRUCTION IS COMPLETE AND DITCH IS NO LONGER NEEDED FOR DRAINAGE PURPOSES. TOP BANK OF EXISTING DITCH WILL BE MAXIMUM HEIGHT OF SPOIL MATERIAL. AFTER SPOIL AREA IS FILLED TO MAXIMUM HEIGHT, CONTRACTOR SHALL HAUL OFF ANY ADDITIONAL SPOIL ACQUIRED IN DITCH EXCAVATION TO AN OFF-SITE AREA APPROVED BY ENGINEER. THE SPOIL AREA SHALL BE GRADED TO DRAIN IN A MANNER SATISFACTORY TO THE ENGINEER. NO ADDITIONAL COMPENSATION WILL BE ALLOWED IF SPOIL AREA IS NOT UTILIZED BY CONTRACTOR.

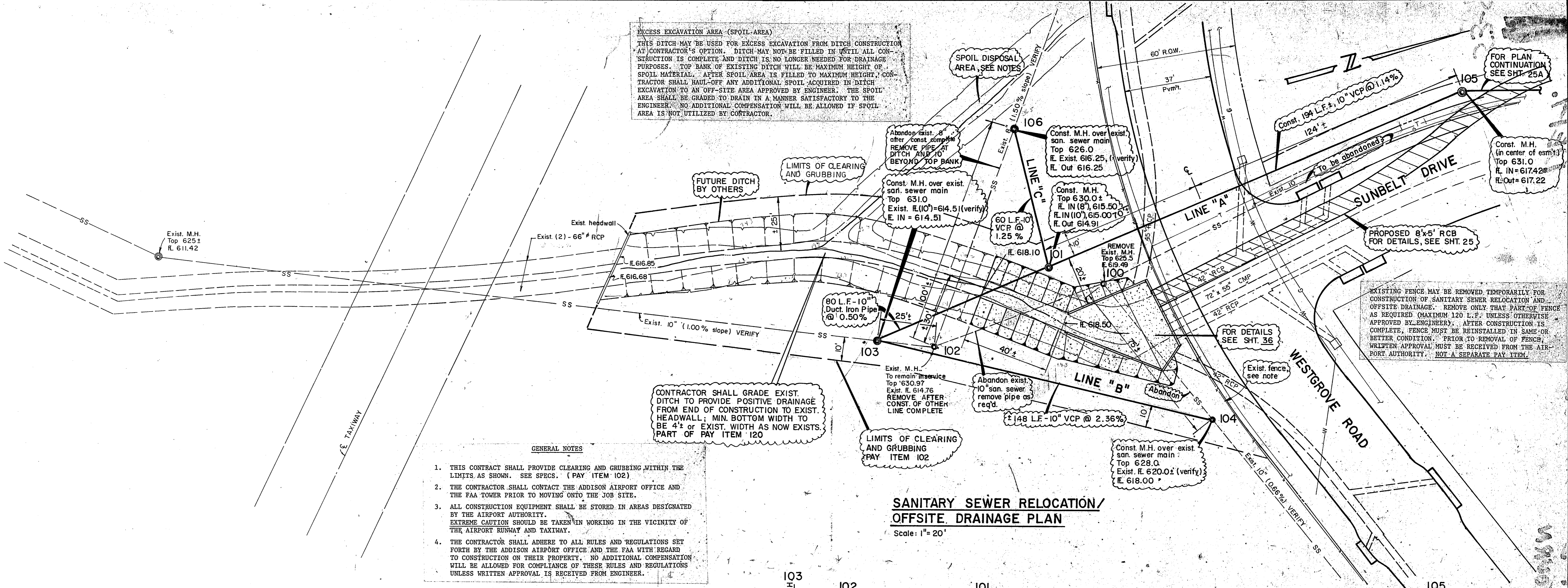

- GENERAL NOTES**
1. THIS CONTRACT SHALL PROVIDE CLEARING AND GRUBBING WITHIN THE LIMITS AS SHOWN. SEE SPECS. (PAY ITEM 102)
  2. THE CONTRACTOR SHALL CONTACT THE ADDISON AIRPORT OFFICE AND THE FAA TOWER PRIOR TO MOVING ONTO THE JOB SITE.
  3. ALL CONSTRUCTION EQUIPMENT SHALL BE STORED IN AREAS DESIGNATED BY THE AIRPORT AUTHORITY. EXTREME CAUTION SHOULD BE TAKEN IN WORKING IN THE VICINITY OF THE AIRPORT RUNWAY AND TAXIWAY.
  4. THE CONTRACTOR SHALL ADHERE TO ALL RULES AND REGULATIONS SET FORTH BY THE ADDISON AIRPORT OFFICE AND THE FAA WITH REGARD TO CONSTRUCTION ON THEIR PROPERTY. NO ADDITIONAL COMPENSATION WILL BE ALLOWED FOR COMPLIANCE OF THESE RULES AND REGULATIONS UNLESS WRITTEN APPROVAL IS RECEIVED FROM ENGINEER.

**SANITARY SEWER RELOCATION/  
 OFFSITE DRAINAGE PLAN**  
 Scale: 1" = 20'

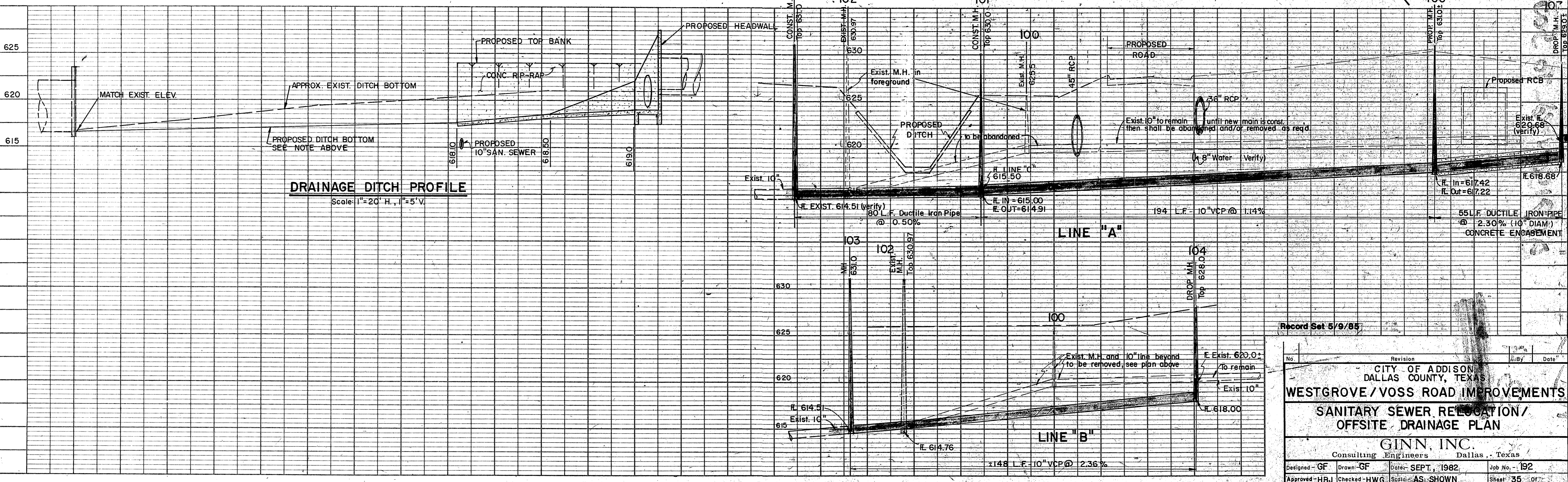

Record Set 5/9/85

No.	Revision	By	Date

CITY OF ADDISON  
 DALLAS COUNTY, TEXAS  
**WESTGROVE / VOSS ROAD IMPROVEMENTS**  
**SANITARY SEWER RELOCATION/  
 OFFSITE DRAINAGE PLAN**

**GINN, INC.**  
 Consulting Engineers Dallas, Texas

Designed - GF Drawn - GF Dates - SEPT., 1982 Job No. - 192  
 Approved - HBJ Checked - HWG Scale - AS - SHOWN Sheet 35 of 37