

ADDISON AIRPORT

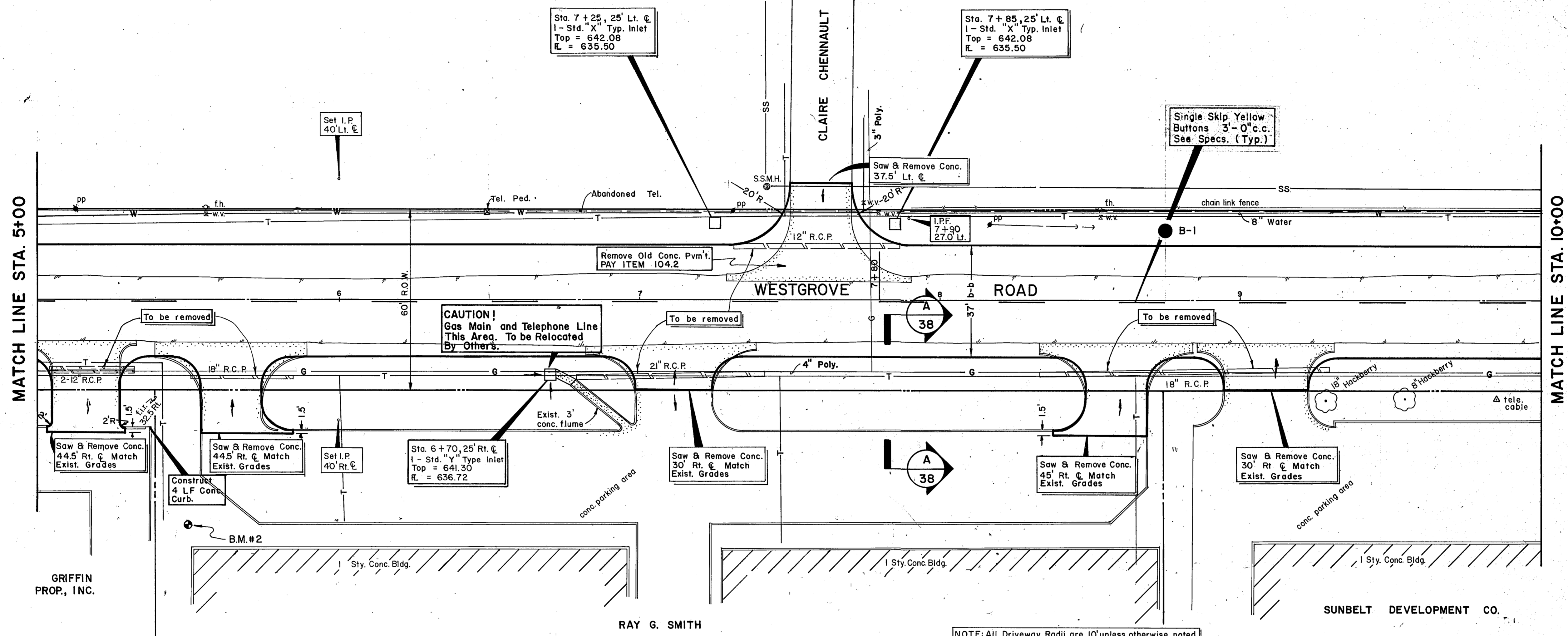

B.M. #2 - 2' x 2' cut on first step East corner. 4559 Westgrove Sta. 5+50±  
ELEV. 644.46

NOTE: All Driveway Radii are 10' unless otherwise noted

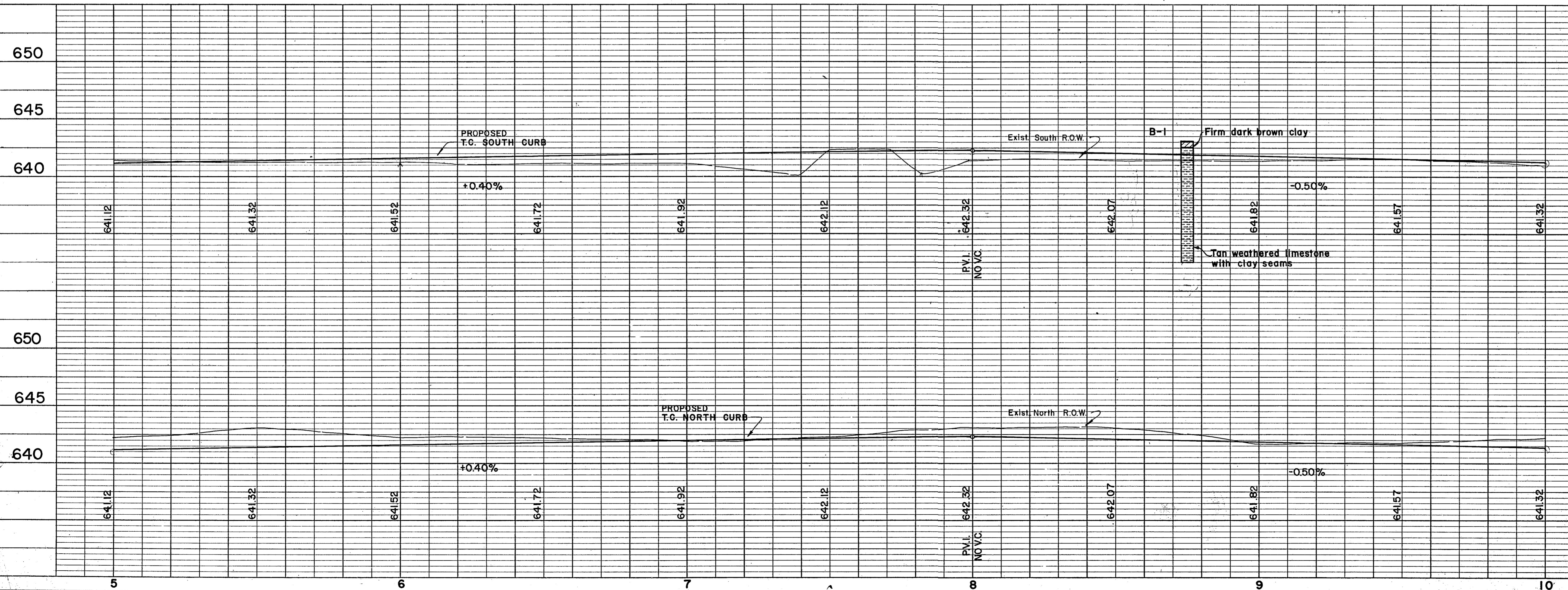

Record Set 5/9/85

NO.	REVISION	BY	DATE
CITY OF ADDISON DALLAS COUNTY, TEXAS			
<b>WESTGROVE/VOSS ROAD IMPROVEMENTS</b>			
PAVING Sta. 5+00 to 10+00			
<b>GINN, INC.</b> Consulting Engineers - Dallas, Texas			
DESIGNED - H.J.	DRAWN - RB/LA	DATE - SEPT., 1982	FILE - J-192
APPROVED - HWG	CHECKED - HBJ	SCALE - H-1"=20'/V-1"=5'	SHEET - 5 OF 5