

SIGN SPACING TABLE

POSTED SPEED LIMIT	30	40
DISTANCE (X) IN FEET	165'	295'

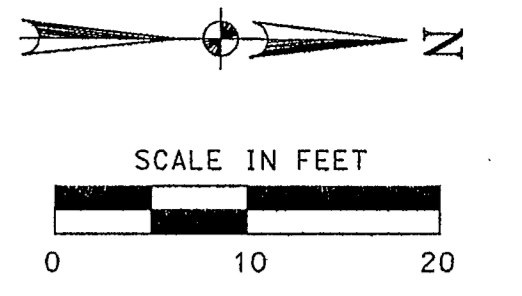

TRAFFIC CONTROL NOTES:

1. THE CONTRACTOR IS RESPONSIBLE FOR TRAFFIC HANDLING AND SAFETY IN THE CONSTRUCTION AREA DURING THE CONSTRUCTION PERIOD. SIGNS, BARRICADES AND OTHER NECESSARY DEVICES SHALL BE FURNISHED AND MAINTAINED IN COMPLIANCE WITH PART VI OF THE TEXAS MANUAL OF UNIFORM TRAFFIC CONTROL DEVICES. (CURRENT EDITION)
2. ALL PERMANENT AND/OR TEMPORARY STRIPING, MARKINGS, LIGHTS, SIGNS, AND BARRICADES SHALL BE PLACED AND MAINTAINED IN ACCORDANCE WITH THE TEXAS MANUAL OF UNIFORM TRAFFIC CONTROL DEVICES. (CURRENT EDITION)
3. CONTRACTOR IS TO COORDINATE WITH THE TOWN OF ADDISON FOR THE PLACEMENT AND OPERATION OF ALL TEMPORARY AND PERMANENT TRAFFIC SIGNALS AS TO ASSURE VISIBILITY TO AND SAFETY OF THE TRAVELING PUBLIC.
4. ADVANCED WARNING SIGNS SHALL BE MAINTAINED THROUGHOUT THE CONSTRUCTION PERIOD. ADDITIONAL SIGNS AND BARRICADES SHALL BE PLACED IN ACCORDANCE WITH THE STANDARD DETAILS AND AS DIRECTED BY THE ENGINEER TO PROTECT PEDESTRIANS AND THE TRAVELING PUBLIC.
5. ALL SIGNS THAT ARE NOT APPLICABLE FOR ANY ONE PHASE SHALL BE REMOVED OR COVERED.
6. ALL TEMPORARY STRIPING AND MARKINGS FOR TRAFFIC CONTROL DURING CONSTRUCTION SHALL NOT BE PAID FOR SEPARATELY BUT WILL BE INCIDENTAL TO MAINTENANCE OF TRAFFIC.
7. THE PROJECT SIGNS (2) SHALL CLEARLY INDICATE INVOLVED AGENCIES (DART, TOWN OF ADDISON, ETC.) AND SHALL BE PLACED AT BOTH ENDS OF THE PROJECT.

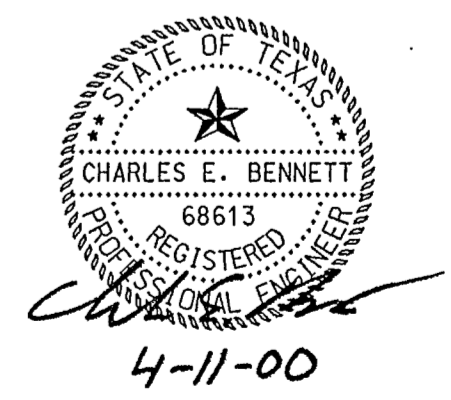
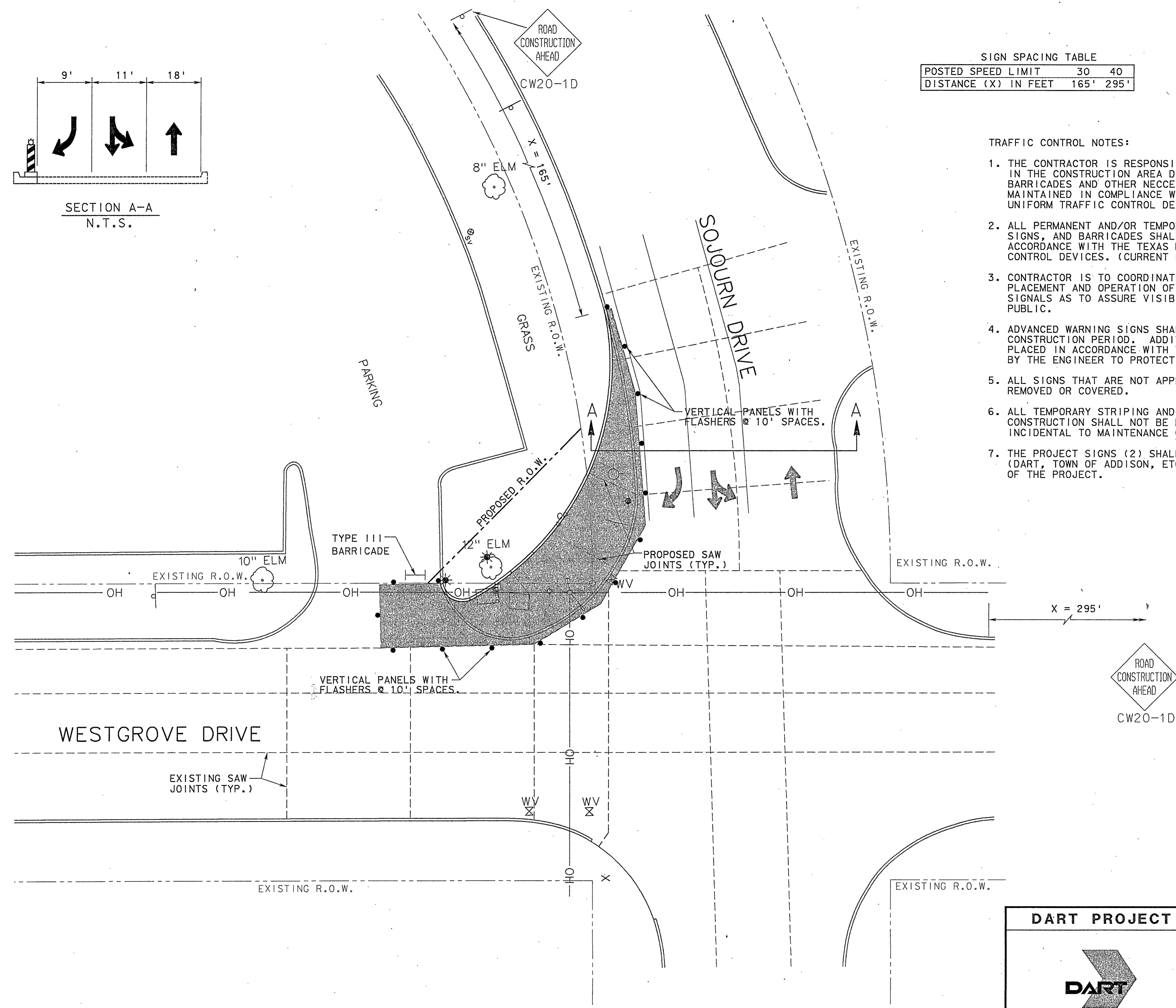

	DART PROJECT					
	INTERSECTION IMPROVEMENTS SOJOURN DR. AT WESTGROVE DR.					
	TOWN OF ADDISON TRAFFIC CONTROL SHEET					
DESIGNED	DRAWN	CHECKED	DATE	SCALE	SHEET NO.	
CAJ	CAJ	CEB	4/11/00	1" = 20'	6 OF 6	

Filename: E:\TRANS\Draw\H04\To6\Microsta\Sheets\soj\traf.dgn