

CAUTION:!!!
 CONTRACTOR SHALL VERIFY AND COORDINATE CONSTRUCTION ACTIVITY W/ THE AIRPORT PRIOR TO INITIATION OF WORK IN THIS AREA. CALL AIRPORT MANAGER AT (972) 392-4850.

NOTE:
 CONTRACTOR SHALL MAINTAIN AIRPORT SECURITY AT ALL TIMES. ALL FENCE(S) AND GATE(S) SHALL BE CLOSED AT ALL TIMES. IN AN EVENT THAT THE FENCE(S) OR GATE(S) ARE TO BE OPEN, A GUARDMAN SHALL BE USED IN ORDER TO PROVIDE APPROPRIATE SECURITY.

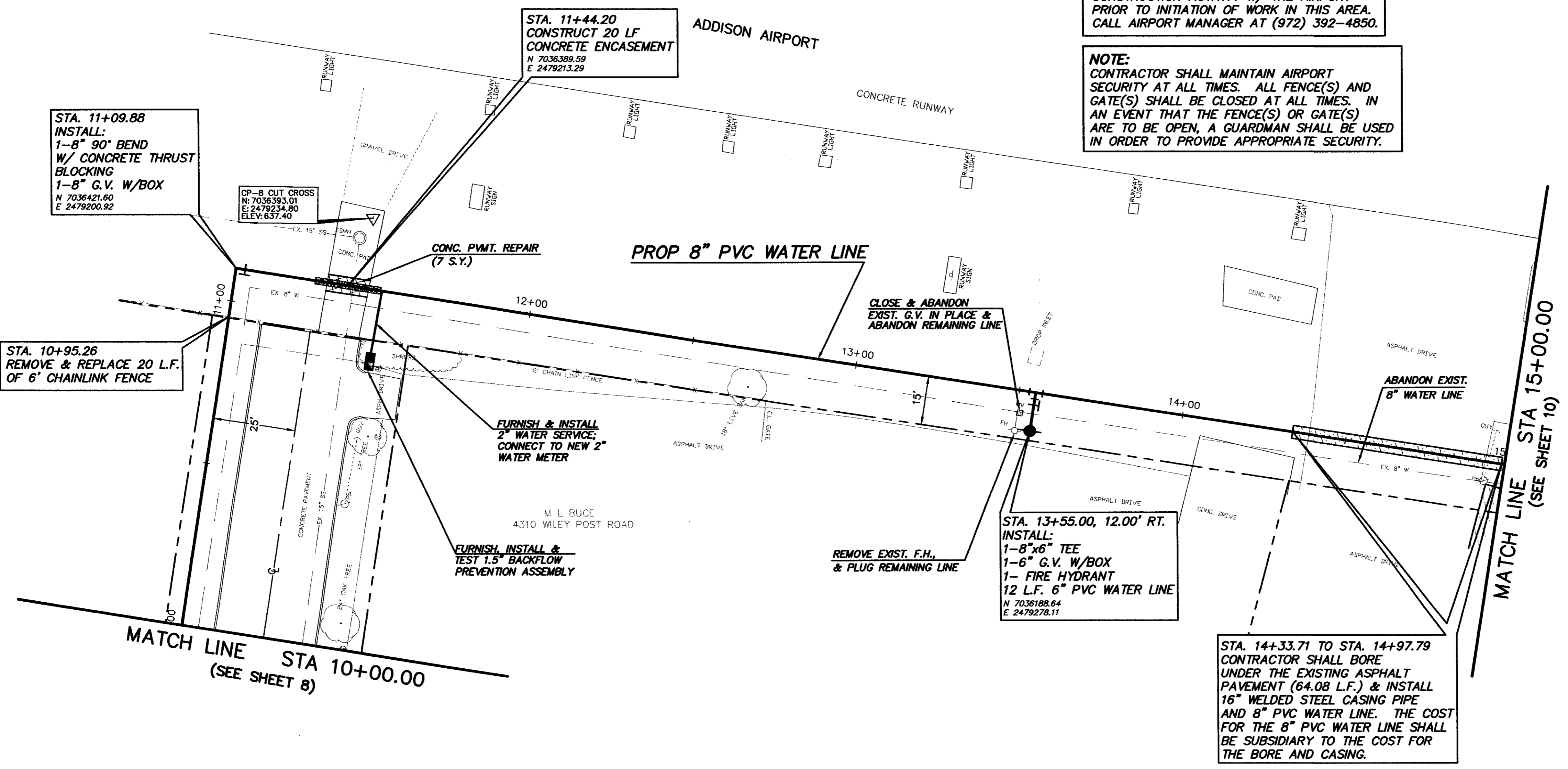

- NOTES:**
- EXISTING GAS SERVICES ARE PRESENT; EXACT LOCATIONS NOT KNOWN.
 - THE CONTRACTOR SHALL PRESERVE AND PROTECT EXISTING DRIVEWAYS AT ALL TIMES DURING CONSTRUCTION.
 - THE CONTRACTOR SHALL MAINTAIN WATER SERVICE AT ALL TIMES DURING CONSTRUCTION. SEE NOTE #4 ON GENERAL NOTES & LEGEND SHEET.
 - THE CONTRACTOR SHALL TAKE THE NECESSARY PRECAUTIONS TO PROTECT ALL OVERHEAD UTILITIES FROM DAMAGE. REPAIR OF DAMAGED UTILITIES WILL BE AT THE CONTRACTOR'S OWN EXPENSE.
 - THE CONTRACTOR SHALL BE RESPONSIBLE FOR MAKING SERVICE CONNECTIONS TO ALL NEW WATER METERS. IF SERVICE CONNECTION CROSSES STREET, THE CONTRACTOR SHALL BORE UNDER THE STREET IN ORDER TO MAKE THE CONNECTION.

WILEY POST ROAD - ADDISON AIRPORT

B.M.:

CROSS CUT SET IN THE SOUTH EDGE OF A DRIVEWAY IN THE NORTH SIDE OF WRIGHT BROTHERS 293' EAST OF THE EAST EDGE OF MIDWAY AND 23' NORTH OF THE CURB LINE OF WRIGHT BROTHERS DRIVE. ELEV.=646.99

BOX CUT IN THE CENTER OF AN INLET AT THE NORTHEAST CORNER OF WILEY POST AND MIDWAY ALONG THE NORTH SIDE OF WILEY POST. ELEV.=631.53

CUT CROSS FOUND AT THE SOUTH SIDE OF WILEY POST ROAD AT THE PROJECTION OF CENTERLINE OF WRIGHT BROTHERS ROAD 12.6' WEST OF A 4' INLET. ELEV.=637.24

NO.	REVISION	BY	DATE

MSW
DESIGNED
DAS
DRAWN
JRP
CHECKED

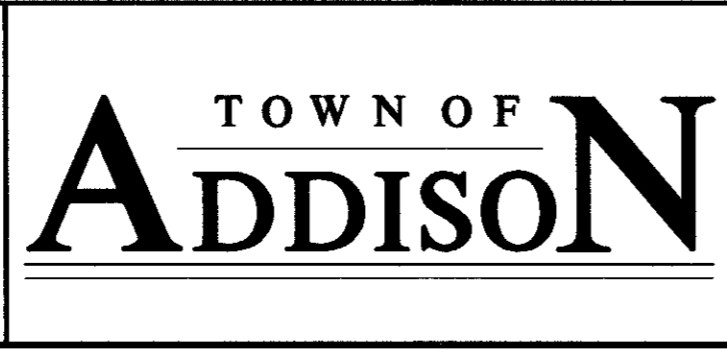

SCALE
HORIZ
1"=20'
VERT
N/A
DATE
JULY 2002

TEAGUE NALL AND PERKINS
 CONSULTING ENGINEERS

1100 Macon Street Fort Worth, Texas 76102 (817) 336-5773

2001 West Irving Blvd Irving, Texas 75061 (972) 254-1765

TOWN OF ADDISON
 WRIGHT BROTHERS / WILEY POST
WATER LINE REPLACEMENT
 WATER LINE PLAN - WILEY POST
 STA. 10+00.00 TO STA. 15+00.00

TNP PROJECT
ADD01333
SHEET
9
OF
12

C:\LDD\ADD01333\dwg\sheet\W-P&P7.DWG, 07/11/2002, 05:25:49 PM, HP1050C.p3