

# GENERAL NOTES

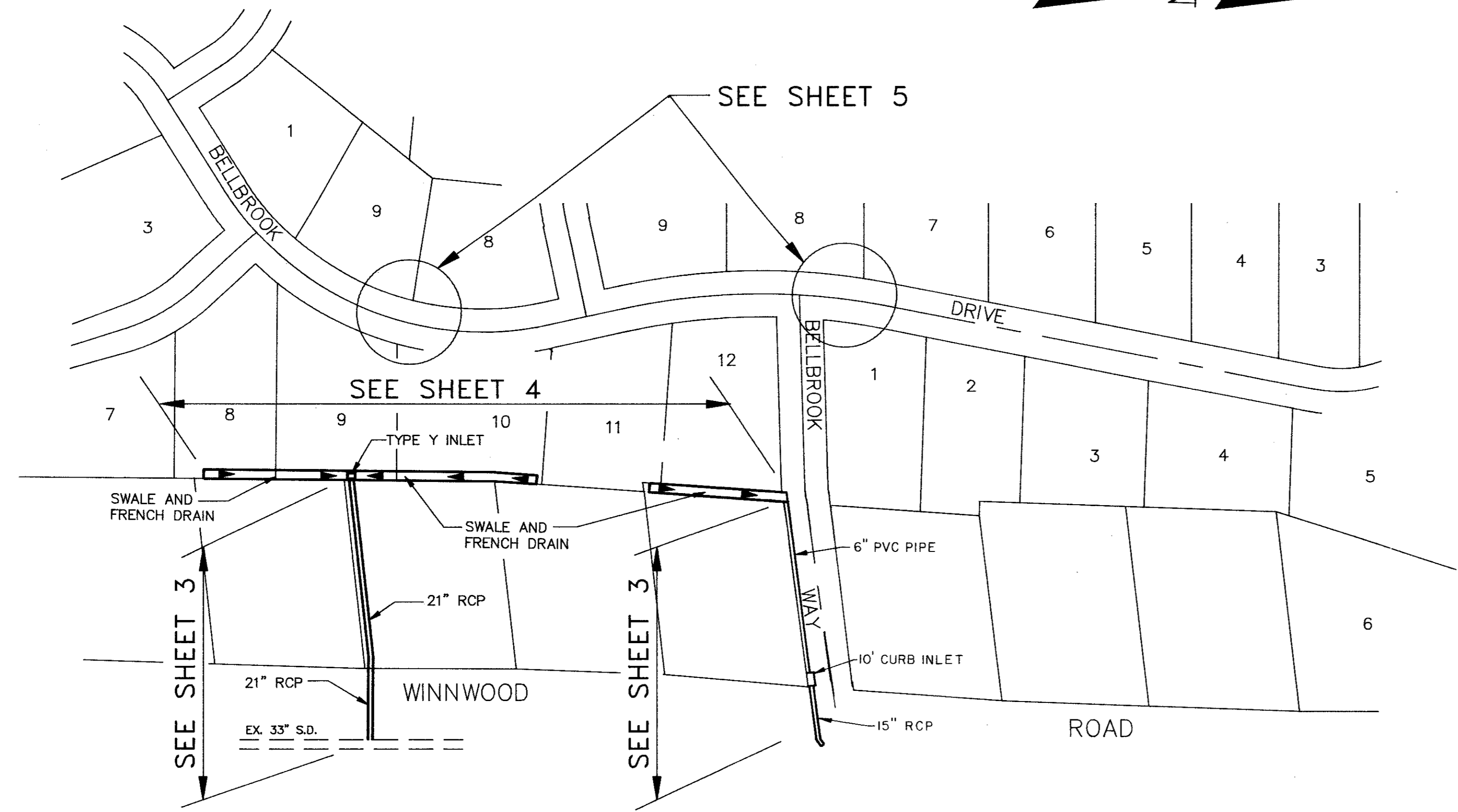

### PROJECT LAYOUT

#### LIST OF BENCHMARKS

B.M. #6:  
RAILROAD SPIKE FOUND IN A POWER POLE ON THE SOUTH SIDE OF CELESTIAL ROAD 400'± EAST OF THE SOUTHWEST PROPERTY CORNER, FIRST POLE EAST OF BELLBROOK DRIVE. ELEVATION = 603.83

B.M. #10:  
RAILROAD SPIKE FOUND IN A POWER POLE 20'± WEST OF THE SOUTHEAST LOT CORNER OF NAN'S LITTLE ACRE ADDITION; SAME CORNER BEING 57'± SOUTH OF THE NORTHEAST CORNER OF LOT 9 OF BELLBROOK ESTATES. ELEVATION = 567.28

B.M. #11:  
BOX SET IN THE NORTH RIM OF A SANITARY SEWER MANHOLE 5' SOUTH OF THE SOUTH CURB LINE OF BELLBROOK WAY, NEAR THE NORTHEAST CORNER OF LOT 12 OF BELLBROOK ESTATES. ELEVATION = 567.70

#### LEGEND

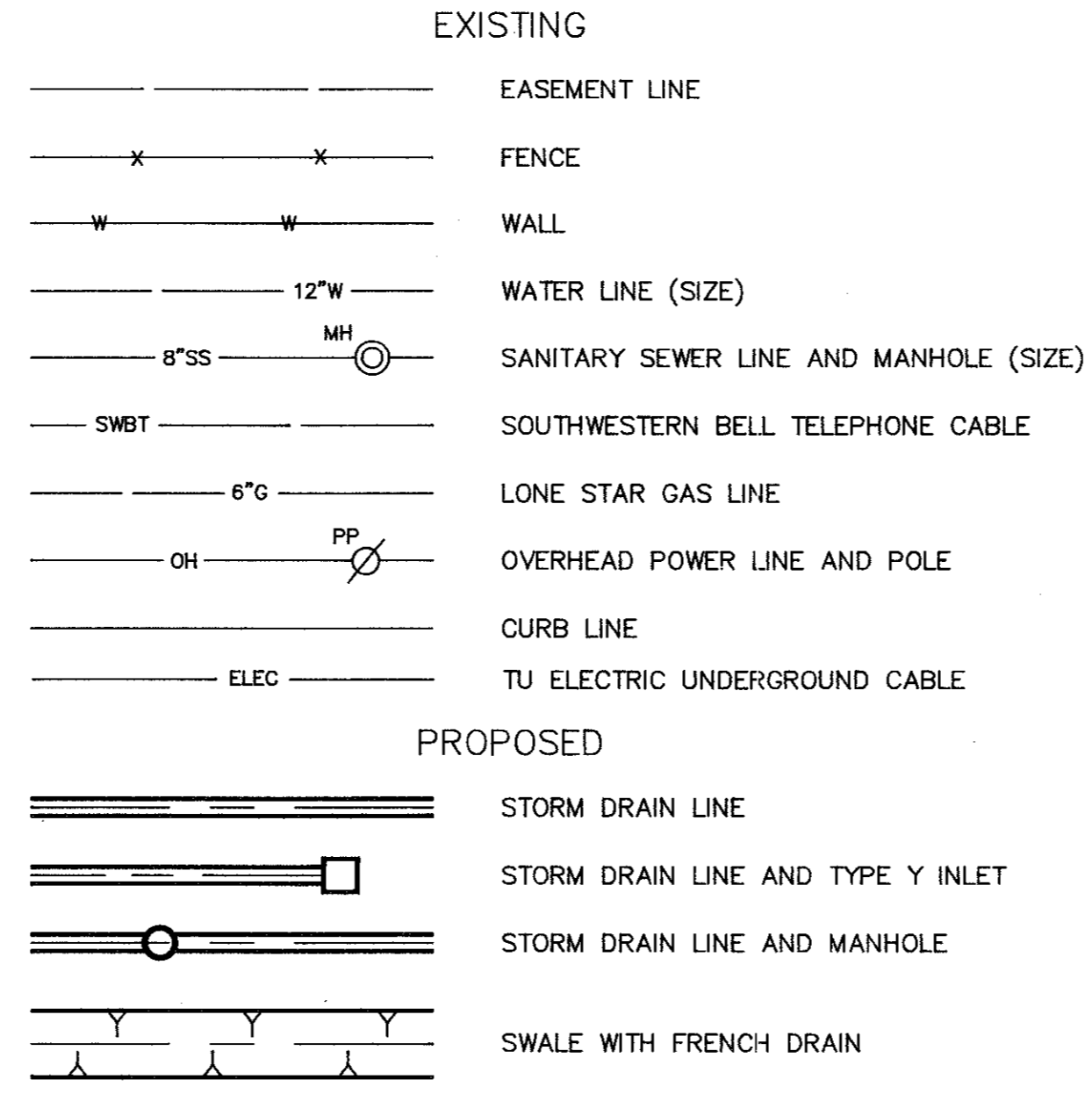

1. ALL CONSTRUCTION SHALL BE PERFORMED IN ACCORDANCE WITH THE CITY OF DALLAS 251-D STANDARDS AND SPECIFICATIONS. USE TOWN OF ADDISON STANDARD INLET FRAME & COVER ON ALL MANHOLES AND INLETS.
2. CONTRACTOR SHALL NOT PLACE FILL OR WASTE MATERIAL ON ANY PRIVATE PROPERTY WITHOUT PRIOR WRITTEN AGREEMENT WITH THE PROPERTY OWNER. NO EXCESS EXCAVATED MATERIAL SHALL BE DEPOSITED IN LOW AREAS OR ALONG NATURAL DRAINAGE WAY WITHOUT WRITTEN PERMISSION FROM THE ENGINEER. IF THE CONTRACTOR PLACES EXCESS MATERIAL IN AREAS WITHOUT WRITTEN PERMISSION, HE WILL BE RESPONSIBLE FOR ALL DAMAGE RESULTING FROM SUCH FILL AND HE SHALL REMOVE THE MATERIAL AT HIS OWN COST IF THE TOWN SO DIRECTS.
3. NO TREES SHALL BE CUT EXCEPT ON SPECIFIC AUTHORITY OF THE TOWN.
4. ALL CONCRETE SHALL HAVE A MINIMUM COMPRESSIVE STRENGTH OF 3,000 PSI AT 28 DAYS UNLESS OTHERWISE NOTED.
5. ALL REINFORCING STEEL AND DOWEL BARS IN PAVEMENT SHALL BE SUPPORTED AND MAINTAINED AT THE CORRECT CLEARANCES BY THE USE OF BAR CHAIRS OR OTHER APPROVED SUPPORT.
6. THE CONTRACTOR SHALL NOTIFY THE DALLAS WATER UTILITIES DISTRIBUTION DIVISION, 670-8543, AND THE WASTEWATER COLLECTION DIVISION, 670-7440, AT LEAST 48 HOURS PRIOR TO START OF ANY CONSTRUCTION THAT MIGHT AFFECT THEIR FACILITIES.
7. THE CONTRACTOR SHALL CONSTRUCT UTILITY SUPPORTS FOR EXISTING WATER MAINS AND SANITARY SEWERS WHERE DIRECTED BY THE ENGINEER. ALL SUCH UTILITY SUPPORTS SHALL BE INCIDENTAL ON THIS PROJECT. NO PAY ITEMS WILL BE PROVIDED.
8. STANDARD DEPTH OF INLETS IS 4.0 FEET, EXCEPT AS SHOWN OTHERWISE. DEPTH MAY BE VARIED TO CLEAR UTILITIES.
9. LOCATION OF ALL UNDERGROUND UTILITIES IN THE AREA OF SWALE, FRENCH DRAIN AND STORM DRAIN CONSTRUCTION AND OTHER AREAS OF POSSIBLE CONFLICT WILL BE UNCOVERED TO DETERMINE EXACT LOCATIONS PRIOR TO START OF CONSTRUCTION.
10. ALL STORM DRAIN PIPE WILL BE INSTALLED ACCORDING TO THE REQUIREMENTS OF THE SPECIFICATIONS.
11. ALL BARRICADES, WARNING SIGNS, LIGHTS, DEVICES, ETC., FOR THE GUIDANCE AND PROTECTION OF TRAFFIC AND PEDESTRIANS MUST CONFORM TO THE INSTALLATION SHOWN IN THE 1980 TEXAS MANUAL OF UNIFORM TRAFFIC CONTROL DEVICES, AS CURRENTLY AMENDED, TEXAS STATE DEPARTMENT OF HIGHWAYS AND PUBLIC TRANSPORTATION.
12. THE CONTRACTOR IS RESPONSIBLE FOR KEEPING STREETS AND SIDEWALKS ADJACENT TO PROJECT FREE OF MUD AND DEBRIS FROM CONSTRUCTION ON A DAILY BASIS.
13. HAND FINISH OF CONCRETE PAVEMENT SHALL NOT BE A SEPERATE PAY ITEM ON THIS PROJECT.
14. ACCESS TO ABUTTING PROPERTY DURING THE CONSTRUCTION OF THIS PROJECT MUST BE MAINTAINED FOR EMERGENCY TRAFFIC.
15. NO STOP OR YIELD SIGN IS TO BE RELOCATED OR REMOVED WITHOUT PRIOR APPROVAL BY THE TOWN.
16. ADJUSTMENT OF UNPAVED SURFACES TO GRADE AND RESTORATION OF THE SURFACE TO EQUAL OR BETTER THAN THE ORIGINAL WILL BE INCIDENTAL ON THIS PROJECT. NO PAY ITEMS WILL BE PROVIDED.
17. VERIFY LOCATIONS OF TU ELECTRIC COMPANY UNDERGROUND FACILITIES BEFORE BEGINNING EXCAVATION. CONTACT TU ELECTRIC AT 323-8910 48 HOURS PRIOR TO BEGINNING CONSTRUCTION SO THAT THE LOCATION OF UNDERGROUND LINES CAN BE MARKED.
18. PRIOR TO BEGINNING CONSTRUCTION IN THE AREA OF SOUTHWESTERN BELL TELEPHONE UNDERGROUND FACILITIES, CALL 998-4102 48 HOURS IN ADVANCE OF WORK. IF NECESSARY, TEST DITCHES WILL BE DUG TO VERIFY ACTUAL LOCATIONS AND CONDITIONS.
19. CONTACT STORER CABLE AT 840-2388 48 HOURS PRIOR TO BEGINNING CONSTRUCTION SO THAT THE LOCATION OF UNDERGROUND LINES CAN BE MARKED.
20. CONTACT LONE STAR GAS COMPANY AT 263-DIGG 48 HOURS PRIOR TO BEGINNING CONSTRUCTION SO THAT THE LOCATION OF UNDERGROUND LINES CAN BE MARKED.
21. STREET NAME SIGNS WILL BE RELOCATED BY THE CONTRACTOR. THE CONTRACTOR WILL BE REQUIRED TO GIVE 5 DAYS NOTICE IN ADVANCE OF THE TIME A STREET SIGN MUST BE RELOCATED TO CLEAR CONSTRUCTION OPERATIONS.
22. REMOVAL AND REPLACEMENT OF FENCE WILL BE INCIDENTAL ON THIS PROJECT. NO PAY ITEMS WILL BE PROVIDED. ANY DAMAGE TO EXISTING FENCING SHALL BE REPAIRED AT THE CONTRACTORS EXPENSE.
23. THE CEMENT CONTENT FOR PAVEMENT WILL BE INCREASED TO 6 BAGS PER CUBIC YARD TO ENABLE EARLIER OPENING OF THE STREET TO TRAFFIC, IF NECESSARY. NO SEPERATE OR ADDITIONAL PAY WILL BE PROVIDED.
24. WHEN EXCAVATING NEAR POWER POLES, CONTRACTOR SHALL ARRANGE AND PAY FOR HAVING POLES SUPPORTED IN PLACE. NO SEPERATE OR ADDITIONAL PAY WILL BE PROVIDED.
25. LOCATION OF ALL UTILITIES IS APPROXIMATE. CONTRACTOR TO LOCATE, PROTECT AND REPAIR AT HIS EXPENSE ALL UTILITIES.
26. THE CONTRACTOR SHALL OBTAIN ALL NECESSARY PERMITS AT LEAST 48 HOURS PRIOR TO START OF ANY CONSTRUCTION.
27. CONTRACTOR SHALL EXERCISE REASONABLE CARE TO PREVENT UNNECESSARY DAMAGE TO TREES AND SHRUBS. WHERE REQUIRED, REPLACEMENT OR RESTORATION OF TREES AND SHRUBS SHALL BE PERFORMED BY THE TOWN OF ADDISON.

NO	REVISION	BY	DATE

DESIGNED BY: E.H.&A.  
 DRAWN BY: E.H.&A.  
 CHECKED BY: B. GRANTHAM  
 SCALE: 1" = 100'  
 DATE: MAY 1990

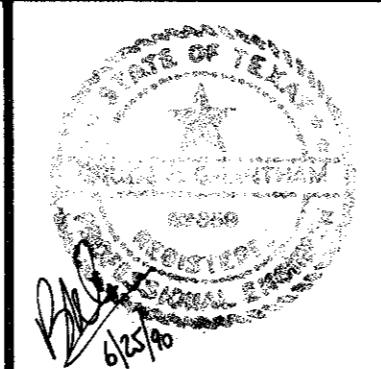

**ESPEY, HUSTON & ASSOCIATES, INC.**  
*Engineering & Environmental Consultants*  
 17811 Waterview Parkway Dallas, Texas 75252  
 (214) 669-9600

**PROJECT LAYOUT/NOTES**  
 WINNWOOD/BELLBROOK DRAINAGE  
 for  
 THE TOWN OF ADDISON

SHEET NO. 2  
 OF 6 SHEETS  
 JOB NO. 12552