

| PAY ITEM | DESCRIPTION  | UNIT | QTY  |
|----------|--|------|------|
| 100.1    | PREPARE R.O.W.                                     | STA  | 3.54 |
| 110.1    | ROADWAY EXCAVATION                                 | CY   | 300  |
| 260.1    | LIME TREATMENT                                     | SY   | 753  |
| 260.2    | HYDRATED LIME                                      | TON  | 10.2 |
| 340.1    | 2" HMA CP, TYPE B, 220#/SY                         | TON  | 26.6 |
| 360.1    | 6" REINF. CONC. PAVT. W/INTEGRAL CURB              | SY   | 687  |
| 502.1    | BARRICADES   | LS   | 1    |
| 470.7    | 5' CURB INLET (MOD)                                | EA   | 1    |
| 465.0    | 18" RCP, CL III                                    | LF   | 31   |
| 530.1    | 6" REINF. CONC. DRIVE                              | SY   | 95   |
| 104.1    | SAWCUT   | LF   | 10   |
| 104.2    | REMOVE OLD CONC.                                   | SY   | 44   |
| 496.1    | EXCAVATION & REMOVAL OF TOP HALF OF 120" DIAM. CMP | LS   | 1    |

**Rt. Curb Curve Data**  
 $\Delta = 111^\circ 22' 35"$   
 $R = 300'$   
 $T = 43.96'$   
 $L = 58.32'$

**Lt. Curb Curve Data**  
 $\Delta = 17^\circ 52' 30"$   
 $R = 100.00'$   
 $T = 15.73'$   
 $L = 30.58'$

**C Curve Data**  
 $\Delta = 17^\circ 52' 30"$   
 $R = 88.50'$   
 $T = 13.92'$   
 $L = 27.61'$

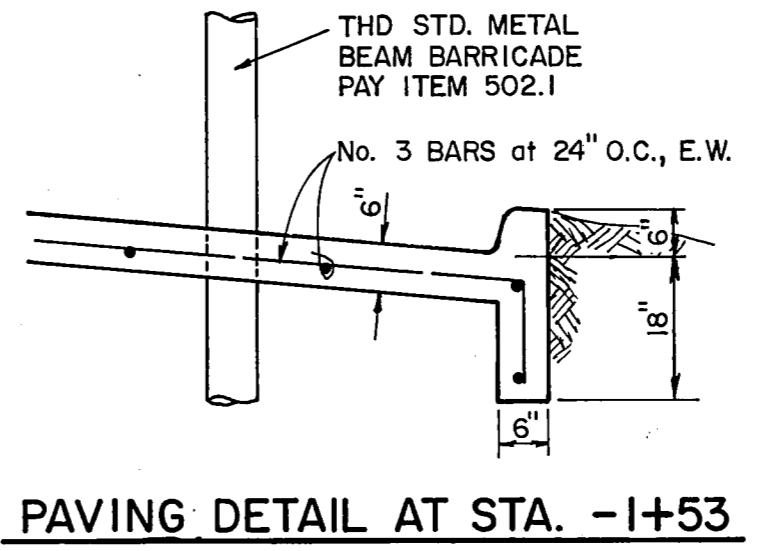
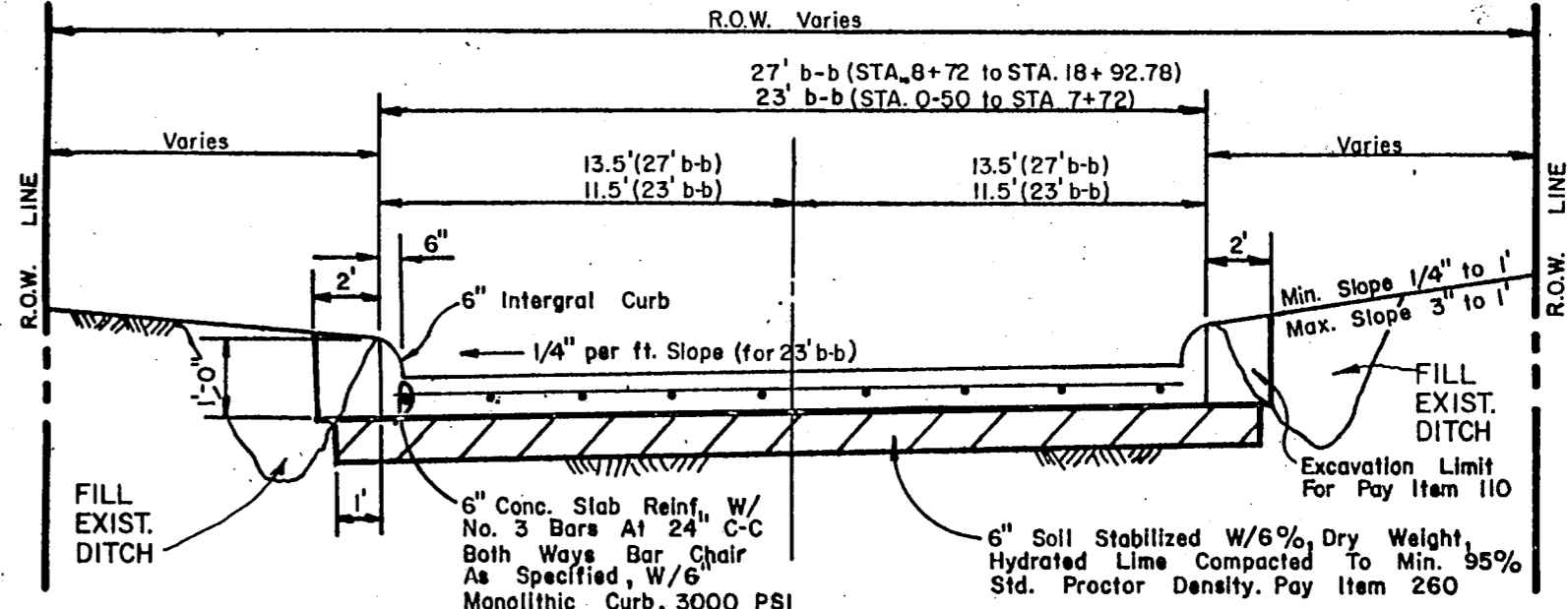

NOTES: 1. Backfill material NOT A SEPARATE PAY ITEM. Material acquired from excavation may be used if approved by Engineer.  
 2. Right (North) T.C. Elevation Higher than Left (South) T.C. Elevation, See Plans

**NOTE**  
 Paving Grades Will Be Set At Later Date After Completed Construction Of 84" Water Line, By Others.  
 Estimated Earthwork Quantities Are Subject To Change.

**CAUTION!**  
 Underground Gas Main In This Area. Contact Lone Star Gas Company 2 Working Days Prior To Construction. Call MR. Leon Weatherford At 276-1171

B.M. "O" CUT ON HEADWALL, EAST SIDE OF WINNWOOD, 180' SOUTH OF BELT LINE ROAD. ELEV. 555.79 (M.S.L.)  
 B.M. "Q" CUT CENTER FRONT PORCH 5555 CELESTIAL ROAD. ELEV. 577.95 (M.S.L.)

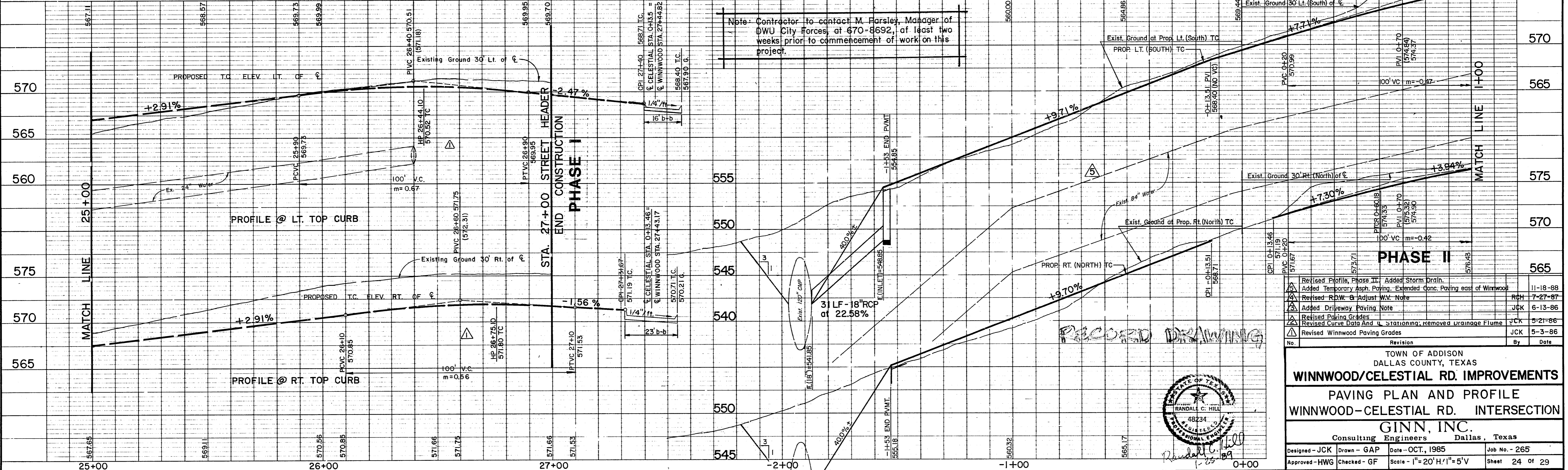

| No. | Revision  | By  | Date     |
|-----|---|-----|----------|
| 1   | Revised Profile, Phase II, Added Storm Drain.                       | JCK | 11-18-88 |
| 2   | Added Temporary Asp. Paving, Extended Conc. Paving east of Winnwood | ROM | 7-27-87  |
| 3   | Revised R.O.W. & Adjust W.V. Note                                   | JCK | 6-13-86  |
| 4   | Added Driveway Paving Note  | JCK | 9-21-86  |
| 5   | Revised Paving Grades   | JCK | 5-3-86   |
| 6   | Revised Curve Data And Stationing, removed drainage Flume           | JCK | 5-3-86   |
| 7   | Revised Winnwood Paving Grades                                      | JCK | 5-3-86   |

TOWN OF ADDISON  
 DALLAS COUNTY, TEXAS  
**WINNWOOD/CELESTIAL RD. IMPROVEMENTS**  
 PAVING PLAN AND PROFILE  
 WINNWOOD-CELESTIAL RD. INTERSECTION  
**GINN, INC.**  
 Consulting Engineers Dallas, Texas  
 Designed - JCK Drawn - GAP Date - OCT., 1985 Job No. - 265  
 Approved - HWG Checked - GF Scale - 1" = 20' H, 1" = 5' V Sheet 24 of 29

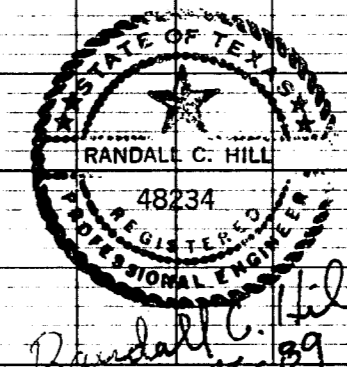

**RECORD DRAWING**