

STA. 0+23.76-0+24.06
 INSTALL 4.0" DIA STD MH
 FL 8" IN = 551.38
 FL 8" OUT = 554.28
 RIM EL = 558.75-58.66

LOT 3
 PAD SITE
 MIN. FINISHED FLOOR = 558.6
 (PER FLOODPLAIN STUDY)

RALJOE ADDITION
 BLOCK 1
 LOT 2
 PAD SITE
 MIN. FINISHED FLOOR = 558.4
 (PER FLOODPLAIN STUDY)

LOT 1
 PAD SITE
 MIN. FINISHED FLOOR = 565.0
 (PER FLOODPLAIN STUDY)

STA. 4+07.28-4+05.88
 INSTALL 8"X4" WYE TEE
 5± L.F. 4" SERVICE LAT
 FL EL = 553.65

STA. 3+31.28-3+33.37
 INSTALL 8"X4" WYE TEE
 5± L.F. 4" SERVICE LAT
 FL EL = 553.20

STA. 1+97.95-1+99.08
 INSTALL 8"X4" WYE TEE
 8± L.F. 4" SERVICE LAT
 FL EL = 552.41

STA. 4+12.28
 INSTALL STANDARD
 CLEANOUT FL = 553.68
 RIM EL = 569.5±

STA. 0+00
 CONNECT TO EX MH
 FL 8" IN = 551.19
 RIM EL = 558.28-58.16

- THE MINIMUM HORIZONTAL SEPARATION BETWEEN PARALLEL WATER AND SEWER LINES IS TEN (10) FEET, OR MINIMUM VERTICAL SEPARATION BETWEEN CROSSING WATER AND SEWER LINES IS EIGHTEEN (18) INCHES.
- DIMENSIONS SHOWN ARE TO CENTER LINE OF PIPE OR FITTING OR TO CENTER LINE OF MANHOLE.
- THE TOP ELEVATION OF MANHOLES CONSTRUCTED IN PAVED AREAS SHALL MATCH FINISH GRADE. THE TOP ELEVATION OF MANHOLES CONSTRUCTED IN NON-PAVED AREAS SHALL BE SIX (6) INCHES ABOVE FINISHED GRADE (UNLESS NOTED).
- CONTRACTOR SHALL GROUT AROUND ALL PIPE ENTRANCES TO SANITARY SEWER MANHOLES WITH NON-SHRINKING GROUT TO ASSURE CONNECTION IS WATER TIGHT.
- CONTRACTOR SHALL ON ALL UTILITIES, COORDINATE INSPECTION WITH APPROPRIATE AUTHORITIES PRIOR TO COVERING TRENCHES AT INSTALLATION.
- CONSTRUCTION SHALL COMPLY WITH ALL GOVERNING CODES AND REQUIREMENTS. THE CONTRACTOR SHALL CONDUCT ALL REQUIRED TESTS TO THE SATISFACTION OF THE UTILITY COMPANIES AND OWNERS INSPECTING AUTHORITIES.
- SANITARY SEWER PIPE SHALL BE PVC, ASTM D 3034 (SDR-35) WITH INTEGRAL BELL, BELL & SPIGOT TYPE JOINTS (WITH RUBBER).
- CAUTION!!! OVERHEAD ELECTRICAL SERVICE TO EX STRUCTURE SEWER STA 2+40±
- WATER TAPS SHALL BE MADE IN 3' X 3' CUTS IN EX. PAVEMENT. PAVEMENT PATCH SHALL BE PER CITY STANDARDS.
- CONTRACTOR SHALL COMPLY TO THE FULLEST EXTENT WITH THE LATEST STANDARDS OF OSHA DIRECTIVES OR ANY OTHER AGENCY HAVING JURISDICTION FOR EXCAVATION AND TRENCHING PROCEDURE. THE CONTRACTOR SHALL USE SUPPORT SYSTEMS, SLOPING, BENCHING, AND OTHER MEANS OF PROTECTION. THIS IS TO INCLUDE, BUT NOT LIMITED FOR, ACCESS AND EGRESS FROM ALL EXCAVATION AND TRENCHING. CONTRACTOR IS RESPONSIBLE TO COMPLY WITH PERFORMANCE CRITERIA FOR OSHA.
- CONTRACTOR SHALL INSTALL NECESSARY BACKFLOW PREVENTION DEVICES.
- CONTRACTOR SHALL VERIFY WATER SERVICE SIZES WITH THE FIRE SPRINKLER DESIGN. APPROVED SPRINKLER DESIGN IS REQUIRED BY THE CITY.

BENCH MARK
 ASSUMED 569.88 ON CENTERLINE TOP OF MANHOLE LOCATED APPROXIMATELY 120' NORTH OF THE NORTH LINE OF CELESTIAL ROAD, AND APPROXIMATELY 30' WEST OF THE EAST LINE OF WINNWOOD LANE.

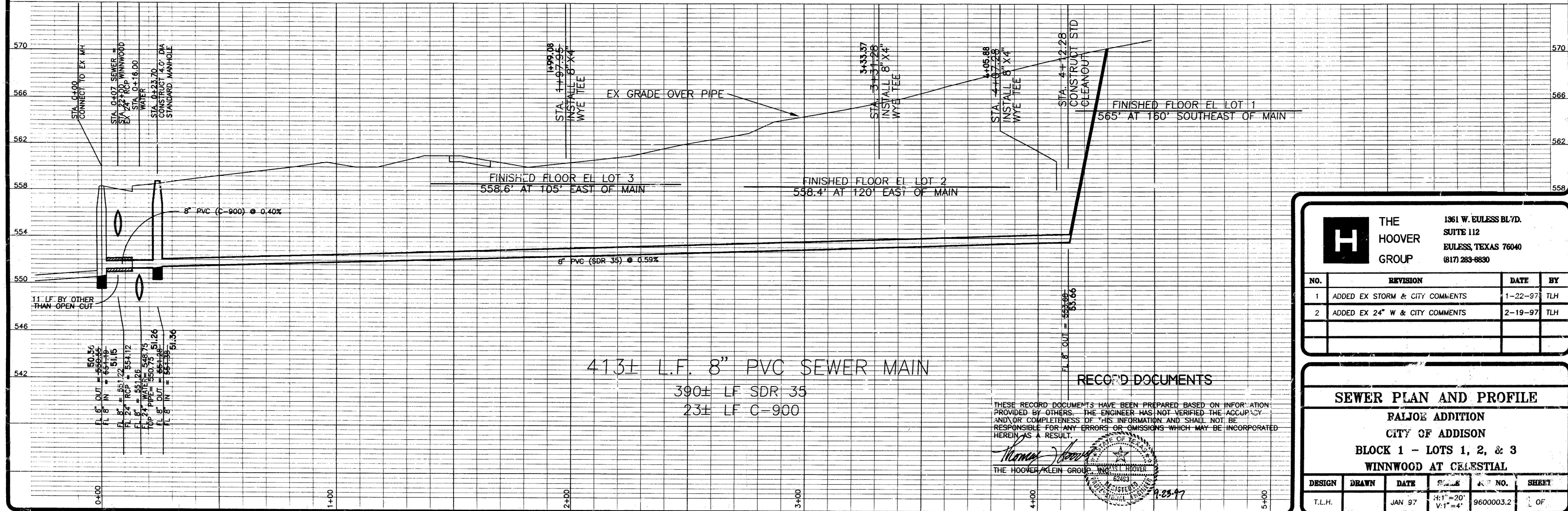

413± L.F. 8" PVC SEWER MAIN
 390± L.F. SDR 35
 23± L.F. C-900

THESE RECORD DOCUMENTS HAVE BEEN PREPARED BASED ON INFORMATION PROVIDED BY OTHERS. THE ENGINEER HAS NOT VERIFIED THE ACCURACY AND/OR COMPLETENESS OF THIS INFORMATION AND SHALL NOT BE RESPONSIBLE FOR ANY ERRORS OR OMISSIONS WHICH MAY BE INCORPORATED HEREIN AS A RESULT.

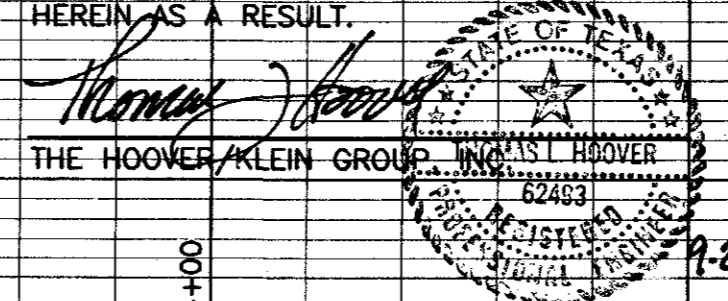

H		THE HOOPER GROUP		1361 W. EULESS BLVD. SUITE 112 EULESS, TEXAS 76040 (817) 283-8830	
		NO.	REVISION	DATE	BY
1	ADDED EX STORM & CITY COMMENTS	1-22-97	TLH		
2	ADDED EX 24" W & CITY COMMENTS	2-19-97	TLH		

SEWER PLAN AND PROFILE					
RALJOE ADDITION					
CITY OF ADDISON					
BLOCK 1 - LOTS 1, 2, & 3					
WINNWOOD AT CELESTIAL					
DESIGN	DRAWN	DATE	SCALE	SHEET NO.	SHEET
TLH		JAN 97	H:1"=20' V:1"=4'	9600003.2	OF

WINNWOOD (Celestial) Sewer (RalJoe)