

B21-3

WINNWOOD

B21-3 RALJOE ADDN. SEWER

pdf

CELESTIAL ROAD
(VARIABLE WIDTH RIGHT-OF-WAY)

LOT 1

PAD SITE
MIN. FINISHED FLOOR = 565.0
(PER FLOODPLAIN STUDY)

STA. 4+07.28-4+05.88
INSTALL 8" X 4" WYE TEE
5± L.F. 4" SERVICE LAT
FL EL = 553.65

STA. 4+12.28
INSTALL STANDARD
CLEANOUT FL = 553.68
RIM EL = 569.5±

LOT 2

PAD SITE
MIN. FINISHED FLOOR = 558.4
(PER FLOODPLAIN STUDY)

STA. 3+31.28-3+33.37
INSTALL 8" X 4" WYE TEE
5± L.F. 4" SERVICE LAT
FL EL = 553.20

STA. 1+07.95-1+09.08
INSTALL 8" X 4" WYE TEE
8± L.F. 4" SERVICE LAT
FL EL = 552.41

LOT 3

PAD SITE
MIN. FINISHED FLOOR = 558.6
(PER FLOODPLAIN STUDY)

STA. 0+23.70-0+24.06
INSTALL 4.0' DIA STD MH
FL 8" IN = 551.38
FL 8" OUT = 551.28
RIM EL = 558.75-58.66

EXISTING 24" WATER LINE
TOP PIPE ELEV. 550.75

TOP RIM = 558.28
FLOWLINE = 550.55

STA. 0+00
CONNECT TO EX MH
FL 8" IN = 551.19
RIM EL = 556.28-58.16

CONTRACTOR SHALL COMPLY TO THE FULLEST EXTENT WITH THE LATEST STANDARDS OF OSHA DIRECTIVES OR ANY OTHER AGENCY HAVING JURISDICTION FOR EXCAVATION AND TRENCHING PROCEDURE. THE CONTRACTOR SHALL USE SUPPORT SYSTEMS, SLOPING, BENCHING, AND SHIELDING TO PROTECT THE ADJACENT EXISTING UTILITIES. LIMITED ACCESS AND EGRESS FROM EXCAVATION AND TRENCHING OPERATIONS SHALL BE MAINTAINED AT ALL TIMES. THE CONTRACTOR IS RESPONSIBLE TO COMPLY WITH PERFORMANCE CRITERIA FOR OSHA.
CONTRACTOR SHALL INSTALL NECESSARY BACKFLOW PREVENTION DEVICES. CONTRACTOR SHALL VERIFY WATER SERVICE SIZES WITH THE FIRE SPRINKLER DESIGN. APPROVED SPRINKLER DESIGN IS REQUIRED BY THE CITY.

CONTRACTOR SHALL ON ALL UTILITIES, COORDINATE INSPECTION WITH APPROPRIATE AUTHORITIES PRIOR TO COVERING TRENCHES AT INSTALLATION. REQUIREMENTS THE CONTRACTOR SHALL CONDUCT ALL REQUIRED TESTS TO THE SATISFACTION OF THE UTILITY COMPANIES AND OWNERS INSPECTING AUTHORITIES.
SANITARY SEWER PIPE SHALL BE PVC, ASTM D 3034 (SDR-35) WITH INTEGRAL BELL, BELL & SPIGOT TYPE JOINTS (WITH RUBBER).
CAUTION!!! - OVERHEAD ELECTRICAL SERVICE TO EX STRUCTURE
SEWER STA 2+40± WATER TAP SHALL BE MADE IN 3" X 3" CUTS IN EX. PAVEMENT. PAVEMENT PATCH SHALL BE PER CITY STANDARDS.

THE MINIMUM HORIZONTAL SEPARATION BETWEEN PARALLEL WATER AND SEWER LINES SHALL BE AS FOLLOWS:
1. DIMENSIONS SHOWN ARE TO CENTER LINE OF PIPE OR FITTING OR TO CENTER LINE OF MANHOLE.
2. THE TOP ELEVATION OF MANHOLES CONSTRUCTED IN PAVED AREAS SHALL MATCH FINISH GRADE. THE TOP ELEVATION OF MANHOLES CONSTRUCTED IN NON-PAVED AREAS SHALL BE SIX (6) INCHES ABOVE FINISHED GRADE (UNLESS NOTED).
CONTRACTOR SHALL GROUT AROUND ALL PIPE ENTRANCES TO SANITARY SEWER MANHOLES WITH NON-SHRINKING GROUT TO ASSURE CONNECTION IS WATER TIGHT.

BENCH MARK
ASSUMED 569.88 ON CENTERLINE TOP OF MANHOLE LOCATED APPROXIMATELY 120' NORTH OF THE NORTH LINE OF CELESTIAL ROAD, AND APPROXIMATELY 30' WEST OF THE EAST LINE OF WINNWOOD LANE.

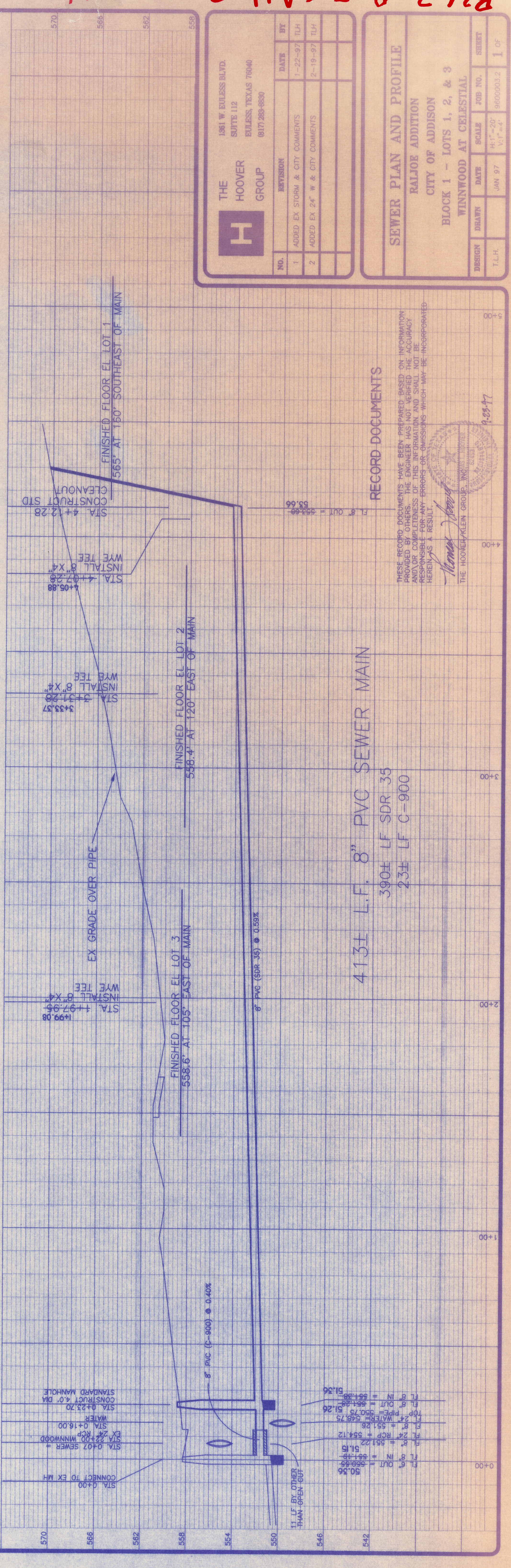

413± L.F. 8" PVC SEWER MAIN
300± L.F. SDR 35
23± L.F. C-900

RECORD DOCUMENTS

THESE RECORD DOCUMENTS HAVE BEEN PREPARED BASED ON INFORMATION PROVIDED TO THE ENGINEER. THE ENGINEER HAS NOT VERIFIED THE ACCURACY AND/OR COMPLETENESS OF THIS INFORMATION AND IS NOT RESPONSIBLE FOR ANY ERRORS OR OMISSIONS WHICH MAY BE INCORPORATED HEREIN AS A RESULT.



THE HOOPER GROUP		1881 W. BULLESS BLVD. SUITE 112 BULLESS, TEXAS 76040 (817) 289-8830	
NO.	REVISION	DATE	BY
1	ADDED EX STORM & CITY COMMENTS	1-22-97	TLH
2	ADDED EX 24" W & CITY COMMENTS	2-19-97	TLH

SEWER PLAN AND PROFILE			
RALJOE ADDITION			
CITY OF ADDISON			
BLOCK 1 - LOTS 1, 2, & 3			
WINNWOOD AT CELESTIAL			
DESIGN	DRAWN	DATE	SCALE
TLH	JAN 97	JAN 97	H:1"=20' V:1"=4'
JOB NO.	SHEET		
9600003.2	1 OF		