

**CAUTION!**  
Underground Gas Main In This Area.  
Contact Lone Star Gas Company 2  
Working Days Prior To Construction.  
Call MR. Leon Weatherford At  
276-1171

Contractor Shall Notify Dallas  
Water Utilities Construction  
Inspection At 670-8700 At  
Least 48 Hours Prior To  
The Start Of Construction.

B.M. ~ "C" Cut on edge of concrete  
porch of Church at 5555 Celestial  
ELEV. 577.95 (m.s.l.)

B.M. ~ "D" Cut on headwall, E. Side  
of Winnwood, 100' E. of Belt Line &  
ELEV. 553.79 (m.s.l.)

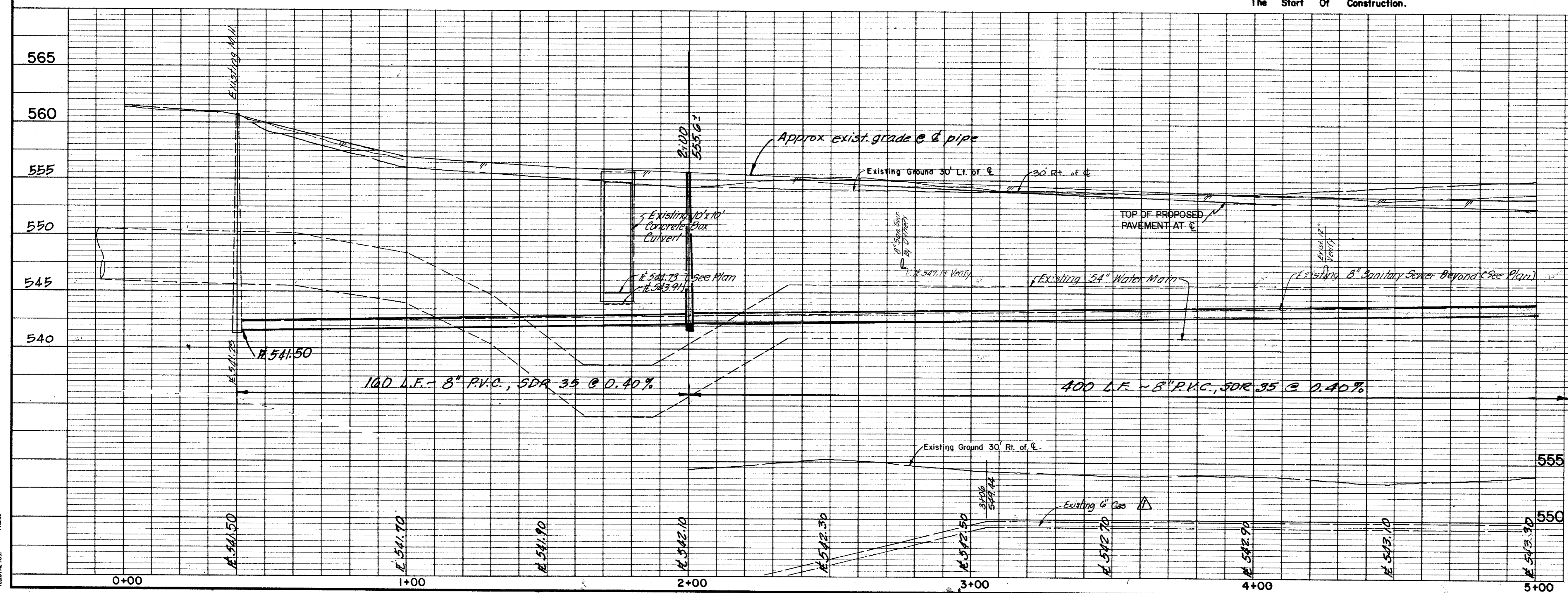

**PHASE I**

Changed 4" S.S. Lateral to 6" Added B.M. & G' Gas. REC 12-13-85 No. Revision By Date			
TOWN OF ADDISON DALLAS COUNTY, TEXAS <b>WINNWOOD RD. SAN. SEWER IMPROVEMENTS</b>			
<b>SEWER PLAN AND PROFILE</b> STA. 0+00 to STA. 5+00			
<b>GINN, INC.</b> Consulting Engineers Dallas, Texas			
Designed - GF	Drawn - ALA	Date - OCT., 1985	Job No. - 265
Approved - HWG	Checked - JCK	Scale - 1" = 20'H/1" = 5'V	Sheet 18' of 29