



11.06.2009

OWNER
JW OPERATING COMPANY
15508 WRIGHT BROTHERS DR.
ADDISON, TX 75001
PHONE: (972) 233-4191
FAX: (972) 991-0704
ggradick@jwoperating.com

CIVIL ENGINEER
PACHECO KOCH CONSULTING ENGINEERS
8350 N CENTRAL EXPRESSWAY SUITE 1000
DALLAS, TX 75208-1612
PHONE: (972) 235-2031
FAX: (972) 235-6544

STRUCTURAL ENGINEER
R.L. GOODSON
5445 LA SIERRA, SUITE 300-LB 17
DALLAS, TX 75231
PHONE: (214) 739-8100
FAX: (214) 739-8354

MEP ENGINEER
DASHARATH ENGINEERING
921 INDUSTRIAL BLVD. SUITE 100
DALLAS, TX 75207
PHONE: (214) 720-1005
FAX: (214) 720-1006

LANDSCAPE ARCHITECT
CAYE COOK & ASSOCIATES
12700 HILLCREST ROAD, SUITE 149
DALLAS, TX 75230
PHONE: (214) 739-9105
FAX: (214) 373-0170
barbara@cclandscapearch.com

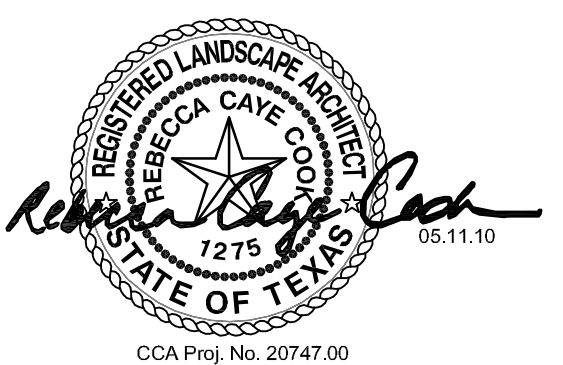

TITLE

IRRIGATION PLAN

REVISIONS

06.03.2010 Planter Pot Add.

JOB NO. 26010

Issue Date: 04/23/2010

Drawn By: MP

Checked By: JP

SHEET NO.

AS-BUILTS

L-2.1

ISSUE FOR REVIEW ONLY

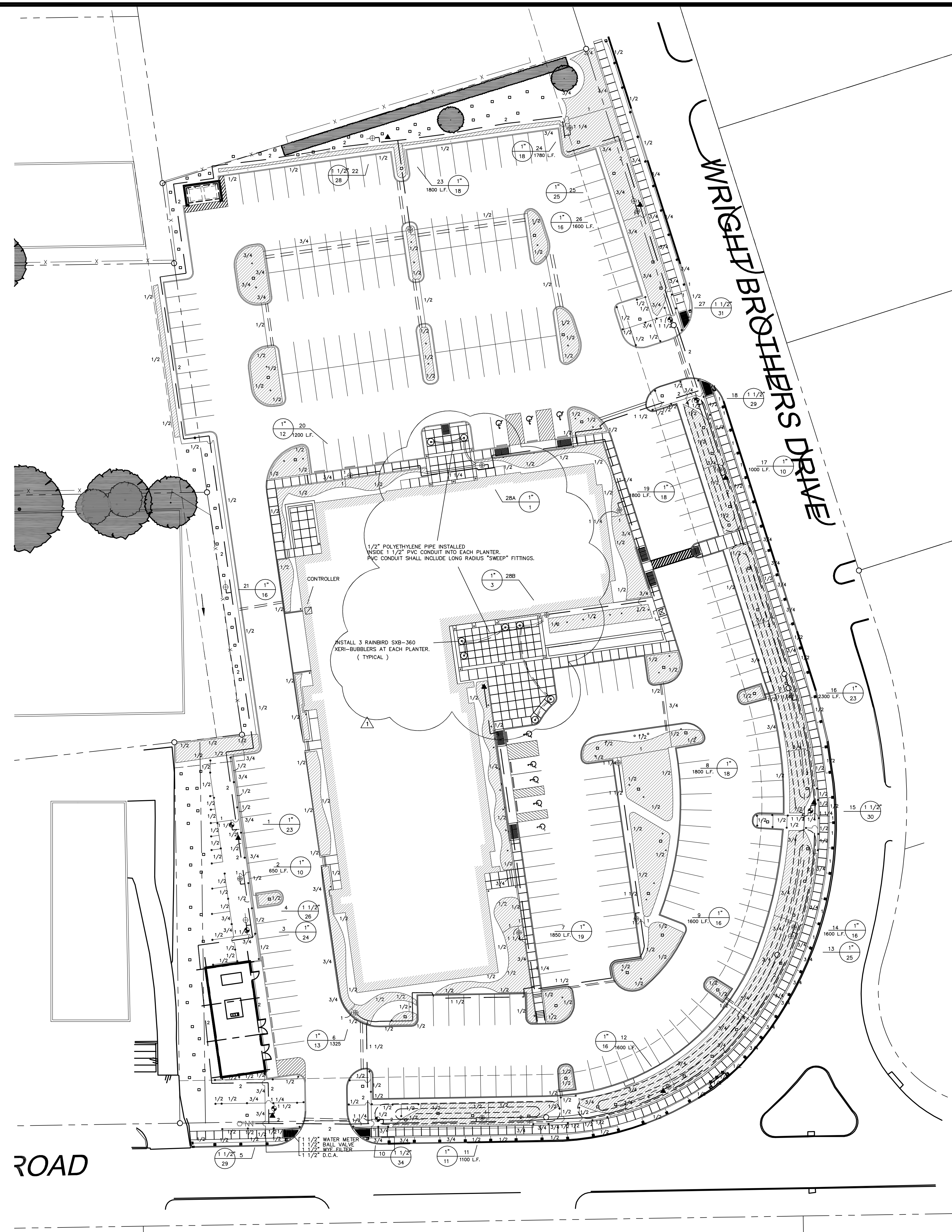

LEGEND

- HUNTER INST-04 SERIES POP UP SPRAY HEADS WITH HUNTER MSBN-50H STREAM BUBBLER NOZZLES. (TWO PER TREE)
SEE INSTALLATION NOTE #13 REGARDING TREE BUBBLER LATERAL PIPE
- /■ HUNTER INST-04 SERIES POP UP SPRAY HEAD WITH SS / ES SERIES STRIP NOZZLE UNLESS NOTED OTHERWISE.
- HUNTER INST-04 SERIES POP UP SPRAY HEAD WITH PRO SPRAY SERIES NOZZLE AS NOTED BELOW
- ▨ NETAFIM TECHLINE CV SERIES DRIP TUBE IN SHRUB BED INSTALLED AT 2" DEPTH
SEE INSTALLATION NOTE #16 REGARDING DRIP TUBE LAYOUT IN SHRUB BEDS.
- HUNTER PGP 4" POP UP ROTARY HEAD, PART CIRCLE, #2.5 BLUE NOZZLE UNLESS NOTED OTHERWISE
- HUNTER PGP 4" POP UP ROTARY HEAD, PART CIRCLE, #4.0 BLUE NOZZLE UNLESS NOTED OTHERWISE
- ⊕ HUNTER ICV SERIES ELECTRIC REMOTE CONTROL VALVE
- ⊕ HUNTER ICV SERIES ELECTRIC REMOTE CONTROL, "TREE BUBBLER ZONE" VALVE
SEE INSTALLATION NOTE #13 REGARDING TREE BUBBLER LATERAL PIPE
- ⊕ HUNTER ICV SERIES ELECTRIC REMOTE CONTROL VALVE WITH "ACCU-SET" PRESSURE REGULATOR AND
SAME SIZE NETAFIM TECH FILTER - FOR "DRIP" ZONES. SET REGULATOR AT 30 P.S.I.
- ▲ HUNTER 33D-R QUICK COUPLING VALVE WITH LOCKING PURPLE COVER AND 3/4" PVC BALL VALVE
- ⊕ LASCO "V101N" SERIES SCH. 80 PVC TRUE UNION BALL VALVE, MAINLINE SIZE
- 1 1/2" FEBCO 850 SERIES D.C.A. INSTALLED PER CITY CODE, WITH SAME SIZE WATTS 6000 SERIES BRONZE
BALL VALVE AND WATTS 777 SERIES BRONZE WYE FILTER WITH STAINLESS STEEL SCREEN
- 1 1/2" IRRIGATION WATER METER AND TAP
- HUNTER ICC-2400M SERIES AUTOMATIC CONTROLLER WITH WRFC WIRELESS RAIN / FREEZE SENSOR
LOCATE SENSOR AS FIELD DIRECTED BY THE LANDSCAPE ARCHITECT

- CLASS 200 PVC MAINLINE PIPE
- CLASS 200 (EXCEPT 1/2 INCH #315) PVC LATERAL PIPE
- CLASS 200 SLEEVE PIPES, ONE 4" AND ONE 2" PIPE AT EACH CROSSING
- 1 1/2" PVC CONDUIT WITH LONG RADIUS "SWEEP" FITTINGS INTO EACH RAISED PLANTER POT.

L.I.C. SHALL SELECT PRO-SPRAY SPRAY NOZZLES FOR "HEAD-TO-HEAD" COVERAGE, ADJUSTED FOR NO OVERSPRAY ONTO WALLS AND WALKS. NO OVERSPRAY INTO STREETS IS PERMITTED.

1 IRRIGATION PLAN
1" = 30' - 0"

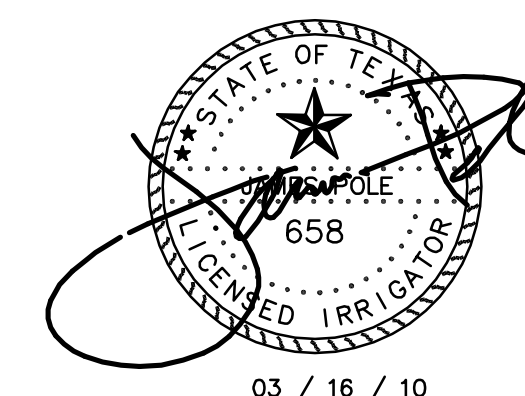
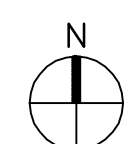

James Pole
IRRIGATION CONSULTANTS

IRRIGATION DESIGN, CONSULTING, AND
LANDSCAPE WATER MANAGEMENT
TEXAS L.I.C. #658 PHONE: 940.243.2364
100 W. OAK ST., SUITE 101 FAX: 940.382.2475
DENTON, TEXAS 76201 james@jamespoleirrigation.com