

PARKING TABULATION

PARKING REQUIRED - (1:200 SF)
 BUILDING AREA - 83,000 GSF

PARKING
 REQUIRED - 415 PARKING SPACES

PARKING PROVIDED

ON SITE PERMANENT	97
SOUTH OF SOJOURN	248
ELEVATED DECK	37
HOSPITAL SURPLUS	33
TOTAL	415

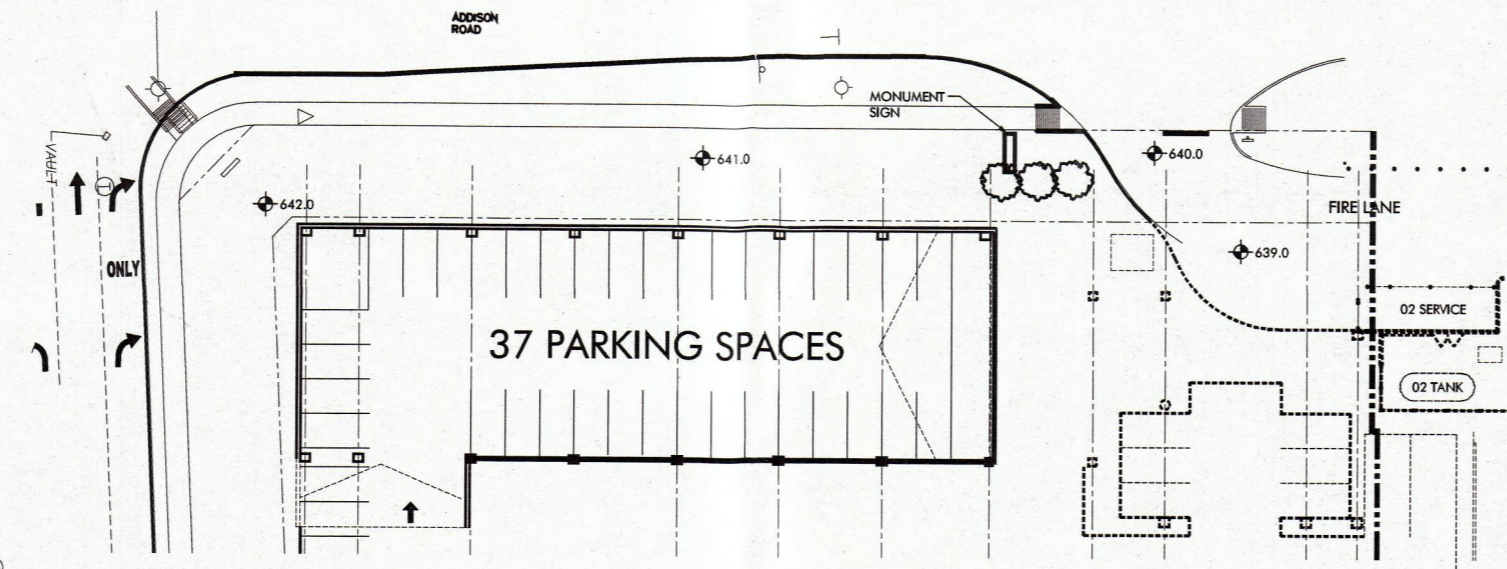

02 ELEVATED PARKING DECK

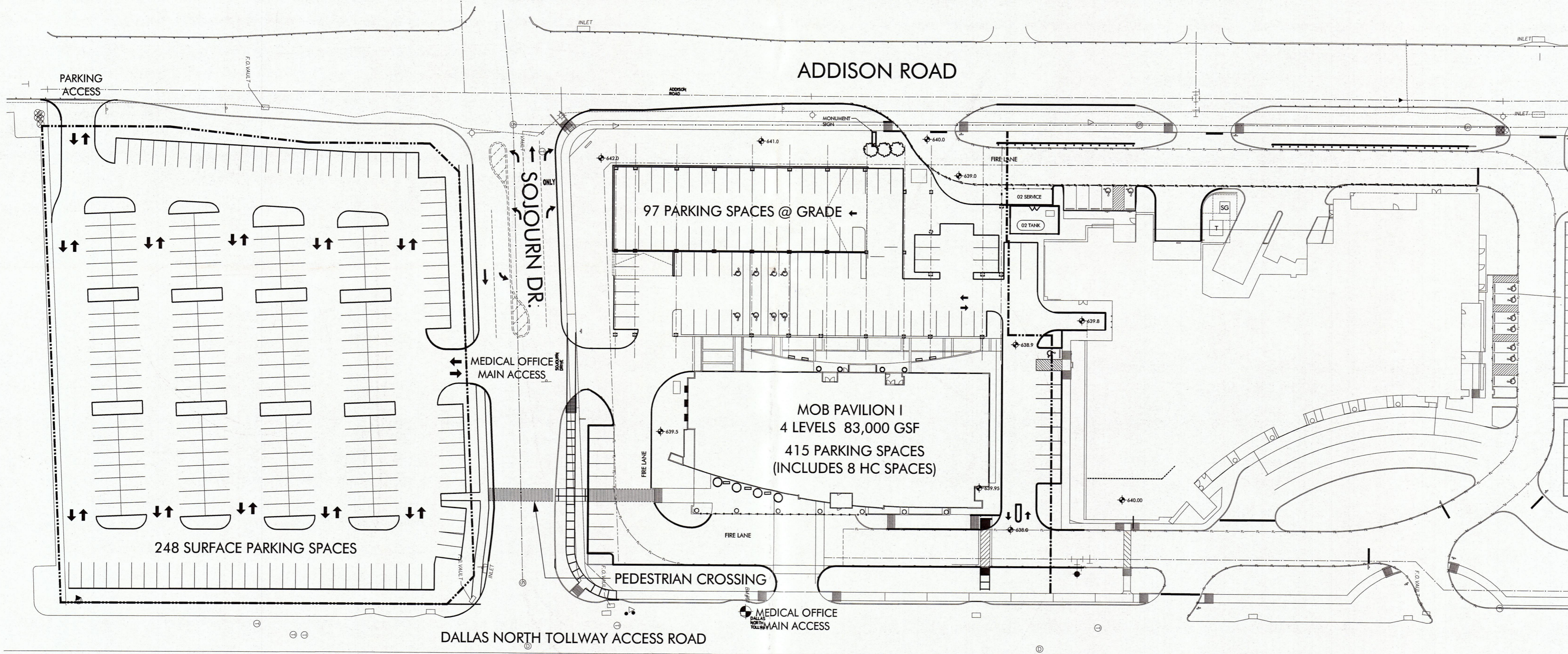

DALLAS NORTH TOLLWAY

01 SITE PLAN

MHS PAVILION I - MEDICAL OFFICE BUILDING

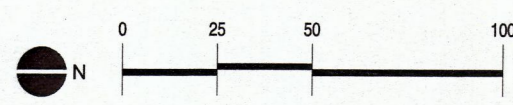

Donald R. Powell, Jr.
 Reg. No.: 7206
 Chris W. Barnes
 Reg. No.: 10147
 John E. Orfield
 Reg. No.: 11164
 R. Andrew Bennett
 Reg. No.: 18129

Site Plan

01.31.2012

Project No.:
 09063.100

© 2010 BOKA Powell, LLC. All rights reserved. For regulatory approval, permitting or construction.