

B.M. #19 "C" CUT IN CENTER OF INLET 150 FEET SOUTH OF BELT LINE RD., EAST OF INWOOD RD. ELEV. 630.59

T.B.M. AR-1 "C" CUT IN TOP OF VAULT NORTHEAST CORNER OF ADDISON RD. AND BELT LINE RD. ELEV. 634.80

T.B.M. AR-2 "C" CUT IN CENTER OF INLET EAST SIDE OF ADDISON RD., @ STA. 0+87, 52 FEET RT. ELEV. 628.79

PROP. CURB P.I. STA. 3+86.42, 28.5' LT.

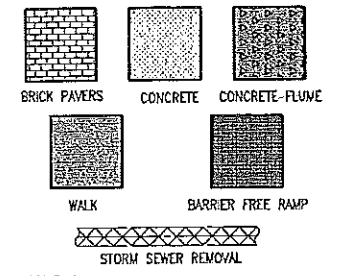

NOTE A: EXISTING CABLE FENCE SHALL BE REMOVED BETWEEN ADDISON RD. AND EAST R.O.W. LINE. FURNISH & INSTALL 2-TERMINAL POSTS. POSTS MATERIAL SHALL BE OF SAME OR BETTER QUALITY AS EXISTING POST.

FOR SUMMARY OF ABBREVIATIONS SEE SHEET INDEX/GENERAL NOTES SHEET

These plans and related specifications were prepared for construction of this specific project only. Reuse of these documents is not permitted without written authorization of Birkhoff, Hendricks, & Conway, L.L.P.

NOTE: DETAIL BELOW SHALL BE USED FOR SIDEWALKS ADJACENT TO PROPOSED PAVEMENT IN THIS PROJECT.

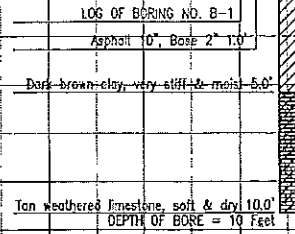
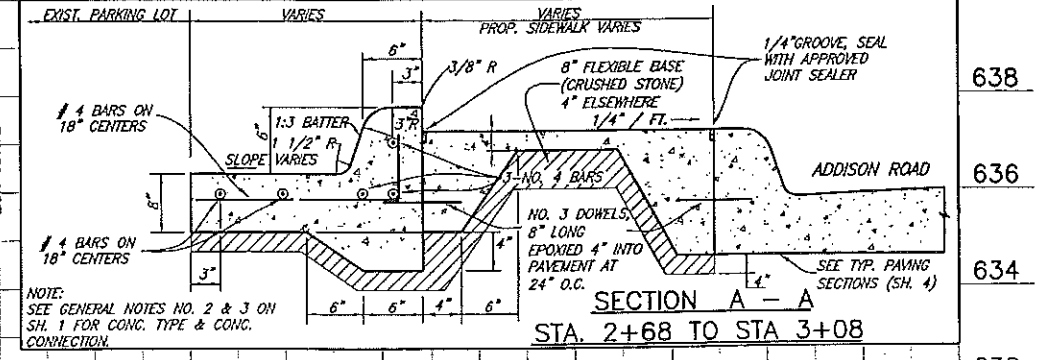

638	<p>Pothole Crew:</p> <p>Please try to verify the service taps. You don't need to dig them up, but just verify that there is a service and mark the approximate location on the drawings!</p> <p><i>[Signature]</i></p>		
636			
634			
632			
630			
628			
626			
0+00			

TOWN OF ADDISON, TEXAS

ADDISON ROAD IMPROVEMENTS
BELT LINE ROAD TO ARAPAHO ROAD PHASE I
STA. 0+00 TO STA. 4+00

BIRKHOFF, HENDRICKS & CONWAY L.L.P.
CONSULTING ENGINEERS
Dallas, Texas

DESIGNED BY: J.W.B. PROJECT: 2002102 SHEET NO. 5
DRAWN BY: R.J.L. DATE: MAY 2005 OF 68 SHEETS

THESE DOCUMENTS ARE FOR BIDDING, CONSTRUCTION AND PERMIT PURPOSES

[Signature]

DATE: 10/3/06



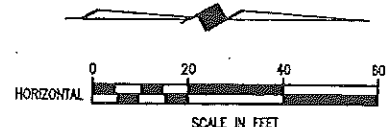
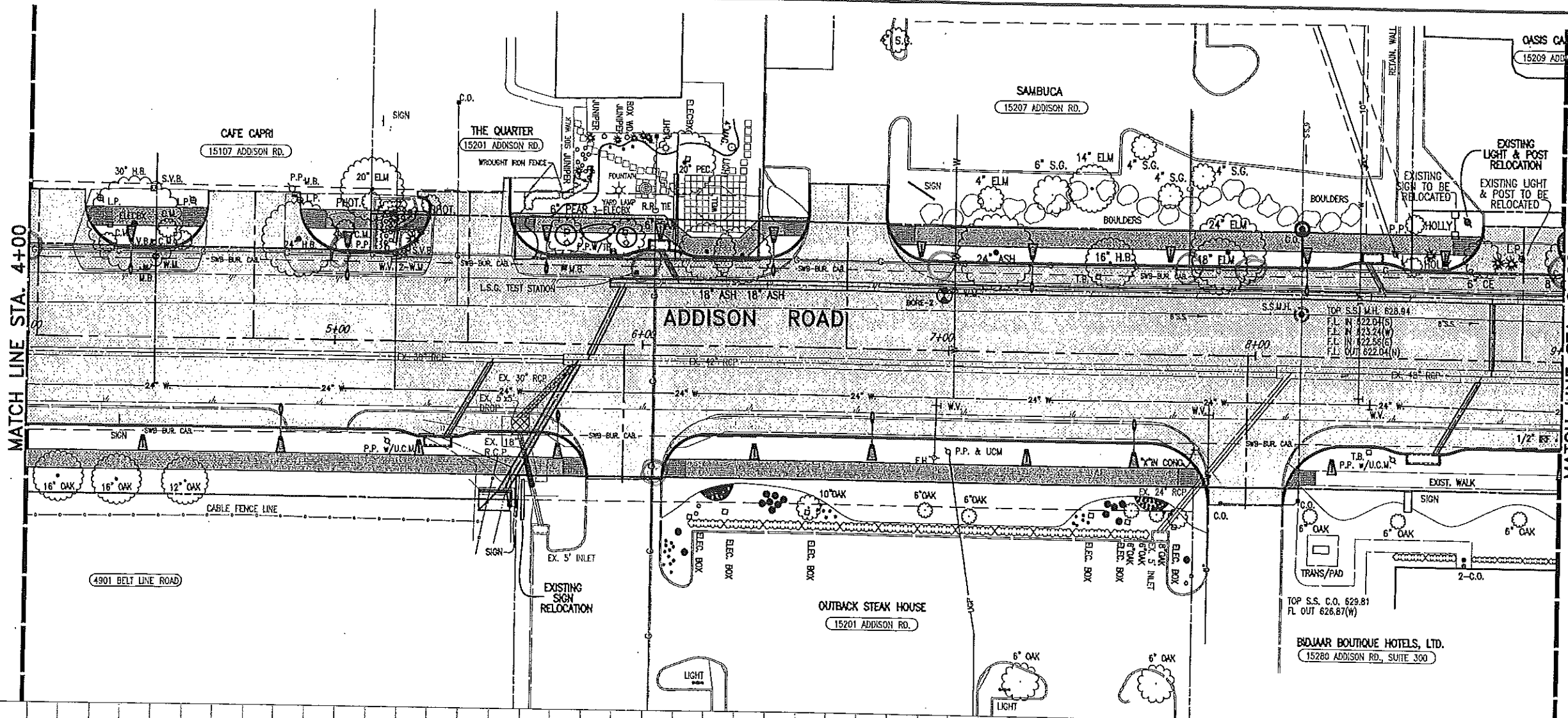

- B.M.#19 "C" CUT IN CENTER OF INLET 150 FEET SOUTH OF BELT LINE RD., EAST OF INWOOD RD. ELEV. 630.59
- T.B.M. AR-1 "C" CUT IN TOP OF VAULT NORTHEAST CORNER OF ADDISON RD. AND BELT LINE RD. ELEV. 634.80
- T.B.M. AR-2 "C" CUT IN CENTER OF INLET EAST SIDE OF ADDISON RD., § STA. 9+87, 52 FEET RT. ELEV. 628.79

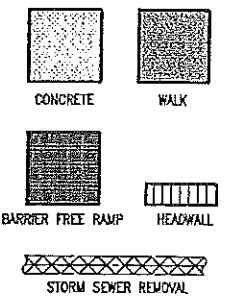

FOR SUMMARY OF ABBREVIATIONS SEE SHEET INDEX/GENERAL NOTES SHEET

These plans and related specifications were prepared for construction of this specific project only. Reuse of these documents is not permitted without written authorization of Birkhoff, Hendricks, & Conway, L.L.P.

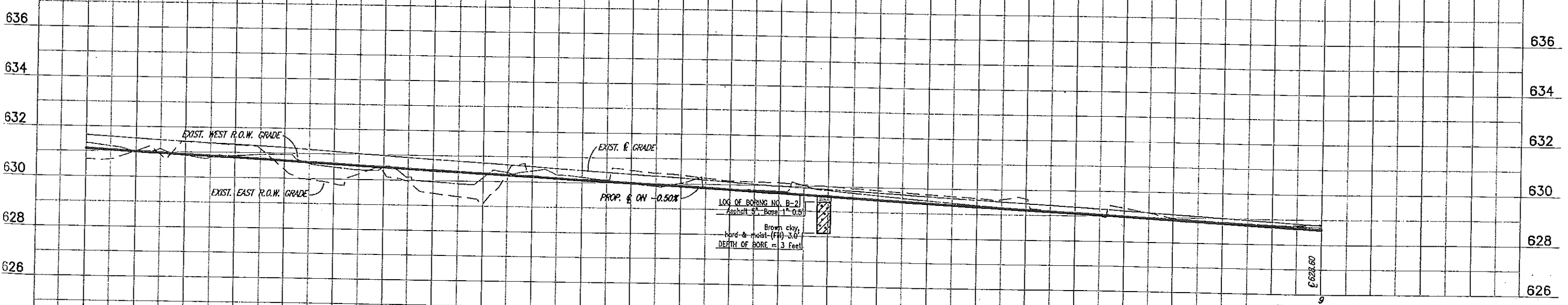

LOG OF BORING NO. B-2
 Asphalt 5" Base 1'-0.5"
 Brown clay, hard & moist (FH) 3'-0"
 DEPTH OF BORE = 3 Feet

TOWN OF ADDISON, TEXAS

**ADDISON ROAD IMPROVEMENTS
 BELT LINE ROAD TO KELLER SPRING ROAD
 STA. 4+00 TO STA. 9+00**

BIRKHOFF, HENDRICKS & CONWAY L. L. P.
 CONSULTING ENGINEERS
 Dallas, Texas

THESE DOCUMENTS ARE FOR BIDDING, CONSTRUCTION, AND PERMIT PURPOSES.
John Birkhoff
 DATE: 10/31/06



DESIGNED BY: J.W.B. PROJECT: 2002102 SHEET NO. 6
 DRAWN BY: R.J.L. DATE: SEPTEMBER 2006 OF 68 SHEETS

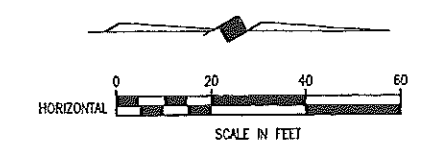
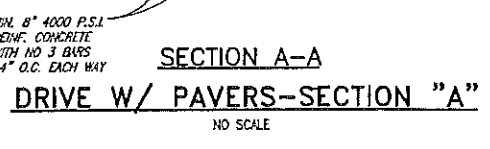
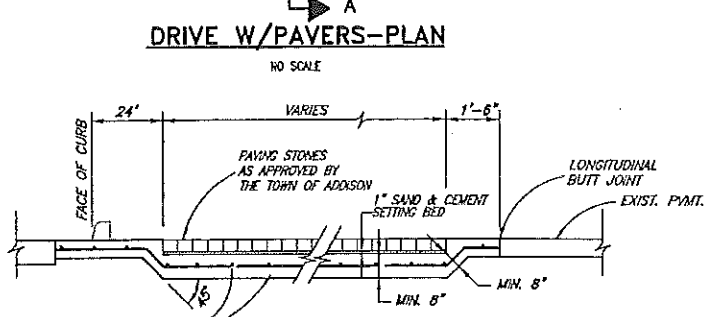
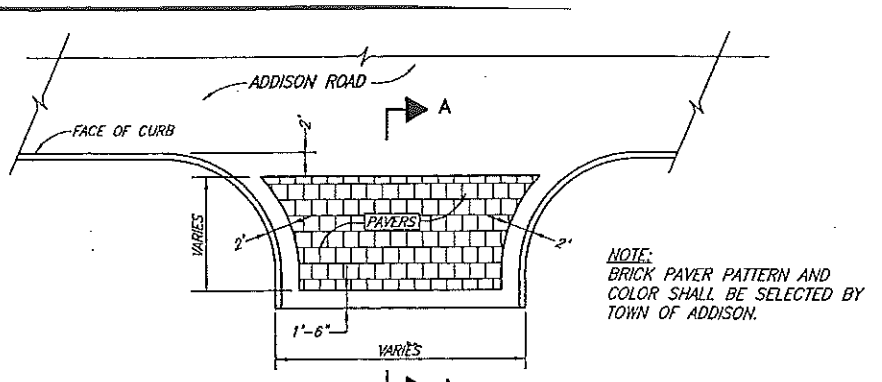
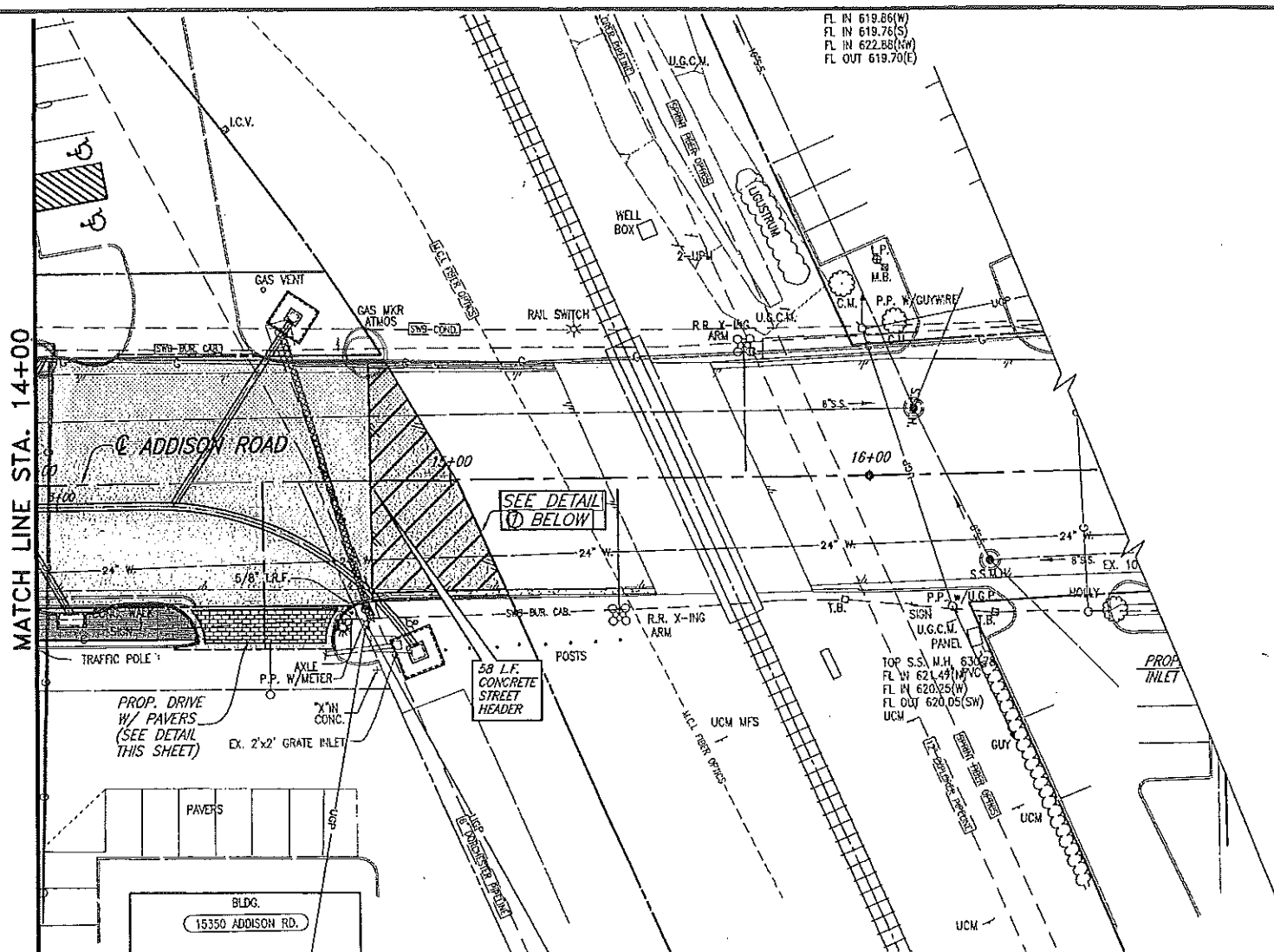

- B.M.#19 "C" CUT IN CENTER OF INLET 150 FEET SOUTH OF BELT LINE RD., EAST OF INWOOD RD. ELEV. 630.59
- T.B.M. AR-1 "C" CUT IN TOP OF VAULT NORTHEAST CORNER OF ADDISON RD. AND BELT LINE RD. ELEV. 634.80
- T.B.M. AR-2 "C" CUT IN CENTER OF INLET EAST SIDE OF ADDISON RD., @ STA. 9+87, 52 FEET RT. ELEV. 628.79
- T.B.M. AR-3 "C" CUT AT END OF RETAINING WALL, NORTH OF LINDBERGH DR., WEST SIDE OF ADDISON RD., @ STA. 18+76, 45 FEET LT. ELEV. 635.38

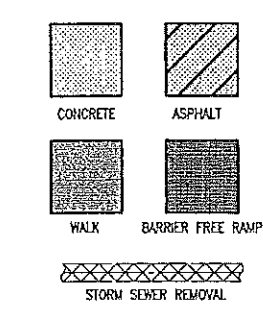

FOR SUMMARY OF ABBREVIATIONS SEE SHEET INDEX/GENERAL NOTES SHEET

These plans and related specifications were prepared for construction of this specific project only. Reuse of these documents is not permitted without written authorization of Birkhoff, Hendricks, & Conway, L.L.P.

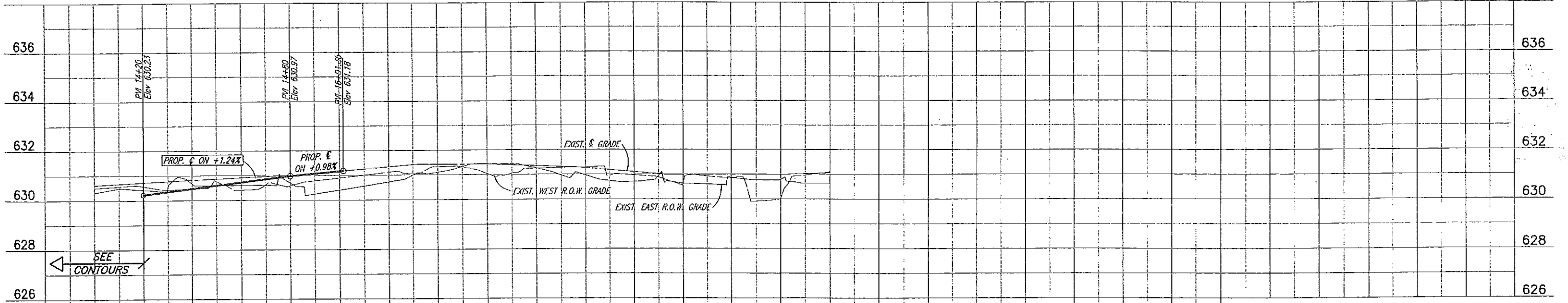

TOWN OF ADDISON, TEXAS

ADDISON ROAD IMPROVEMENTS
BELT LINE ROAD TO ARAPAHO ROAD PHASE I
STA. 14+00 TO STA. 15+01.35

BIRKHOFF, HENDRICKS & CONWAY L. L. P.
CONSULTING ENGINEERS
Dallas, Texas

DESIGNED BY: J.W.B.	PROJECT: 2002-102	SHEET NO. 8
DRAWN BY: R.J.L.	DATE: SEPTEMBER 2006	OF 68 SHEETS

THESE DOCUMENTS ARE FOR BIDDING, CONSTRUCTION, AND PERMIT PURPOSES.

John W. Birkhoff

DATE: 10/31/06

H:\Projects\Addison\2002102\PHASE1\Sheet\2002102D08_PP.dwg
 PLOT SCALE: 1:1
 REVISED: 10/30/06 - FLOWE
 14
 15+00