

EXIST. FIRE HYDRANT
120' +/- EAST OF SOUTHEAST
CORNER OF TRACT

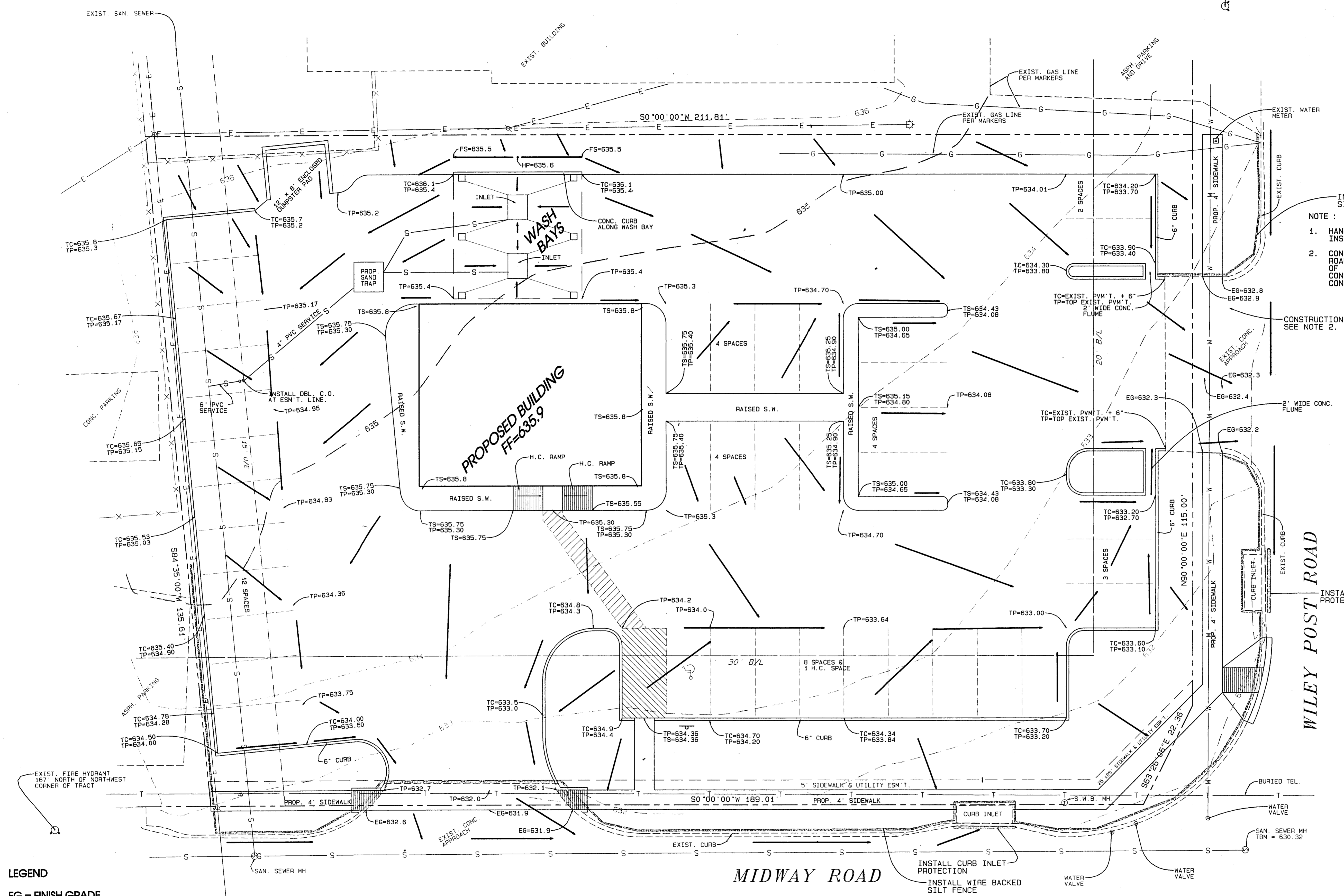

NOTE:
1. HANDICAP IMPROVEMENTS ARE TO BE INSPECTED BY THIRD PARTY INSPECTOR TO INSURE COMPLIANCE WITH T.A.S. REQUIREMENTS.
2. CONTRACTOR SHALL INSURE THAT NO MUD IS TRACKED ONTO EXISTING ROADWAYS. IF MUD IS TRACKED ONTO ADJACENT ROADWAYS, THE TOWN OF ADDISON, AT THE DISCRETION OF THE INSPECTOR, WILL REQUIRE A CONSTRUCTION ENTRANCE CONFORMING TO NCTCOG STANDARDS BE CONSTRUCTED AT THE CONTRACTOR'S EXPENSE.

CONSTRUCTION ENTRANCE
SEE NOTE 2.

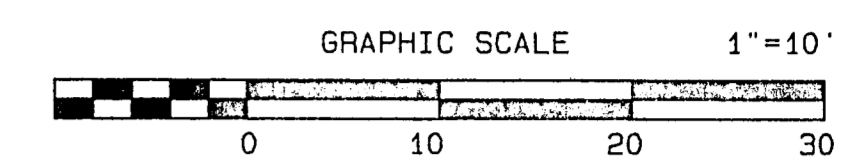
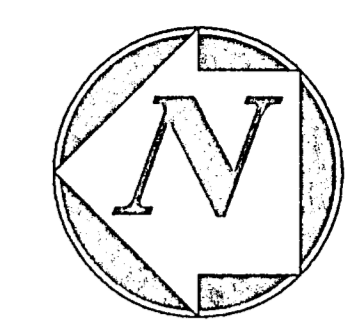
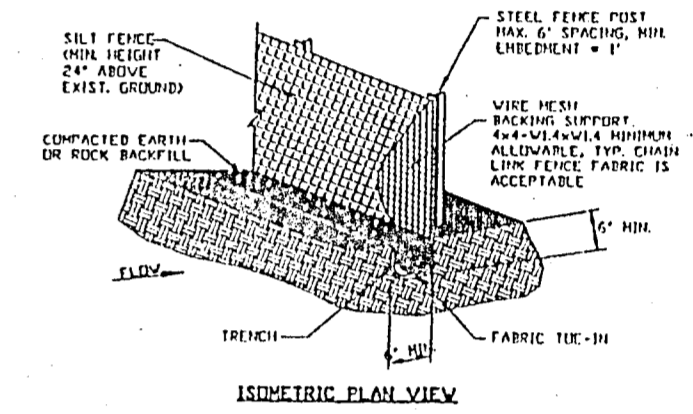

SILT FENCE GENERAL NOTES

1. STEEL POSTS WHICH SUPPORT THE SILT FENCE SHALL BE INSTALLED AT A SLIGHT ANGLE TOWARD THE ANTICIPATED EROSION SOURCE. POSTS MUST BE SPACED AT A MINIMUM OF 10 FEET.
2. THE USE OF THE SILT FENCE SHALL BE REVIEWED BY THE TOWN ENGINEER OF THE TOWN OF ADDISON, TEXAS. THE FENCE SHALL BE PERPENDICULAR TO THE LINE OF EROSION. WHERE FENCE CANNOT BE PERPENDICULAR TO THE LINE OF EROSION, THE FENCE SHALL BE INSTALLED AT AN ANGLE TO PREVENT FLOW FROM BEING UNDER THE FENCE.
3. THE TRENCH MUST BE A MINIMUM OF 4 INCHES DEEP AND 12 INCHES WIDE TO ALLOW FOR THE SILT FENCE FABRIC TO BE PROPERLY INSTALLED IN THE TRENCH. THE TRENCH SHALL BE COMPACTED EARTH OR ROCK BACKFILL.
4. SILT FENCE SHALL BE SECURELY FASTENED TO EACH STEEL SUPPORT POST OR TO WOODEN WIRE, WHICH IN TURN IS ATTACHED TO THE STEEL FENCE POST. THERE SHALL BE FABRIC TIE-IN.
5. INSPECTION SHALL BE MADE EVERY TWO WEEKS AND AFTER EACH RAIN OR WINDSTORM. REPAIR OR REPLACEMENT SHALL BE MADE PROMPTLY AS NEEDED.
6. SILT FENCE SHALL BE REMOVED WHEN THE SITE IS COMPLETELY STABILIZED TO 1/8" MOISTURE TO BLOCK OR PREVENT EROSION FROM OCCURRING.
7. ACCUMULATED SILT SHALL BE REMOVED WHEN IT REACHES A DEPTH OF HALF THE HEIGHT OF THE FENCE. THE SILT SHALL BE REMOVED BY AN APPROVED SITE AND SO THAT A MARKER AS TO NOT CONTRIBUTE TO ADDITIONAL SILTATION.

SILT CONTROL FENCE INSTALLATION

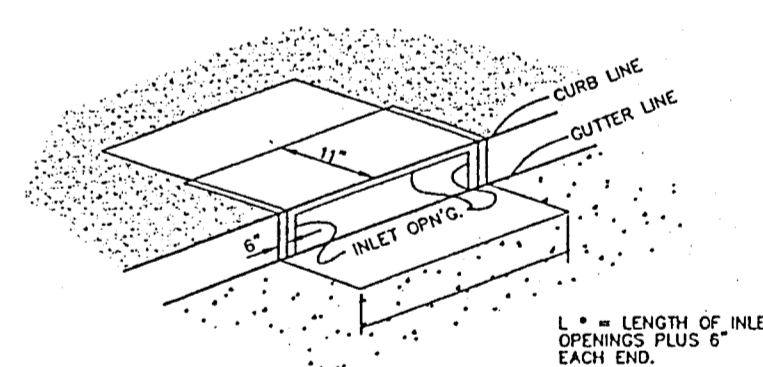

GENERAL NOTES:

1. FRAME TO BE MADE OF A GAUGE GALVANIZED STEEL. 3" x 8" SQUARE FOR SECTION ADJACENT TO FACE OF INLET. 4" x 8" SQUARE FOR TOP AND BOTTOM SECTIONS.
2. FILTER FABRIC TO BE 500 POLYFELT.
3. CURB INLET PROTECTOR TO BE MANUFACTURED BY TEXAS ENVIRONMENTAL MANAGEMENT, INC. OR EQUAL (DESIGN ENGINEER TO APPROVE SUBSTITUTE PRIOR TO INSTALLATION).

CURB INLET PROTECTION

LEGEND
FG = FINISH GRADE
EG = EXISTING GRADE
HP = HIGH POINT
TC = TOP OF CURB
TP = TOP OF PAVEMENT
TS = TOP OF SIDEWALK
TW = TOP OF WALL
BW = BOTTOM OF WALL
FS = FLOW LINE OF SWALE

NOTE:
1. TOPOGRAPHIC INFORMATION PROVIDED BY DOUG CONNALLY & ASSOC., INC.
2. INSTALL WIRE BACKED SILT FENCE OR OTHER APPROVED EROSION CONTROL DEVICES TO CONTROL SILT RUN OFF FROM THE LOT TO THE STREET AND ADJACENT PROPERTY.

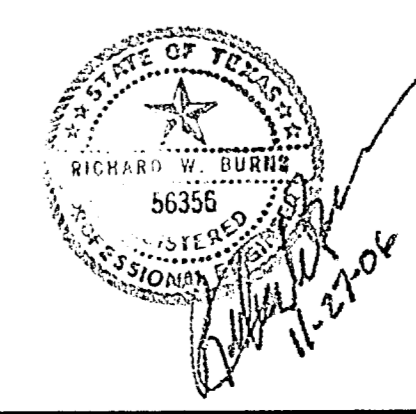

REVISED 01/18/07, COMBINED SAN. SEWER SERV. & SAND TRAP SERV
REVISED 01/18/07, ADJUSTED FINAL GRADES
REVISED 01/06/07 PER CITY COMMENTS DATED 01/04/07
REVISED 12/29/06 PER CITY COMMENTS DATED 12/20/06

GRADING & EROSION CONTROL PLAN
LOT 12, BLOCK B, ADDISON
AIRPORT INDUSTRIAL DISTRICT
ENTERPRISE RENT-A-CAR
15500 MIDWAY ROAD
ADDISON, TEXAS
AMC BUILDING COMPANY
4040 VERNON WAY
KELLER, TEXAS 76248
TEL. : 817.296.2895, FAX. : 817.741.7322

KMT, INC., RICHARD W. BURNS, P.E.
P. O. BOX 1775
KELLER, TEXAS 76244
TEL. : 817.431.3785
FAX. : 817.431.8272

REVISED : 01/18/07
REVISED : 01/06/07
REVISED : 12/29/06
PREPARED : 11/27/06