

© Vilbig & Associates, Inc. Unauthorized duplication is prohibited.

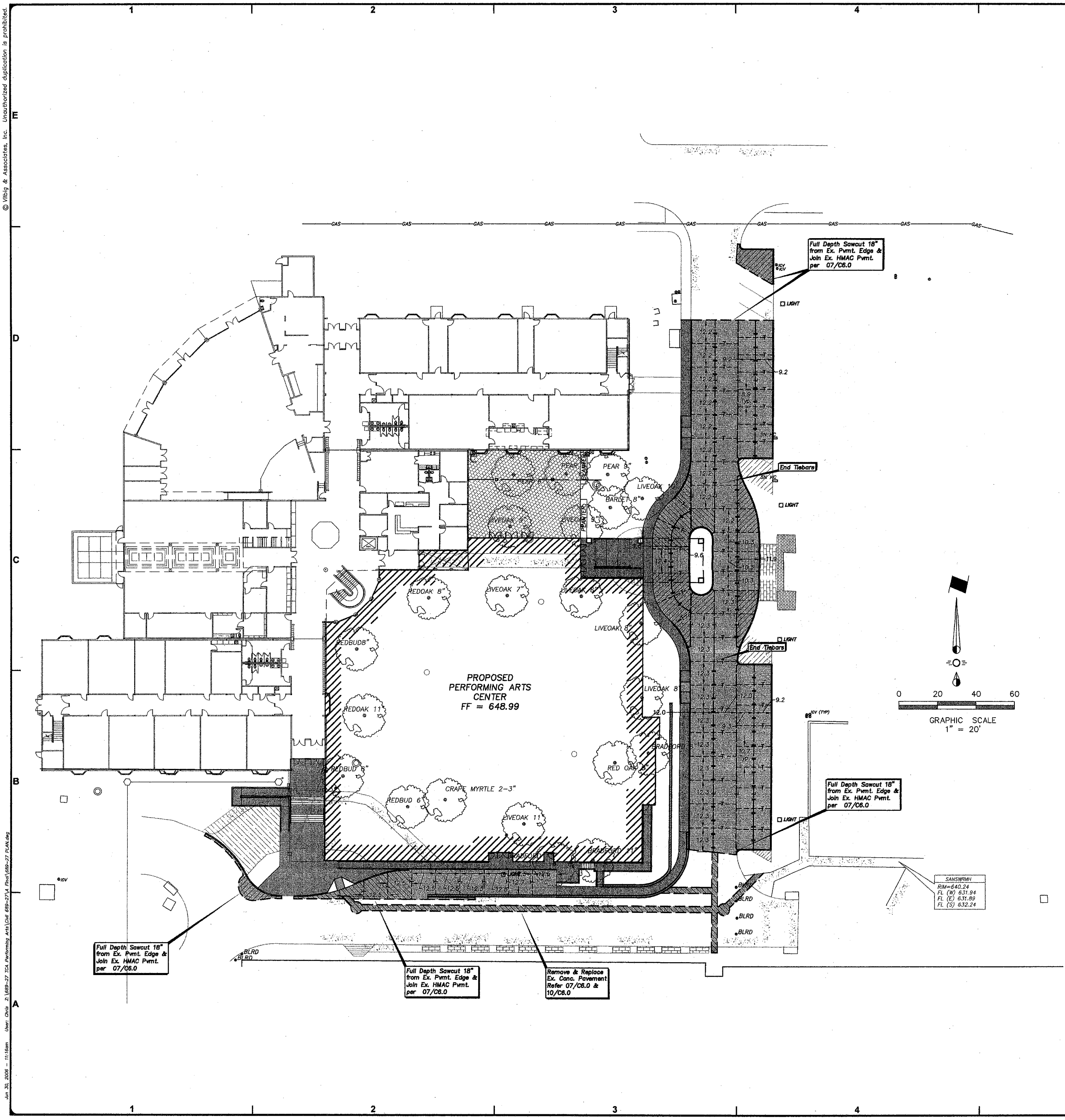

- PAVING NOTES**
- Final paving, curb and sidewalk elevations will be placed at  $\pm 0.03$  foot. Paved areas shall have sawcut joints per details at spacing of 12.5' (12'-6\"/>

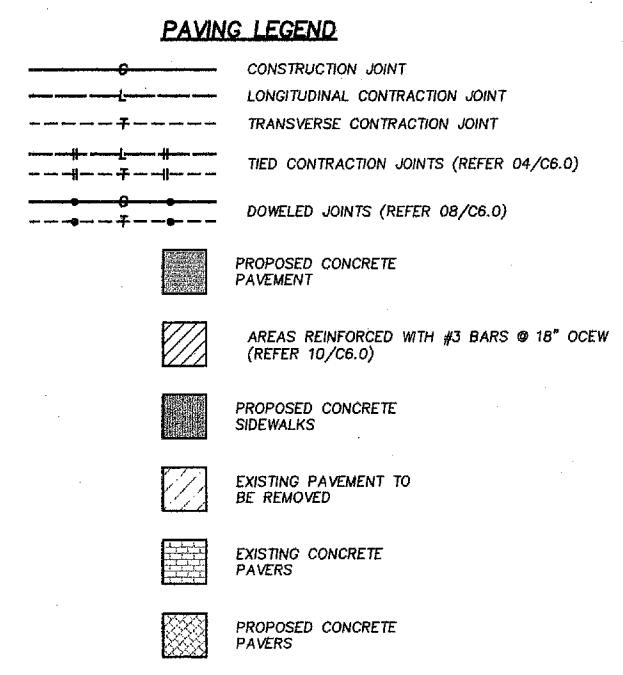

DRAWING PREPARED BY:  
**VILBIG & ASSOCIATES, INC.**  
 CONSULTING ENGINEERS & SURVEYORS  
 10132 MONROE DRIVE DALLAS, TEXAS 75228  
 (214) 352-7333 fax (214) 352-0999

COMPANY:  
**BCW SUPPLY**  
 2809 WASHINGTON BLVD.  
 CODYEN, UTAH 84001  
 PHONE: 801-621-4761

PROJECT:  
**BCW Building Grid's Way**  
 THE DRAWING IS A COMPUTER GENERATED FILE. THE USER HAS ACCEPTED THE TERMS AND CONDITIONS OF THE LICENSE AGREEMENT FOR THE SOFTWARE. THE USER HAS ACCEPTED THE TERMS AND CONDITIONS OF THE LICENSE AGREEMENT FOR THE SOFTWARE. THE USER HAS ACCEPTED THE TERMS AND CONDITIONS OF THE LICENSE AGREEMENT FOR THE SOFTWARE.

**TRINITY CHRISTIAN ACADEMY  
 NEW PERFORMING ARTS BLDG.  
 EARLY SITE & FOUNDATION PACKAGE  
 17001 ADDISON RD., ADDISON, TX 75001**

**PAVING PLAN**

Project: AS-081

C5.0

DATE: June 30, 2008  
 ENGINEER: David A. Vilbig, P.E.  
 PROJECT MANAGER: Chris Wilton, P.E.  
 CHECKED: [Signature]  
 DWG: [Signature]

Original Issue Date: June 30, 2008  
 Engineer: David A. Vilbig, P.E.  
 Project Manager: Chris Wilton, P.E.  
 Checked: [Signature]  
 Dwg: [Signature]

DATE: June 30, 2008  
 USER: [Signature]  
 FILE: [Signature]

DATE: June 30, 2008  
 USER: [Signature]  
 FILE: [Signature]

DO NOT SCALE DRAWING