

User: Chris, 2/15/08-27/101, Performance, A41, CIV, 658-2714, Proj: 658-2714, Rev: 1
 Jan 30, 2008 - 4:38pm © Vilbig & Associates, Inc. Unauthorized duplication is prohibited.

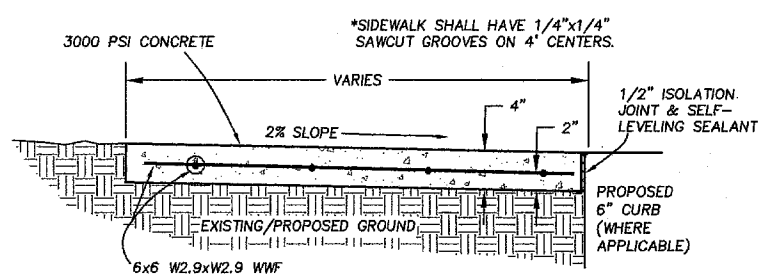

01 SIDEWALK DETAIL
NOT TO SCALE

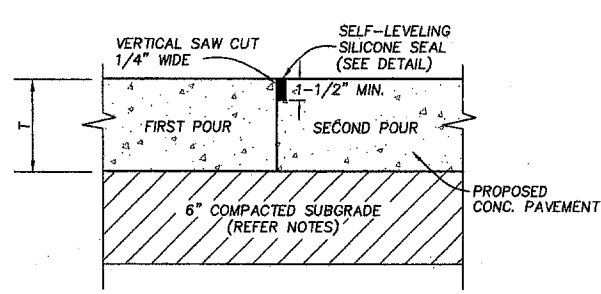

02 LONGITUDINAL OR TRANSVERSE CONSTRUCTION JOINT
NOT TO SCALE

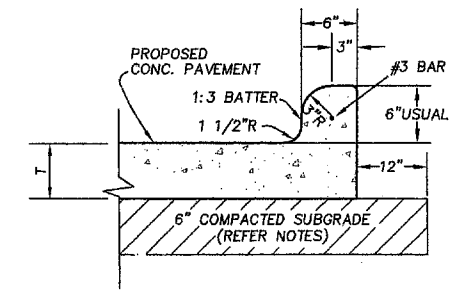

03 INTEGRAL 6\"/>

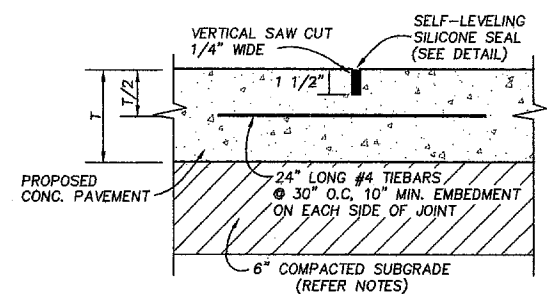

04 LONGITUDINAL OR TRANSVERSE TIED CONSTRUCTION JOINT
NOT TO SCALE

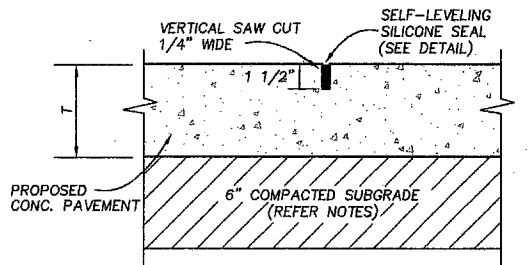

05 LONGITUDINAL OR TRANSVERSE CONSTRUCTION JOINT
NOT TO SCALE

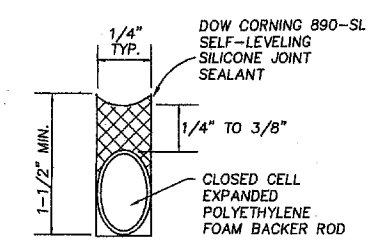

06 JOINT SEAL DETAIL
NOT TO SCALE

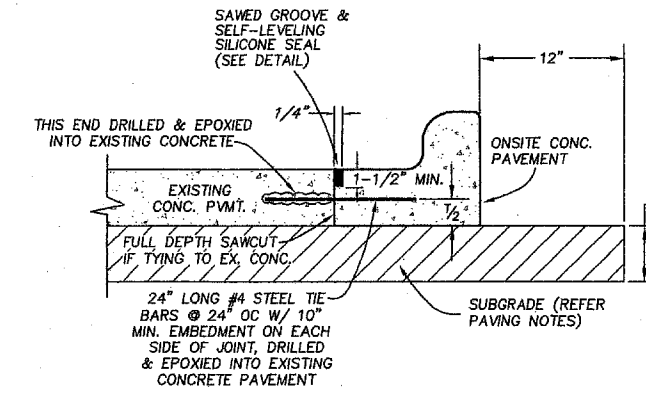

07 CONC. PVMT. CONNECTION @ CURB
NOT TO SCALE

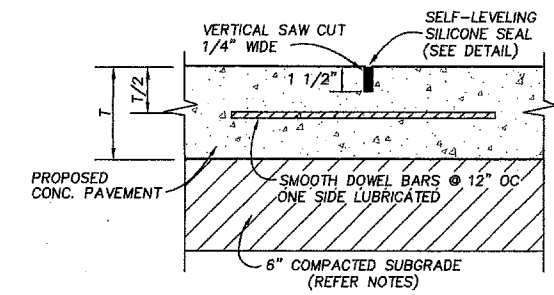

08 LONGITUDINAL OR TRANSVERSE DOWELED CONSTRUCTION JOINT
NOT TO SCALE

| DOWEL BAR SCHEDULE | | | |
|--------------------|----------|------------|----------------------------|
| THICKNESS | BAR DIA. | BAR LENGTH | MIN. EMBEDMENT (EACH SIDE) |
| 5" | 5/8" | 12" | 5" |
| 6" | 3/4" | 14" | 6" |
| 7" | 7/8" | 14" | 6" |
| 8" | 1" | 14" | 6" |

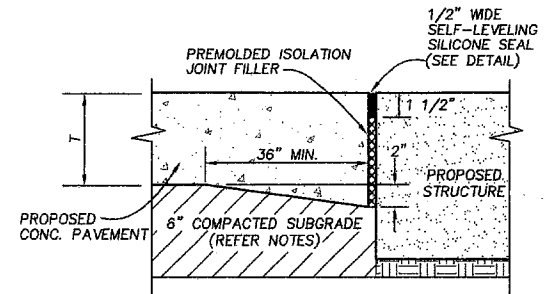

09 ISOLATION JOINT
NOT TO SCALE

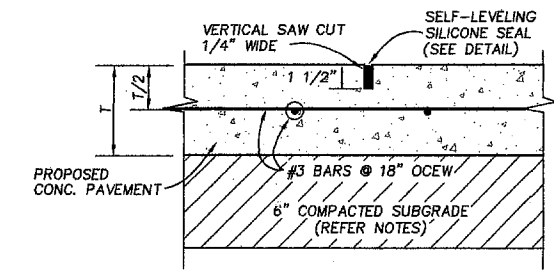

10 REINFORCEMENT DETAIL
* FOR USE ONLY WHERE INDICATED ON PLAN NOT TO SCALE

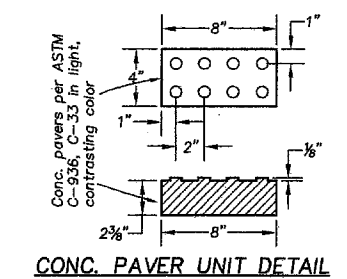

CONC. PAVER UNIT DETAIL

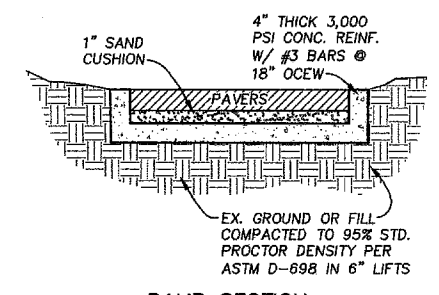

RAMP SECTION

13 RAMP PAVER DETAIL
NOT TO SCALE

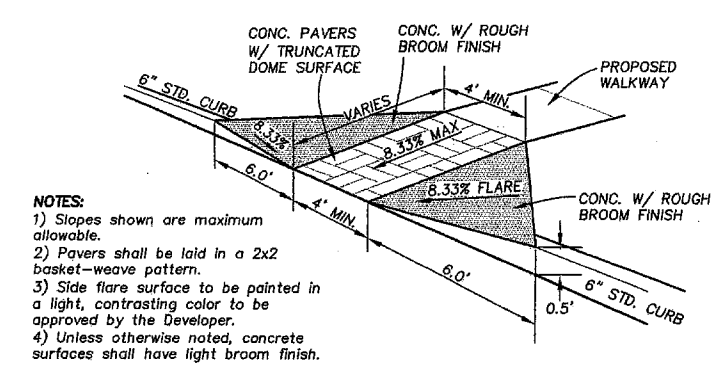

11 TYPE 1 CURB RAMP DETAIL
NOT TO SCALE

- NOTES:**
- 1) Slopes shown are maximum allowable.
 - 2) Pavers shall be laid in a 2x2 basket-weave pattern.
 - 3) Side flare surface to be painted in a light, contrasting color to be approved by the Developer.
 - 4) Unless otherwise noted, concrete surfaces shall have light broom finish.

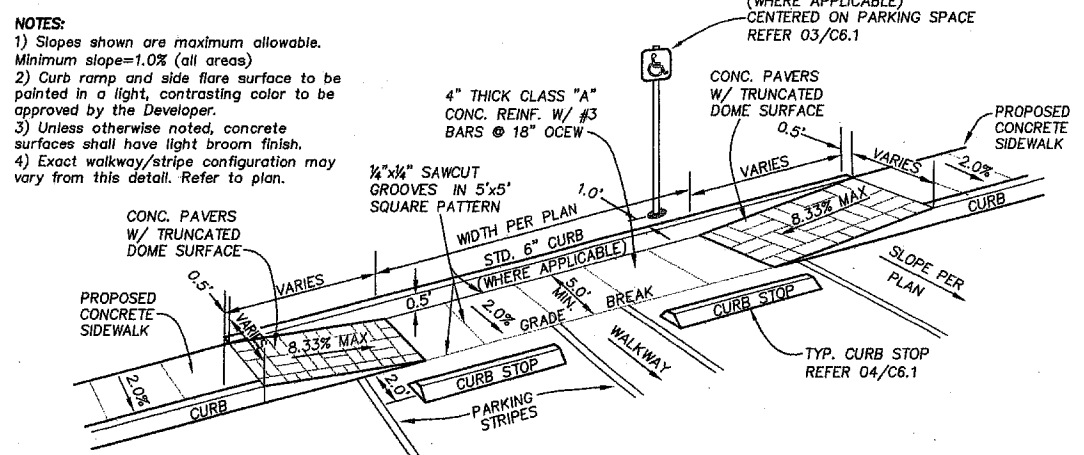

12 TYPE 2 CURB RAMP & PARKING DETAIL
NOT TO SCALE

- NOTES:**
- 1) Slopes shown are maximum allowable. Minimum slope=1.0% (all areas)
 - 2) Curb ramp and side flare surface to be painted in a light, contrasting color to be approved by the Developer.
 - 3) Unless otherwise noted, concrete surfaces shall have light broom finish.
 - 4) Exact walkway/stripe configuration may vary from this detail. Refer to plan.

COMPANY: 2900 WASHINGTON BLVD. COBLEN, UTAH 84001 PHONE: 801-561-4781

SUPPLY: BOW BUILDERS' CODE'S WAREHOUSE

Original Issue Date: June 30, 2008
 Designer: David A. Vilbig, P.E.
 Project Manager: Chris Wilburn, P.E.
 Checker: Chris Wilburn, P.E.

Description: PAVING DETAILS

Date:

Rev:

TRINITY CHRISTIAN ACADEMY
 NEW PERFORMING ARTS BLDG.
 EARLY SITE & FOUNDATION PACKAGE
 17001 ADDISON RD., ADDISON, TX 75001

PAVING DETAILS

DRAWING PREPARED BY:
 VILBIG & ASSOCIATES, INC.
 CONSULTING ENGINEERS & SURVEYORS
 10132 MONROE DRIVE DALLAS, TEXAS 75229
 (214) 352-7333 fax (214) 352-0999

Project: AS-081

DO NOT SCALE DRAWING

C6.0