

CONSTRUCTION DOCUMENTS FOR ADDISON AIRPORT ACCESS ROAD REALIGNMENT

CITY COUNCIL

JOE CHOW, MAYOR

GREGORY S. HIRSCH,
MAYOR PRO TEMPORE

TOM BRAUN,
DEPUTY MAYOR PRO TEMPORE

DENNIS KRAFT

TODD MEIER

ROGER S. MELLOW

JIMMY NIEMANN

CITY MANAGER

RON WHITEHEAD

DIRECTOR OF PUBLIC WORKS

NANCY STRAUB CLINE, P.E.

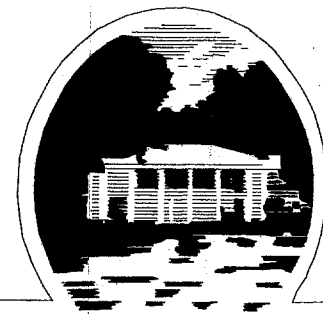

T O W N O F
ADDISON

PUBLIC WORKS NO. 2007-004

SHEET NO.	INDEX OF SHEETS
C1	COVER SHEET / LOCATION MAP
C2	GENERAL NOTES
C3	PAVING PLAN
C4	EROSION & SEDIMENTATION CONTROL PLAN
C5	EROSION & SEDIMENTATION CONTROL DETAILS
C6	PAVING DETAILS

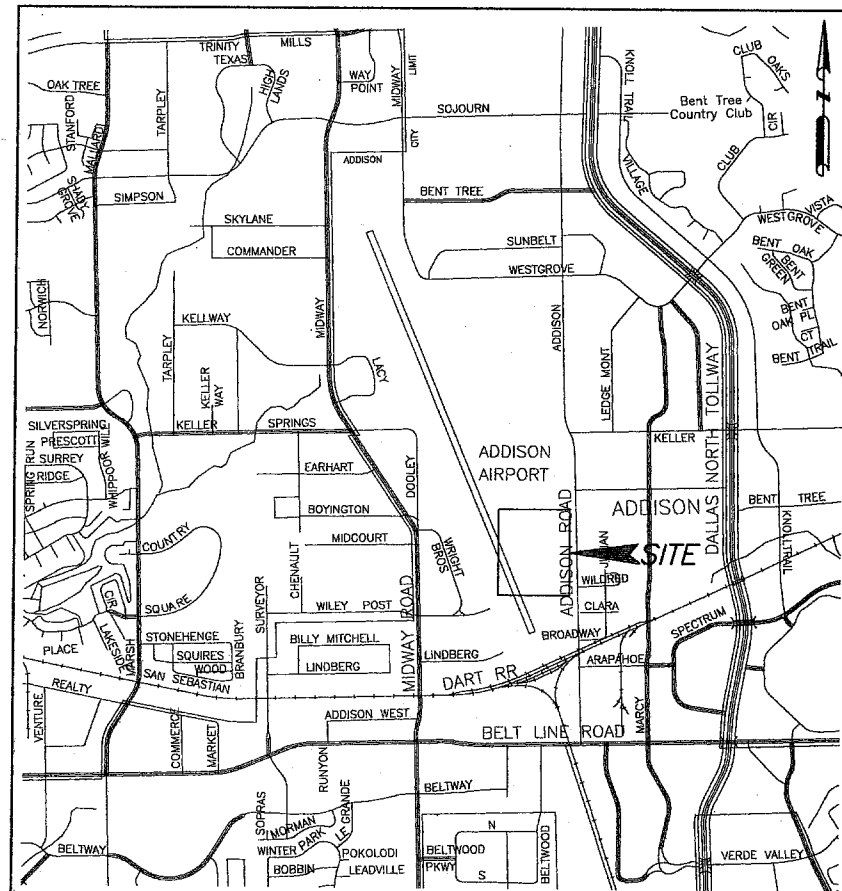

LOCATION MAP
NOT TO SCALE

ENGINEER
TOWN OF ADDISON
DEPARTMENT OF PUBLIC WORKS
16801 WESTGROVE DRIVE
ADDISON, TEXAS 75001
(972) 450-2871
CONTACT: CLAY BARNETT, P.E.

JUNE, 2007

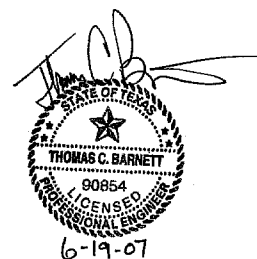

2007-08

ADDISON AIRPORT ACCESS ROAD REALIGNMENT

P:\Public\Projects\Airport\Access Road Realignment\Plans\Drawings\2007-04-20\04-20.dwg The Jun 19 16:03:28 2007