

90-8008



7291 GLENVIEW DRIVE
FORT WORTH, TX 76180
P 817.589.1722
F 817.595.2916
www.gsbsarchitects.com

THESE DRAWINGS ARE INCOMPLETE AND MAY NOT BE USED FOR REGULATORY APPROVAL, PERMIT OR CONSTRUCTION.

THOMAS E. BATENHORST
11360

REGISTRATION # DATE OF ISSUE
ENDORSE DATE

ALL REPORTS, PLANS, SPECIFICATIONS, CONTRACTS, FIELD DATA, NOTES, AND OTHER RECORDS AND INSTRUMENTS PREPARED BY GSBS ARCHITECTS ARE THE PROPERTY OF GSBS ARCHITECTS. NO PART OF THIS DRAWING OR INSTRUMENT SHALL BE REPRODUCED OR TRANSMITTED IN ANY FORM OR BY ANY MEANS, INCLUDING PHOTOCOPYING, RECORDING, OR BY ANY INFORMATION STORAGE AND RETRIEVAL SYSTEM, WITHOUT THE WRITTEN PERMISSION OF GSBS ARCHITECTS.

No.	DATE	REVISION

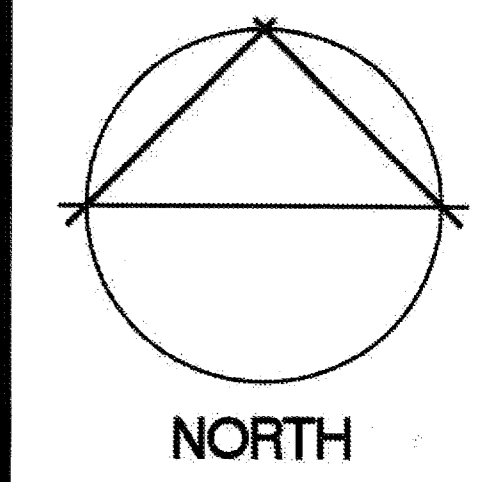

NORTH

BEST PRESS, INC.

4201 AIRBORN DR.
ADDISON, TX 75001

DESIGN DOCUMENTS

OVERALL FLOOR PLAN

PROJECT NO.
2007-T52-00

FEBRUARY
DRAWN

CHECKED

Fire Sprinkler and Fire Alarm Systems must conform to applicable NFPA standards. Submit plans to Fire Dept BEFORE installation or modification.

Building fire alarm shall be audible throughout.
Visual notification required in public & common areas.

Provide one fire extinguisher for each 3000 sq. ft. 75' max. travel distance.

Security / locking system plans shall be reviewed by the Fire Department BEFORE installation.

DISCLAIMER:
THE EXISTING PLAN WAS OWNER FURNISHED TO GSBS. GSBS DOES NOT TAKE RESPONSIBILITY FOR THE ACCURACY AND COMPLETENESS OF THE EXISTING PLAN.

OVERALL FLOOR PLAN A1
SCALE: 1/16" = 1'-0" A1.2

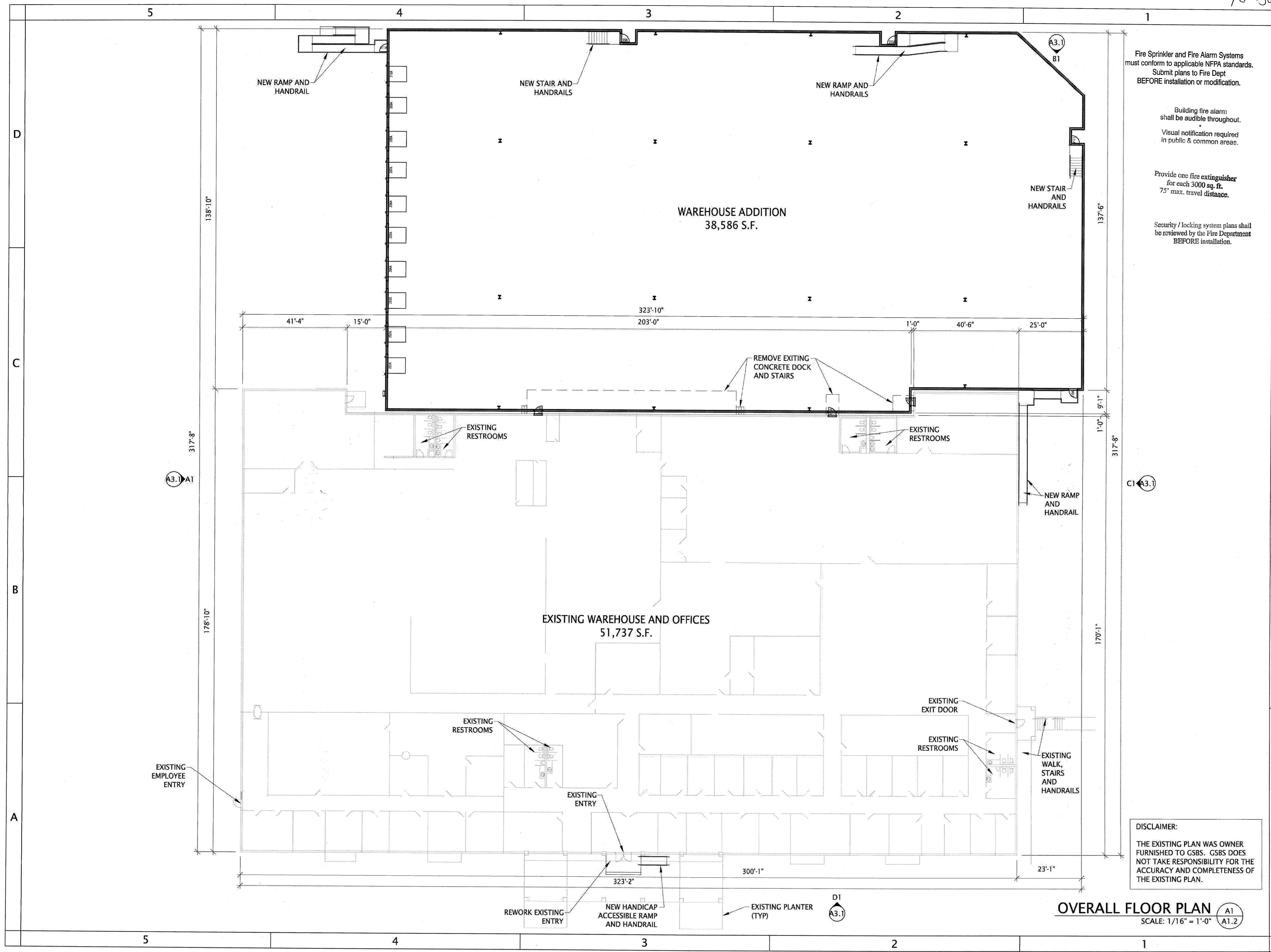

WAREHOUSE ADDITION
38,586 S.F.

EXISTING WAREHOUSE AND OFFICES
51,737 S.F.

EXISTING EMPLOYEE ENTRY

EXISTING RESTROOMS

EXISTING ENTRY

REWORK EXISTING ENTRY

NEW HANDICAP ACCESSIBLE RAMP AND HANDRAIL

EXISTING PLANTER (TYP)

EXISTING EXIT DOOR

EXISTING RESTROOMS

EXISTING WALK, STAIRS AND HANDRAILS

NEW RAMP AND HANDRAIL

NEW STAIR AND HANDRAILS

NEW RAMP AND HANDRAILS

NEW STAIR AND HANDRAILS

NEW RAMP AND HANDRAIL

REMOVE EXISTING CONCRETE DOCK AND STAIRS

EXISTING RESTROOMS

EXISTING RESTROOMS

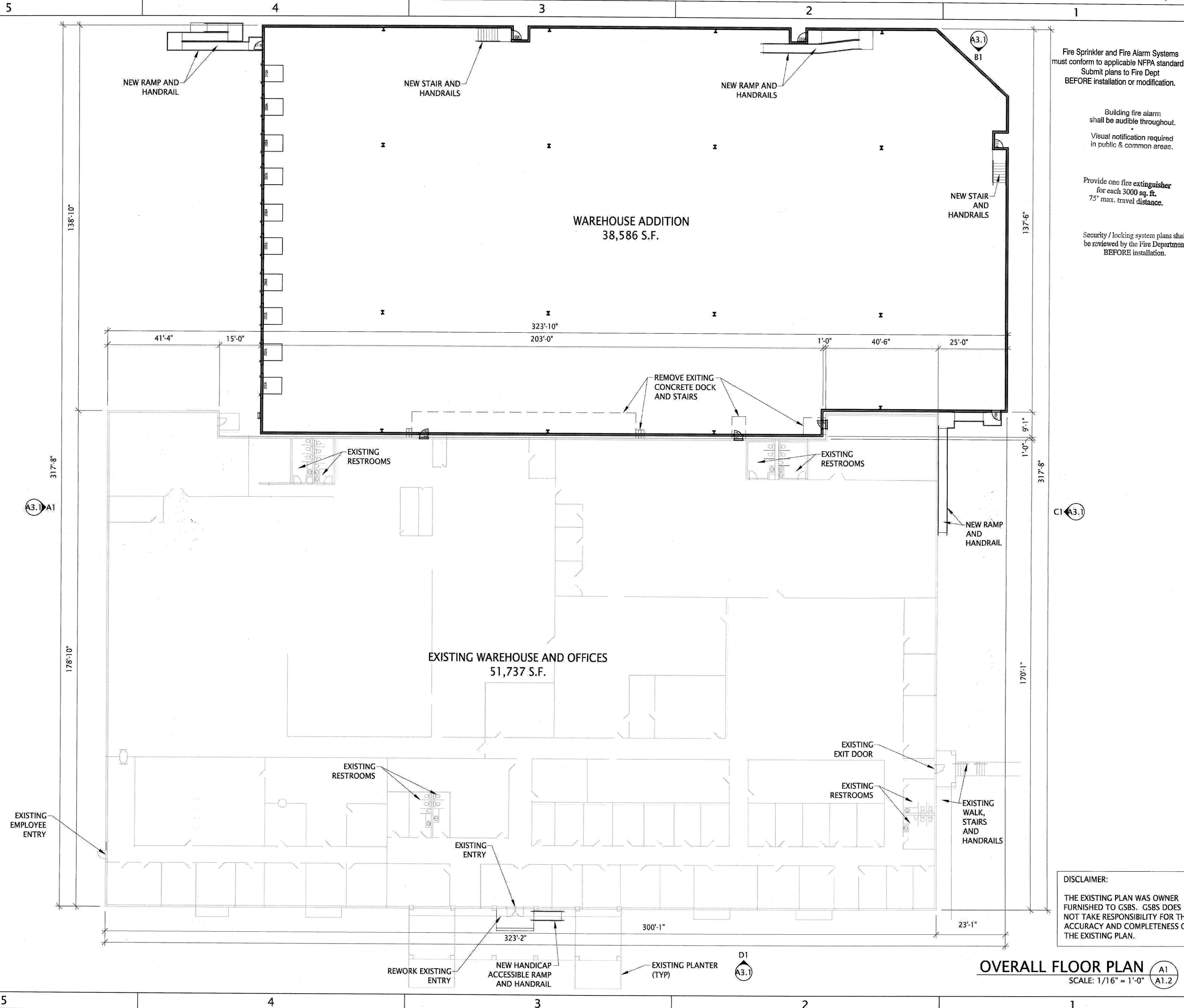

138'-10"

317'-8"

178'-10"

5

4

3

2

1

41'-4"

15'-0"

323'-10"

203'-0"

1'-0"

40'-6"

25'-0"

137'-6"

9'-1"

317'-8"

170'-1"

300'-1"

23'-1"

D1
A3.1

A1
A1.2