

- LEGEND**
- CV = CHECK VALVE
  - DE = DRAINAGE EASEMENT
  - EA = EDGE ASPHALT
  - EC = EDGE CONCRETE
  - FH = FIRE HYDRANT
  - GM = GAS METER
  - LP = LIGHT POLE
  - OHE = OVERHEAD ELECTRIC
  - PP = POWER POLE
  - SH = SPRINKLER HEAD
  - SS = SANITARY SEWER
  - SSCO = SANITARY SEWER CLEANOUT
  - SV = SPRINKLER VALVE
  - TEL = TELEPHONE STRUCTURE
  - TMK = TELEPHONE STRUCTURE
  - TP = TOP OF PAVEMENT
  - UE = UTILITY EASEMENT
  - UG-E = UNDERGROUND ELECTRIC
  - UG-T = UNDERGROUND TELEPHONE
  - W = WATER
- = PROPOSED WATER MAIN  
 = PAVEMENT REPLACEMENT WITH 8,000 PSI REINF. CONCRETE  
 = SIDEWALK REPLACEMENT WITH 6,000 PSI REINF. CONCRETE  
 = EXISTING WATER VALVE

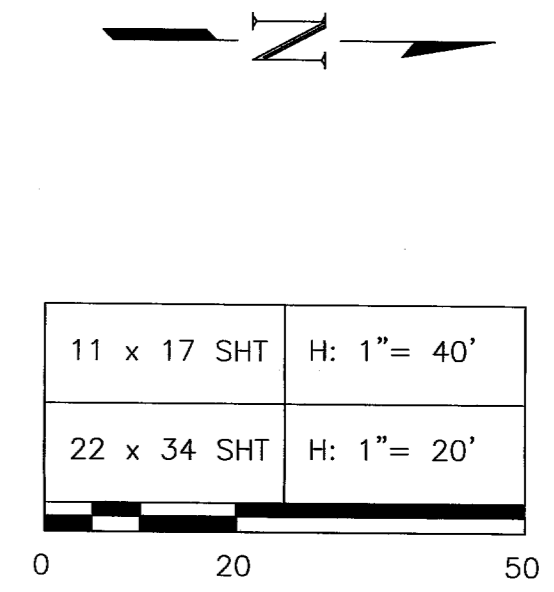

*See Attached*

*Exist 8" (66) to Clearcut Apts. Inplant*

*Any piping for hydrant line extensions is to be Class 200.*

*ACCORDING TO DAVE, THIS SECTION OF WATER LINE WAS LOWERED BECAUSE THE SANITARY SEWER SERVICE IS SHALLOW.*

*Some portions of concrete replacement may require fast-set concrete to minimize closure and to facilitate access ASAP, as needed.*

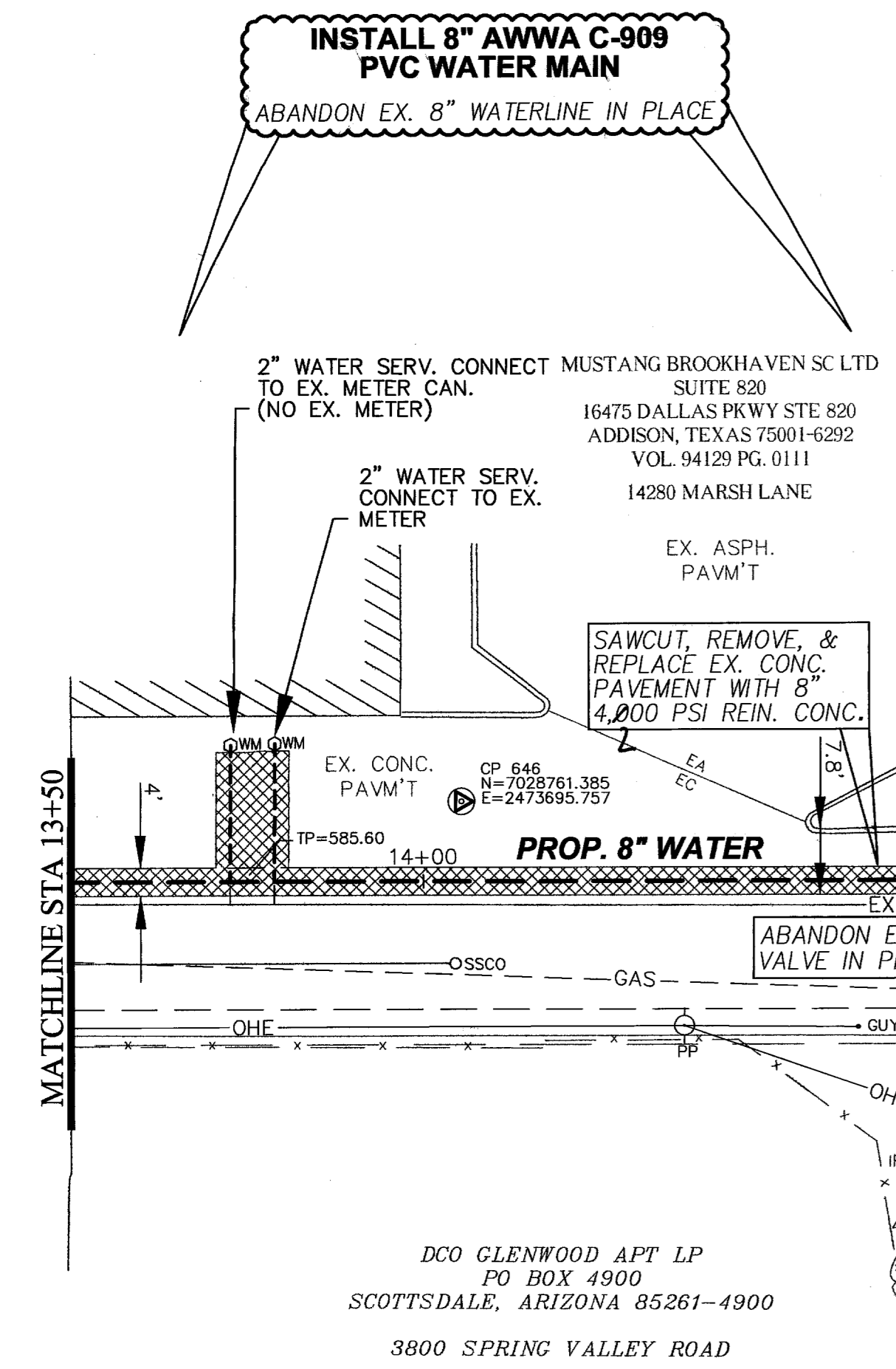

*This is a proposed line. Please add a note above for connection to this line.*

*3-8" VALVES*

- CAUTION !!**  
EXISTING GAS SERVICE ARE PRESENT, LOCATION NOT KNOWN.
- NOTICE !!**  
THE CONTRACTOR SHALL PRESERVE AND PROTECT EXISTING DRIVEWAYS AT ALL TIMES DURING CONSTRUCTION.
- NOTICE !!**  
THE CONTRACTOR SHALL MAINTAIN WATER SERVICE AT ALL TIMES DURING CONSTRUCTION.
- NOTICE !!**  
THE CONTRACTOR SHALL TAKE THE NECESSARY PRECAUTIONS TO PROTECT ALL OVERHEAD UTILITIES FROM DAMAGE. REPAIR OF DAMAGED UTILITIES WILL AT THE CONTRACTOR'S OWN EXPENSE.

**PRELIMINARY**  
NOT FOR CONSTRUCTION BIDDING, OR PERMIT PURPOSES. FOR REVIEW ONLY.

**GSWW, Inc.**  
QUINN G. SPANN, JR. P.E. No. 68109  
Date: 05/16/2008

- BENCHMARKS:**
- CP 1 = "X" SET IN THE SOUTH SIDE OF A CONCRETE DRIVE 55 FEET EAST FROM THE CURB OF MARSH LANE, 39.4 FEET NORTH OF THE NORTH FACE OF THE BURGER HOUSE BUILDING AT 14248 MARSH LANE. ELEV.= 565.46
  - CP 3 = "X" SET IN THE SOUTH SIDE OF A CONCRETE DRIVE 404 FEET EAST FROM THE CURB OF MARSH LANE, 17 FEET EAST FROM A SANITARY SEWER MAN HOLE, 8 FEET NORTH OF AN INLET RIM. ELEV.=572.39
  - CP 4 = "X" SET IN THE CONCRETE PAVING AT THE SOUTHEAST CORNER OF 14280 MARSH LANE, 19.2 FEET SOUTHEAST FROM THE SOUTHEAST BUILDING CORNER, 17.7 FEET SOUTH FROM A WATER VAULT. ELEV.= 576.44
  - CP 5 = "X" SET IN THE EAST SIDE OF A CONCRETE DRIVE 300 FEET SOUTH FROM THE SOUTH BACK OF CURB OF SPRING VALLEY DRIVE, 7.5 FEET WEST FROM THE EAST EDGE OF PAVING. ELEV.=581.81
  - CP 6 = "X" SET IN THE NORTH WALK OF SPRING VALLEY BOULEVARD NORTH OF ITS INTERSECTION WITH A CONCRETE DRIVE BETWEEN 3900 SPRING VALLEY ROAD AND 14280 MARSH LANE, 17.9 FEET SOUTHWEST FROM A POWER POLE, 3.2 FEET NORTH OF THE NORTH BACK OF CURB OF SPRING VALLEY ROAD. ELEV.=586.26

REVISION NO.	DESCRIPTION	BY	DATE
<b>TOWN OF ADDISON, TEXAS</b> PUBLIC WORKS DEPT. - ENGINEERING DIVISION			
<b>GREENHAVEN WATERLINE RECONSTRUCTION</b>			
<b>STA 9+50 TO STA 14+96</b>			
<b>GSWW, Inc.</b>			
DESIGN:	GSWW	SCALE:	AS NOTED
DRAWN:	GSWW	<b>Addison!</b>	
APPROVED:	QGS		
DATE:	MAY, 2008		
		SCALE:	<b>5 OF 5</b>