

MATCH LINE BELT LINE ROAD STA 58+00

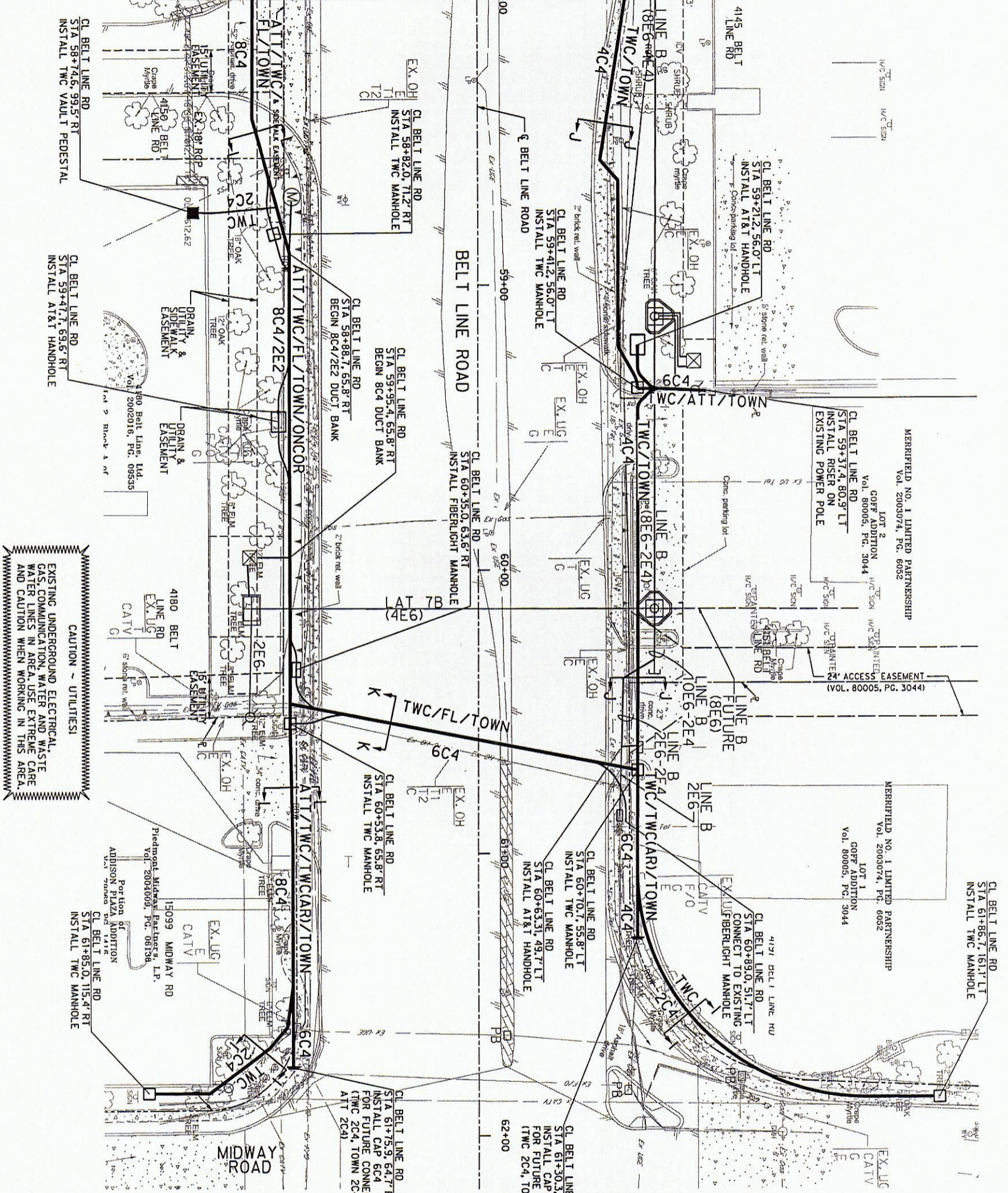

EXISTING UNDERGROUND ELECTRICAL, GAS, COMMUNICATION, WATER AND WASTE WATER LINES IN AREA. USE EXTREME CARE AND CAUTION WHEN WORKING IN THIS AREA.

EXISTING UTILITY LOCATIONS SHOWN ARE SCHEMATIC IN NATURE AND MAY NOT ACCURATELY REFLECT THE SIZE AND LOCATION OF EACH PARTICULAR UTILITY. SOME UTILITY LINES MAY NOT BE SHOWN. CONTRACTOR SHALL ASSUME RESPONSIBILITY FOR ACTUAL FIELD LOCATION AND PROTECTION OF ALL EXISTING UTILITIES WHETHER SHOWN OR NOT. CONTRACTOR SHALL ALSO ASSUME RESPONSIBILITY FOR REPAIRS TO EXISTING UTILITIES, WHETHER SHOWN OR NOT, DAMAGED BY CONTRACTOR'S ACTIVITIES. DIFFERENCES IN HORIZONTAL OR VERTICAL LOCATION OF EXISTING UTILITIES SHALL NOT BE A BASIS FOR ADDITIONAL COMPENSATION. CALL 1-800-344-8377 TWO WORKING DAYS PRIOR TO CONSTRUCTION FOR ONSITE LOCATIONS.

LEGEND

- ONCOR SEE ONCOR DUCT BANK PLAN SHEETS FOR ONCOR LOAD CABLES TO BE LOCATED IN JOINT TRENCH.
- ATT PROPOSED AT&T TELEPHONE LINE (2-4" PVC)
- ATT(F)O PROPOSED AT&T FIBER OPTIC LINE (2-4" PVC)
- FL PROPOSED FIBERLIGHT LINE (2-4" PVC)
- TWC PROPOSED TIME WARNER CABLE LINE REQUIRED TO REPLACE EXISTING TIME WARNER CABLE (2-4" PVC) ADDITIONAL REQUESTED PROPOSED TIME WARNER CABLE LINE (2-4" PVC)
- TWC(AR) PROPOSED TOWN OF ADDISON LINE (2-4" PVC)
- TOWN PROPOSED TIME WARNER PULL BOX
- PROPOSED TIME WARNER PEDESTAL/VAULT
- PROPOSED AT&T HANDHOLE
- PROPOSED FIBERLIGHT HANDHOLE
- ATT/TWC/FL/ONCOR PROPOSED AT&T, TIME WARNER CABLE ONCOR AND FIBERLIGHT LINE IN JOINT TRENCH
- BY OTHER THAN OPEN CUT
- B.O.T.O.C.

NOTE:  
1. ALL LINES TO BE INSTALLED BY OPEN CUT UNLESS OTHERWISE NOTED.

Signature of Registrant: *Chad...* P.E. 3-25-14  
Date: 3-25-14  
FIRM REGISTRATION NUMBER: 312



TOWN OF ADDISON  
DALLAS COUNTY, TEXAS  
BELT LINE ROAD  
UNDERGROUND ELECTRICAL

TELECOM RELOCATION PLAN  
BELT LINE RD STA 58+00 TO STA 62+00

HALFF  
1201 NORTH BOWSER ROAD, RICHARDSON, TEXAS 75081-2275  
TEL (214) 346-6200 FAX (214) 739-0995

PROJECT	DESIGN	DRAWN	DATE	FILE	SHEET
29350	HALFF	HALFF	MAR. 2014	29350 TEL 07A	TEL-7A

