

NOTE: SEE MECHANICAL (M 213) FOR WATER METER VALVE DETAIL

# TEXAS POWER & LIGHT 100' R.O.W.

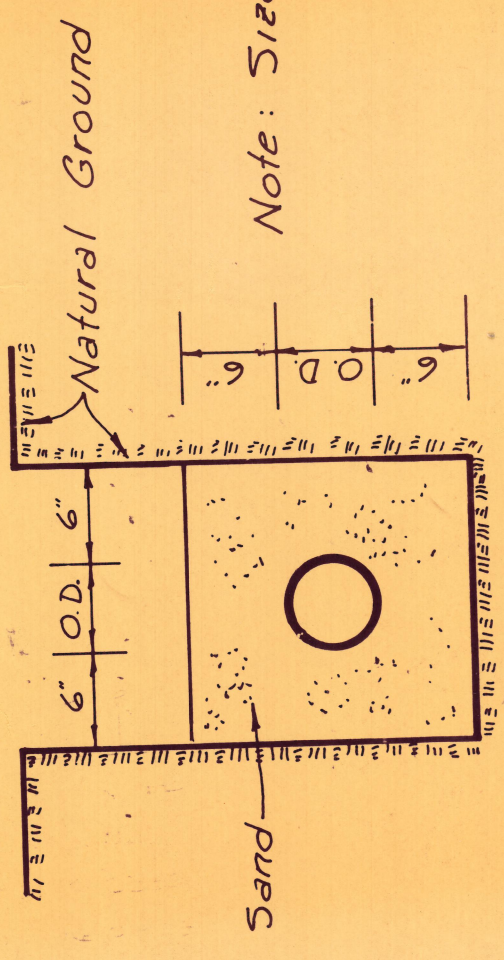
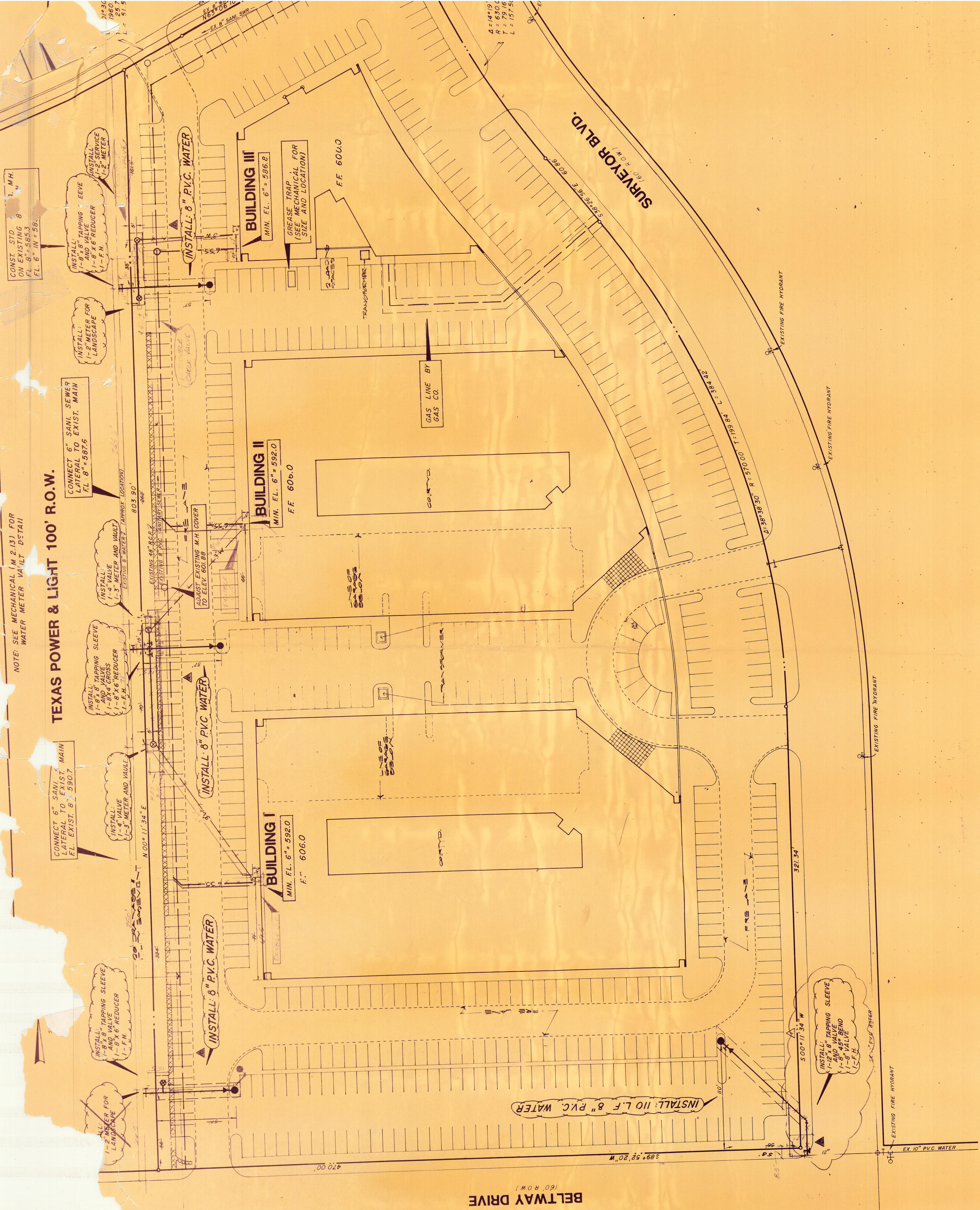

Note: Size of Pipe Varies

### GENERAL NOTES

1. ALL MATERIALS AND WORKMANSHIP SHALL CONFORM TO THE CITY OF ADDISON STANDARDS AND SPECIFICATIONS.
2. ALL WATER MAINS SHALL BE PVC SDR-18 WATER PIPE (BLUE BRUTE WITH WIRE TRACERS) AND SPECIFICATIONS.
3. ALL WATER MAINS SHALL HAVE MINIMUM COVER BELOW FINISHED GRADES AS FOLLOWS:  
6" & 8" - 48" OR AS REQUIRED TO CLEAR OTHER UTILITIES.
4. ALL TRENCH BACKFILL FOR UTILITIES SHALL BE COMPACTED AS REQUIRED BY CITY, BUT IN NO CASE SHALL THE TOP 12" BE COMPACTED TO LESS THAN 90% AASHTO DENSITY WITH THE REMAINDER OF THE DITCH BEING COMPACTED TO THAT OF ADJOINING SOIL CONDITIONS.
5. CONTRACTOR TO VERIFY LOCATION OF ALL UTILITIES PRIOR TO BEGINNING WORK AND SHALL PROTECT EXISTING IMPROVEMENTS DURING CONSTRUCTION.
6. ALL PIPE EMBEDMENT SHALL BE AS DETAILED ON THIS SHEET.

TYPICAL WATER AND SANITARY SEWER EMBEDMENT DETAIL N.T.S.

BENCH MARK - Square cut on top of curb on east side of BELTWAY BLVD. at 220' south of BELT LINE R.O.W. ELEVATION = 606.0