

STREET NAME SIGNS			
SIGN NO./LOCATION	STREET NAME	BLOCK NO.	MOUNTING
①	MORRIS AVE.	4900	NEW SIGN POLE
	QUORUM DR.	15600	
②	GOODMAN AVE.	4900	NEW SIGN POLE
	QUORUM DR.	15700	
③	PASCHAL PL.	15700	NEW SIGN POLE
	GOODMAN AVE.	4900	
④	PASCHAL PL.	15700	NEW SIGN POLE
	MORRIS AVE.	4900	
⑤	WITT PL.	15600	NEW SIGN POLE
	MORRIS AVE.	4900	
⑥	WITT PL.	15600	NEW SIGN POLE
	ADDISON CIRCLE	4900	

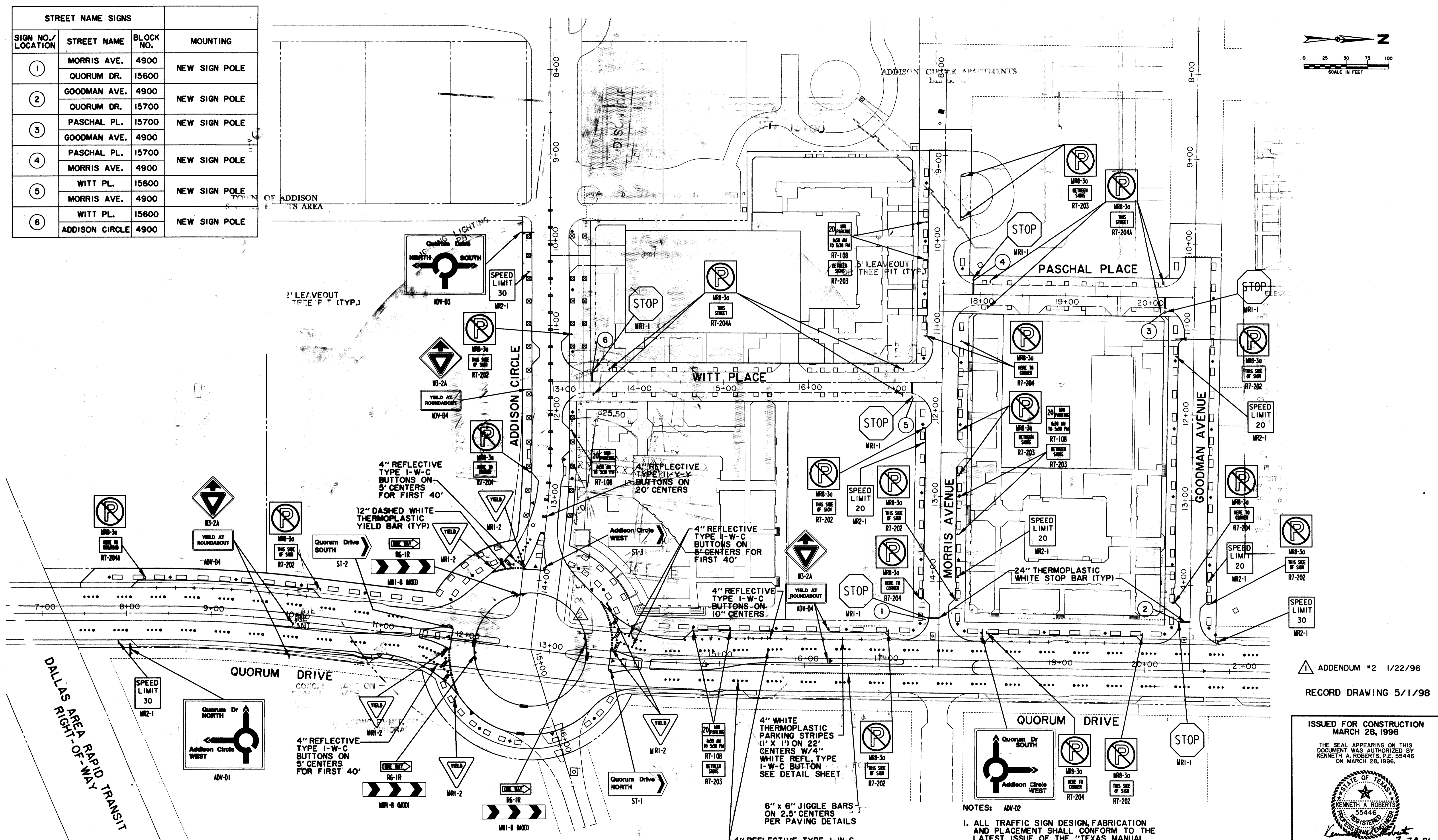
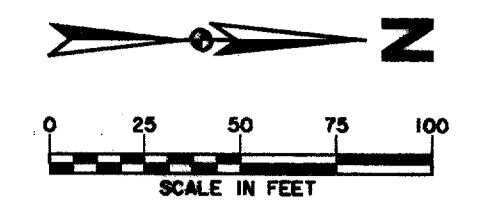

DALLAS AREA RAPID TRANSIT

ADDENDUM #2 1/22/96  
RECORD DRAWING 5/1/98

ISSUED FOR CONSTRUCTION  
MARCH 28, 1996

THE SEAL APPEARING ON THIS DOCUMENT WAS AUTHORIZED BY  
KENNETH A. ROBERTS, P.E. 55446  
ON MARCH 28, 1996.

ENTIRE SHEET REVISED PER ADDENDUM #2

- NOTES:
- ALL TRAFFIC SIGN DESIGN, FABRICATION AND PLACEMENT SHALL CONFORM TO THE LATEST ISSUE OF THE "TEXAS MANUAL ON UNIFORM TRAFFIC CONTROL DEVICES FOR STREETS AND HIGHWAYS".
  - STREET NAME SIGNS ARE TO BE MOUNTED PER TABLE ON THIS DRAWING.
  - PRIOR TO FINAL INSTALLATION OF SIGNS, CONTRACTOR SHALL REVIEW PLACEMENT WITH THE DIRECTOR OF PUBLIC WORKS TO ENSURE PROPER VISIBILITY RELATIVE TO COMPLETION OF OTHER IMPROVEMENTS.
  - MOUNTING HEIGHT OF ALL ONE-WAY WITH CHEVRON SIGNS SHALL BE 1' CLEAR FROM TOP OF CURB TO BOTTOM OF SIGN.
  - SEE SHEET 32 FOR LANE STRIPING DETAILS.

SIGNAGE & STRIPING PLAN						
ADDISON CIRCLE						
PHASE I PUBLIC INFRASTRUCTURE						
TOWN OF ADDISON, TEXAS						
Huiji-Zollars, Inc./Engineering/Architecture						
Dallas, Fort Worth, Houston, El Paso, Phoenix, Tustin, Ontario, San Clemente						
DESIGN	DRAWN	APPR.	SCALE	DATE	PROJECT NO.	NO.
HZI	HZI	KAR	1"=50'	JAN 96	1822-04	17 137