

STREET	STATION	SLEEVE SIZE AND USE
ADDISON CIRCLE	9+87.81	4" SPARE
ADDISON CIRCLE	10+03.54	1-4" IRRIGATION, 1-4" SPARE
ADDISON CIRCLE	11+05.00	2-4" SPARE
ADDISON CIRCLE	11+26.00	1-6" IRRIGATION
ADDISON CIRCLE	12+60.00	1-6" IRRIGATION
ADDISON CIRCLE	13+31.87	3-4" SPARE
ADDISON CIRCLE	13+66.06	1-6" IRRIGATION
ADDISON CIRCLE	13+75.47	6" IRRIGATION
ADDISON CIRCLE	16+23.50	2-4" SPARE, 1-6" IRRIGATION
QUORUM DRIVE	11+46.00	2-4" SPARE, 1-6" IRRIGATION
QUORUM DRIVE	13+03.92	1-4" SPARE, 1-4" IRRIGATION
QUORUM DRIVE	13+13.79	1-4" DATA
QUORUM DRIVE	13+24.03	1-2" FOR ELECTRICAL, 1-3" FOR ELECTRICAL
QUORUM DRIVE	14+15.75	2-4" SPARE & 1-6" IRRIGATION
QUORUM DRIVE	13+85.27	1-6" IRRIGATION
QUORUM DRIVE	20+10.00	1-6" IRRIGATION
WITT PLACE	15+01.50	1-2" FIRE ALARM, 1-2" SECURITY, 1-3" SPARE
WITT PLACE	15+38.31	1-6" IRRIGATION
WITT PLACE	15+56.71	1-6" SPARE
WITT PLACE	15+60.01	2-4" IRRIGATION
WITT PLACE	15+59.00	1-4" SPARE
PASCHAL PLACE	17+91.25	2-3" TV, 2-4" TELEPHONE
PASCHAL PLACE	18+04.50	1-6" IRRIGATION
PASCHAL PLACE	18+36.99	1-4" IRRIGATION
PASCHAL PLACE	18+40.23	1-4" SPARE
PASCHAL PLACE	19+44.79	1-4" IRRIGATION
PASCHAL PLACE	19+45.00	1-6" IRRIGATION
PASCHAL PLACE	19+48.04	1-4" SPARE
PASCHAL PLACE	20+07.29	1-6" IRRIGATION
NORRIS AVENUE	9+68.00	1-6" IRRIGATION
NORRIS AVENUE	10+42.25	2-3" TV, 2-4" TELEPHONE
NORRIS AVENUE	11+08.50	1-2" FIRE ALARM, 1-2" SECURITY, 1-3" SPARE
NORRIS AVENUE	12+36.25	2-3" TV
NORRIS AVENUE	12+62.25	2-4" TELEPHONE, 1-6" IRRIGATION
NORRIS AVENUE	14+40.00	1-6" IRRIGATION
GOODMAN AVENUE	11+55.00	1-6" IRRIGATION

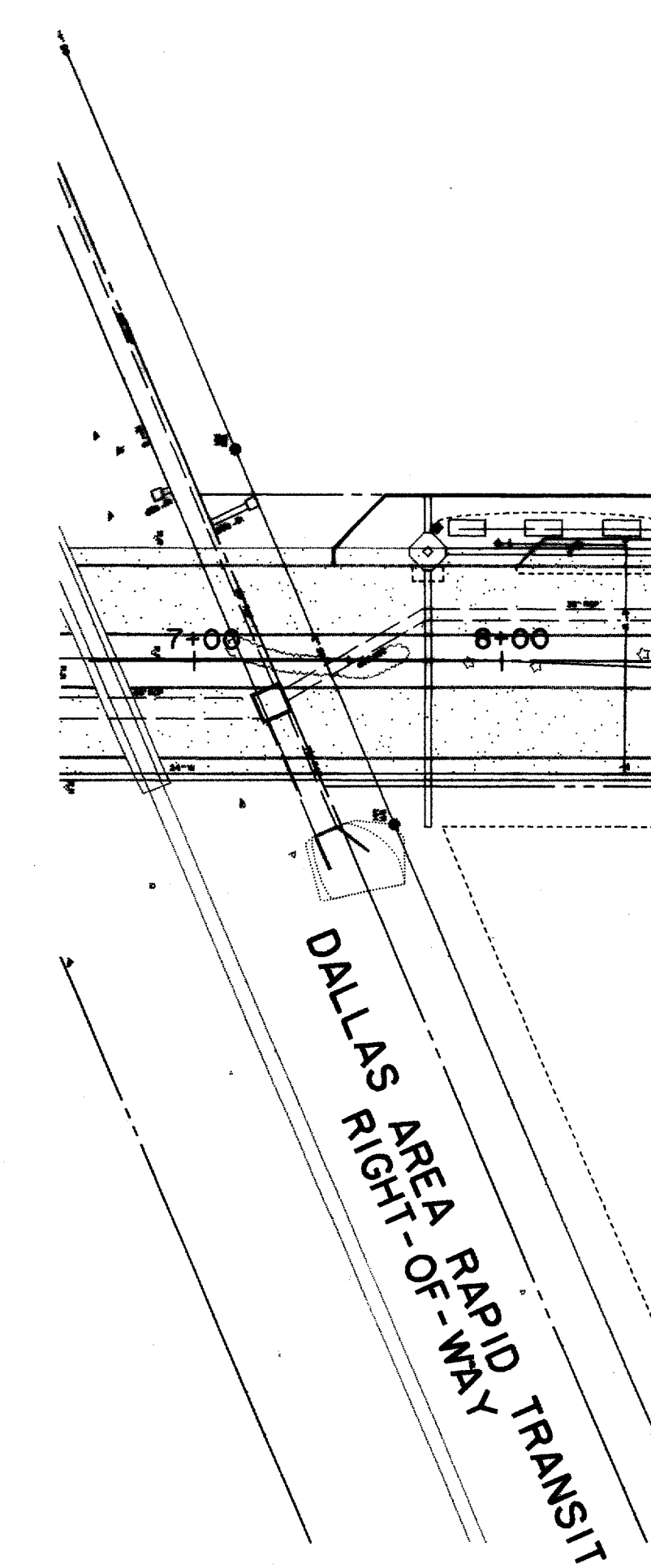
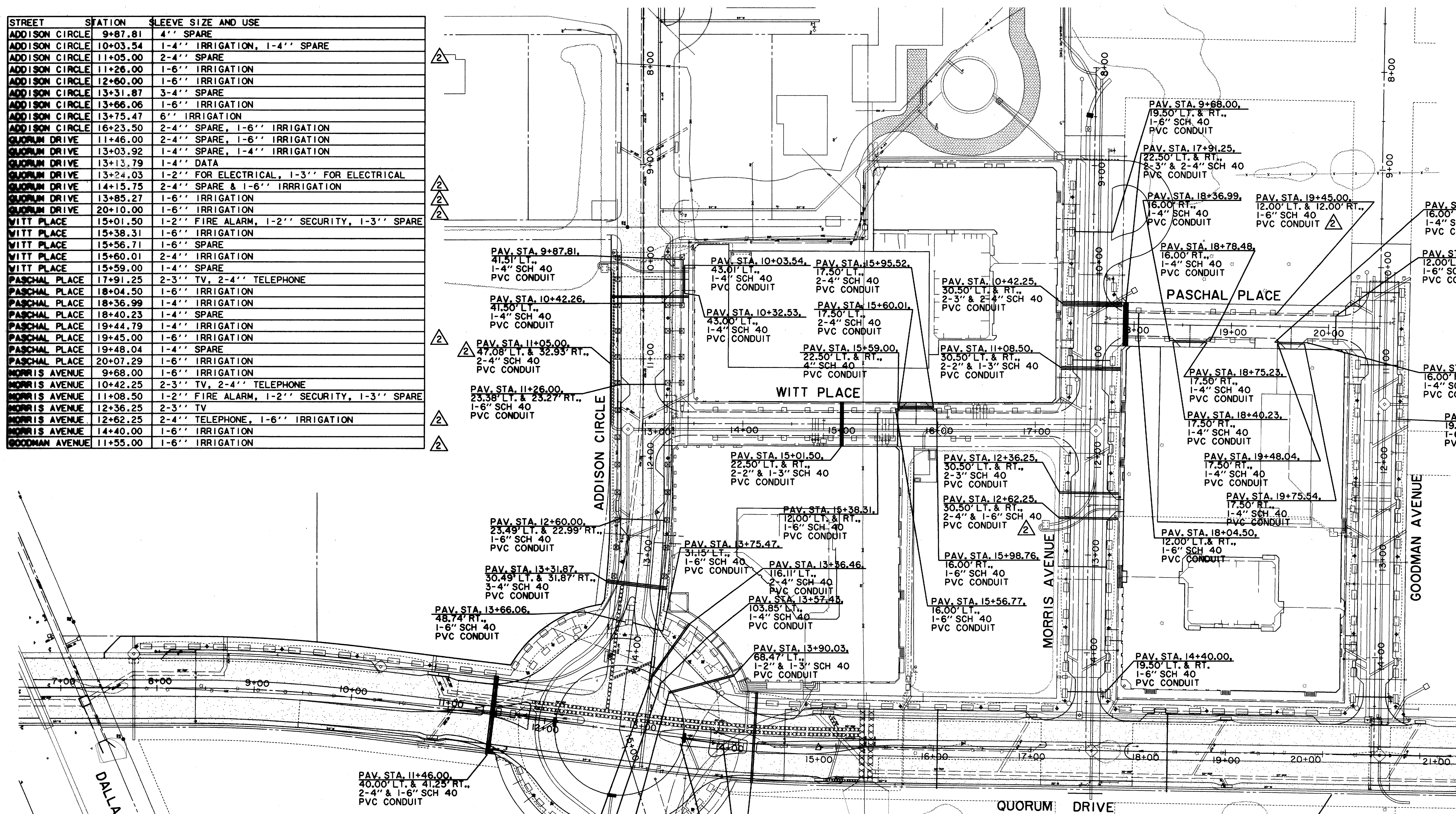
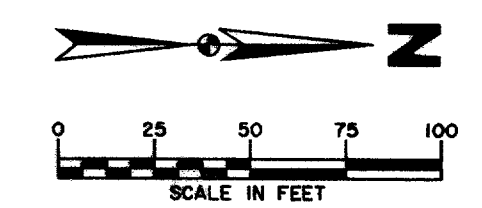

TYPICAL CONDUIT/SLEEVE EMBEDMENT
N.T.S.

RECORD DRAWING 5/1/98
 2 REVISED SLEEVES PER IRRIGATION PLANS 5/21/96
 1 ADDENDUM #2 1/22/96

ISSUED FOR CONSTRUCTION
 MARCH 28, 1996
 THE SEAL APPEARING ON THIS DOCUMENT WAS AUTHORIZED BY
 KENNETH A. ROBERTS, P.E. 55446
 ON MARCH 28, 1996.

 3-28-96

SLEEVING PLAN						
ADDISON CIRCLE						
PHASE I PUBLIC INFRASTRUCTURE						
TOWN OF ADDISON, TEXAS						
Hull-Zollars, Inc./Engineering/Architecture Dallas, Fort Worth, Houston, El Paso, Phoenix, Tustin, Ontario, San Clemente						
DESIGN	DRAWN	APPR.	SCALE	DATE	PROJECT NO.	NO.
HZI	HZI	KAR	1"=50'	JAN 96	1822-04	42 137