

LEGEND

ELECTRIC — OHE	48" RCP	MISC.
○ LIGHT POLE	EX. STORM SEWER	— CHAIN LINK FENCE
PP POWER POLE	— WOOD FENCE	— EXISTING ASPHALT
— GUY WIRE	— EXISTING DIRT OR GRAVEL	— EX. CONCRETE
TELEPHONE — T	— EXISTING CURB	— TREE/TREE LINE
● TELEPHONE MANHOLE	— PROP. CURB	— EX. PROPERTY LINE
□ TELEPHONE PEDESTAL	— PROP. CENTERLINE	— PROP. R.O.W.
TS TELEPHONE SIGN	— PROP. INLET	— T.P.
GM GAS METER	— T.C.	— TOP OF PAVEMENT
GS GAS SIGN	— C.R.	— TOP OF CURB
R-R RAILROAD SIGN	— EX. GUTTER	— EXISTING GUTTER
○ SIGN	— BORING LOCATION	— BORING LOCATION
— SURVEY	—	—
I.R. FOUND IRON ROD	—	—
WB TEMP BENCHMARK	—	—
WM WASTEWATER MANHOLE	—	—
CO CLEANOUT	—	—
WATER — W	—	—
FH FIRE HYDRANT	—	—
WM METER	—	—
T WATER VALVE	—	—

RECORD DRAWING 5/1/98

RECORD DRAWING 5/1/98

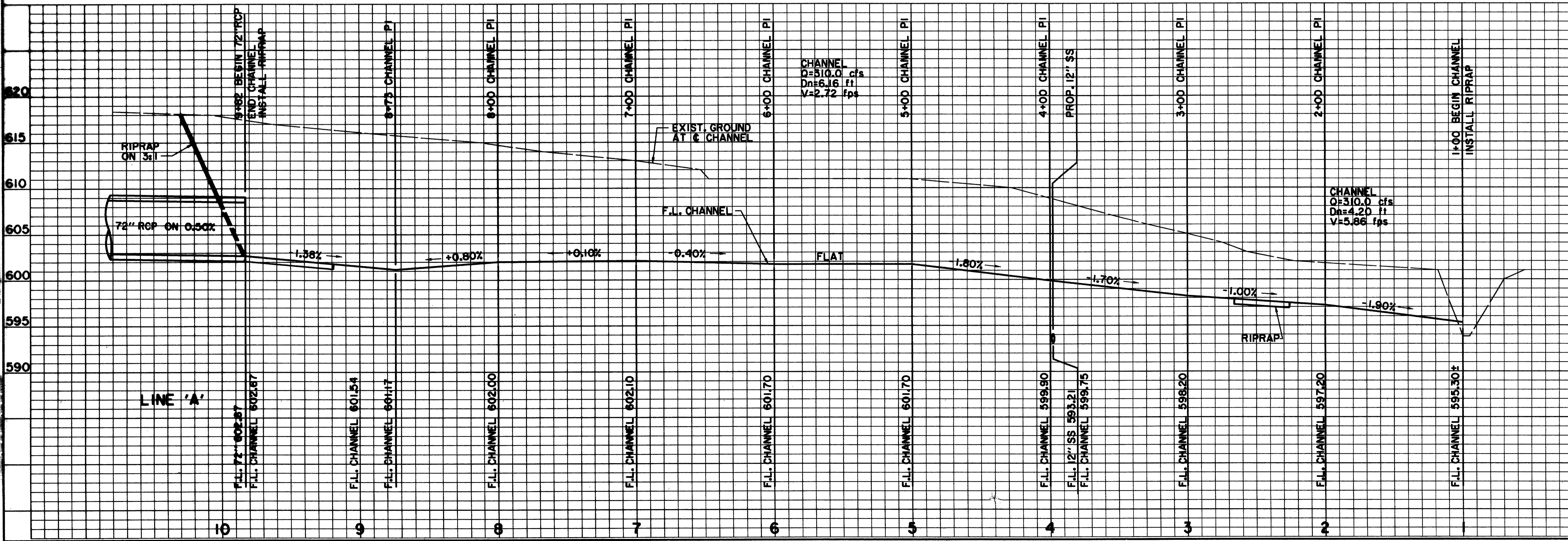

BENCHMARKS:

BM#1
"C" CUT AT CENTER BACK OF CURB OF INLET, 190 FEET SOUTH FROM THE CENTERLINE INTERSECTION OF ADDISON CIRCLE, WEST SIDE OF QUORUM DRIVE, ELEV. 621.89

BM#2
"C" CUT AT CENTER BACK OF CURB OF INLET, 200 FEET NORTH FROM THE CENTERLINE INTERSECTION OF ADDISON CIRCLE, WEST SIDE OF QUORUM DRIVE, ELEV. 621.68

ISSUED FOR CONSTRUCTION
MARCH 28, 1996

THE SEAL APPEARING ON THIS DOCUMENT WAS AUTHORIZED BY
KENNETH A. ROBERTS, P.E. 55446
ON MARCH 28, 1996.

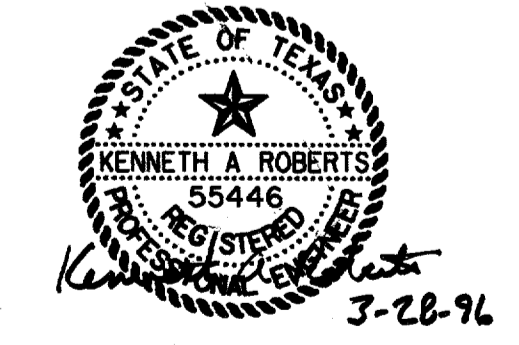

STORM WATER PLAN & PROFILE
LINE 'A' OUTFALL
ADDISON CIRCLE
PHASE I PUBLIC INFRASTRUCTURE
TOWN OF ADDISON, TEXAS

Hutt-Zollers, Inc./Engineering/Architecture
Dallas, Fort Worth, Houston, El Paso, Phoenix, Austin, San Clemente

DESIGN	DRAWN	APPR.	SCALE	DATE	PROJECT NO.	NO.
HZI	HZI	KAR	H: 1"=40' V: 1"=6'	JAN 96	1822-04	65

137