

LEGEND

ELECTRIC — OHE —	48" RCP	MISC.
⊕ LIGHT POLE	—	EX. STORM SEWER
PP POWER POLE	—	CHAIN LINK FENCE
— GUY WIRE	—	WOOD FENCE
TELEPHONE	—	EXISTING ASPHALT
MH TELEPHONE MANHOLE	—	EXISTING DIRT OR GRAVEL
TELEPHONE PEDESTAL	—	EX. CONCRETE
TS TELEPHONE SIGN	—	TREE/TREE LINE
GAS — G —	—	EXISTING CURB
GM GAS METER	—	PROP. CURB
GS GAS SIGN	—	PROP. EDGE OF PAVEMENT NO CURB
R/R RAILROAD SIGN	—	EX. PROPERTY LINE
SIGN	—	PROP. CENTERLINE
SURVEY	—	PROP. R.O.W.
I.R. FOUND IRON ROD	—	PROP. INLET
TEMP BENCHMARK	T.P.	TOP OF PAVEMENT
WASTEWATER — WW —	T.C.	TOP OF CURB
WV WASTEWATER MANHOLE	C.R.	CURB RETURN
CO CLEANOUT	EX. G	EXISTING GUTTER
WATER — W —	B-20	BORING LOCATION
FH FIRE HYDRANT		
WM METER		
T WATER VALVE		

RECORD DRAWING 5/1/98

ADDENDUM #2 1/22/96

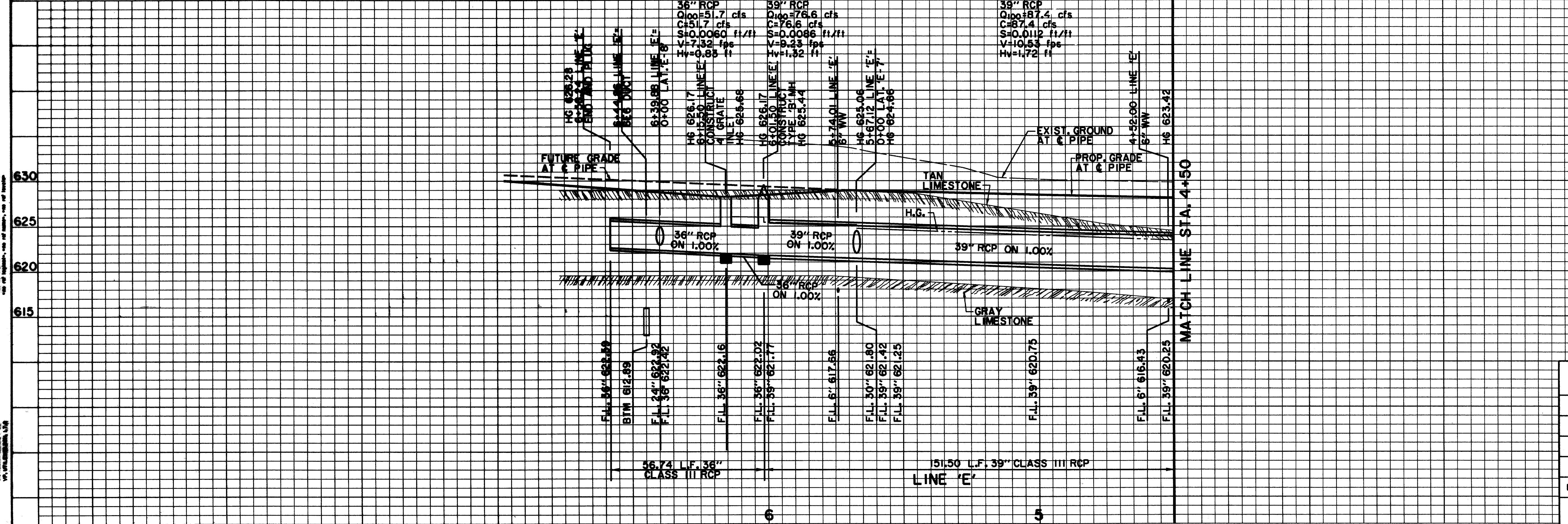

BENCHMARKS:

BM#2
"T" CUT AT CENTER BACK OF CURB OF INLET, 200 FEET NORTH FROM THE CENTERLINE INTERSECTION OF ADDISON CIRCLE, WEST SIDE OF QUORUM DRIVE.
ELEV. 621.68

BM#3
"T" CUT AT CENTER BACK OF CURB OF INLET, 620 FEET NORTH FROM THE CENTERLINE INTERSECTION OF ADDISON CIRCLE, WEST SIDE OF QUORUM DRIVE.
ELEV. 624.50

ISSUED FOR CONSTRUCTION
MARCH 28, 1996

THE SEAL APPEARING ON THIS DOCUMENT WAS AUTHORIZED BY
KENNETH A. ROBERTS, P.E. 55446
ON MARCH 28, 1996.

7-28-96

STORM WATER PLAN & PROFILE					
LINE 'E' & LAT 'E'-8'					
ADDISON CIRCLE					
PHASE I PUBLIC INFRASTRUCTURE					
TOWN OF ADDISON, TEXAS					
Huiji-Zollars, Inc./Engineering/Architecture					
Dallas, Fort Worth, Houston, El Paso, Phoenix, Tustin, Ontario, San Clemente					
DESIGN	DRAWN	APPR.	SCALE	DATE	PROJECT NO.
HZI	HZI	KAR	H ₁ 1:20' V ₁ 1:6'	JAN 96	1822-04
				72	137