

**LEGEND**

ELECTRIC — OHE	48" RCP	MISC.
⊕ LIGHT POLE	EX. STORM SEWER	CHAIN LINK FENCE
PP POWER POLE	WOOD FENCE	EXISTING ASPHALT
← GUY WIRE	EXISTING DIRT OR GRAVEL	EX. CONCRETE
TELEPHONE — T	EXISTING TREE/TREE LINE	EXISTING CURB
TELEPHONE MANHOLE	PROP. CURB	PROP. EDGE OF PAVEMENT NO CURB
TELEPHONE PEDESTAL	EX. PROPERTY LINE	PROP. CENTERLINE
TS TELEPHONE SIGN	PROP. R.O.W.	PROP. INLET
GAS — G	T.P.	TOP OF PAVEMENT
GAS METER	T.C.	TOP OF CURB
GAS SIGN	C.R.	CURB RETURN
LAND USE	EX. G	EXISTING GUTTER
RAILROAD SIGN	B-20	BORING LOCATION
SIGN		
SURVEY		
FOUND IRON ROD		
TEMP BENCHMARK		
WASTEWATER — WW		
WASTEWATER MANHOLE		
CLEANOUT		
WATER — W		
FIRE HYDRANT		
METER		
WATER VALVE		

RECORD DRAWING 5/1/98

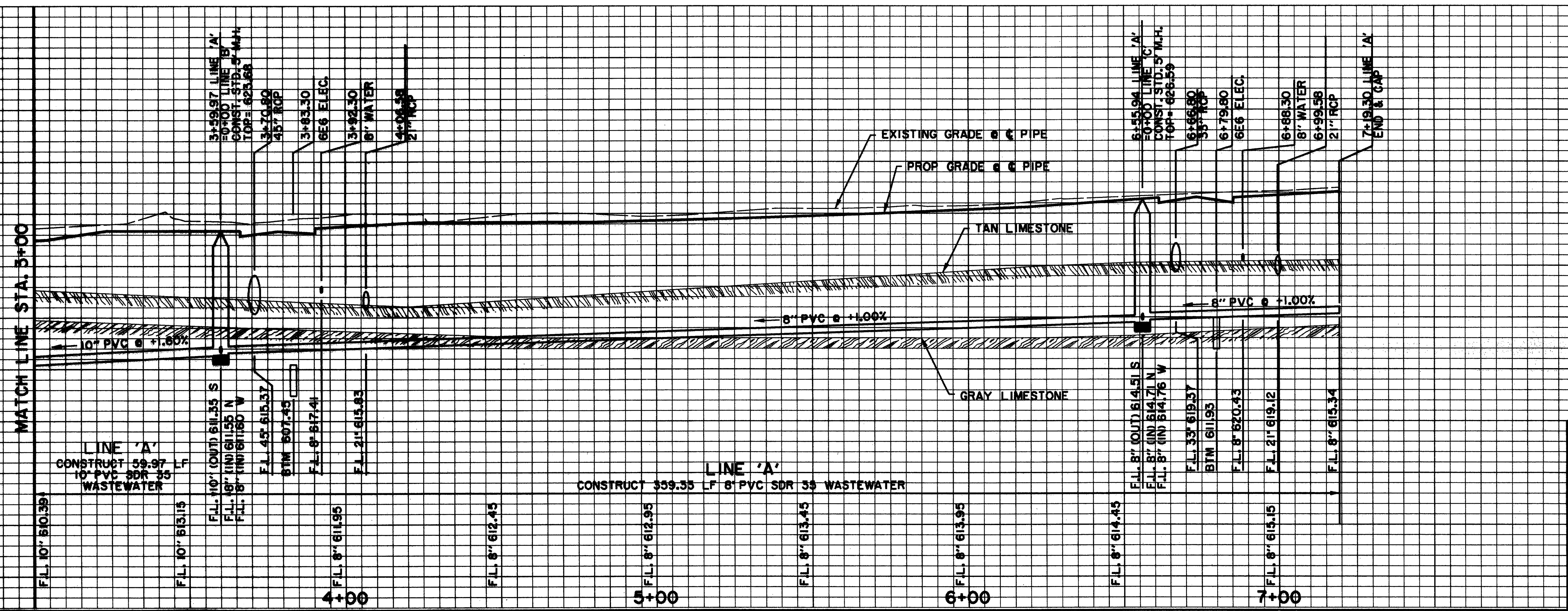

**BENCHMARKS:**

BM\*2  
"□" CUT AT CENTER BACK OF CURB OF INLET, 200 FEET NORTH FROM THE CENTERLINE INTERSECTION OF ADDISON CIRCLE, WEST SIDE OF QUORUM DRIVE.  
ELEV. 621.68

BM\*3  
"□" CUT AT CENTER BACK OF CURB OF INLET, 620 FEET NORTH FROM THE CENTERLINE INTERSECTION OF ADDISON CIRCLE, WEST SIDE OF QUORUM DRIVE.  
ELEV. 624.50

ISSUED FOR CONSTRUCTION  
MARCH 28, 1996

THE SEAL APPEARING ON THIS DOCUMENT WAS AUTHORIZED BY  
KENNETH A. ROBERTS, P.E. 55446  
ON MARCH 28, 1996.

<b>WASTEWATER PLAN &amp; PROFILE</b>						
LINE 'A' STA. 3+00 TO STA. 7+60						
<b>ADDISON CIRCLE</b>						
<b>PHASE I PUBLIC INFRASTRUCTURE</b>						
<b>TOWN OF ADDISON, TEXAS</b>						
Huiji-Zollars, Inc./Engineering/Architecture Dallas, Fort Worth, Houston, El Paso, Phoenix, Tustin, Ontario, San Clemente						
DESIGN	DRAWN	APPR.	SCALE	DATE	PROJECT NO.	NO.
HZI	HZI	KAR	H <sub>v</sub> 1"=20' V <sub>v</sub> 1"=8'	JAN 96	1822-04	93
						137