

LEGEND

- | | | |
|------------------------|----------------------------------|-----------------------|
| ELECTRIC — OHE | 48" RCP | MISC. |
| ⊕ LIGHT POLE | EX. STORM SEWER | — CHAIN LINK FENCE |
| PP POWER POLE | — WOOD FENCE | — EXISTING ASPHALT |
| — GUY WIRE | — EXISTING DIRT OR GRAVEL | — EX. CONCRETE |
| TELEPHONE — T | — TREE/TREE LINE | — EXISTING CURB |
| ● TELEPHONE MANHOLE | — PROP. EDGE OF PAVEMENT NO CURB | — EX. PROPERTY LINE |
| ⊕ TELEPHONE PEDESTAL | — PROP. CENTERLINE | — PROP. R.O.W. |
| TS TELEPHONE SIGN | — PROP. INLET | T.P. TOP OF PAVEMENT |
| GAS — G | — T.C. TOP OF CURB | C.R. CURB RETURN |
| GM GAS METER | — EX. GUTTER | EX. G BORING LOCATION |
| GS GAS SIGN | | B-20 |
| LAND USE | | |
| RR RAILROAD SIGN | | |
| — SIGN | | |
| SURVEY | | |
| I.R. FOUND IRON ROD | | |
| — TEMP BENCHMARK | | |
| WASTEWATER — WW | | |
| ● WASTEWATER MANHOLE | | |
| CO CLEANOUT | | |
| WATER — W | | |
| FH FIRE HYDRANT | | |
| WM METER | | |
| T WATER VALVE | | |

MATCH LINE STA. 10+00

MATCH LINE STA. 5+00

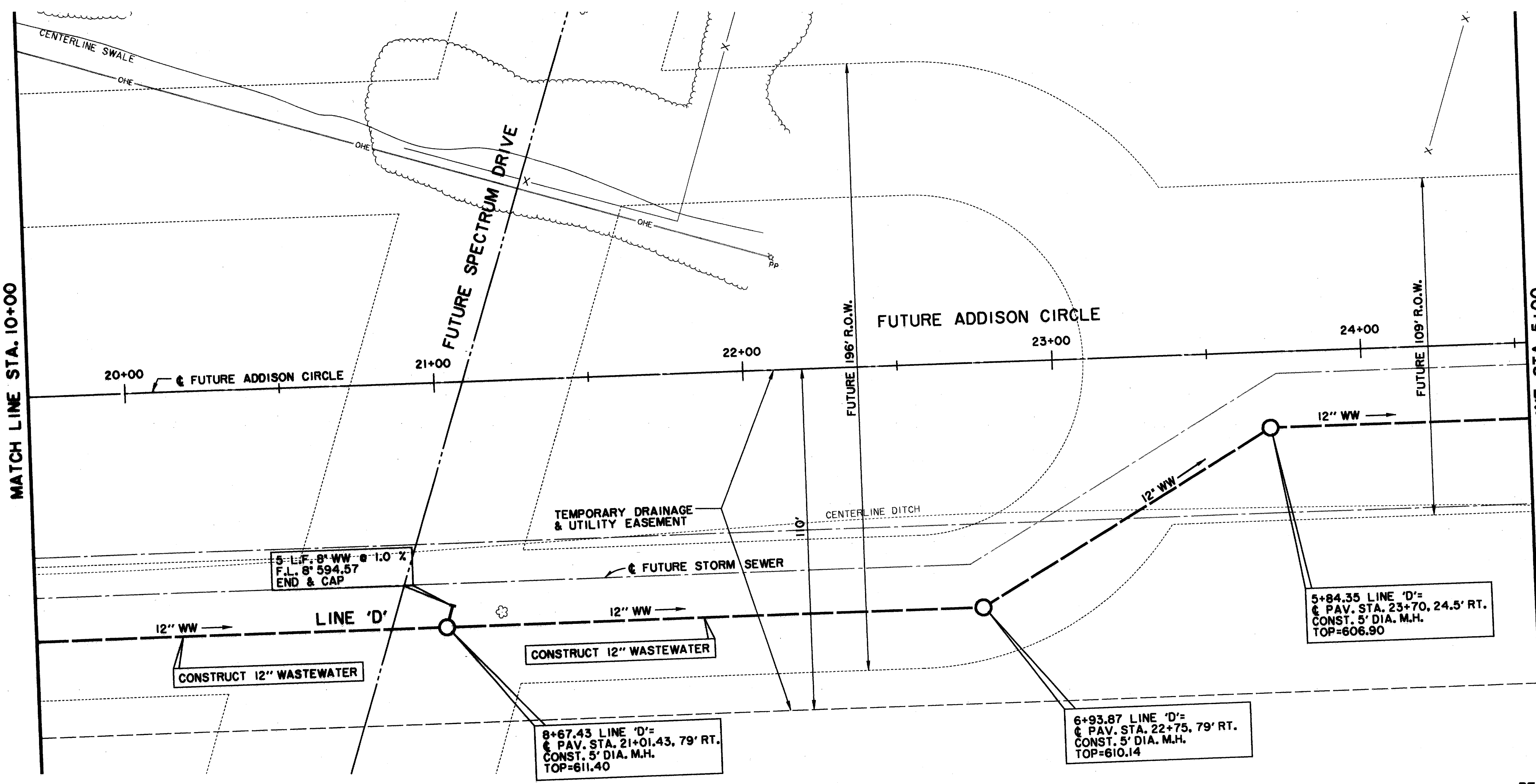

RECORD DRAWING 5/1/98

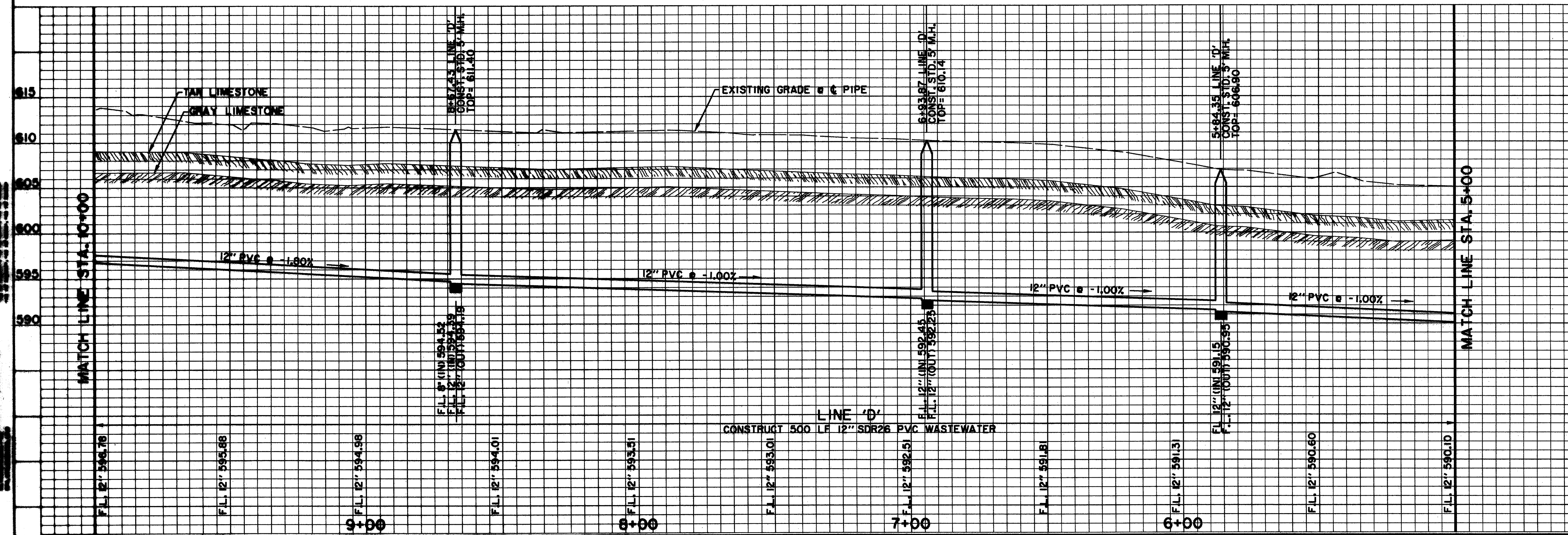

BENCHMARKS:

BM#1
"I" CUT AT CENTER BACK OF CURB OF INLET, 190 FEET SOUTH FROM THE CENTERLINE INTERSECTION OF ADDISON CIRCLE, WEST SIDE OF QUORUM DRIVE. ELEV. 621.89

BM#2
"I" CUT AT CENTER BACK OF CURB OF INLET, 200 FEET NORTH FROM THE CENTERLINE INTERSECTION OF ADDISON CIRCLE, WEST SIDE OF QUORUM DRIVE. ELEV. 621.68

ISSUED FOR CONSTRUCTION
MARCH 28, 1996

THE SEAL APPEARING ON THIS DOCUMENT WAS AUTHORIZED BY
KENNETH A. ROBERTS, P.E. 55446
ON MARCH 28, 1996.

3-28-96

WASTEWATER PLAN & PROFILE						
LINE 'D' STA. 5+00 TO STA. 10+00						
ADDISON CIRCLE						
PHASE I PUBLIC INFRASTRUCTURE						
TOWN OF ADDISON, TEXAS						
Huitt-Zollers, Inc./Engineering/Architecture Dallas, Fort Worth, Houston, El Paso, Phoenix, Tustin, Ontario, San Clemente						
DESIGN	DRAWN	APPR.	SCALE	DATE	PROJECT NO.	NO.
HZI	HZI	KAR	H _v 1"=20' V _v 1"=6'	JAN 96	1822-04	98
						137