

NOTE: SIDEWALK BEYOND RIGHT OF WAY TO BE CONSTRUCTED BY OTHERS WITH THE ADDISON CIRCLE APARTMENTS PRIVATE DEVELOPMENT. CONTRACTOR SHALL COORDINATE INTERFACE IN THE FIELD. SEE SIDEWALK DETAILS IN THIS PLAN SET.

- NOTES:
1. SEE DEMOLITION PLAN FOR PAVEMENT REMOVAL LIMITS.
  2. SEE SURFACE PATTERNING PLANS FOR BRICK PATTERNS AND SLOPES.
  3. POUR SIDEWALK AROUND NOTED LEAVEOUTS PER LOCATIONS ON STREETSCAPE PLANS.

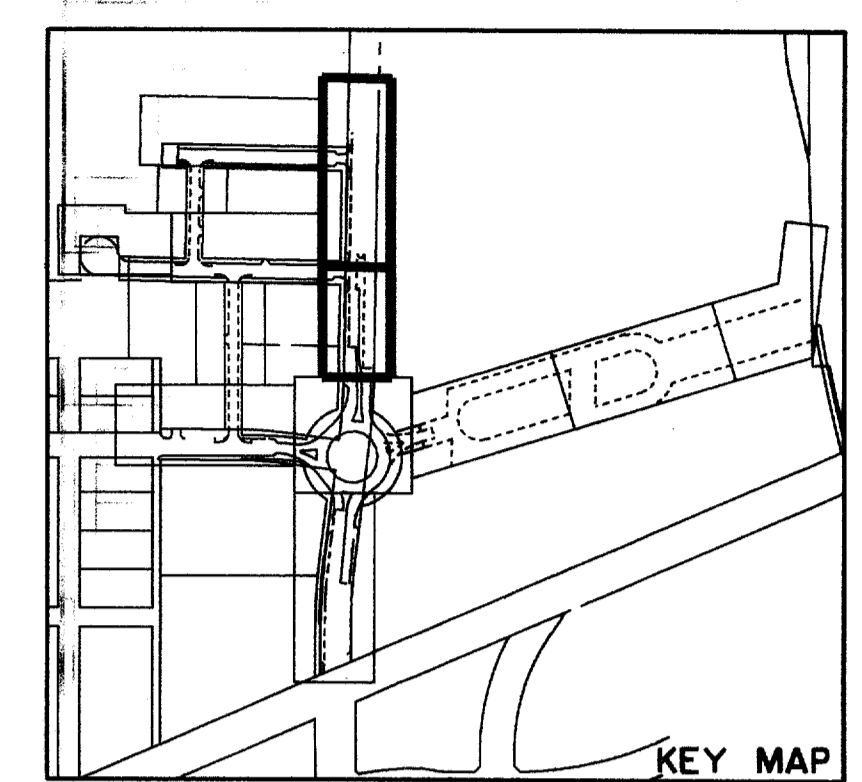
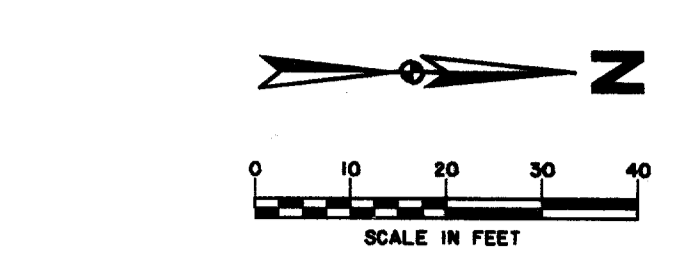

**LEGEND**

ELECTRIC — OHE —	48" RCP	MISC.
⊙ LIGHT POLE	EX. STORM SEWER	
PP POWER POLE	CHAIN LINK FENCE	
— GUY WIRE	WOOD FENCE	
TELEPHONE — T —	EXISTING ASPHALT	
⊙ TELEPHONE MANHOLE	EXISTING DIRT OR GRAVEL	
⊙ TELEPHONE PEDESTAL	EX. CONCRETE	
TS TELEPHONE SIGN	TREE/TREE LINE	
GN GAS	EXISTING CURB	
GS GAS METER	PROP. CURB	
GS GAS SIGN	PROP. EDGE OF PAVEMENT NO CURB	
LAND USE	EX. PROPERTY LINE	
RAILROAD SIGN	PROP. CENTERLINE	
⊙ SIGN	PROP. R.O.W.	
SURVEY	PROP. INLET	
IR FOUND IRON ROD	T.P. TOP OF PAVEMENT	
TEMP BENCHMARK	T.C. TOP OF CURB	
WASTEWATER — WW —	C.R. CURB RETURN	
WASTEWATER MANHOLE	EX. G. EXISTING GUTTER	
CLEANOUT	BORING LOCATION	
WATER — W —	B-20	
METER		
T WATER VALVE		

**BENCHMARKS:**

BM#2  
"C" CUT AT CENTER BACK OF CURB OF INLET, 200 FEET NORTH FROM THE CENTERLINE INTERSECTION OF ADDISON CIRCLE, WEST SIDE OF QUORUM DRIVE.  
ELEV. 621.68

BM#3  
"C" CUT AT CENTER BACK OF CURB OF INLET, 620 FEET NORTH FROM THE CENTERLINE INTERSECTION OF ADDISON CIRCLE, WEST SIDE OF QUORUM DRIVE.  
ELEV. 624.50

ISSUED FOR CONSTRUCTION  
MARCH 28, 1996

THE SEAL APPEARING ON THIS DOCUMENT WAS AUTHORIZED BY  
KENNETH A. ROBERTS, P.E. 55446  
ON MARCH 28, 1996.

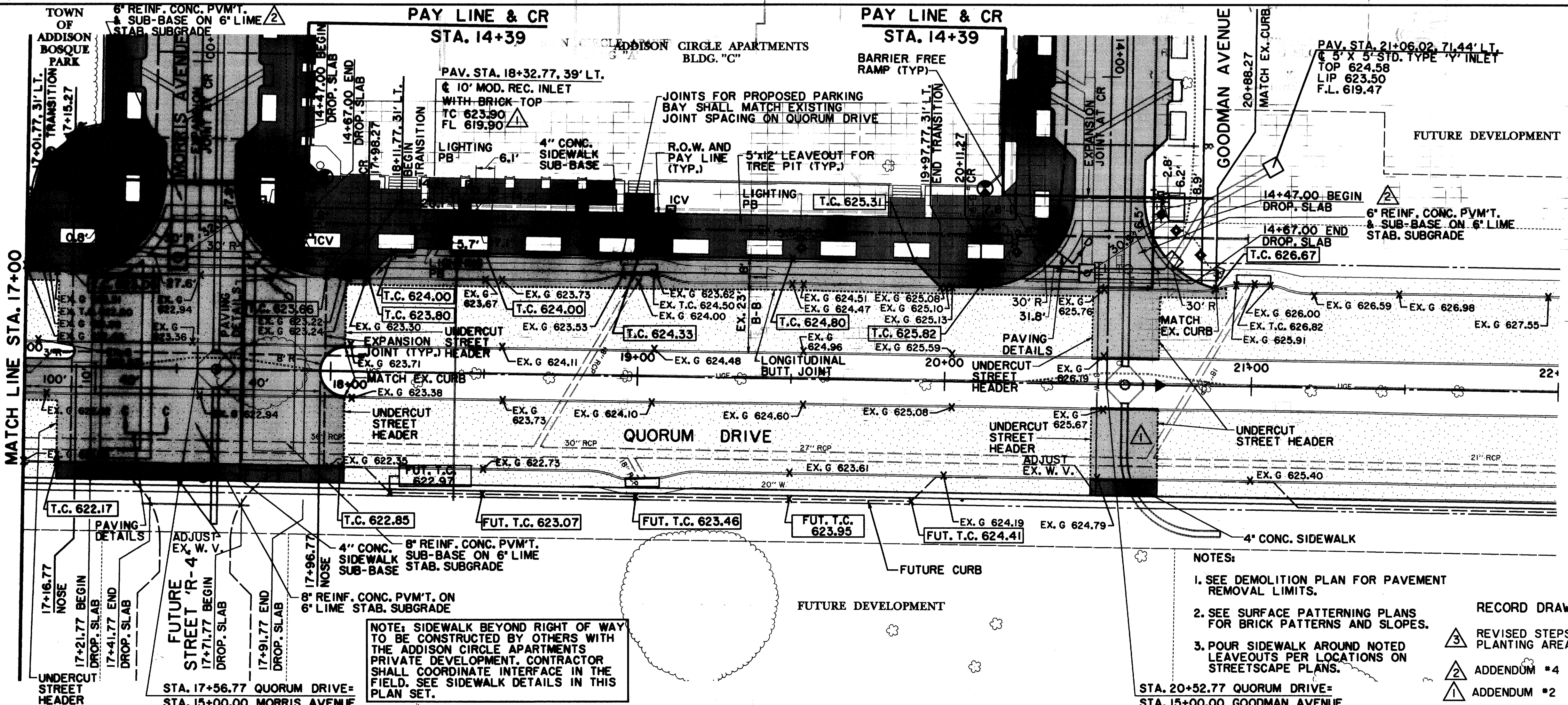

NOTE: SIDEWALK BEYOND RIGHT OF WAY TO BE CONSTRUCTED BY OTHERS WITH THE ADDISON CIRCLE APARTMENTS PRIVATE DEVELOPMENT. CONTRACTOR SHALL COORDINATE INTERFACE IN THE FIELD. SEE SIDEWALK DETAILS IN THIS PLAN SET.

- NOTES:
1. SEE DEMOLITION PLAN FOR PAVEMENT REMOVAL LIMITS.
  2. SEE SURFACE PATTERNING PLANS FOR BRICK PATTERNS AND SLOPES.
  3. POUR SIDEWALK AROUND NOTED LEAVEOUTS PER LOCATIONS ON STREETSCAPE PLANS.

RECORD DRAWING 5/1/98

3 REVISED STEPS AND PLANTING AREAS 5/13/96

2 ADDENDUM #4 2/16/96

1 ADDENDUM #2 1/22/96

**PAVING PLAN**  
QUORUM DRIVE STA. 13+00 TO STA. 22+00  
**ADDISON CIRCLE**  
PHASE I PUBLIC INFRASTRUCTURE  
TOWN OF ADDISON, TEXAS

Huiji-Zollars, Inc./Engineering/Architecture  
Dallas, Fort Worth, Houston, El Paso, Phoenix, Austin, Ontario, San Clemente

DESIGN	DRAWN	APPR.	SCALE	DATE	PROJECT NO.	NO.
HZI	HZI	KAR	1"=20'	JAN 96	1822-04	22

137