

NOTE: SIDEWALK BEYOND RIGHT OF WAY TO BE CONSTRUCTED BY OTHERS WITH THE ADDISON CIRCLE APARTMENTS PRIVATE DEVELOPMENT. CONTRACTOR SHALL COORDINATE INTERFACE IN THE FIELD. SEE SIDEWALK DETAILS IN THIS PLAN SET.

- NOTES:
1. SEE DEMOLITION PLAN FOR PAVEMENT REMOVAL LIMITS.
 2. SEE SURFACE PATTERNING PLANS FOR BRICK PATTERNS AND SLOPES.
 3. POUR SIDEWALK AROUND NOTED LEAVEOUTS PER LOCATIONS ON STREETScape PLANS.

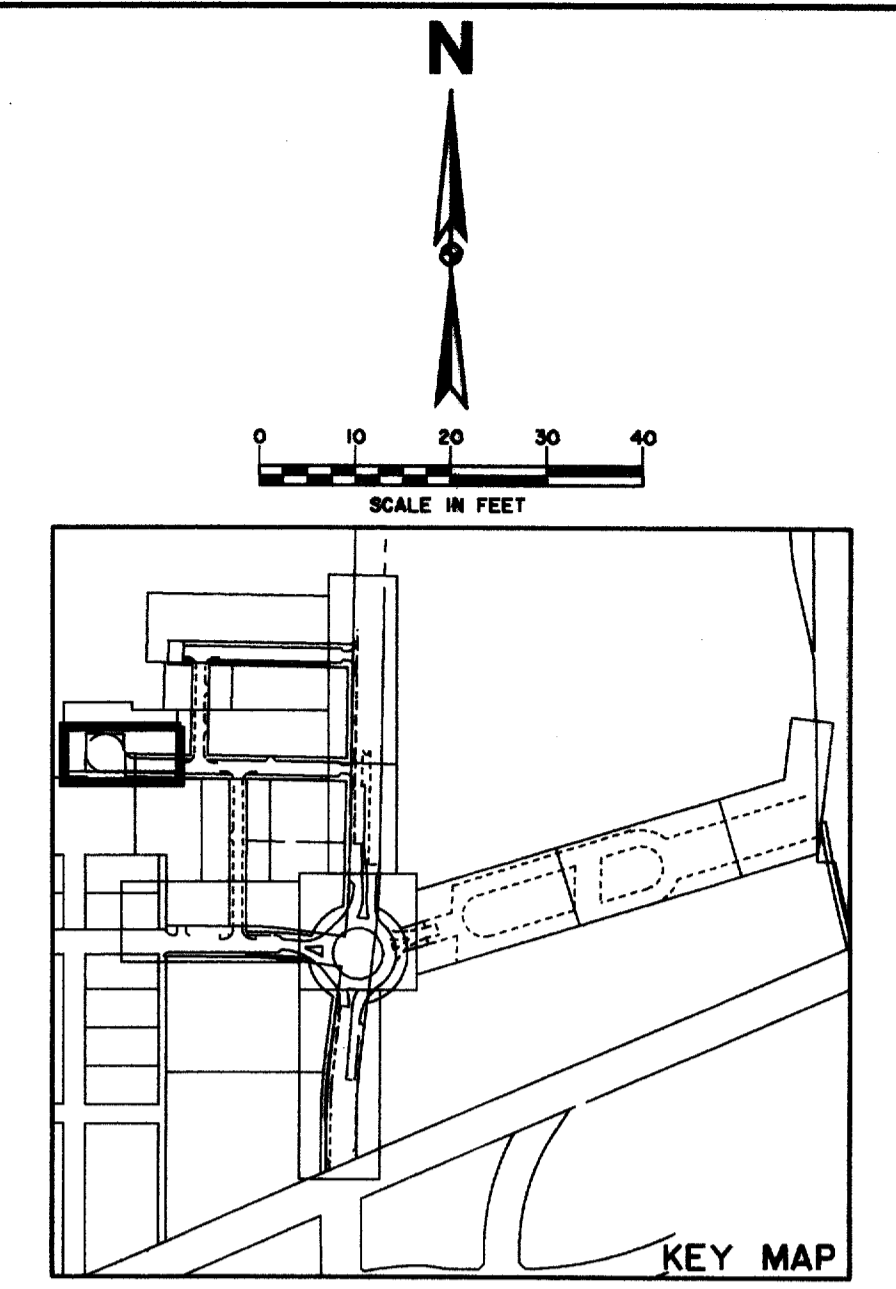

LEGEND

ELECTRIC	— OHE —	MISC.	— 48" RCP —
○	LIGHT POLE	—	EX. STORM SEWER
pp	POWER POLE	—	CHAIN LINK FENCE
—	GUY WIRE	—	WOOD FENCE
TELEPHONE	— T —	—	EXISTING ASPHALT
●	TELEPHONE MANHOLE	—	EXISTING DIRT OR GRAVEL
○	TELEPHONE PEDESTAL	—	EX. CONCRETE
TS	TELEPHONE SIGN	—	TREE/TREE LINE
—	GAS	—	EXISTING CURB
GM	GAS METER	—	PROP. CURB
GS	GAS SIGN	—	PROP. EDGE OF PAVEMENT NO CURB
LAND USE		—	EX. PROPERTY LINE
RJR	RAILROAD SIGN	—	PROP. CENTERLINE
—	SIGN	—	PROP. R.O.W.
SURVEY		—	PROP. INLET
IR	FOUND IRON ROD	T.P.	TOP OF PAVEMENT
—	TEMP BENCHMARK	T.C.	TOP OF CURB
WASTEWATER	— WW —	C.R.	CURB RETURN
—	WASTEWATER MANHOLE	EX. G	EXISTING GUTTER
CO	CLEANOUT	—	BORING LOCATION
WATER	— W —	—	
FH	FIRE HYDRANT	—	
WM	METER	—	
T	WATER VALVE	—	

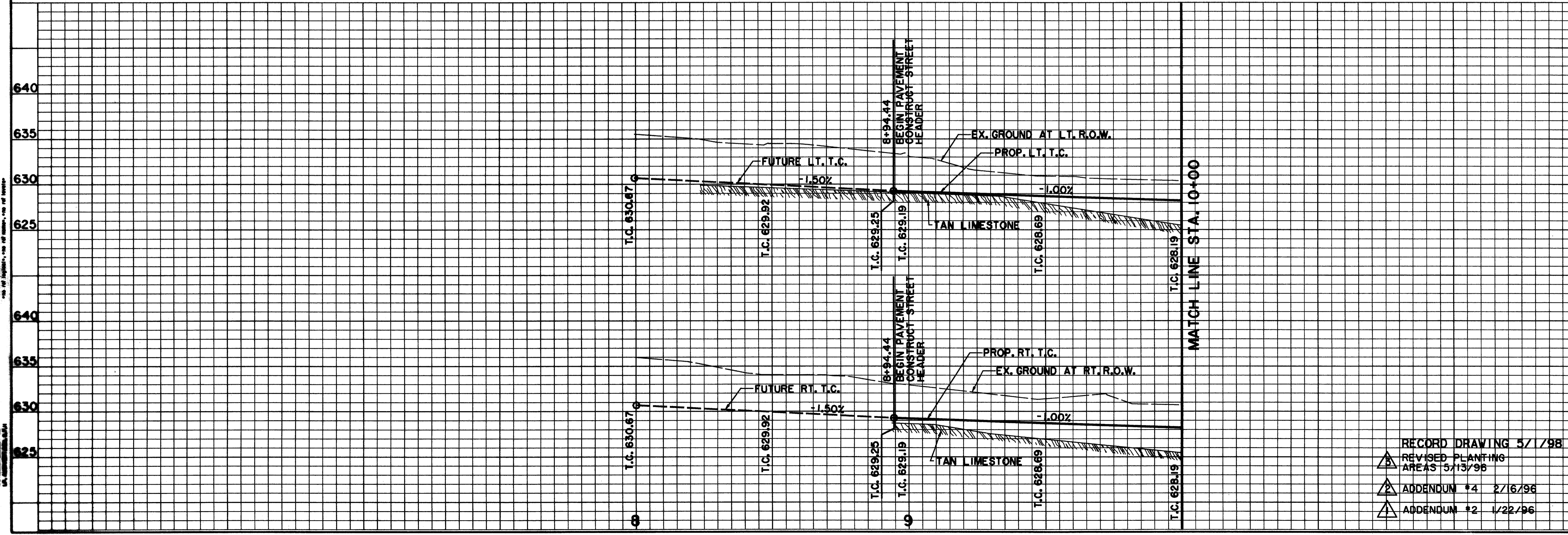

BENCHMARKS:

BM#2
"I" CUT AT CENTER BACK OF CURB OF INLET, 200 FEET NORTH FROM THE CENTERLINE INTERSECTION OF ADDISON CIRCLE, WEST SIDE OF QUORUM DRIVE.
ELEV. 621.68

BM#3
"I" CUT AT CENTER BACK OF CURB OF INLET, 620 FEET NORTH FROM THE CENTERLINE INTERSECTION OF ADDISON CIRCLE, WEST SIDE OF QUORUM DRIVE.
ELEV. 624.50

ISSUED FOR CONSTRUCTION
MARCH 28, 1996

THE SEAL APPEARING ON THIS DOCUMENT WAS AUTHORIZED BY
KENNETH A. ROBERTS, P.E. 55446
ON MARCH 28, 1996.

PAVING PLAN & PROFILE
MORRIS AVENUE STA. 8+94.44 TO STA. 10+00
ADDISON CIRCLE
PHASE I PUBLIC INFRASTRUCTURE
TOWN OF ADDISON, TEXAS

Hull-Zollars, Inc./Engineering/Architecture
Dallas, Fort Worth, Houston, El Paso, Phoenix, Tustin, Ontario, San Clemente

DESIGN	DRAWN	APPR.	SCALE	DATE	PROJECT NO.	NO.
HZI	HZI	KAR	H:1"=20' V:1"=6'	JAN 96	1822-04	24 137

RECORD DRAWING 5/1/98
REVISED PLANTING AREAS 5/13/98
ADDENDUM #4 2/16/96
ADDENDUM #2 1/22/96