

**LEGEND**

	<b>ELECTRIC</b> — OHE		<b>MISC.</b>
	○ LIGHT POLE		EX. STORM SEWER
	PP POWER POLE		CHAIN LINK FENCE
	— GUY WIRE		WOOD FENCE
	<b>TELEPHONE</b> — T		EXISTING ASPHALT
	TELEPHONE MANHOLE		EXISTING DIRT OR GRAVEL
	TELEPHONE PEDESTAL		EX. CONCRETE
	TELEPHONE SIGN		TREE/TREE LINE
	<b>GAS</b> — G		EXISTING CURB
	GM GAS METER		PROP. CURB
	GS GAS SIGN		PROP. EDGE OF PAVEMENT NO CURB
	<b>LAND USE</b>		EX. PROPERTY LINE
	RR RAILROAD SIGN		PROP. CENTERLINE
	SIGN		PROP. R.O.W.
	<b>SURVEY</b>		PROP. INLET
	IR. FOUND IRON ROD		T.P. TOP OF PAVEMENT
	TEMP BENCHMARK		C.R. TOP OF CURB
	WWMH WASTEWATER MANHOLE		EX. G. EXISTING GUTTER
	CO CLEANOUT		B-20 BORING LOCATION
	<b>WATER</b> — W		
	FH FIRE HYDRANT		
	WM METER		
	T WATER VALVE		

**BENCHMARKS:**

**BM#2**  
 "C" CUT AT CENTER BACK OF CURB OF INLET, 200 FEET NORTH FROM THE CENTERLINE INTERSECTION OF ADDISON CIRCLE, WEST SIDE OF QUORUM DRIVE.  
 ELEV. 621.68

**BM#3**  
 "C" CUT AT CENTER BACK OF CURB OF INLET, 620 FEET NORTH FROM THE CENTERLINE INTERSECTION OF ADDISON CIRCLE, WEST SIDE OF QUORUM DRIVE.  
 ELEV. 624.50

ISSUED FOR CONSTRUCTION  
 JUNE 19, 1996

THE SEAL APPEARING ON THIS DOCUMENT WAS AUTHORIZED BY  
 KENNETH A. ROBERTS, P.E. 55446  
 ON JUNE 19, 1996.

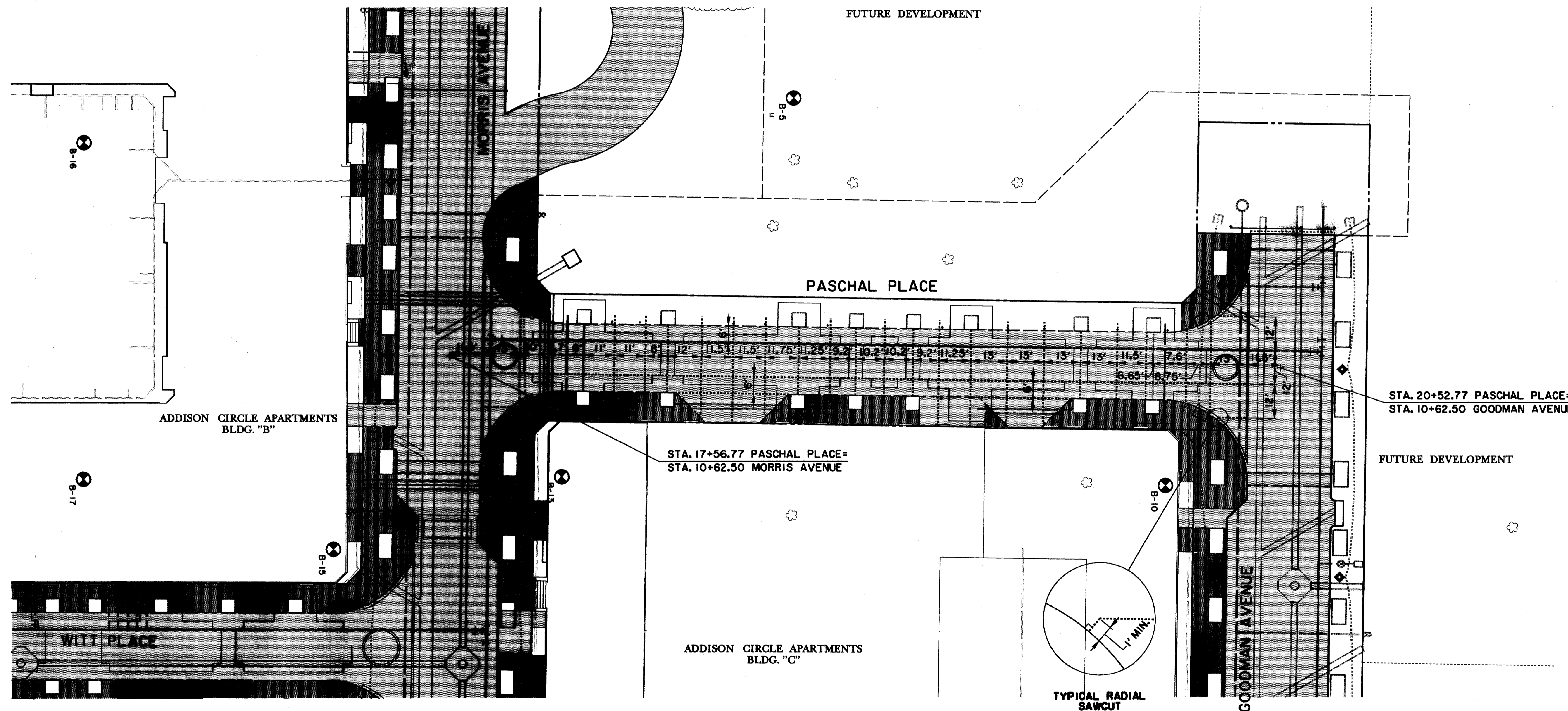

**LEGEND:**

	EXPANSION JOINT
	SAWCUT CONTROL JOINT

<b>JOINT PLAN</b>						
PASCHAL PLACE STA. 17+50 TO STA. 20+50						
<b>ADDISON CIRCLE</b>						
PHASE I PUBLIC INFRASTRUCTURE						
TOWN OF ADDISON, TEXAS						
Huitt-Zollars, Inc./Engineering/Architecture Dallas, Fort Worth, Houston, El Paso, Phoenix, Tusin, Ontario, San Clemente						
DESIGN	DRAWN	APPR.	SCALE	DATE	PROJECT NO.	NO.
HZI	HZI	KAR	H <sub>1</sub> 1"=20' V <sub>1</sub> 1"=8'	JUN 96	1822-04	27A 137

RECORD DRAWING 5/1/98