

*free staking / survey detail?*

*? to this speed?*

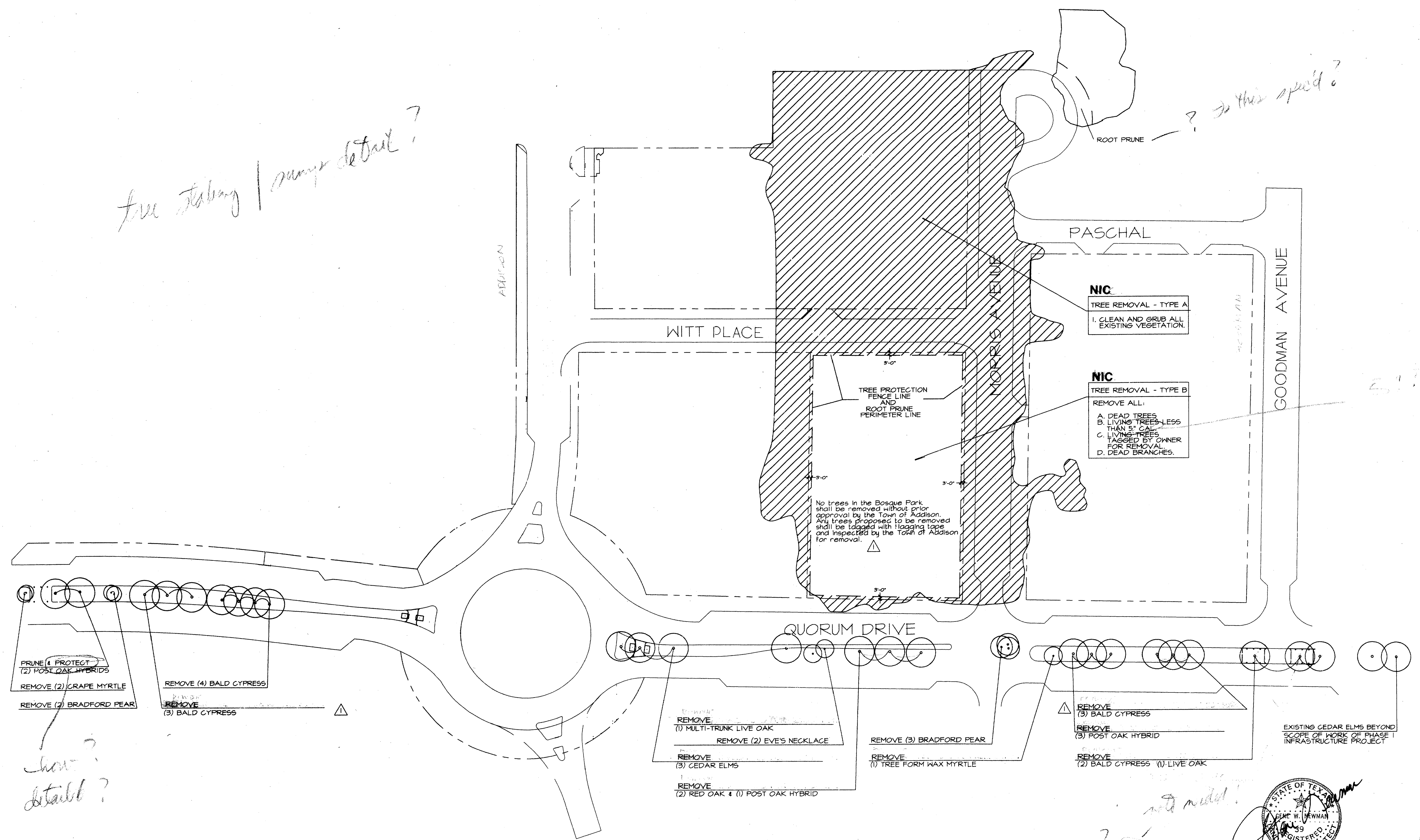

PRUNE & PROTECT  
(2) POST OAK HYBRIDS  
REMOVE (2) CRAPE MYRTLE  
REMOVE (2) BRADFORD PEAR

REMOVE (4) BALD CYPRESS  
REMOVE  
(3) BALD CYPRESS

REMOVE  
(1) MULTI-TRUNK LIVE OAK  
REMOVE (2) EVE'S NECKLACE  
REMOVE  
(3) CEDAR ELMS  
REMOVE  
(2) RED OAK & (1) POST OAK HYBRID

REMOVE (3) BRADFORD PEAR  
REMOVE  
(1) TREE FORM WAX MYRTLE

REMOVE  
(3) BALD CYPRESS  
REMOVE  
(3) POST OAK HYBRID

REMOVE  
(2) BALD CYPRESS (1) LIVE OAK

EXISTING CEDAR ELMS BEYOND  
SCOPE OF WORK OF PHASE I  
INFRASTRUCTURE PROJECT

*how detail?*

*? OK*

*revert A #15?*

Revisions:  
 1-22-96 Addendum #2  
 2-29-96 Addendum #6  
 RECORD DRAWING 5/1/98

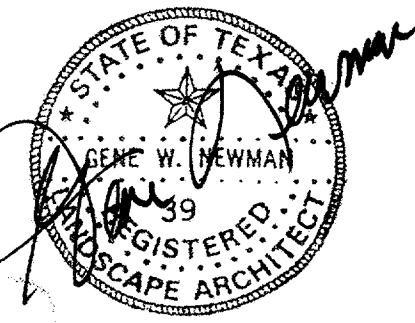

**Newman, Jackson, Bieberstein, Inc.**  
 Landscape Architecture Urban and Development Planning  
 2710 Cott Road, Suite 210 Dallas, Texas (214) 299-2095 Fax (214) 299-2022

Tree Removal, Relocation & Protection Plan						
ADDISON CIRCLE						
PHASE 1						
TOWN OF ADDISON, TEXAS						
Hutt-Zollars, Inc./Engineering/Architecture Dallas, Fort Worth, Houston, El Paso, Phoenix, Tucson, Ontario, San Clemente						
DESIGN	DRAWN	APPR.	SCALE	DATE	PROJECT NO.	NO.
PS	TS	GN		2-4-95	0030-95	121 137

Issued for Construction  
 March 28, 1996