

LEGEND	
	HB - HAY BALES
	SF - SILT FENCE

NOTES:
FOR STORMWATER POLLUTION PREVENTION
NOTES & DETAILS SEE SHEET ER-2.

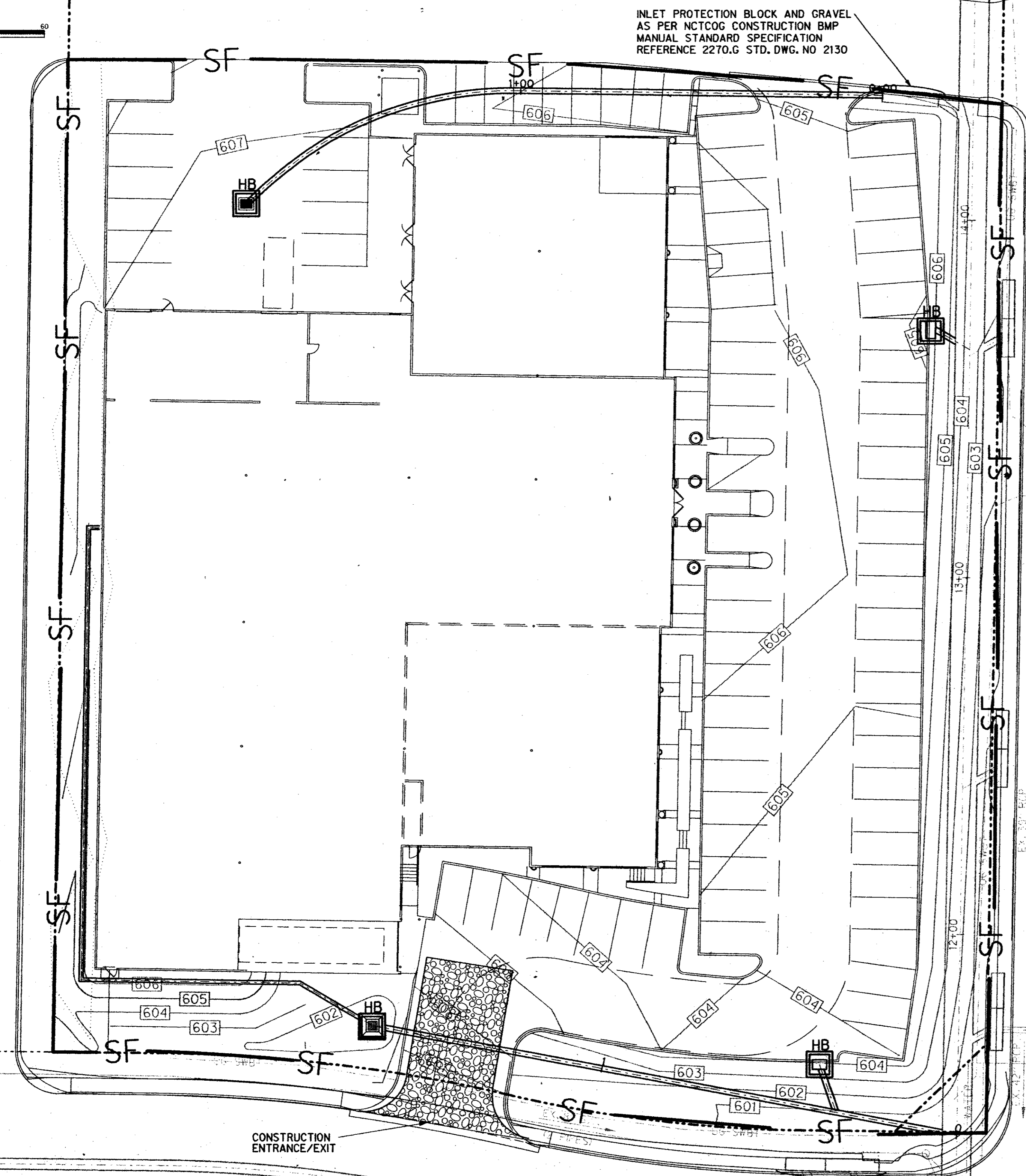

PROTON (60' ROW) DRIVE

INLET PROTECTION BLOCK AND GRAVEL
AS PER NCTCOG CONSTRUCTION BMP
MANUAL STANDARD SPECIFICATION
REFERENCE 2270.G STD. DWG. NO 2130

MIDWAY (100' ROW) ROAD

GENERAL NOTES

1. Contractor is responsible for, and must obtain all necessary construction permits required by the Town of Addison prior to construction, including any and all necessary permits for construction within public street right-of-way.
2. All site work details shall be done in accordance with the Standard Details of the Town of Addison and conform to the requirements of the plans and contract documents.
3. Existing utility locations shown are generally schematic in nature and may not accurately reflect the size and location of each particular utility. Contractor shall assume responsibility for actual field location and protection and repairs of existing facilities, whether shown or not. Differences in horizontal or vertical locations of existing utilities shall not be basis for additional compensation to the Contractor. The utility companies which may need to be contacted include, but may not be limited to:
 - A) Town of Addison
 - B) Lone Star Gas
 - C) Southwestern Bell
 - D) Storer Cable
 - E) Planned Cable Systems
 - F) TU Electric
4. The Contractor shall protect existing property monumentation and primary control. Any such points which the Contractor believes will be destroyed shall have offset points established by the Contractor prior to construction. Any monumentation destroyed by the Contractor shall be reestablished at his expense. All monumentation shall conform to the requirements of the Town of Addison.
5. It shall be the responsibility of the Contractor to: A.) Prevent any damage to private property and property owner's poles, fences, shrubs, etc. B.) Protect all underground utilities. C.) Notify all utility companies and field verify horizontal and vertical location of all utilities prior to start of construction. Notify owner of any potential conflicts which may exist between the existing utilities and construction plans.
6. Barricading and traffic control during construction shall be the responsibility of the contractor and shall conform to the 'Texas Manual on Uniform Traffic Control Devices', Part VII in particular. Traffic flow and access shall be maintained during all phases of the construction. The Contractor is responsible for providing traffic safety measures for work on project.
7. The Contractor shall abide by all applicable federal, state, and local laws governing excavation. The contractor shall provide detailed plans and specifications for trench safety systems that comply with applicable laws governing excavation. These plans shall be sealed by an Engineer experienced in the design of trench safety systems and registered by the State of Texas. Submit plan to the Owner prior to commencing work. The contractor shall be solely responsible for all aspects of work related to excavation.
8. Contractor shall maintain drainage at all times during construction. Ponding of water in streets, drives, truck courts, trenches, etc. will not be allowed.
9. Pavement removal and repair shall conform to the Town of Addison requirements. All sawcuts shall be full depth cuts. Contractor shall make efforts to protect concrete edges. Any large spalled or broken edges shall be removed by sawcutting pavement prior to replacement.
10. Any damages that may occur to real property or existing improvements shall be restored by the Contractor to at least the same condition that the real property or existing improvements were in prior to the damages. This restoration shall be subject to the Owner's approval; moreover, this restoration shall not be a basis for additional compensation to the Contractor. Restoration shall include, but not be limited to, regrassing, revegetation, replacing fences, replacing trees, etc.
11. Contractor shall maintain existing sanitary sewer and water service at all times during construction.
12. Contractor is responsible for coordination with utility companies and adjustment of existing sanitary sewer cleanouts, water meters and any other appurtenances to new grade as required.
13. Contractor is responsible for complying with all applicable local, state and federal storm water pollution prevention laws and ordinances.
14. Contractor shall stamp a 2-inch 'S' and a 2-inch 'W' in the curb at the location of the sewer service and water service lines, respectfully.
15. During construction, the Owner shall provide a qualified geotechnical lab to perform materials testing during the construction at the request of the Town of Addison.
16. The contractor shall submit materials sheets to the Town of Addison for approval prior to incorporating materials into the job.

BENCH MARKS:

□ CUT AT WEST CORNER OF CONCRETE HEADWALL OF BOX CULVERT,
SOUTH SIDE OF PROTON DRIVE AND ±350' EAST OF MIDWAY ROAD
AND PROTON DRIVE INTERSECTION. ELEV.=598.37
SET *□* CUT SET ON CURB INLET NORTH SIDE OF PROTON DR. ± 50' WEST
OF WEST R.O.W. OF MIDWAY RD. ELEV=598.92

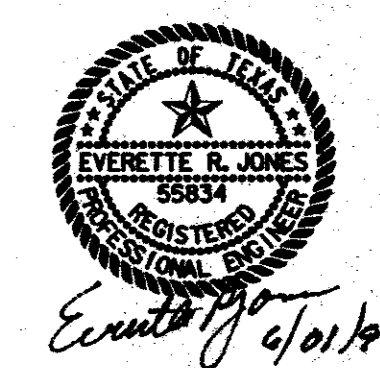

EROSION CONTROL PLAN

ENGLISHMAN'S ANTIQUES
PRITCHARD ASSOCIATES
ADDISON, TEXAS

Half Associates
ENGINEERS • ARCHITECTS • SCIENTISTS • PLANNERS • SURVEYORS

AS BUILT DRAWINGS BASED ON INFORMATION
PROVIDED BY THE CONTRACTOR

7/28/99 EPJ

DESIGN	DRAWN	DATE	SCALE	NOTES	FILE	NO.
R.M.	CADD	JUNE 1998	1" = 20'	T49er01.dgn 16749		ER-1