



FOR ADDISON USE ONLY
 Permit Number W-18801072
 Location: 4387 Westgrove
 Revised 2/20/14

APPLICATION

Right of Way Work Permit -FRANCHISE
 (For Franchise Utility/CTP - Street Cut/Excavation/Lane Closure)

PLEASE PRINT LEGIBLY

Date of application: 12-12-16
 Facility Owner Company: Time Warner Company Phone #: _____
 Utility/CTP Representative: Robert Houston Cell Phone #: 469-744-9794
 General Contractor: G-T-I Company Phone #: 972-329-9933
 Site Supervisor Name: Mike Hulvey 24 hour phone #: 469-853-5420
 Work Site Address and Location: Commercial Sales & SVC 4387 Westgrove Dr
 Purpose and general description of work: Span overlash, 361' New Underground
 Proposed Start Work Date: ~~12-19-16~~ 2/20/17 Estimated Completion Date: ~~1-19-17~~ 2/20/17
 Pavement Cut? Yes No Directional Bore/Boring? Yes No
 Excavation? Yes No Lane Closure? Yes No Other: _____? Yes No
Mike Hulvey Mike Hulvey Supervisor
 Applicant's Printed Name Signature Position with Company
 Applicant's Email: mike@gardner100.com Applicant's Phone Number: 469-853-5420
Robert Houston 469-744-9794 Time Warner
 Direct Supervisor's Printed Name Phone Number Company Name

FOR ADDISON USE ONLY

Received By: Maure S. Entered? Yes Received Date: 12-12-16
 Approved By: Dave Wilde Inspector: JF/pw Issue Date: ~~12-14-16~~ 2/20/17
 Plans Submitted? Yes No N/A Traffic Control Plan Submitted? Yes No N/A Exp. date 3/4/17
 Insurance Provided? Yes No On File Performance/Maintenance Bond? Yes No On File N/A
 Fee Paid: NA Receipt#: CTP Date: _____ Processed By: _____
 Picked Up By: Mike Hulvey Company: G-T-I Date & Time: 2/20/17 9:55 Am

TOWN OF ADDISON INFRASTRUCTURE OPERATIONS AND SERVICES DEPARTMENT
 ATTN: RIGHT OF WAY PERMIT - DAVE WILDE 972-450-2847
 16801 WESTGROVE RD. ADDISON, TX 75001-9010
 PHONE: 972-450-2871 FAX: 972-450-2837



FOR ADDISON USE ONLY
 Permit Number: W-1070
 Location: 4387 Westgrove
 Revised 2/20/14

APPLICATION

Right of Way Work Permit -FRANCHISE

(For Franchise Utility/CTP - Street Cut/Excavation/Lane Closure)

Sub-Contractor List

PLEASE PRINT LEGIBLY

General Contractor's Name: G T I General Contractor's Phone #: 972-329-9933

Sub-Contractor #1 Company Name: Rivera Address: _____

Print Sub-Contractor's Name: Oscar Rivera Sub-Contractor Phone #: 214-952-5688

Print Sub-Contractor's Name: _____ Sub-Contractor Phone #: _____

Insurance Provided? Yes No On File

Sub-Contractor #1 Company Name: _____ Address: _____

Print Sub-Contractor's Name: _____ Sub-Contractor Phone #: _____

Print Sub-Contractor's Name: _____ Sub-Contractor Phone #: _____

Insurance Provided? Yes No On File

Sub-Contractor #1 Company Name: _____ Address: _____

Print Sub-Contractor's Name: _____ Sub-Contractor Phone #: _____

Print Sub-Contractor's Name: _____ Sub-Contractor Phone #: _____

Insurance Provided? Yes No On File

TOWN OF ADDISON INFRASTRUCTURE OPERATIONS AND SERVICES DEPARTMENT
 ATTN.: RIGHT OF WAY PERMIT - DAVE WILDE 972-450-2847
 16801 WESTGROVE RD. ADDISON, TX 75001-9010
 PHONE: 972-450-2871 FAX: 972-450-2837

RIGHT OF WAY, EXCAVATION &
LANE CLOSURE PERMIT

~~W-1030~~

PERMIT NUMBER

12/19/16

START DATE

01/19/17

EST. COMPLETION DATE

GTI

CONTRACTOR

TWC

FOR

4387 WESTGROVE DR

LOCATION (ADDRESS)

POLE S SIDE OF STREET, BORE 49' W, THEN N ACROSS STREET

LOCATION (ACTUAL)

INSTALL CABLE FACILITIES TO REAR OF ADDRESS

TYPE OF WORK

THIS CARD MUST BE DISPLAYED ON THE JOB SITE AT ALL TIMES.

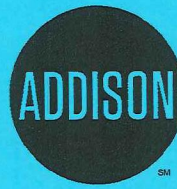

INFRASTRUCTURE &
DEVELOPMENT SERVICES

16801 WESTGROVE DRIVE
ADDISON, TEXAS 75001
972.450.2871

*Re-Issued
as W-1070
2/20/17*





TIME WARNER CABLE

COMMERCIAL SALES &
SERVICE, INC.
4387 WESTGROVE DRIVE
ADDISON, TEXAS

VICINITY MAP

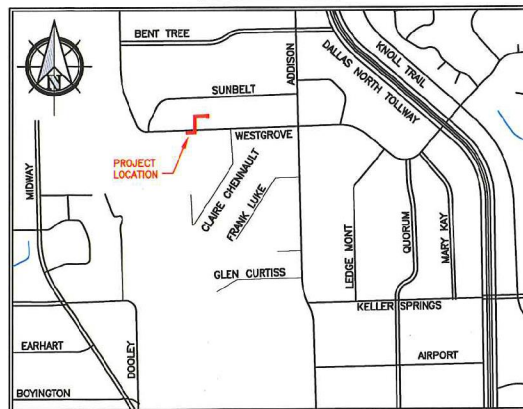

GENERAL PROJECT NOTES

1. ALL CONSTRUCTION WORK WITHIN THE PUBLIC RIGHT-OF-WAY SHALL BE DONE IN ACCORDANCE WITH THE ORDINANCES AND REGULATIONS OF THE MUNICIPALITY IN WHICH THE WORK IS TO BE PERFORMED.
2. EXISTING UTILITY LOCATIONS SHOWN ARE TAKEN FROM AVAILABLE RECORDS AND MAY NOT BE ALL INCLUSIVE. UTILITY LOCATIONS ARE GENERALLY SCHEMATIC IN NATURE AND MAY NOT ACCURATELY REFLECT THE SIZE AND LOCATION OF EACH PARTICULAR UTILITY. THE CONSTRUCTION CONTRACTOR SHALL ASSUME RESPONSIBILITY FOR ACTUAL LINE LOCATES IN THE FIELD AND THE PROTECTION OF ALL EXISTING FACILITIES WHETHER SHOWN OR NOT. THE CONSTRUCTION CONTRACTOR SHALL ALSO ASSUME RESPONSIBILITY FOR REPAIRS TO ANY EXISTING FACILITY DAMAGED AS A DIRECT RESULT OF THE CONSTRUCTION ACTIVITIES WHETHER THE FACILITY IS SHOWN ON THE DRAWINGS OR NOT.
3. THE CONSTRUCTION CONTRACTOR SHALL BE RESPONSIBLE FOR CONTACTING ALL DEPARTMENTS WITHIN THE MUNICIPALITY AND THE UTILITY COMPANIES AT LEAST TWO WORKING DAYS PRIOR TO THE COMMENCEMENT OF WORK.

CALL BEFORE YOU DIG

811

IT'S THE LAW

4. IT SHALL BE THE RESPONSIBILITY OF THE CONSTRUCTION CONTRACTOR TO: A) PREVENT DAMAGE TO PRIVATE AND PUBLIC PROPERTY. B) RESTORE ALL AREAS EFFECTED BY THE CONSTRUCTION TO ORIGINAL OR BETTER CONDITION.
5. BARRICADING AND TRAFFIC CONTROL SHALL BE THE RESPONSIBILITY OF THE CONSTRUCTION CONTRACTOR AND SHALL CONFORM TO THE "TEXAS MANUAL ON UNIFORM TRAFFIC CONTROL DEVICES". TRAFFIC FLOW AND ACCESS SHALL BE MAINTAINED DURING ALL PHASES OF CONSTRUCTION. THE CONSTRUCTION CONTRACTOR IS RESPONSIBLE FOR PROVIDING TRAFFIC SAFETY MEASURES FOR WORK ON THE PROJECT. THE WORK SITE SHALL BE SUITABLY LIT AND BARRICADED AT NIGHT.
6. THE CONSTRUCTION CONTRACTOR SHALL ABIDE BY ALL APPLICABLE FEDERAL, STATE AND LOCAL LAWS GOVERNING EXCAVATION. THE CONSTRUCTION CONTRACTOR SHALL PROVIDE ALL TRENCH SAFETY SYSTEMS THAT COMPLY WITH ALL LAWS GOVERNING EXCAVATION. THE CONSTRUCTION CONTRACTOR SHALL BE SOLELY RESPONSIBLE FOR ALL ASPECTS OF WORK RELATED TO EXCAVATION.
7. ALL CONCRETE USED IN ANY ROADWAY SHALL BE IN COMPLIANCE WITH THE SPECIFIED CLASSES OF CONCRETE IN THE STANDARD SPECIFICATIONS 5.8 "PORTLAND CEMENT CONCRETE PAVEMENT" AND 7.4.5 "QUALITY OF CONCRETE" AS AMENDED BY THE ADDENDUM TO THE NORTH CENTRAL TEXAS STANDARD SPECIFICATIONS FOR PUBLIC WORKS CONSTRUCTION - 2004. ALL OTHER CONCRETE SHALL BE CLASS A CONCRETE.
8. ALL REINFORCING STEEL AND DOWEL BARS IN PAVEMENT SHALL BE SUPPORTED AND MAINTAINED AT THE CORRECT CLEARANCES BY THE USE OF BAR CHAINS OR OTHER APPROVED SUPPORT.
9. ALL CONDUIT MUST BE PLACED WITH A MINIMUM 42" OF COVER, UNLESS OTHERWISE SPECIFIED.
10. ALL BACKFILLING WILL BE MECHANICALLY TAMPED IN LIFTS TO A DENSITY OF 95% PROCTOR. THE REQUIRED DENSITY WILL BE OBTAINED BY USING TAMPERS, RAMMERS OR ROLLING EQUIPMENT. LIFTS MAY VARY ACCORDING TO THE TYPE OF EQUIPMENT USED TO OBTAIN THE REQUIRED DENSITY. SAND AND DEBRIS FREE MATERIAL WILL BE USED FOR BACKFILL.

DFWT CONTACT: DAVID HATTON 972.670.2113

PREPARED BY: DFW TELECOM, INC.

LEGEND

	PROPOSED CONDUIT
	BORE UNDER CONCRETE
	EXISTING CONDUIT
	EXISTING CUSTOMER CONDUIT
	OVERHEAD: NEW BUILD
	OVERHEAD: OVERLASH

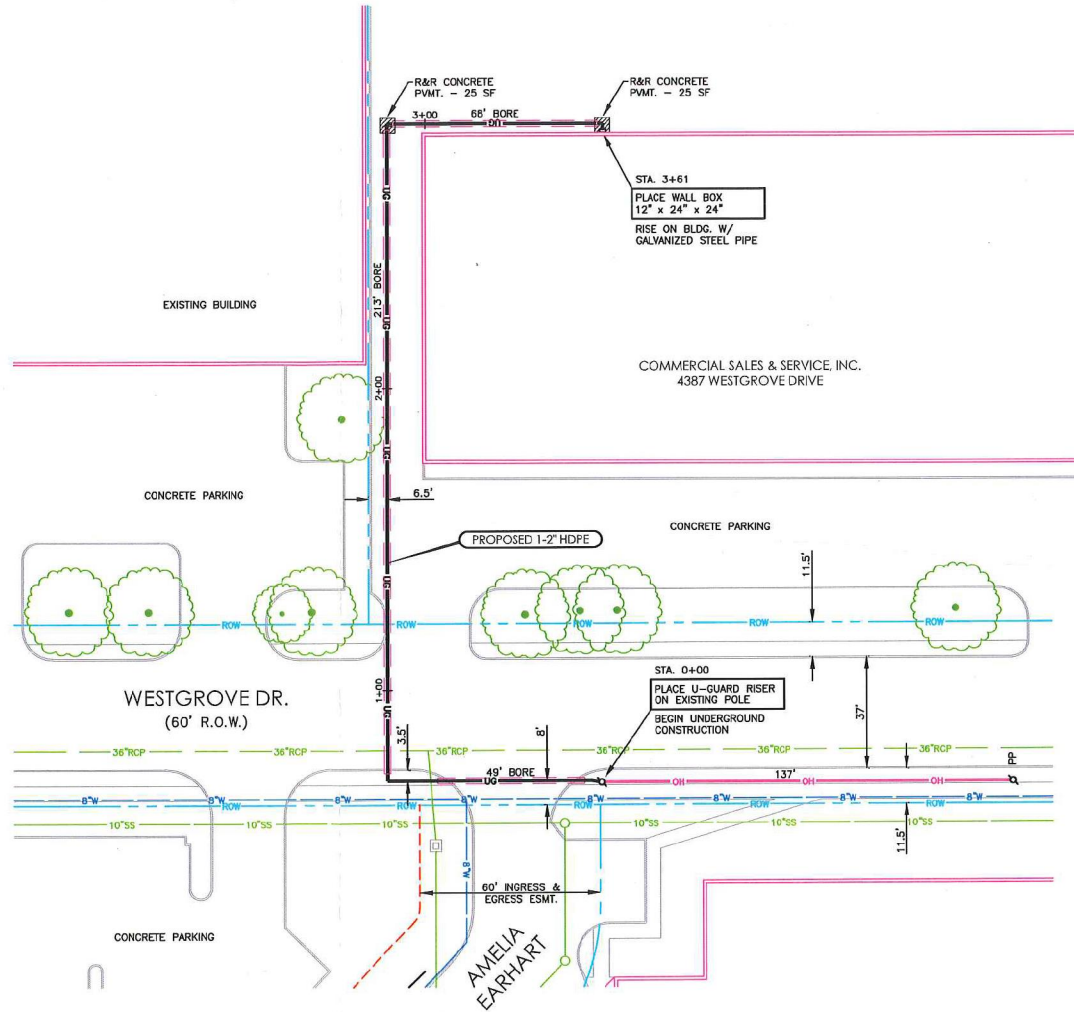

TRENCH DETAIL
NOT TO SCALE

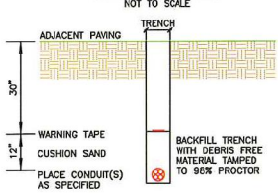

TYPICAL UTILITY CROSSING

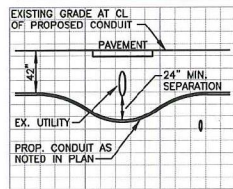

PREPARED BY:

DFWT CONTACT:
DAVID HATTON 972.670.2113

ESTIMATED SHEET TOTALS

DESCRIPTION	QUANTITY	DESCRIPTION	QUANTITY
TRENCH & PLACE CONDUIT	31'	PLACE FLUSH MOUNT VAULT	
BORE & PLACE CONDUIT	330'	PLACE PEDESTAL	
BORE & PLACE STEEL CASING		PLACE FLUSH DROP BUCKET	
FULL THROUGH EXISTING CONDUIT		PLACE POWER SUPPLY	
R & R CONCRETE SIDEWALK (SF)		PLACE WALL BOX & RISER	1
R & R CONCRETE PAVEMENT (SF)	50	PLACE U-GUARD RISER	1
OVERHEAD: OVERLASH	137'	OVERHEAD: NEW BUILD	



PROJECT: **COMMERCIAL SALES & SERVICE, INC.**
ADDRESS: 4387 WESTGROVE DRIVE
CITY, STATE: ADDISON, TEXAS

HORIZONTAL SCALE: 1" = 40'
VERTICAL SCALE: 1" = 10'

JOB NUMBER: DID-1385828
DATE: 12-09-2016

