



FOR ADDISON USE ONLY
 Permit Number: W-1054
 Location: 4930 Belt Line Rd

APPLICATION

Right of Way Work Permit - PUBLIC UTILITY/CTP
 (For Public Utility/CTP - Street Cut/Excavation/Lane Closure)

PLEASE PRINT LEGIBLY

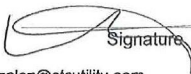
Date of application: 01-31-17
 Facility Owner Company: Spectrum Company Phone #: 214-935-8747
 Utility/CTP Representative: Lyle Bradley Cell Phone #: 214-846-5286
 General Contractor: STC Utility Services Company Phone #: 214-295-5422
 Site Supervisor Name: Chris Twidwell 24 hour phone #: 214-283-4706
 Work Site Address and Location: 4930 Belt Line to West side of Landmark Blvd RMO # 61649
 Purpose and general description of work: Directional bore and place new CATV conduit to replace damaged cable
 Proposed Start Work Date: 02-02-17 Estimated Completion Date: 03-02-17
 Pavement Cut? Yes No Directional Bore/Boring? Yes No
 Excavation? Yes No Lane Closure? Yes No Other: _____ ? Yes No
 Applicant's Printed Name: Melissa Gonzalez Signature:  Project Coordinator
 Position with Company: _____
 Applicant's Email: melissa.gonzalez@stcutility.com Applicant's Phone Number: 817-683-0478
 Direct Supervisor's Printed Name: Chris Twidwell Phone Number: 214-283-4706 Company Name: STC Utility Services

FOR ADDISON USE ONLY

Received By: DW via Email Entered? Yes Received Date: 1/31/17 3:23PM
 Approved By: Dave Wilde Inspector: JS Issue Date: 2/2/17
 Plans Submitted? Yes No N/A Traffic Control Plan Submitted? Yes No N/A Expiration Date: 2/16/17
 Insurance Provided? Yes No On File Performance/Maintenance Bond? Yes No On File N/A
 Fee Paid: NA Receipt#: CTP Date: 2-3-17 Processed By: Melissa S.
 Picked Up By: Chris Company: STC Date & Time: 2-3-17 1:59PM

TOWN OF ADDISON INFRASTRUCTURE AND DEVELOPMENT SERVICES
 DEPARTMENT ATTN.: RIGHT OF WAY PERMIT - DAVE WILDE 972-450-2847
 16801 WESTGROVE RD. ADDISON, TX 75001-9010
 PHONE: 972-450-2871 FAX: 972-450-2837



FOR ADDISON USE ONLY	
Permit Number:	<u>W-1054</u>
Location:	_____

APPLICATION
Right of Way Work Permit –PUBLIC UTILITY/CTP
 (For Public Utility/CTP - Street Cut/Excavation/Lane Closure)

Sub-Contractor List

PLEASE PRINT LEGIBLY

General Contractor's Name: STC Utility General Contractor's Phone #: 214-245-5422

Sub-Contractor #1 Company Name: _____ Address: _____

Print Sub-Contractor's Name: _____ Sub-Contractor Phone #: _____

Print Site Supervisor's Name: _____ Supervisor's Phone #: _____

Insurance Provided? Yes No On File

Sub-Contractor #2 Company Name: _____ Address: _____

Print Sub-Contractor's Name: _____ Sub-Contractor Phone #: _____

Print Supervisor's Name: _____ Supervisor's Phone #: _____

Insurance Provided? Yes No On File

Sub-Contractor #3 Company Name: _____ Address: _____

Print Sub-Contractor's Name: _____ Sub-Contractor Phone #: _____

Print Supervisor's Name: _____ Supervisor's Phone #: _____

Insurance Provided? Yes No On File

Peggy Price

From: RMO_Robot@twcable.com
Sent: Thursday, June 30, 2016 3:27 PM
To: Rick Jaskula; Laura Pedersen; Chris Pedersen; Peggy Price; David.hatton@dfw-telecom.com; Vicki.moore@dfw-telecom.com; Dayna.lapoma@dfw-telecom.com; Lyle.Bradley@Charter.com; Danny Mowery; C-Gage.Joyce@Charter.com; C-Tyler.Hurt@charter.com; Jeff Collins
Subject: RMO - New ticket #61649 - There is a ticket assigned to you.
Attachments: E087996_5291384458541_1kh3d3u1.jpg; E087996_77619570493698_IMG_3405.JPG
Importance: Low

There has been a ticket assigned to you. [Click to view.](#)

14-B

RMWO Ticket #:	61649	MIDWAY
PRIN:	Dallas	
Entered By:	Minneti, Phillip	
Authorized By:	Blanco, Anthony	
Routed To:	STC-Utilities	
Assigned To:	Bradley, Lyle	
Date of Order:	6/22/2016	
Date Completed:		
Completed By:		
Tech ID / Cell phone:	2048 / 2148697992	
Node / Amp:	1kh3 / 1kh3d3u1	1K01 - D3u1
TDR Sent:	(X)Yes	
Location:	4930 Belt Line Addison. Wallbox behind building to Mini Bridger directly West on Landmark.	
Description:	Please replace 345 feet span to .625 Losing 18 db over existing line. Showing short at 12 feet. Another thing with this one. We have 6 outputs coming out of this one minibridger. Ideally this should be a BTD. I don't know what the process would be to change existing plant to BTD, but as of now every leg is losing 6-10 db right away due to number of outputs.	
Type of Repair:	[X]UG	
Repair of:	[X]Cable	
Cable sizes	.625 CA [X]UG 345 feet	
Direct bury?	(X)Yes	

Type of soil:	<input type="checkbox"/> Dirt <input checked="" type="checkbox"/> Concrete
Is temp line placed?	<input type="checkbox"/> No
Is temp spliced?	<input type="checkbox"/> No
Orange St. crossing?	<input type="checkbox"/> No

This E-mail and any of its attachments may contain Time Warner Cable proprietary information, which is privileged, confidential, or subject to copyright belonging to Time Warner Cable. This E-mail is intended solely for the use of the individual or entity to which it is addressed. If you are not the intended recipient of this E-mail, you are hereby notified that any dissemination, distribution, copying, or action taken in relation to the contents of and attachments to this E-mail is strictly prohibited and may be unlawful. If you have received this E-mail in error, please notify the sender immediately and permanently delete the original and any copy of this E-mail and any printout.

TIME WARNER CABLE

RMO-61649
4930 BELTLINE ROAD
ADDISON, TEXAS

VICINITY MAP

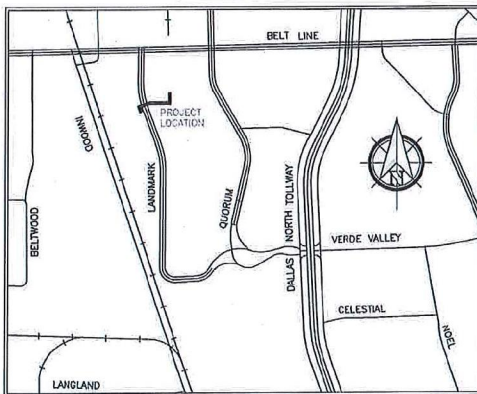

GENERAL PROJECT NOTES

1. ALL CONSTRUCTION WORK WITHIN THE PUBLIC RIGHT-OF-WAY SHALL BE DONE IN ACCORDANCE WITH THE ORDINANCES AND REGULATIONS OF THE MUNICIPALITY IN WHICH THE WORK IS TO BE PERFORMED.
2. EXISTING UTILITY LOCATIONS SHOWN ARE TAKEN FROM AVAILABLE RECORDS AND MAY NOT BE ALL INCLUSIVE. UTILITY LOCATIONS ARE GENERALLY SCHEMATIC IN NATURE AND MAY NOT ACCURATELY REFLECT THE SIZE AND LOCATION OF EACH PARTICULAR UTILITY. THE CONSTRUCTION CONTRACTOR SHALL ASSUME RESPONSIBILITY FOR ACTUAL LINE LOCATES IN THE FIELD AND THE PROTECTION OF ALL EXISTING FACILITIES WHETHER SHOWN OR NOT. THE CONSTRUCTION CONTRACTOR SHALL ALSO ASSUME RESPONSIBILITY FOR REPAIRS TO ANY EXISTING FACILITY DAMAGED AS A DIRECT RESULT OF THE CONSTRUCTION ACTIVITIES WHETHER THE FACILITY IS SHOWN ON THE DRAWINGS OR NOT.
3. THE CONSTRUCTION CONTRACTOR SHALL BE RESPONSIBLE FOR CONTACTING ALL DEPARTMENTS WITHIN THE MUNICIPALITY AND THE UTILITY COMPANIES AT LEAST TWO WORKING DAYS PRIOR TO THE COMMENCEMENT OF WORK.

CALL BEFORE YOU DIG

811

IT'S THE LAW

4. IT SHALL BE THE RESPONSIBILITY OF THE CONSTRUCTION CONTRACTOR TO: A) PREVENT DAMAGE TO PRIVATE AND PUBLIC PROPERTY. B) RESTORE ALL AREAS EFFECTED BY THE CONSTRUCTION TO ORIGINAL OR BETTER CONDITION.
5. BARRICAADING AND TRAFFIC CONTROL SHALL BE THE RESPONSIBILITY OF THE CONSTRUCTION CONTRACTOR AND SHALL CONFORM TO THE "TEXAS MANUAL ON UNIFORM TRAFFIC CONTROL DEVICES". TRAFFIC FLOW AND ACCESS SHALL BE MAINTAINED DURING ALL PHASES OF CONSTRUCTION. THE CONSTRUCTION CONTRACTOR IS RESPONSIBLE FOR PROVIDING TRAFFIC SAFETY MEASURES FOR WORK ON THE PROJECT. THE WORK SITE SHALL BE SUITABLY LIT AND BARRICADED AT NIGHT.
6. THE CONSTRUCTION CONTRACTOR SHALL ABIDE BY ALL APPLICABLE FEDERAL, STATE AND LOCAL LAWS GOVERNING EXCAVATION. THE CONSTRUCTION CONTRACTOR SHALL PROVIDE ALL TRENCH SAFETY SYSTEMS THAT COMPLY WITH ALL LAWS GOVERNING EXCAVATION. THE CONSTRUCTION CONTRACTOR SHALL BE SOLELY RESPONSIBLE FOR ALL ASPECTS OF WORK RELATED TO EXCAVATION.
7. ALL CONCRETE USED IN ANY ROADWAY SHALL BE IN COMPLIANCE WITH THE SPECIFIED CLASSES OF CONCRETE IN THE STANDARD SPECIFICATIONS 5.8 "PORLAND CEMENT CONCRETE PAVEMENT" AND 7.4.5 "QUALITY OF CONCRETE" AS AMENDED BY THE ADDENDUM TO THE NORTH CENTRAL TEXAS STANDARD SPECIFICATIONS FOR PUBLIC WORKS CONSTRUCTION - 2004. ALL OTHER CONCRETE SHALL BE CLASS A CONCRETE.
8. ALL REINFORCING STEEL AND DOWEL BARS IN PAVEMENT SHALL BE SUPPORTED AND MAINTAINED AT THE CORRECT CLEARANCES BY THE USE OF BAR CHAINS OR OTHER APPROVED SUPPORT.
9. ALL CONDUIT MUST BE PLACED WITH A MINIMUM 42" OF COVER, UNLESS OTHERWISE SPECIFIED.
10. ALL BACKFILLING WILL BE MECHANICALLY TAMPED IN LIFTS TO A DENSITY OF 95% PROCTOR. THE REQUIRED DENSITY WILL BE OBTAINED BY USING TAMPERS, RAMMERS OR ROLLING EQUIPMENT. LIFTS MAY VARY ACCORDING TO THE TYPE OF EQUIPMENT USED TO OBTAIN THE REQUIRED DENSITY. SAND AND DEBRIS FREE MATERIAL WILL BE USED FOR BACKFILL.

DFWT CONTACT: DAVID HATTON 972.670.2113

PREPARED BY: DFW TELECOM, INC.

LEGEND	
	PROPOSED CONDUIT
	BORE UNDER CONCRETE
	BORE UNDER CONCRETE
	EXISTING CONDUIT
	EXISTING CUSTOMER CONDUIT
	OVERHEAD: NEW BUILD
	OVERHEAD: OVERLASH

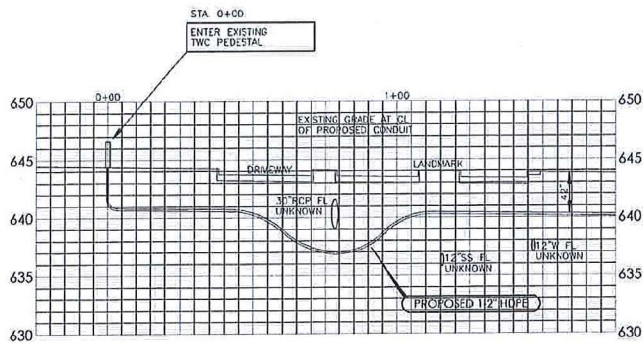

TRENCH DETAIL

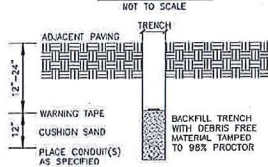

TYPICAL UTILITY CROSSING

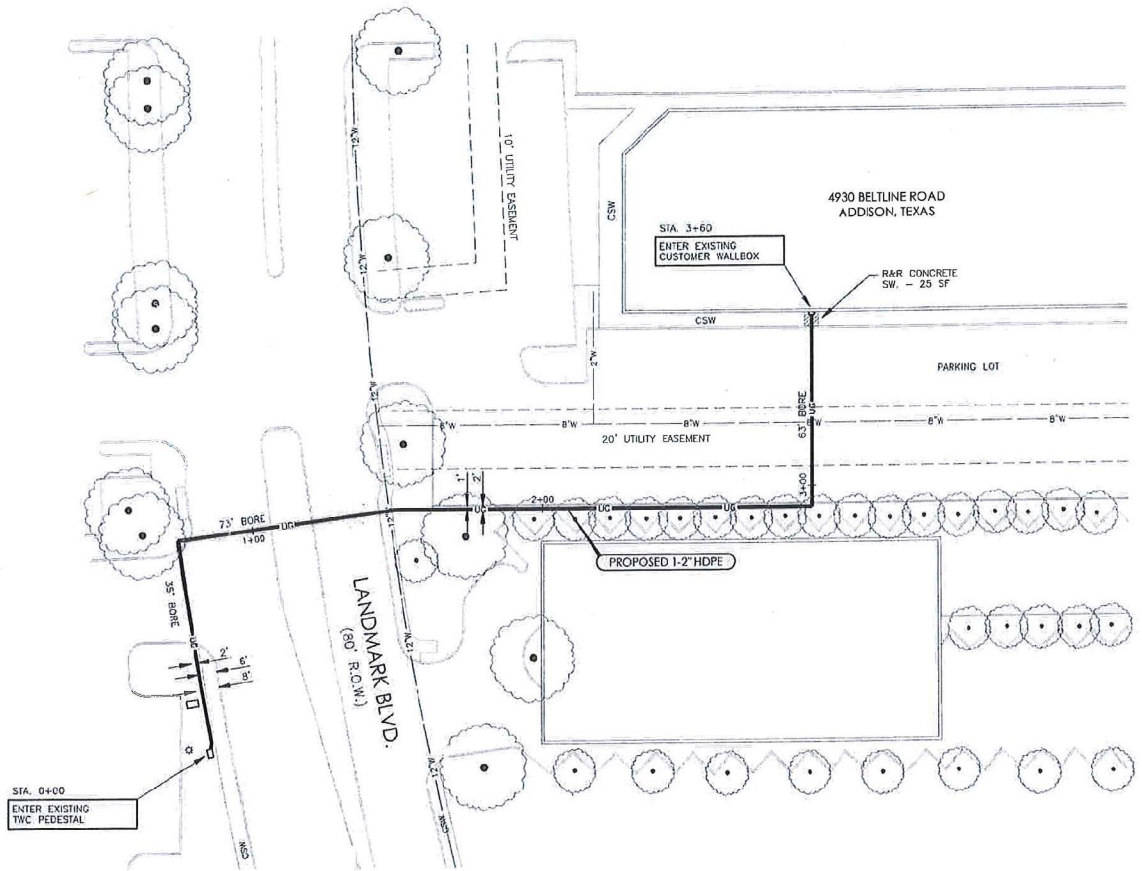
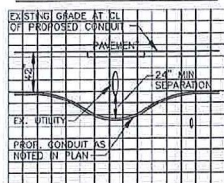

PREPARED BY:



DFWT CONTACT:
DAVID HATTON 972.670.2113

ESTIMATED SHEET TOTALS

DESCRIPTION	QUANTITY	DESCRIPTION	QUANTITY
TRENCH & PLACE CONDUIT	189'	PLACE FLUSH MOUNT VAULT	
BORE & PLACE CONDUIT	171'	PLACE PEDESTAL	
BORE & PLACE STEEL CASING		PLACE FLUSH DROP BUCKET	
PULL THROUGH EXISTING CONDUIT		PLACE POWER SUPPLY	
R & R CONCRETE SIDEWALK (SF)	25 SF	PLACE WALL BOX & RISER	
R & R CONCRETE PAVEMENT (SF)		PLACE U-GUARD RISER	
OVERHEAD: OVERLASH		OVERHEAD: NEW BUILD	

NORTH



SHEET
1 OF 1

PROJECT: **SPAN REPLACEMENT**
(REPLACE EXIST. CATV DUE TO DAMAGE)

ADDRESS: 4930 BELTLINE ROAD
CITY, STATE: ADDISON, TEXAS

HORIZONTAL SCALE 1" = 40'	VERTICAL SCALE 1" = 10'	JOB NUMBER: RMO-61649	DATE: 08-05-2016
------------------------------	----------------------------	--------------------------	---------------------



