



FOR ADDISON USE ONLY
 Permit Number: W-1075
 Location: 4700 Ratliff
 Revised 2/20/14

APPLICATION

Right of Way Work Permit -FRANCHISE

(For Franchise Utility/CTP - Street Cut/Excavation/Lane Closure)

PLEASE PRINT LEGIBLY

Date of application: 2-23-17
 Facility Owner Company: TWC / Spectrum Company Phone #: _____
 Utility/CTP Representative: Robert Houston Cell Phone #: 469-744-9794
 General Contractor: GTT Company Phone #: 972-329-9933
 Site Supervisor Name: Mike Hulvey 24 hour phone #: 469-853-5420
 Work Site Address and Location: Auto Cave 4700 Ratliff LN
 Purpose and general description of work: 328' New U.G., 330' Pull through existing conduit
 Proposed Start Work Date: 3-3-17 Estimated Completion Date: 4-3-17
 Pavement Cut? Yes No Directional Bore/Boring? Yes No
 Excavation? Yes No Lane Closure? Yes No Other: _____ ? Yes No
 Applicant's Printed Name: Mike Hulvey Signature: Mike Hulvey Position with Company: Supervisor
 Applicant's Email: mike@gardner100.com Applicant's Phone Number: 469-853-5420
 Direct Supervisor's Printed Name: Robert Houston Phone Number: 469-744-9794 Company Name: Spectrum

FOR ADDISON USE ONLY

Received By: Nicele Simpson Entered? Yes No Received Date: 2/23/17
 Approved By: Dave Wilder Inspector: JE Issue Date: 2/23/17
 Plans Submitted? Yes No N/A Traffic Control Plan Submitted? Yes No N/A 3/1/17
 Insurance Provided? Yes No On File Performance/Maintenance Bond? Yes No On File N/A
 Fee Paid: NA Receipt#: CTP Date: _____ Processed By: _____
 Picked Up By: Mike Hulvey Company: GTT Date & Time: 2-28-17

TOWN OF ADDISON INFRASTRUCTURE OPERATIONS AND SERVICES DEPARTMENT
 ATTN.: RIGHT OF WAY PERMIT - DAVE WILDE 972-450-2847
 16801 WESTGROVE RD. ADDISON, TX 75001-9010
 PHONE: 972-450-2871 FAX: 972-450-2837



FOR ADDISON USE ONLY

Permit Number: _____

Location: _____

Revised 2/20/14

APPLICATION

Right of Way Work Permit -FRANCHISE

(For Franchise Utility/CTP - Street Cut/Excavation/Lane Closure)

Sub-Contractor List

PLEASE PRINT LEGIBLY

General Contractor's Name: G T I General Contractor's Phone #: 972-329-9933

Sub-Contractor #1 Company Name: Ventura Address: _____

Print Sub-Contractor's Name: Simon Ventura Sub-Contractor Phone #: 214-991-5948

Print Sub-Contractor's Name: _____ Sub-Contractor Phone #: _____

Insurance Provided? Yes No On File

Sub-Contractor #1 Company Name: _____ Address: _____

Print Sub-Contractor's Name: _____ Sub-Contractor Phone #: _____

Print Sub-Contractor's Name: _____ Sub-Contractor Phone #: _____

Insurance Provided? Yes No On File

Sub-Contractor #1 Company Name: _____ Address: _____

Print Sub-Contractor's Name: _____ Sub-Contractor Phone #: _____

Print Sub-Contractor's Name: _____ Sub-Contractor Phone #: _____

Insurance Provided? Yes No On File

TOWN OF ADDISON INFRASTRUCTURE OPERATIONS AND SERVICES DEPARTMENT
ATTN.: RIGHT OF WAY PERMIT - DAVE WILDE 972-450-2847
16801 WESTGROVE RD. ADDISON, TX 76001-9010
PHONE: 972-450-2871 FAX: 972-450-2837

Spectrum

THE AUTO CAVE 4700 RATLIFF LN ADDISON, TEXAS

VICINITY MAP

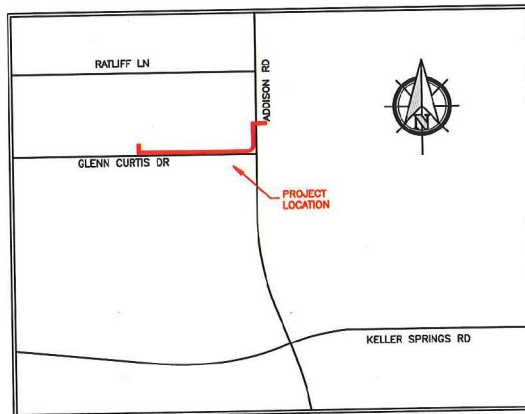

GENERAL PROJECT NOTES

1. ALL CONSTRUCTION WORK WITHIN THE PUBLIC RIGHT-OF-WAY SHALL BE DONE IN ACCORDANCE WITH THE ORDINANCES AND REGULATIONS OF THE MUNICIPALITY IN WHICH THE WORK IS TO BE PERFORMED.
2. EXISTING UTILITY LOCATIONS SHOWN ARE TAKEN FROM AVAILABLE RECORDS AND MAY NOT BE ALL INCLUSIVE. UTILITY LOCATIONS ARE GENERALLY SCHEMATIC IN NATURE AND MAY NOT ACCURATELY REFLECT THE SIZE AND LOCATION OF EACH PARTICULAR UTILITY. THE CONSTRUCTION CONTRACTOR SHALL ASSUME RESPONSIBILITY FOR ACTUAL LINE LOCATES IN THE FIELD AND THE PROTECTION OF ALL EXISTING FACILITIES WHETHER SHOWN OR NOT. THE CONSTRUCTION CONTRACTOR SHALL ALSO ASSUME RESPONSIBILITY FOR REPAIRS TO ANY EXISTING FACILITY DAMAGED AS A DIRECT RESULT OF THE CONSTRUCTION ACTIVITIES WHETHER THE FACILITY IS SHOWN ON THE DRAWINGS OR NOT.
3. THE CONSTRUCTION CONTRACTOR SHALL BE RESPONSIBLE FOR CONTACTING ALL DEPARTMENTS WITHIN THE MUNICIPALITY AND THE UTILITY COMPANIES AT LEAST TWO WORKING DAYS PRIOR TO THE COMMENCEMENT OF WORK.

CALL BEFORE YOU DIG

811

IT'S THE LAW

4. IT SHALL BE THE RESPONSIBILITY OF THE CONSTRUCTION CONTRACTOR TO: A) PREVENT DAMAGE TO PRIVATE AND PUBLIC PROPERTY. B) RESTORE ALL AREAS EFFECTED BY THE CONSTRUCTION TO ORIGINAL OR BETTER CONDITION.
5. BARRICADING AND TRAFFIC CONTROL SHALL BE THE RESPONSIBILITY OF THE CONSTRUCTION CONTRACTOR AND SHALL CONFORM TO THE "TEXAS MANUAL ON UNIFORM TRAFFIC CONTROL DEVICES". TRAFFIC FLOW AND ACCESS SHALL BE MAINTAINED DURING ALL PHASES OF CONSTRUCTION. THE CONSTRUCTION CONTRACTOR IS RESPONSIBLE FOR PROVIDING TRAFFIC SAFETY MEASURES FOR WORK ON THE PROJECT. THE WORK SITE SHALL BE SUITABLY LIT AND BARRICADED AT NIGHT.
6. THE CONSTRUCTION CONTRACTOR SHALL ABIDE BY ALL APPLICABLE FEDERAL, STATE AND LOCAL LAWS GOVERNING EXCAVATION. THE CONSTRUCTION CONTRACTOR SHALL PROVIDE ALL TRENCH SAFETY SYSTEMS THAT COMPLY WITH ALL LAWS GOVERNING EXCAVATION. THE CONSTRUCTION CONTRACTOR SHALL BE SOLELY RESPONSIBLE FOR ALL ASPECTS OF WORK RELATED TO EXCAVATION.
7. ALL CONCRETE USED IN ANY ROADWAY SHALL BE IN COMPLIANCE WITH THE SPECIFIED CLASSES OF CONCRETE IN THE STANDARD SPECIFICATIONS 5.8 "PORTLAND CEMENT CONCRETE PAVEMENT" AND 7.4.5 "QUALITY OF CONCRETE" AS AMENDED BY THE ADDENDUM TO THE NORTH CENTRAL TEXAS STANDARD SPECIFICATIONS FOR PUBLIC WORKS CONSTRUCTION - 2004. ALL OTHER CONCRETE SHALL BE CLASS A CONCRETE.
8. ALL REINFORCING STEEL AND DOWEL BARS IN PAVEMENT SHALL BE SUPPORTED AND MAINTAINED AT THE CORRECT CLEARANCES BY THE USE OF BAR CHAINS OR OTHER APPROVED SUPPORT.
9. ALL CONDUIT MUST BE PLACED WITH A MINIMUM 42" OF COVER, UNLESS OTHERWISE SPECIFIED.
10. ALL BACKFILLING WILL BE MECHANICALLY TAMPED IN LIFTS TO A DENSITY OF 95% PROCTOR. THE REQUIRED DENSITY WILL BE OBTAINED BY USING TAMPERS, RAMMERS OR ROLLING EQUIPMENT. LIFTS MAY VARY ACCORDING TO THE TYPE OF EQUIPMENT USED TO OBTAIN THE REQUIRED DENSITY. SAND AND DEBRIS FREE MATERIAL WILL BE USED FOR BACKFILL.

DFWT CONTACT: DAVID HATTON 972.670.2113

PREPARED BY: DFW TELECOM, INC.

LEGEND

UC	PROPOSED CONDUIT
XX' BORE	BORE UNDER CONCRETE
---	EXISTING CONDUIT
---	EXISTING CUSTOMER CONDUIT
PP XX' PP	OVERHEAD: NEW BUILD
PP XX' OH	OVERHEAD: OVERLASH

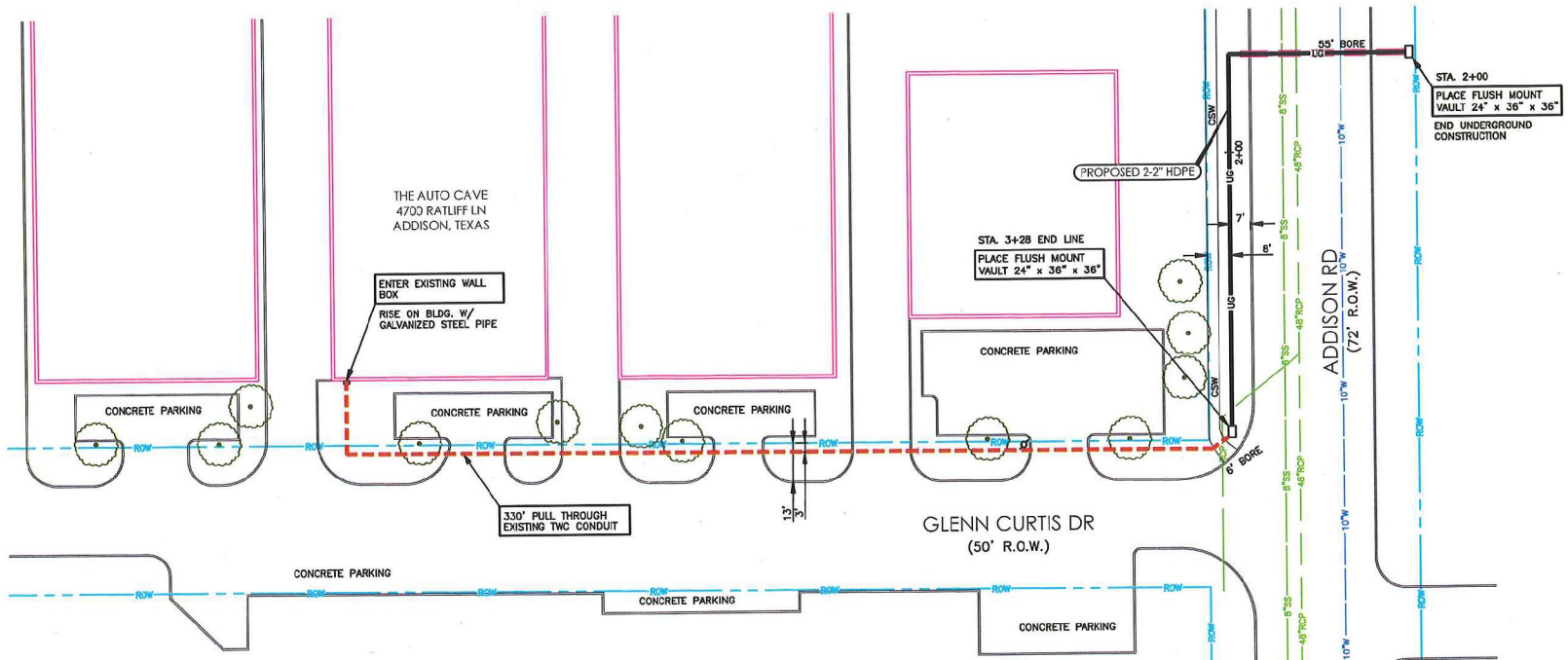

TRENCH DETAIL
NOT TO SCALE

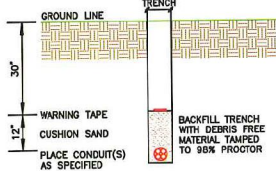

TYPICAL UTILITY CROSSING

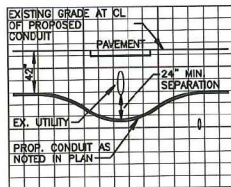

PREPARED BY:

 DFW CONTACT:
 DAVID HATTON 972.670.2113

ESTIMATED SHEET TOTALS			
DESCRIPTION	QUANTITY	DESCRIPTION	QUANTITY
TRENCH & PLACE CONDUIT	145'	PLACE FLUSH MOUNT VAULT	1
BORE & PLACE CONDUIT	55'	PLACE PEDESTAL	
BORE & PLACE STEEL CASING		PLACE FLUSH DROP BUCKET	
PULL THROUGH EXISTING CONDUIT	330'	PLACE POWER SUPPLY	
R & R CONCRETE SIDEWALK (SF)		PLACE WALL BOX & RISER	
R & R CONCRETE PAVEMENT (SF)		PLACE U-GUARD RISER	1
OVERHEAD: OVERLASH		OVERHEAD: NEW BUILD	

NORTH

 SHEET
 1 OF 1

PROJECT: THE AUTO CAVE
 ADDRESS: 4700 RATLIFF LN
 CITY, STATE: ADDISON, TEXAS
 HORIZONTAL SCALE: 1" = 40'
 VERTICAL SCALE: 1" = 10'
 JOB NUMBER: 1418978
 DATE: 2/21/2017

