



**FOR ADDISON USE ONLY**  
 Permit Number: W-1100  
 Location: 3730 Belt Line Rd  
 Revised 2/20/14

**APPLICATION**

**Right of Way Work Permit -FRANCHISE**  
 (For Franchise Utility/CTP - Street Cut/Excavation/Lane Closure)

**PLEASE PRINT LEGIBLY**

Date of application: 4-4-17  
 Facility Owner Company: Spectrum Company Phone #: \_\_\_\_\_  
 Utility/CTP Representative: Robert Houston Cell Phone #: 469-744-9794  
 General Contractor: G-T-I Company Phone #: 972-329-9933  
 Site Supervisor Name: Mike Hulvey 24 hour phone #: 469-853-5420  
 Work Site Address and Location: Verizon Business 3730 Beltline Rd  
 Purpose and general description of work: 961' New underground  
 Proposed Start Work Date: 4-10-17 Estimated Completion Date: 5-10-17  
 Pavement Cut?  Yes  No Directional Bore/Boring?  Yes  No  
 Excavation?  Yes  No Lane Closure?  Yes  No Other: \_\_\_\_\_ ?  Yes  No  
 Applicant's Printed Name: Mike Hulvey Signature: Mike Hulvey Position with Company: Supervisor  
 Applicant's Email: mike@gardner100.com Applicant's Phone Number: 469-853-5420  
 Direct Supervisor's Printed Name: Robert Houston Phone Number: 469-744-9794 Company Name: Spectrum

**FOR ADDISON USE ONLY**

Received By: Nicole Simpson Entered?  Yes  No Received Date: 4-04-17  
 Approved By: Dave Wilde Inspector: JE Issue Date: 4/2/17  
 Plans Submitted?  Yes  No  N/A Traffic Control Plan Submitted?  Yes  No  N/A Exp. 4/24/17  
 Insurance Provided?  Yes  No  On File Performance/Maintenance Bond?  Yes  No  On File  N/A  
 Fee Paid: NA Receipt#: CTP Date: \_\_\_\_\_ Processed By: \_\_\_\_\_  
 Picked Up By: \_\_\_\_\_ Company: \_\_\_\_\_ Date & Time: \_\_\_\_\_

TOWN OF ADDISON INFRASTRUCTURE OPERATIONS AND SERVICES DEPARTMENT  
 ATTN: RIGHT OF WAY PERMIT - DAVE WILDE 972-450-2847  
 16801 WESTGROVE RD, ADDISON, TX 75001-9010  
 PHONE: 972-450-2371 FAX: 972-450-2837



FOR ADDISON USE ONLY  
Permit Number: W-1100  
Location: 3720 Belt Line Rd  
Revised 2/20/14

**APPLICATION**

**Right of Way Work Permit -FRANCHISE**

(For Franchise Utility/CTP - Street Cut/Excavation/Lane Closure)

**Sub-Contractor List**

PLEASE PRINT LEGIBLY

General Contractor's Name: GTI General Contractor's Phone #: 972-329-9933

Sub-Contractor #1 Company Name: Ventura Address: \_\_\_\_\_

Print Sub-Contractor's Name: Simon Ventura Sub-Contractor Phone #: 214-991-5948

Print Sub-Contractor's Name: \_\_\_\_\_ Sub-Contractor Phone #: \_\_\_\_\_

Insurance Provided?  Yes  No  On File

Sub-Contractor #1 Company Name: \_\_\_\_\_ Address: \_\_\_\_\_

Print Sub-Contractor's Name: \_\_\_\_\_ Sub-Contractor Phone #: \_\_\_\_\_

Print Sub-Contractor's Name: \_\_\_\_\_ Sub-Contractor Phone #: \_\_\_\_\_

Insurance Provided?  Yes  No  On File

Sub-Contractor #1 Company Name: \_\_\_\_\_ Address: \_\_\_\_\_

Print Sub-Contractor's Name: \_\_\_\_\_ Sub-Contractor Phone #: \_\_\_\_\_

Print Sub-Contractor's Name: \_\_\_\_\_ Sub-Contractor Phone #: \_\_\_\_\_

Insurance Provided?  Yes  No  On File

TOWN OF ADDISON INFRASTRUCTURE OPERATIONS AND SERVICES DEPARTMENT  
ATTN.: RIGHT OF WAY PERMIT - DAVE WILDE 972-450-2847  
16801 WESTGROVE RD. ADDISON, TX 75001-9010  
PHONE: 972-450-2871 FAX: 972-450-2837

# Spectrum

VERIZON BUSINESS  
3730 BELT LINE ROAD  
ADDISON, TEXAS

VICINITY MAP

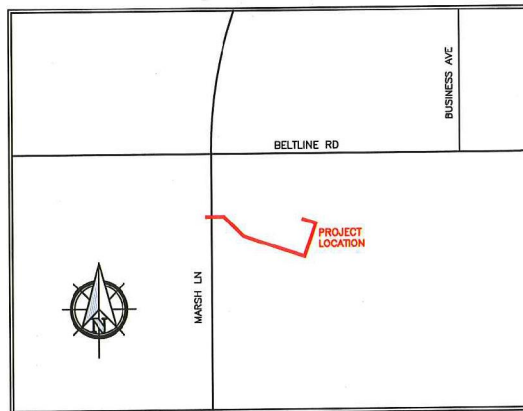

## GENERAL PROJECT NOTES

1. ALL CONSTRUCTION WORK WITHIN THE PUBLIC RIGHT-OF-WAY SHALL BE DONE IN ACCORDANCE WITH THE ORDINANCES AND REGULATIONS OF THE MUNICIPALITY IN WHICH THE WORK IS TO BE PERFORMED.
2. EXISTING UTILITY LOCATIONS SHOWN ARE TAKEN FROM AVAILABLE RECORDS AND MAY NOT BE ALL INCLUSIVE. UTILITY LOCATIONS ARE GENERALLY SCHEMATIC IN NATURE AND MAY NOT ACCURATELY REFLECT THE SIZE AND LOCATION OF EACH PARTICULAR UTILITY. THE CONSTRUCTION CONTRACTOR SHALL ASSUME RESPONSIBILITY FOR ACTUAL LINE LOCATES IN THE FIELD AND THE PROTECTION OF ALL EXISTING FACILITIES WHETHER SHOWN OR NOT. THE CONSTRUCTION CONTRACTOR SHALL ALSO ASSUME RESPONSIBILITY FOR REPAIRS TO ANY EXISTING FACILITY DAMAGED AS A DIRECT RESULT OF THE CONSTRUCTION ACTIVITIES WHETHER THE FACILITY IS SHOWN ON THE DRAWINGS OR NOT.
3. THE CONSTRUCTION CONTRACTOR SHALL BE RESPONSIBLE FOR CONTACTING ALL DEPARTMENTS WITHIN THE MUNICIPALITY AND THE UTILITY COMPANIES AT LEAST TWO WORKING DAYS PRIOR TO THE COMMENCEMENT OF WORK.

CALL BEFORE YOU DIG

811

IT'S THE LAW

4. IT SHALL BE THE RESPONSIBILITY OF THE CONSTRUCTION CONTRACTOR TO: A) PREVENT DAMAGE TO PRIVATE AND PUBLIC PROPERTY. B) RESTORE ALL AREAS EFFECTED BY THE CONSTRUCTION TO ORIGINAL OR BETTER CONDITION.
5. BARRICADING AND TRAFFIC CONTROL SHALL BE THE RESPONSIBILITY OF THE CONSTRUCTION CONTRACTOR AND SHALL CONFORM TO THE "TEXAS MANUAL ON UNIFORM TRAFFIC CONTROL DEVICES". TRAFFIC FLOW AND ACCESS SHALL BE MAINTAINED DURING ALL PHASES OF CONSTRUCTION. THE CONSTRUCTION CONTRACTOR IS RESPONSIBLE FOR PROVIDING TRAFFIC SAFETY MEASURES FOR WORK ON THE PROJECT. THE WORK SITE SHALL BE SUITABLY LIT AND BARRICADED AT NIGHT.
6. THE CONSTRUCTION CONTRACTOR SHALL ABIDE BY ALL APPLICABLE FEDERAL, STATE AND LOCAL LAWS GOVERNING EXCAVATION. THE CONSTRUCTION CONTRACTOR SHALL PROVIDE ALL TRENCH SAFETY SYSTEMS THAT COMPLY WITH ALL LAWS GOVERNING EXCAVATION. THE CONSTRUCTION CONTRACTOR SHALL BE SOLELY RESPONSIBLE FOR ALL ASPECTS OF WORK RELATED TO EXCAVATION.
7. ALL CONCRETE USED IN ANY ROADWAY SHALL BE IN COMPLIANCE WITH THE SPECIFIED CLASSES OF CONCRETE IN THE STANDARD SPECIFICATIONS 5.8 "PORTLAND CEMENT CONCRETE PAVEMENT" AND 7.4.5 "QUALITY OF CONCRETE" AS AMENDED BY THE ADDENDUM TO THE NORTH CENTRAL TEXAS STANDARD SPECIFICATIONS FOR PUBLIC WORKS CONSTRUCTION - 2004. ALL OTHER CONCRETE SHALL BE CLASS A CONCRETE.
8. ALL REINFORCING STEEL AND DOWEL BARS IN PAVEMENT SHALL BE SUPPORTED AND MAINTAINED AT THE CORRECT CLEARANCES BY THE USE OF BAR CHAINS OR OTHER APPROVED SUPPORT.
9. ALL CONDUIT MUST BE PLACED WITH A MINIMUM 42" OF COVER, UNLESS OTHERWISE SPECIFIED.
10. ALL BACKFILLING WILL BE MECHANICALLY TAMPED IN LIFTS TO A DENSITY OF 95% PROCTOR. THE REQUIRED DENSITY WILL BE OBTAINED BY USING TAMPERS, RAMMERS OR ROLLING EQUIPMENT. LIFTS MAY VARY ACCORDING TO THE TYPE OF EQUIPMENT USED TO OBTAIN THE REQUIRED DENSITY. SAND AND DEBRIS FREE MATERIAL WILL BE USED FOR BACKFILL.

DFWT CONTACT: DAVID HATTON 972.670.2113

PREPARED BY: DFW TELECOM, INC.

**LEGEND**

	PROPOSED CONDUIT
	BORE UNDER CONCRETE
	EXISTING CONDUIT
	EXISTING CUSTOMER CONDUIT
	OVERHEAD: NEW BUILD
	OVERHEAD: OVERLASH

**TYPICAL UTILITY CROSSING**

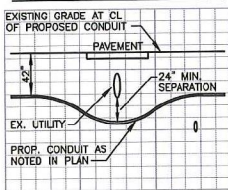

**TRENCH DETAIL**  
NOT TO SCALE

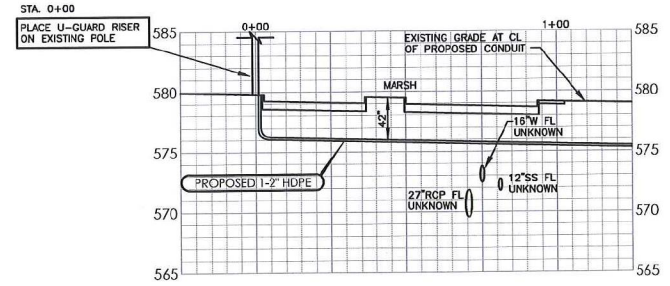
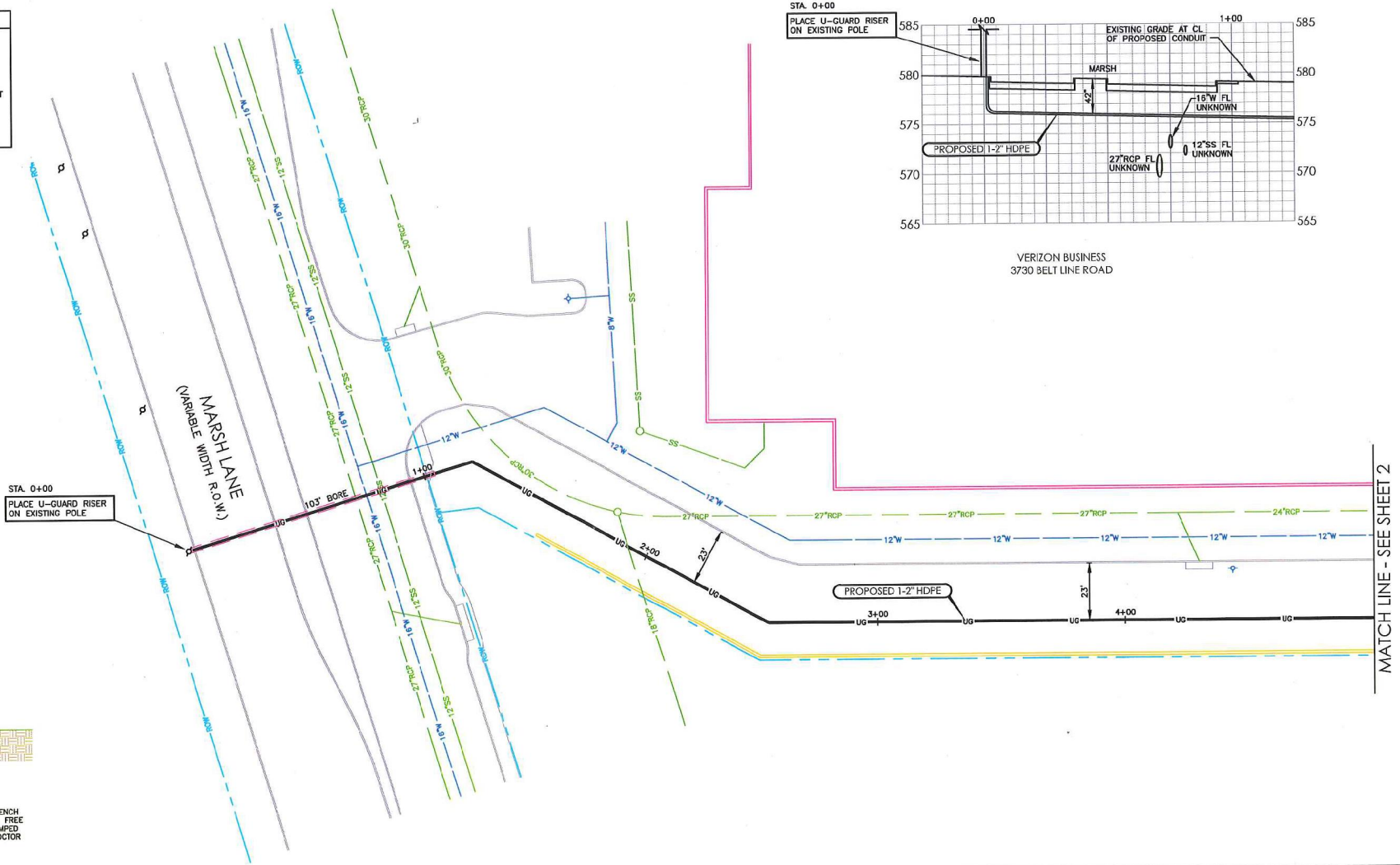
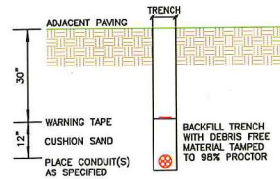

VERIZON BUSINESS  
3730 BELT LINE ROAD

MATCH LINE - SEE SHEET 2

PREPARED BY:



DFWT CONTACT:  
DAVID HATTON 972.670.2113

**ESTIMATED SHEET TOTALS**

DESCRIPTION	QUANTITY	DESCRIPTION	QUANTITY
TRENCH & PLACE CONDUIT	397'	PLACE FLUSH MOUNT VAULT	
BORE & PLACE CONDUIT	103'	PLACE PEDESTAL	
BORE & PLACE STEEL CASING		PLACE FLUSH DROP BUCKET	
PULL THROUGH EXISTING CONDUIT		PLACE POWER SUPPLY	
R & R CONCRETE SIDEWALK (SF)		PLACE WALL BOX & RISER	
R & R CONCRETE PAVEMENT (SF)		PLACE U-GUARD RISER	1
OVERHEAD: OVERLASH		OVERHEAD: NEW BUILD	

NORTH



SHEET  
1 OF 2

PROJECT: VERIZON BUSINESS

ADDRESS: 3730 BELT LINE ROAD  
CITY, STATE: ADDISON, TEXAS

HORIZONTAL SCALE 1" = 40'	VERTICAL SCALE 1" = 10'	JOB NUMBER: DID 1438584	DATE: 03-31-2017
------------------------------	----------------------------	----------------------------	---------------------



LEGEND	
UG	PROPOSED CONDUIT
XX' BORE UG	BORE UNDER CONCRETE
---	EXISTING CONDUIT
---	EXISTING CUSTOMER CONDUIT
PP XX' OH PP	OVERHEAD: NEW BUILD
PP XX' OH PP	OVERHEAD: OVERLASH

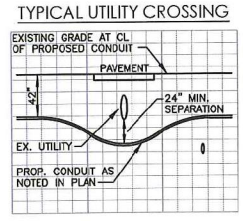
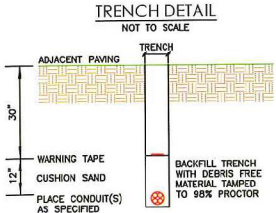
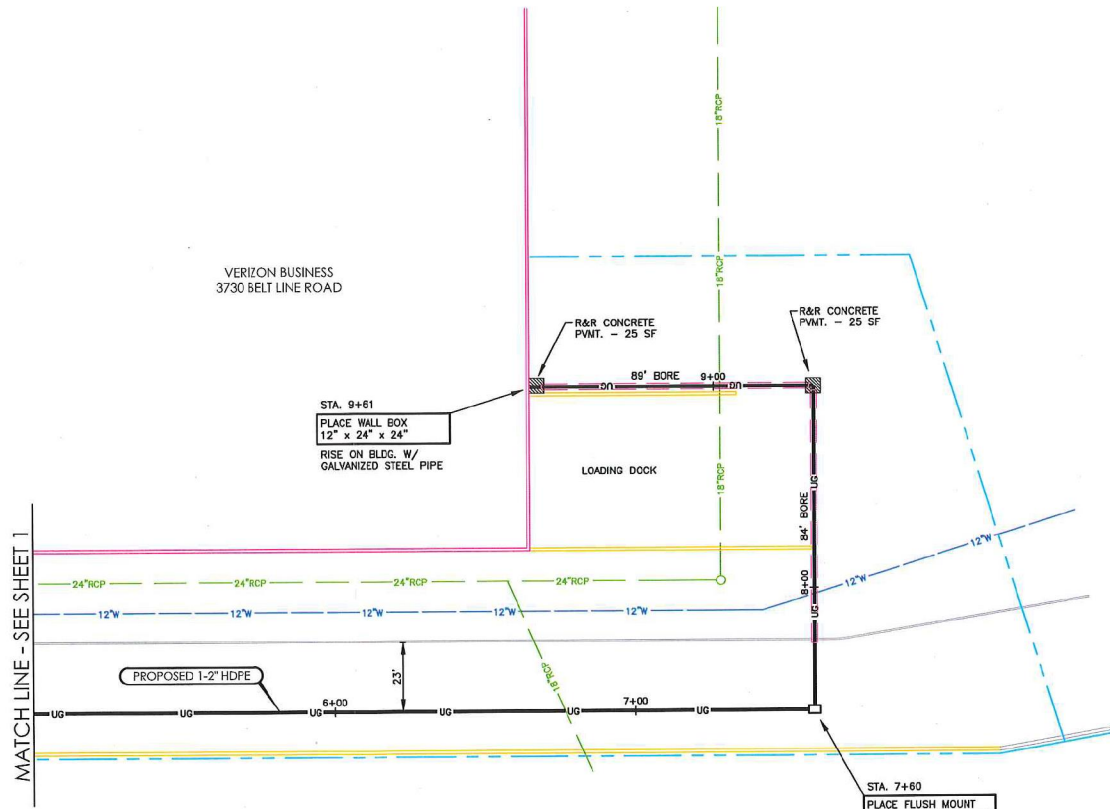

PREPARED BY:  
  
 DFW CONTACT:  
 DAVID HAITON 972.670.2113

ESTIMATED SHEET TOTALS			
DESCRIPTION	QUANTITY	DESCRIPTION	QUANTITY
TRENCH & PLACE CONDUIT	288'	PLACE FLUSH MOUNT VAULT	1
BORE & PLACE CONDUIT	173'	PLACE PEDESTAL	
BORE & PLACE STEEL CASING		PLACE FLUSH DROP BUCKET	
PULL THROUGH EXISTING CONDUIT		PLACE POWER SUPPLY	
R & R CONCRETE SIDEWALK (SF)		PLACE WALL BOX & RISER	
R & R CONCRETE PAVEMENT (SF)	50	PLACE U-GUARD RISER	
OVERHEAD: OVERLASH		OVERHEAD: NEW BUILD	

NORTH  
  
 SHEET  
 2 OF 2

PROJECT: VERIZON BUSINESS  
 ADDRESS: 3730 BELT LINE ROAD  
 CITY, STATE: ADDISON, TEXAS  
 HORIZONTAL SCALE: 1" = 40'  
 VERTICAL SCALE: 1" = 10'  
 JOB NUMBER: DID 1438584  
 DATE: 03-31-2017

