



FOR ADDISON USE ONLY
 Permit Number: W-1108
 Location: 3901 Beltway

APPLICATION

Right of Way Work Permit -FRANCHISE

(For Franchise Utility/CTP - Street Cut/Excavation/Lane Closure)

PLEASE PRINT LEGIBLY

Date of Application: 4/5/2017

Facility Owner Company: Time Warner Cable / Spectrum Company Phone #: 214-394-4281
 Utility/CTP Representative: Kevin Causey Cell Phone #: 214-394-4281
 Utility/CTP Representative E-Mail: kevin.causey@charter.com

General Contractor: TCS Communications LLC Company Phone #: 817-864-9337
 Site Supervisor Name: Stephen Smith 24-hour phone #: 214-601-7722
 Contractor E-Mail address: stephen.smith@tcscomm.com Site Foreman E-Mail: stephen.smith@tcscomm.com

Work Site Address and Location: 3901 Beltway dr
 Purpose and general description of work: place pipe underground
 Proposed Start Work Date: 4/18/2017 Estimated Completion Date: 7/18/2017

Pavement Cut? Yes No Directional Bore/Boring? Yes No
 Excavation? Yes No Lane Closure? Yes No Other: _____? Yes No

Stephen Smith [Signature] Supervisor of Construction Services
 Applicant's Printed Name Signature Position with Company

Applicant's Email: Stephen.smith@tcscomm.com Applicant's Phone Number: 214-601-7722
Michael Escollies 505-850-4737 TCS Communications LLC
 Direct Supervisor's Printed Name Phone Number Company Name
 Supervisor's E-Mail: michael.escollies@tcscomm.com

FOR ADDISON USE ONLY

Received By: Nicole Simpson Entered? Yes No Received Date: 4-18-17
 Approved By: [Signature] Inspector: JS/CH/MKR Issue Date: 4/21/17
 Plans Submitted? Yes No N/A Traffic Control Plan Submitted? Yes No N/A Expiration Date: 5/5/17
 Insurance Provided? Yes No On File Performance/Maintenance Bond? Yes No On File N/A
 Fee Paid: NA Receipt#: CTP Date: 4-21-17 Processed By: Nicole S.
 Picked Up By: Mike Company: TCS Date & Time: 4-21-17

10:38AM

TOWN OF ADDISON INFRASTRUCTURE AND DEVELOPMENT SERVICES
 DEPARTMENT ATTN.: RIGHT OF WAY PERMIT - DAVE WILDE 972-450-2847
 16801 WESTGROVE RD. ADDISON, TX 75001-9010
 PHONE: 972-450-2871 FAX: 972-450-2837



FOR ADDISON USE ONLY

Permit Number: W-408

Location: 3901 Beltway

APPLICATION

Right of Way Work Permit -FRANCHISE

(For Franchise Utility/CTP - Street Cut/Excavation/Lane Closure)

Sub-Contractor List

PLEASE PRINT LEGIBLY

General Contractor's Name: TCS Communications LLC General Contractor's Phone #: 817-864-9337

Sub-Contractor #1 Company Name: _____ Address: _____

Print Sub-Contractor's Name: _____ Sub-Contractor's Phone #: _____

Sub-Contractor's E-Mail: _____

Print Site Supervisor's Name: _____ Supervisor's Phone #: _____

Site Supervisor's E-Mail: _____

Insurance Provided? Yes No On File

Sub-Contractor #2 Company Name: _____ Address: _____

Print Sub-Contractor's Name: _____ Sub-Contractor's Phone #: _____

Sub-Contractor's E-Mail: _____

Print Supervisor's Name: _____ Supervisor's Phone #: _____

Site Supervisor's E-Mail: _____

Insurance Provided? Yes No On File

Sub-Contractor #3 Company Name: _____ Address: _____

Print Sub-Contractor's Name: _____ Sub-Contractor's Phone #: _____

Sub-Contractor's E-Mail: _____

Print Supervisor's Name: _____ Supervisor's Phone #: _____

Site Supervisor's E-Mail: _____

Insurance Provided? Yes No On File



TIME WARNER C A B L E

LES LACS PARK
3901 BELTWAY DR
ADDISON, TEXAS

VICINITY MAP

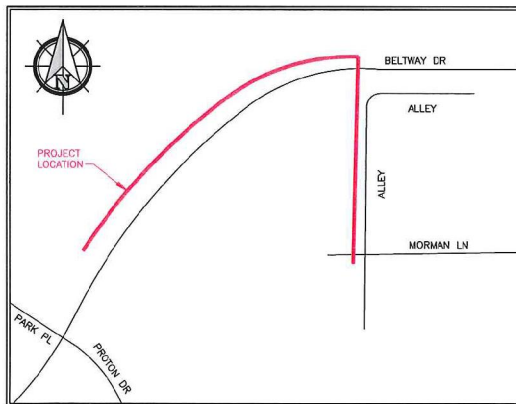

GENERAL PROJECT NOTES

1. ALL CONSTRUCTION WORK WITHIN THE PUBLIC RIGHT-OF-WAY SHALL BE DONE IN ACCORDANCE WITH THE ORDINANCES AND REGULATIONS OF THE MUNICIPALITY IN WHICH THE WORK IS TO BE PERFORMED.
2. EXISTING UTILITY LOCATIONS SHOWN ARE TAKEN FROM AVAILABLE RECORDS AND MAY NOT BE ALL INCLUSIVE. UTILITY LOCATIONS ARE GENERALLY SCHEMATIC IN NATURE AND MAY NOT ACCURATELY REFLECT THE SIZE AND LOCATION OF EACH PARTICULAR UTILITY. THE CONSTRUCTION CONTRACTOR SHALL ASSUME RESPONSIBILITY FOR ACTUAL LINE LOCATES IN THE FIELD AND THE PROTECTION OF ALL EXISTING FACILITIES WHETHER SHOWN OR NOT. THE CONSTRUCTION CONTRACTOR SHALL ALSO ASSUME RESPONSIBILITY FOR REPAIRS TO ANY EXISTING FACILITY DAMAGED AS A DIRECT RESULT OF THE CONSTRUCTION ACTIVITIES WHETHER THE FACILITY IS SHOWN ON THE DRAWINGS OR NOT.
3. THE CONSTRUCTION CONTRACTOR SHALL BE RESPONSIBLE FOR CONTACTING ALL DEPARTMENTS WITHIN THE MUNICIPALITY AND THE UTILITY COMPANIES AT LEAST TWO WORKING DAYS PRIOR TO THE COMMENCEMENT OF WORK.

CALL BEFORE YOU DIG
811

IT'S THE LAW

4. IT SHALL BE THE RESPONSIBILITY OF THE CONSTRUCTION CONTRACTOR TO: A) PREVENT DAMAGE TO PRIVATE AND PUBLIC PROPERTY. B) RESTORE ALL AREAS EFFECTED BY THE CONSTRUCTION TO ORIGINAL OR BETTER CONDITION.
5. BARRICADING AND TRAFFIC CONTROL SHALL BE THE RESPONSIBILITY OF THE CONSTRUCTION CONTRACTOR AND SHALL CONFORM TO THE "TEXAS MANUAL ON UNIFORM TRAFFIC CONTROL DEVICES". TRAFFIC FLOW AND ACCESS SHALL BE MAINTAINED DURING ALL PHASES OF CONSTRUCTION. THE CONSTRUCTION CONTRACTOR IS RESPONSIBLE FOR PROVIDING TRAFFIC SAFETY MEASURES FOR WORK ON THE PROJECT. THE WORK SITE SHALL BE SUITABLY LIT AND BARRICADED AT NIGHT.
6. THE CONSTRUCTION CONTRACTOR SHALL ABIDE BY ALL APPLICABLE FEDERAL, STATE AND LOCAL LAWS GOVERNING EXCAVATION. THE CONSTRUCTION CONTRACTOR SHALL PROVIDE ALL TRENCH SAFETY SYSTEMS THAT COMPLY WITH ALL LAWS GOVERNING EXCAVATION. THE CONSTRUCTION CONTRACTOR SHALL BE SOLELY RESPONSIBLE FOR ALL ASPECTS OF WORK RELATED TO EXCAVATION.
7. ALL CONCRETE USED IN ANY ROADWAY SHALL BE IN COMPLIANCE WITH THE SPECIFIED CLASSES OF CONCRETE IN THE STANDARD SPECIFICATIONS 5.8 "PORTLAND CEMENT CONCRETE PAVEMENT" AND 7.4.5 "QUALITY OF CONCRETE" AS AMENDED BY THE ADDENDUM TO THE NORTH CENTRAL TEXAS STANDARD SPECIFICATIONS FOR PUBLIC WORKS CONSTRUCTION - 2004. ALL OTHER CONCRETE SHALL BE CLASS A CONCRETE.
8. ALL REINFORCING STEEL AND DOWEL BARS IN PAVEMENT SHALL BE SUPPORTED AND MAINTAINED AT THE CORRECT CLEARANCES BY THE USE OF BAR CHAINS OR OTHER APPROVED SUPPORT.
9. ALL CONDUIT MUST BE PLACED WITH A MINIMUM 42" OF COVER, UNLESS OTHERWISE SPECIFIED.
10. ALL BACKFILLING WILL BE MECHANICALLY TAMPED IN LIFTS TO A DENSITY OF 95% PROCTOR. THE REQUIRED DENSITY WILL BE OBTAINED BY USING TAMPERS, RAMMERS OR ROLLING EQUIPMENT. LIFTS MAY VARY ACCORDING TO THE TYPE OF EQUIPMENT USED TO OBTAIN THE REQUIRED DENSITY. SAND AND DEBRIS FREE MATERIAL WILL BE USED FOR BACKFILL.

DFWT CONTACT: [DAVID HATTON 972.670.2113](mailto:DAVID.HATTON@DFWTELECOM.COM)

PREPARED BY: [DFW TELECOM, INC.](http://DFWTELECOM.COM)

LEGEND

	PROPOSED CONDUIT
	BORE UNDER CONCRETE
	EXISTING CONDUIT
	EXISTING CUSTOMER CONDUIT
	OVERHEAD: NEW BUILD
	OVERHEAD: OVERLASH

MATCH LINE - SEE SHEET 2

TRENCH DETAIL
NOT TO SCALE

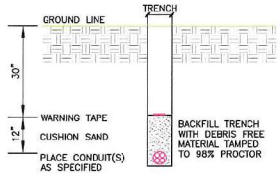

TYPICAL UTILITY CROSSING

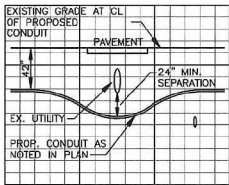

PREPARED BY:



DFWT CONTACT:
DAVID HATTON 972.670.2113

ESTIMATED SHEET TOTALS

DESCRIPTION	QUANTITY	DESCRIPTION	QUANTITY
TRENCH & PLACE CONDUIT	339'	PLACE FLUSH MOUNT VAULT	
BORE & PLACE CONDUIT	46'	PLACE PEDESTAL	1
BORE & PLACE STEEL CASING		PLACE FLUSH DROP BUCKET	
PULL THROUGH EXISTING CONDUIT		PLACE POWER SUPPLY	
R & R CONCRETE SIDEWALK (SF)		PLACE WALL BOX & RISER	
R & R CONCRETE PAVEMENT (SF)		PLACE U-GUARD RISER	
OVERHEAD: OVERLASH		OVERHEAD: NEW BUILD	

NORTH



SHEET
1 OF 3

PROJECT: LES LACS PARK

ADDRESS: 3901 BELTWAY DR
CITY, STATE: ADDISON, TEXAS

HORIZONTAL SCALE 1" = 40'	VERTICAL SCALE 1" = 10'	JOB NUMBER: 1510696	DATE: 12/01/2016
------------------------------	----------------------------	------------------------	---------------------



LEGEND	
	PROPOSED CONDUIT
	BORE UNDER CONCRETE
	EXISTING CONDUIT
	EXISTING CUSTOMER CONDUIT
	OVERHEAD: NEW BUILD
	OVERHEAD: OVERLASH

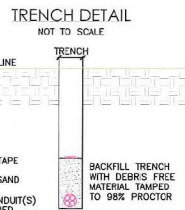

TYPICAL UTILITY CROSSING

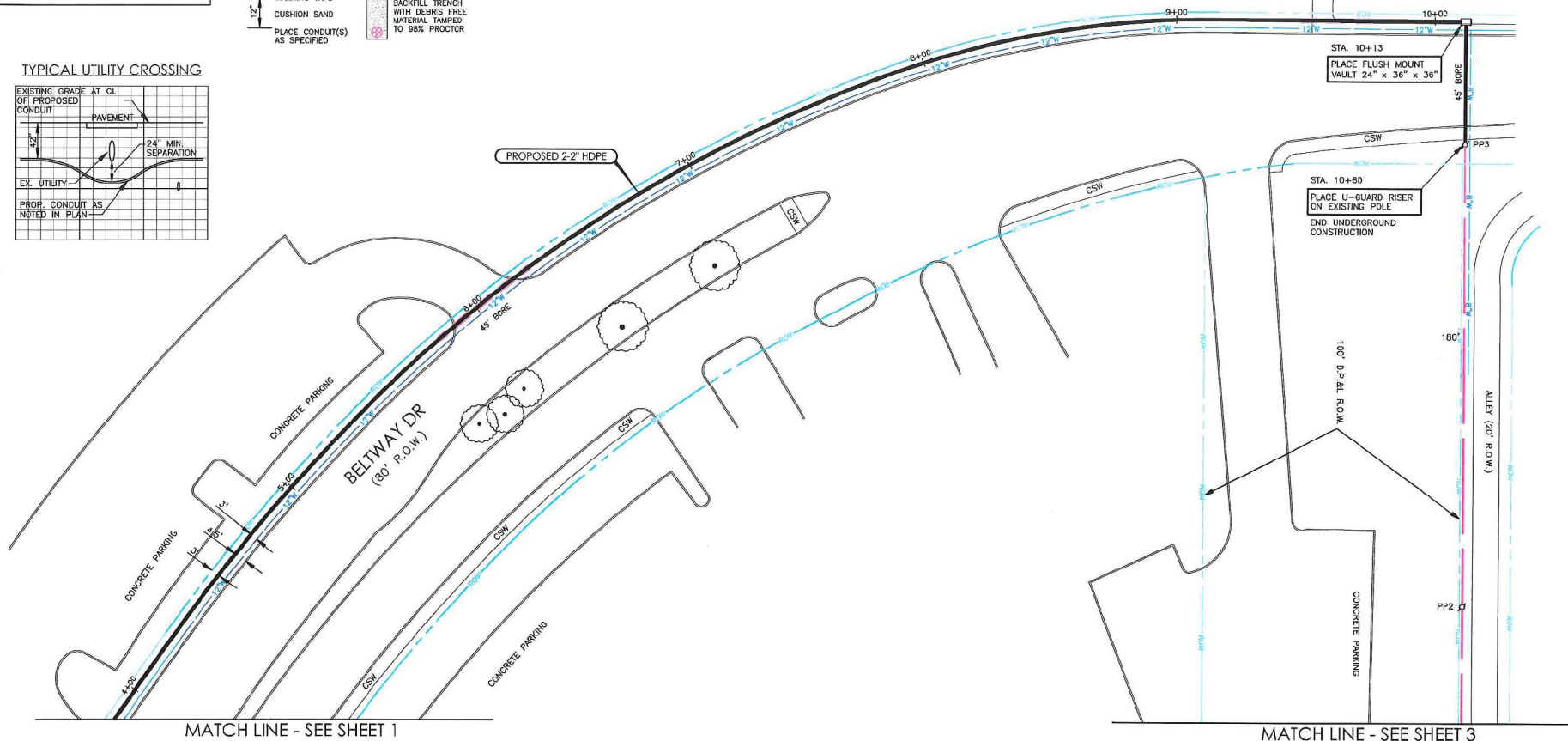
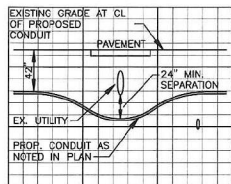

PREPARED BY:



DFWT CONTACT:
DAVID HATTON 972.670.2113

ESTIMATED SHEET TOTALS

DESCRIPTION	QUANTITY	DESCRIPTION	QUANTITY
TRENCH & PLACE CONDUIT	585'	PLACE FLUSH MOUNT VAULT	1
BORE & PLACE CONDUIT	90'	PLACE PEDESTAL	
BORE & PLACE STEEL CASING		PLACE FLUSH DROP BUCKET	
PULL THROUGH EXISTING CONDUIT		PLACE POWER SUPPLY	
R & R CONCRETE SIDEWALK (SF)		PLACE WALL BOX & RISER	
R & R CONCRETE PAVEMENT (SF)		PLACE U-GUARD RISER	1
OVERHEAD: OVERLASH	180'	OVERHEAD: NEW BUILD	

NORTH



SHEET
2 OF 3

PROJECT: LES LACS PARK

ADDRESS: 3901 BELTWAY DR
CITY, STATE: ADDISON, TEXAS

HORIZONTAL SCALE
1" = 40'

VERTICAL SCALE
1" = 10'

JOB NUMBER:
1510696

DATE:
12/01/2016



MATCH LINE - SEE SHEET 2

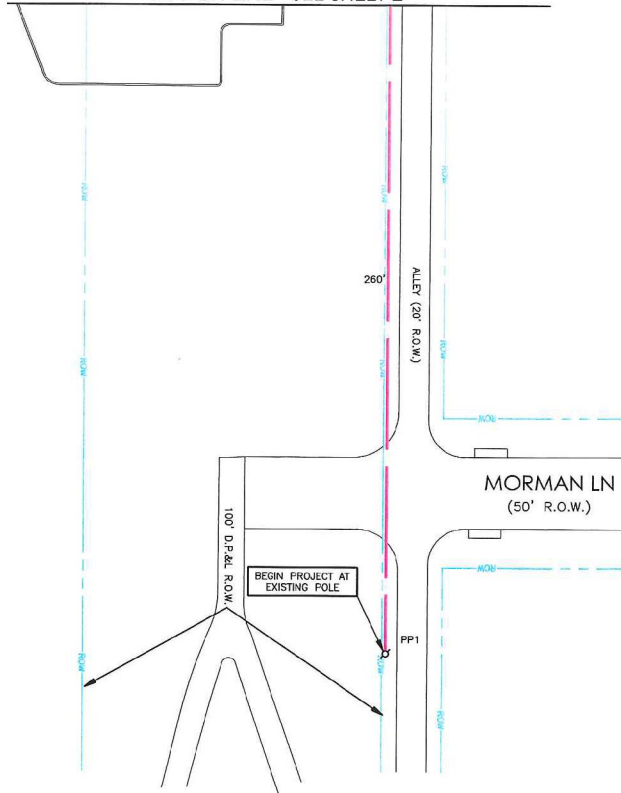

LEGEND

	PROPOSED CONDUIT
	BORE UNDER CONCRETE
	EXISTING CONDUIT
	EXISTING CUSTOMER CONDUIT
	OVERHEAD: NEW BUILD
	OVERHEAD: OVERLASH

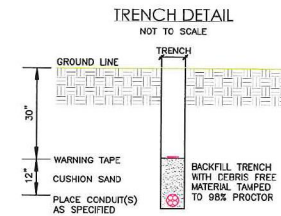
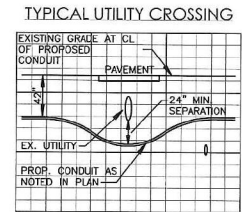

PREPARED BY:



DFWT CONTACT:
DAVID HATTON 972.670.2113

ESTIMATED SHEET TOTALS

DESCRIPTION	QUANTITY	DESCRIPTION	QUANTITY
TRENCH & PLACE CONDUIT		PLACE FLUSH MOUNT VAULT	
BORE & PLACE CONDUIT		PLACE PEDESTAL	
BORE & PLACE STEEL CASING		PLACE FLUSH DROP BUCKET	
PULL THROUGH EXISTING CONDUIT		PLACE POWER SUPPLY	
R & R CONCRETE SIDEWALK (SF)		PLACE WALL BOX & RISER	
R & R CONCRETE PAVEMENT (SF)		PLACE U-GUARD RISER	
OVERHEAD: OVERLASH	260'	OVERHEAD: NEW BUILD	



3 SHEET OF 3

PROJECT: LES LACS PARK

ADDRESS: 3901 BELTWAY DR
CITY, STATE: ADDISON, TEXAS

HORIZONTAL SCALE
1" = 40'

VERTICAL SCALE
1" = 10'

JOB NUMBER:
1510696

DATE:
12/01/2016

