



FOR ADDISON USE ONLY
 Permit Number: W1105
 Location: 15050 Beltwood Pkwy

APPLICATION

Right of Way Work Permit -FRANCHISE

(For Franchise Utility/CTP - Street Cut/Excavation/Lane Closure)

PLEASE PRINT LEGIBLY

Date of Application: 4/5/2017

Facility Owner Company: Time Warner Cable / Spectrum Company Phone #: 214-394-4281
 Utility/CTP Representative: Kevin Causey Cell Phone #: 214-394-4281
 Utility/CTP Representative E-Mail: kevin.causey@charter.com

General Contractor: TCS Communications LLC Company Phone #: 817-864-9337
 Site Supervisor Name: Stephen Smith 24-hour phone #: 214-601-7722
 Contractor E-Mail address: stephen.smith@tcscomm.com Site Foreman E-Mail: stephen.smith@tcscomm.com

Work Site Address and Location: 15050 E Beltwood Pkwy
 Purpose and general description of work: 401' New Underground, 30' pull through existing
 Proposed Start Work Date: 4/10/2017 04/12/17 Estimated Completion Date: 7/10/2017

Pavement Cut? Yes No Directional Bore/Boring? Yes No
 Excavation? Yes No Lane Closure? Yes No Other: _____ ? Yes No

Stephen Smith Stephen Smith Supervisor of Construction Services
 Applicant's Printed Name Signature Position with Company

Applicant's Email: Stephen.smith@tcscomm.com Applicant's Phone Number: 214-601-7722
Michael Escollies 505-850-4737 TCS Communications LLC
 Direct Supervisor's Printed Name Phone Number Company Name
 Supervisor's E-Mail: michael.escollies@tcscomm.com

FOR ADDISON USE ONLY

Received By: ? Entered? Yes Received Date: 4/11/17 DEW from at. DA's station
 Approved By: Dave Wilde Inspector: JE Issue Date: 4/12/17
 Plans Submitted? Yes No N/A Traffic Control Plan Submitted? Yes No N/A Expiration Date: 4/25/17
 Insurance Provided? Yes No On File Performance/Maintenance Bond? Yes No On File N/A
 Fee Paid: _____ Receipt#: _____ Date: _____ Processed By: _____
 Picked Up By: Stephen Smith Company: TCS Comm Date & Time: 4-12-17 12:30

TOWN OF ADDISON INFRASTRUCTURE AND DEVELOPMENT SERVICES
 DEPARTMENT ATTN.: RIGHT OF WAY PERMIT - DAVE WILDE 972-450-2847
 16801 WESTGROVE RD. ADDISON, TX 75001-9010
 PHONE: 972-450-2871 FAX: 972-450-2837



FOR ADDISON USE ONLY

Permit Number: W1105

Location: 15050 Beltway Hwy

APPLICATION
Right of Way Work Permit -FRANCHISE
 (For Franchise Utility/CTP - Street Cut/Excavation/Lane Closure)

Sub-Contractor List

PLEASE PRINT LEGIBLY

General Contractor's Name: TCS Communications LLC **General Contractor's Phone #:** 817-864-9337

Sub-Contractor #1 Company Name: L&J Underground **Address:** 2334 Mocking bird Ln, Garland TX 75040

Print Sub-Contractor's Name: James Juarez **Sub-Contractor's Phone #:** 214-336-5348

Sub-Contractor's E-Mail: junderservices@gmail.com

Print Site Supervisor's Name: Luis Juarez **Supervisor's Phone #:** _____

Site Supervisor's E-Mail: junderservices@gmail.com

Insurance Provided? Yes No On File

Sub-Contractor #2 Company Name: _____ **Address:** _____

Print Sub-Contractor's Name: _____ **Sub-Contractor's Phone #:** _____

Sub-Contractor's E-Mail: _____

Print Supervisor's Name: _____ **Supervisor's Phone #:** _____

Site Supervisor's E-Mail: _____

Insurance Provided? Yes No On File

Sub-Contractor #3 Company Name: _____ **Address:** _____

Print Sub-Contractor's Name: _____ **Sub-Contractor's Phone #:** _____

Sub-Contractor's E-Mail: _____

Print Supervisor's Name: _____ **Supervisor's Phone #:** _____

Site Supervisor's E-Mail: _____

Insurance Provided? Yes No On File

Spectrum

TRONIC MEMS, INC.
15050 E. BELTWOOD PKWY.
ADDISON, TEXAS

VICINITY MAP

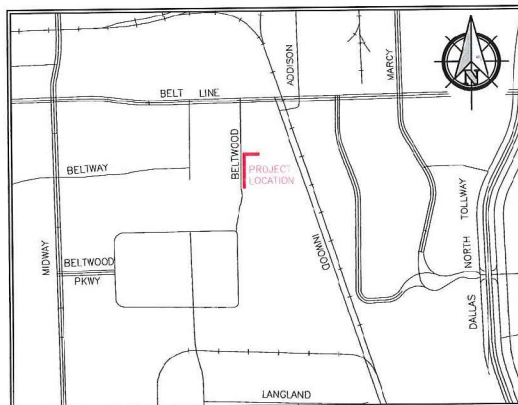

GENERAL PROJECT NOTES

1. ALL CONSTRUCTION WORK WITHIN THE PUBLIC RIGHT-OF-WAY SHALL BE DONE IN ACCORDANCE WITH THE ORDINANCES AND REGULATIONS OF THE MUNICIPALITY IN WHICH THE WORK IS TO BE PERFORMED.
2. EXISTING UTILITY LOCATIONS SHOWN ARE TAKEN FROM AVAILABLE RECORDS AND MAY NOT BE ALL INCLUSIVE. UTILITY LOCATIONS ARE GENERALLY SCHEMATIC IN NATURE AND MAY NOT ACCURATELY REFLECT THE SIZE AND LOCATION OF EACH PARTICULAR UTILITY. THE CONSTRUCTION CONTRACTOR SHALL ASSUME RESPONSIBILITY FOR ACTUAL LINE LOCATES IN THE FIELD AND THE PROTECTION OF ALL EXISTING FACILITIES WHETHER SHOWN OR NOT. THE CONSTRUCTION CONTRACTOR SHALL ALSO ASSUME RESPONSIBILITY FOR REPAIRS TO ANY EXISTING FACILITY DAMAGED AS A DIRECT RESULT OF THE CONSTRUCTION ACTIVITIES WHETHER THE FACILITY IS SHOWN ON THE DRAWINGS OR NOT.
3. THE CONSTRUCTION CONTRACTOR SHALL BE RESPONSIBLE FOR CONTACTING ALL DEPARTMENTS WITHIN THE MUNICIPALITY AND THE UTILITY COMPANIES AT LEAST TWO WORKING DAYS PRIOR TO THE COMMENCEMENT OF WORK.

CALL BEFORE YOU DIG

811

IT'S THE LAW

4. IT SHALL BE THE RESPONSIBILITY OF THE CONSTRUCTION CONTRACTOR TO: A) PREVENT DAMAGE TO PRIVATE AND PUBLIC PROPERTY. B) RESTORE ALL AREAS EFFECTED BY THE CONSTRUCTION TO ORIGINAL OR BETTER CONDITION.
5. BARRICADING AND TRAFFIC CONTROL SHALL BE THE RESPONSIBILITY OF THE CONSTRUCTION CONTRACTOR AND SHALL CONFORM TO THE "TEXAS MANUAL ON UNIFORM TRAFFIC CONTROL DEVICES". TRAFFIC FLOW AND ACCESS SHALL BE MAINTAINED DURING ALL PHASES OF CONSTRUCTION. THE CONSTRUCTION CONTRACTOR IS RESPONSIBLE FOR PROVIDING TRAFFIC SAFETY MEASURES FOR WORK ON THE PROJECT. THE WORK SITE SHALL BE SUITABLY LIT AND BARRICADED AT NIGHT.
6. THE CONSTRUCTION CONTRACTOR SHALL ABIDE BY ALL APPLICABLE FEDERAL, STATE AND LOCAL LAWS GOVERNING EXCAVATION. THE CONSTRUCTION CONTRACTOR SHALL PROVIDE ALL TRENCH SAFETY SYSTEMS THAT COMPLY WITH ALL LAWS GOVERNING EXCAVATION. THE CONSTRUCTION CONTRACTOR SHALL BE SOLELY RESPONSIBLE FOR ALL ASPECTS OF WORK RELATED TO EXCAVATION.
7. ALL CONCRETE USED IN ANY ROADWAY SHALL BE IN COMPLIANCE WITH THE SPECIFIED CLASSES OF CONCRETE IN THE STANDARD SPECIFICATIONS 5.8 "PORTLAND CEMENT CONCRETE PAVEMENT" AND 7.4.5 "QUALITY OF CONCRETE" AS AMENDED BY THE ADDENDUM TO THE NORTH-CENTRAL TEXAS STANDARD SPECIFICATIONS FOR PUBLIC WORKS CONSTRUCTION - 2004. ALL OTHER CONCRETE SHALL BE CLASS A CONCRETE.
8. ALL REINFORCING STEEL AND DOWEL BARS IN PAVEMENT SHALL BE SUPPORTED AND MAINTAINED AT THE CORRECT CLEARANCES BY THE USE OF BAR CHAINS OR OTHER APPROVED SUPPORT.
9. ALL CONDUIT MUST BE PLACED WITH A MINIMUM 42" OF COVER, UNLESS OTHERWISE SPECIFIED.
10. ALL BACKFILLING WILL BE MECHANICALLY TAMPED IN LIFTS TO A DENSITY OF 95% PROCTOR. THE REQUIRED DENSITY WILL BE OBTAINED BY USING TAMPERS, RAMMERS OR ROLLING EQUIPMENT. LIFTS MAY VARY ACCORDING TO THE TYPE OF EQUIPMENT USED TO OBTAIN THE REQUIRED DENSITY. SAND AND DEBRIS FREE MATERIAL WILL BE USED FOR BACKFILL.

DFWT CONTACT: DAVID HATTON 972.670.2113

PREPARED BY: DFW TELECOM, INC.

LEGEND

UG	PROPOSED CONDUIT
XX' BORE	BORE UNDER CONCRETE
---	EXISTING CONDUIT
---	EXISTING CUSTOMER CONDUIT
PP XX' PP	OVERHEAD: NEW BUILD
PP XX' PP	OVERHEAD: OVERLASH

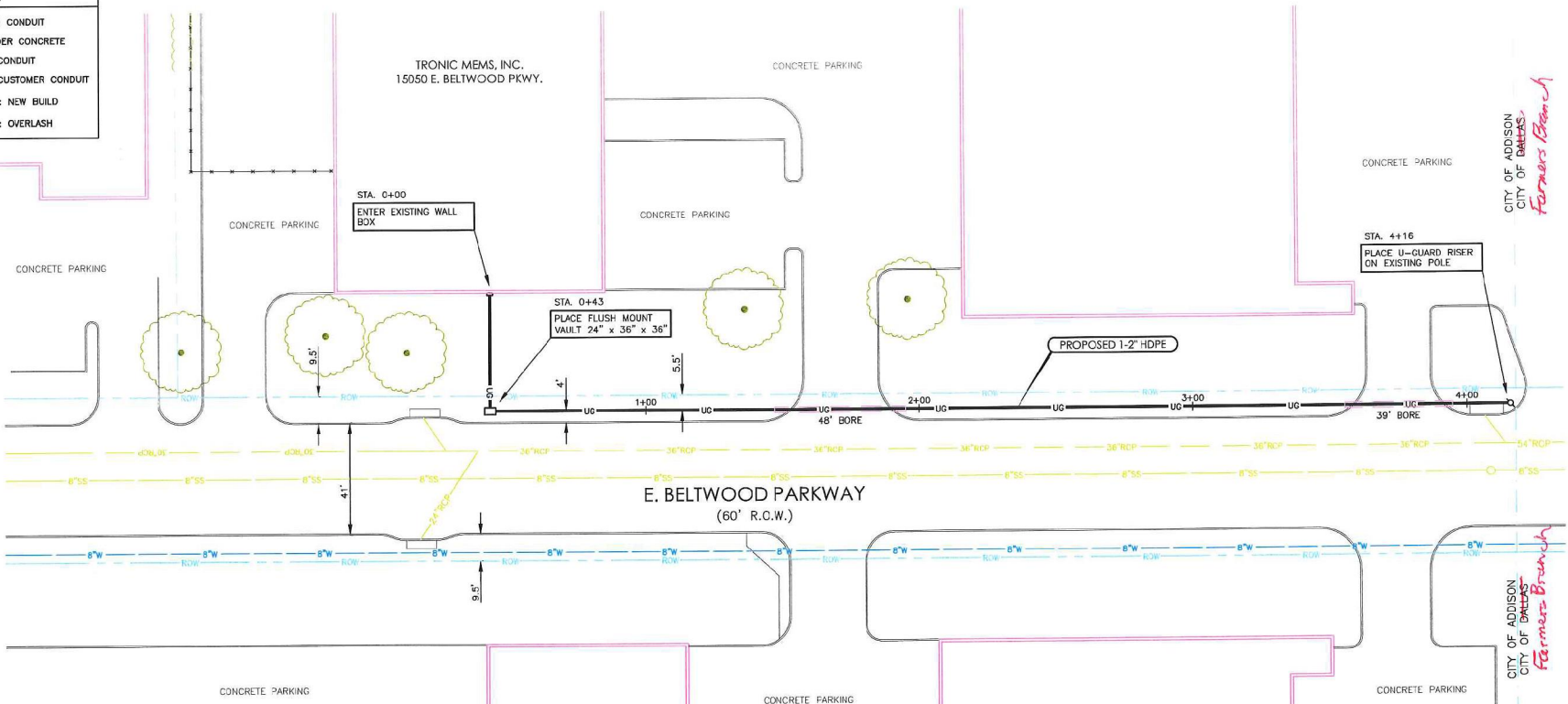

CITY OF ADDISON
CITY OF DREWS
Farmers Branch

CITY OF ADDISON
CITY OF DREWS
Farmers Branch

TRENCH DETAIL
NOT TO SCALE

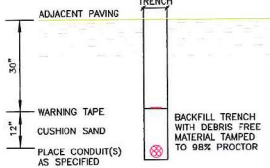

TYPICAL UTILITY CROSSING

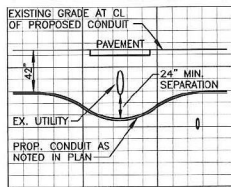

PREPARED BY:
DFW TELECOM
DFWT CONTACT:
DAVID HATTON 972.670.2113

ESTIMATED SHEET TOTALS

DESCRIPTION	QUANTITY	DESCRIPTION	QUANTITY
TRENCH & PLACE CONDUIT	329'	PLACE FLUSH MOUNT VAULT	1
BORE & PLACE CONDUIT	87'	PLACE PEDESTAL	
BORE & PLACE STEEL CASING		PLACE FLUSH DROP BUCKET	
PULL THROUGH EXISTING CONDUIT		PLACE POWER SUPPLY	
R & R CONCRETE SIDEWALK (SF)		PLACE WALL BOX & RISER	
R & R CONCRETE PAVEMENT (SF)		PLACE U-GUARD RISER	1
OVERHEAD: OVERLASH		OVERHEAD: NEW BUILD	

NORTH

SHEET
1 OF 1

PROJECT: **TRONIC MEMS, INC.**
ADDRESS: 15050 E. BELTWOOD PARKWAY
CITY, STATE: ADDISON, TEXAS
HORIZONTAL SCALE: 1" = 40'
VERTICAL SCALE: 1" = 10'
JOB NUMBER: DID-1432109
DATE: 03-30-2017

