



FOR ADDISON USE ONLY
 Permit Number: W-1135
 Location: 5501 Celestial

APPLICATION

Right of Way Work Permit -FRANCHISE

(For Franchise Utility/CTP - Street Cut/Excavation/Lane Closure)

PLEASE PRINT LEGIBLY

Date of Application: 5/11/2017

Facility Owner Company: Time Warner Cable / Spectrum Company Phone #: 214-394-4281

Utility/CTP Representative: Doug England Cell Phone #: 817-905-3097

Utility/CTP Representative E-Mail: doug.english@charter.com

General Contractor: TCS Communications LLC Company Phone #: 817-864-9337

Site Supervisor Name: Stephen Smith 24-hour phone #: 214-601-7722

Contractor E-Mail address: stephen.smith@tcscomm.com Site Foreman E-Mail: stephen.smith@tcscomm.com

Work Site Address and Location: 5501 Celestial Rd 1381192

Purpose and general description of work: 365' new underground

Proposed Start Work Date: 5/11/2017 Estimated Completion Date: 8/11/2017

Pavement Cut? Yes No Directional Bore/Boring? Yes No

Excavation? Yes No Lane Closure? Yes No Other: _____ ? Yes No

Stephen Smith Signature Supervisor of Construction Services
 Applicant's Printed Name Position with Company

Applicant's Email: Stephen.smith@tcscomm.com Applicant's Phone Number: 214-601-7722

Michael Escollies 505-850-4737 TCS Communications LLC
 Direct Supervisor's Printed Name Phone Number Company Name

Supervisor's E-Mail: michael.escollies@tcscomm.com

FOR ADDISON USE ONLY

Received By: Nicole S. Entered? Yes No Received Date: 5-11-17

Approved By: Dave Wilde Inspector: JJ/MKH/RL Issue Date: 5/11/17

Plans Submitted? Yes No N/A Traffic Control Plan Submitted? Yes No N/A Expiration Date: 5/30/17

Insurance Provided? Yes No On File Performance/Maintenance Bond? Yes No On File N/A

Fee Paid: NA Receipt#: CTP Date: 5-11-17 Processed By: Nicole S.

Picked Up By: Stephen Company: TCS Date & Time: 11:52 AM

TOWN OF ADDISON INFRASTRUCTURE AND DEVELOPMENT SERVICES
 DEPARTMENT ATTN.: RIGHT OF WAY PERMIT - DAVE WILDE 972-450-2847
 16801 WESTGROVE RD. ADDISON, TX 75001-9010
 PHONE: 972-450-2871 FAX: 972-450-2837



FOR ADDISON USE ONLY
Permit Number: <u>W-1135</u>
Location: <u>5501 Celestial</u>

APPLICATION

Right of Way Work Permit -FRANCHISE

(For Franchise Utility/CTP - Street Cut/Excavation/Lane Closure)

Sub-Contractor List

PLEASE PRINT LEGIBLY

General Contractor's Name: TCS Communications LLC General Contractor's Phone #: 817-864-9337

Sub-Contractor #1 Company Name: _____ Address: _____

Print Sub-Contractor's Name: _____ Sub-Contractor's Phone #: _____

Sub-Contractor's E-Mail: _____

Print Site Supervisor's Name: _____ Supervisor's Phone #: _____

Site Supervisor's E-Mail: _____

Insurance Provided? Yes No On File

Sub-Contractor #2 Company Name: _____ Address: _____

Print Sub-Contractor's Name: _____ Sub-Contractor's Phone #: _____

Sub-Contractor's E-Mail: _____

Print Supervisor's Name: _____ Supervisor's Phone #: _____

Site Supervisor's E-Mail: _____

Insurance Provided? Yes No On File

Sub-Contractor #3 Company Name: _____ Address: _____

Print Sub-Contractor's Name: _____ Sub-Contractor's Phone #: _____

Sub-Contractor's E-Mail: _____

Print Supervisor's Name: _____ Supervisor's Phone #: _____

Site Supervisor's E-Mail: _____

Insurance Provided? Yes No On File



FOR ADDISON USE ONLY
Permit Number: <u>W-1135</u>
Location: <u>5501 Celestial</u>

APPLICATION

Right of Way Work Permit -FRANCHISE

(For Franchise Utility/CTP - Street Cut/Excavation/Lane Closure)

Sub-Contractor List

PLEASE PRINT LEGIBLY

General Contractor's Name: TCS Communications LLC General Contractor's Phone #: 817-864-9337

Sub-Contractor #1 Company Name: _____ Address: _____

Print Sub-Contractor's Name: _____ Sub-Contractor's Phone #: _____

Sub-Contractor's E-Mail: _____

Print Site Supervisor's Name: _____ Supervisor's Phone #: _____

Site Supervisor's E-Mail: _____

Insurance Provided? Yes No On File

Sub-Contractor #2 Company Name: _____ Address: _____

Print Sub-Contractor's Name: _____ Sub-Contractor's Phone #: _____

Sub-Contractor's E-Mail: _____

Print Supervisor's Name: _____ Supervisor's Phone #: _____

Site Supervisor's E-Mail: _____

Insurance Provided? Yes No On File

Sub-Contractor #3 Company Name: _____ Address: _____

Print Sub-Contractor's Name: _____ Sub-Contractor's Phone #: _____

Sub-Contractor's E-Mail: _____

Print Supervisor's Name: _____ Supervisor's Phone #: _____

Site Supervisor's E-Mail: _____

Insurance Provided? Yes No On File



FOR ADDISON USE ONLY	
Permit Number:	<u>W-1135</u>
Location:	<u>5501 Celestial</u>

APPLICATION

Right of Way Work Permit -FRANCHISE

(For Franchise Utility/CTP - Street Cut/Excavation/Lane Closure)

Sub-Contractor List

PLEASE PRINT LEGIBLY

General Contractor's Name: TCS Communications LLC General Contractor's Phone #: 817-864-9337

Sub-Contractor #1 Company Name: _____ Address: _____

Print Sub-Contractor's Name: _____ Sub-Contractor's Phone #: _____

Sub-Contractor's E-Mail: _____

Print Site Supervisor's Name: _____ Supervisor's Phone #: _____

Site Supervisor's E-Mail: _____

Insurance Provided? Yes No On File

Sub-Contractor #2 Company Name: _____ Address: _____

Print Sub-Contractor's Name: _____ Sub-Contractor's Phone #: _____

Sub-Contractor's E-Mail: _____

Print Supervisor's Name: _____ Supervisor's Phone #: _____

Site Supervisor's E-Mail: _____

Insurance Provided? Yes No On File

Sub-Contractor #3 Company Name: _____ Address: _____

Print Sub-Contractor's Name: _____ Sub-Contractor's Phone #: _____

Sub-Contractor's E-Mail: _____

Print Supervisor's Name: _____ Supervisor's Phone #: _____

Site Supervisor's E-Mail: _____

Insurance Provided? Yes No On File

Right-of-Way Permit Application Check List

(Street Cut/Excavation/Lane Closure-Revised 04/28/15)

Required
 Completed/Received

Today's Date: 5/16/17

Permit Number: W-1135

Company: TCS Comm

Applicant: Stephen Smith

Work Site Address: 550 Celestial

Receive from applicant the following information:

- Performance and Maintenance Bond
- Proof of Insurance
- Traffic Control Plan
- Other: _____

Payment:

- No fee, Franchise (Oncor or Atmos), Waived (work for Town) CTP
- Collect \$50.00 Application Fee
- Connection Fees \$ _____

Complete a receipt

- Write permit number on receipt
- Record receipt information on the application at the bottom of the page
- Make a copy of receipt

Complete the "Picked Up By" portion of the Application at the bottom of the page

Make 4 copies of Permit Application (Page 2 &-if used-Page 3). If both - single side to double-side.

Give to Customer:

- Receipt
- 1 copy of Permit Application - Pages 1-3
- Permit Placard (blue card)
- Other: _____

Give to Dave:

- | | |
|---|---|
| <input checked="" type="checkbox"/> Original Permit Application | <input type="checkbox"/> Bond |
| <input checked="" type="checkbox"/> <u>4</u> copies of Permit Application | <input type="checkbox"/> TCP |
| <input checked="" type="checkbox"/> Submitted plans (<u>2</u> copies) | <input type="checkbox"/> Proof of Insurance |
| <input type="checkbox"/> Copy of Permit Placard (blue card) | <input type="checkbox"/> Other: _____ |

Give to Alyssa:

- Payment (cash/check/money order/credit card)
- Copy of receipt

Other notes: _____

Completed by: _____ Date: _____



FOR ADDISON USE ONLY
 Permit Number: W-1135
 Location: 5501 Celestial

APPLICATION

Right of Way Work Permit -FRANCHISE

(For Franchise Utility/CTP - Street Cut/Excavation/Lane Closure)

PLEASE PRINT LEGIBLY

Date of Application: 5/11/2017

Facility Owner Company: Time Warner Cable / Spectrum Company Phone #: 214-394-4281
 Utility/CTP Representative: Doug England Cell Phone #: 817-905-3097
 Utility/CTP Representative E-Mail: doug.England@charter.com

General Contractor: TCS Communications LLC Company Phone #: 817-864-9337
 Site Supervisor Name: Stephen Smith 24-hour phone #: 214-601-7722

Contractor E-Mail address: stephen.smith@tcscomm.com Site Foreman E-Mail: stephen.smith@tcscomm.com

Work Site Address and Location: 5501 Celestial Rd 1381192
 Purpose and general description of work: 365' new underground

Proposed Start Work Date: 5/11/2017 Estimated Completion Date: 8/11/2017

Pavement Cut? Yes No Directional Bore/Boring? Yes No
 Excavation? Yes No Lane Closure? Yes No Other: _____ ? Yes No
Stephen Smith [Signature] Supervisor of Construction Services
 Applicant's Printed Name Signature Position with Company

Applicant's Email: Stephen.smith@tcscomm.com Applicant's Phone Number: 214-601-7722
Michael Escollies 505-850-4737 TCS Communications LLC
 Direct Supervisor's Printed Name Phone Number Company Name
 Supervisor's E-Mail: michael.escollies@tcscomm.com

FOR ADDISON USE ONLY

Received By: Micelle S. Entered? Yes Received Date: 5-11-17
 Approved By: [Signature] Inspector: JF/MK/CH/RL Issue Date: 5/16/17
 Plans Submitted? Yes No N/A Traffic Control Plan Submitted? Yes No N/A Expiration Date: 5/30/17
 Insurance Provided? Yes No On File Performance/Maintenance Bond? Yes No On File N/A
 Fee Paid: NA Receipt#: CTP Date: 5-17-17 Processed By: Micelle S.
 Picked Up By: Stephen Company: TCS Date & Time: 11:52 AM

TOWN OF ADDISON INFRASTRUCTURE AND DEVELOPMENT SERVICES
 DEPARTMENT ATTN.: RIGHT OF WAY PERMIT - DAVE WILDE 972-450-2847
 16801 WESTGROVE RD, ADDISON, TX 75001-9010
 PHONE: 972-450-2871 FAX: 972-450-2837

Spectrum

CELESTIAL PARK 5501 CELESTIAL RD ADDISON, TEXAS

VICINITY MAP

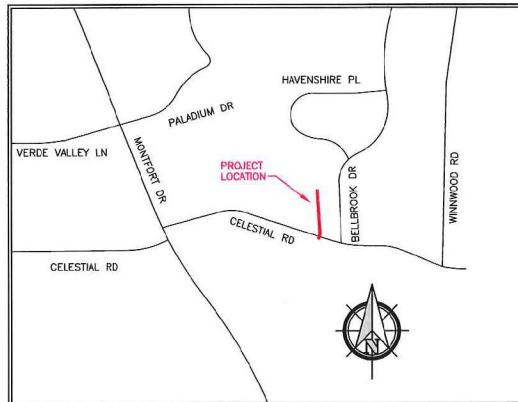

GENERAL PROJECT NOTES

1. ALL CONSTRUCTION WORK WITHIN THE PUBLIC RIGHT-OF-WAY SHALL BE DONE IN ACCORDANCE WITH THE ORDINANCES AND REGULATIONS OF THE MUNICIPALITY IN WHICH THE WORK IS TO BE PERFORMED.
2. EXISTING UTILITY LOCATIONS SHOWN ARE TAKEN FROM AVAILABLE RECORDS AND MAY NOT BE ALL INCLUSIVE. UTILITY LOCATIONS ARE GENERALLY SCHEMATIC IN NATURE AND MAY NOT ACCURATELY REFLECT THE SIZE AND LOCATION OF EACH PARTICULAR UTILITY. THE CONSTRUCTION CONTRACTOR SHALL ASSUME RESPONSIBILITY FOR ACTUAL LINE LOCATES IN THE FIELD AND THE PROTECTION OF ALL EXISTING FACILITIES WHETHER SHOWN OR NOT. THE CONSTRUCTION CONTRACTOR SHALL ALSO ASSUME RESPONSIBILITY FOR REPAIRS TO ANY EXISTING FACILITY DAMAGED AS A DIRECT RESULT OF THE CONSTRUCTION ACTIVITIES WHETHER THE FACILITY IS SHOWN ON THE DRAWINGS OR NOT.
3. THE CONSTRUCTION CONTRACTOR SHALL BE RESPONSIBLE FOR CONTACTING ALL DEPARTMENTS WITHIN THE MUNICIPALITY AND THE UTILITY COMPANIES AT LEAST TWO WORKING DAYS PRIOR TO THE COMMENCEMENT OF WORK.

CALL BEFORE YOU DIG

811

IT'S THE LAW

4. IT SHALL BE THE RESPONSIBILITY OF THE CONSTRUCTION CONTRACTOR TO: A) PREVENT DAMAGE TO PRIVATE AND PUBLIC PROPERTY. B) RESTORE ALL AREAS EFFECTED BY THE CONSTRUCTION TO ORIGINAL OR BETTER CONDITION.
5. BARRICADING AND TRAFFIC CONTROL SHALL BE THE RESPONSIBILITY OF THE CONSTRUCTION CONTRACTOR AND SHALL CONFORM TO THE "TEXAS MANUAL ON UNIFORM TRAFFIC CONTROL DEVICES". TRAFFIC FLOW AND ACCESS SHALL BE MAINTAINED DURING ALL PHASES OF CONSTRUCTION. THE CONSTRUCTION CONTRACTOR IS RESPONSIBLE FOR PROVIDING TRAFFIC SAFETY MEASURES FOR WORK ON THE PROJECT. THE WORK SITE SHALL BE SUITABLY LIT AND BARRICADED AT NIGHT.
6. THE CONSTRUCTION CONTRACTOR SHALL ABIDE BY ALL APPLICABLE FEDERAL, STATE AND LOCAL LAWS GOVERNING EXCAVATION. THE CONSTRUCTION CONTRACTOR SHALL PROVIDE ALL TRENCH SAFETY SYSTEMS THAT COMPLY WITH ALL LAWS GOVERNING EXCAVATION. THE CONSTRUCTION CONTRACTOR SHALL BE SOLELY RESPONSIBLE FOR ALL ASPECTS OF WORK RELATED TO EXCAVATION.
7. ALL CONCRETE USED IN ANY ROADWAY SHALL BE IN COMPLIANCE WITH THE SPECIFIED CLASSES OF CONCRETE IN THE STANDARD SPECIFICATIONS 5.8 "PORTLAND CEMENT CONCRETE PAVEMENT" AND 7.4.5 "QUALITY OF CONCRETE" AS AMENDED BY THE ADDENDUM TO THE NORTH CENTRAL TEXAS STANDARD SPECIFICATIONS FOR PUBLIC WORKS CONSTRUCTION - 2004. ALL OTHER CONCRETE SHALL BE CLASS A CONCRETE.
8. ALL REINFORCING STEEL AND DOWEL BARS IN PAVEMENT SHALL BE SUPPORTED AND MAINTAINED AT THE CORRECT CLEARANCES BY THE USE OF BAR CHAINS OR OTHER APPROVED SUPPORT.
9. ALL CONDUIT MUST BE PLACED WITH A MINIMUM 42" OF COVER, UNLESS OTHERWISE SPECIFIED.
10. ALL BACKFILLING WILL BE MECHANICALLY TAMPED IN LIFTS TO A DENSITY OF 95% PROCTOR. THE REQUIRED DENSITY WILL BE OBTAINED BY USING TAMPERS, RAMMERS OR ROLLING EQUIPMENT. LIFTS MAY VARY ACCORDING TO THE TYPE OF EQUIPMENT USED TO OBTAIN THE REQUIRED DENSITY. SAND AND DEBRIS FREE MATERIAL WILL BE USED FOR BACKFILL.

DFWT CONTACT: DAVID HATTON 972.670.2113

PREPARED BY: DFW TELECOM, INC.

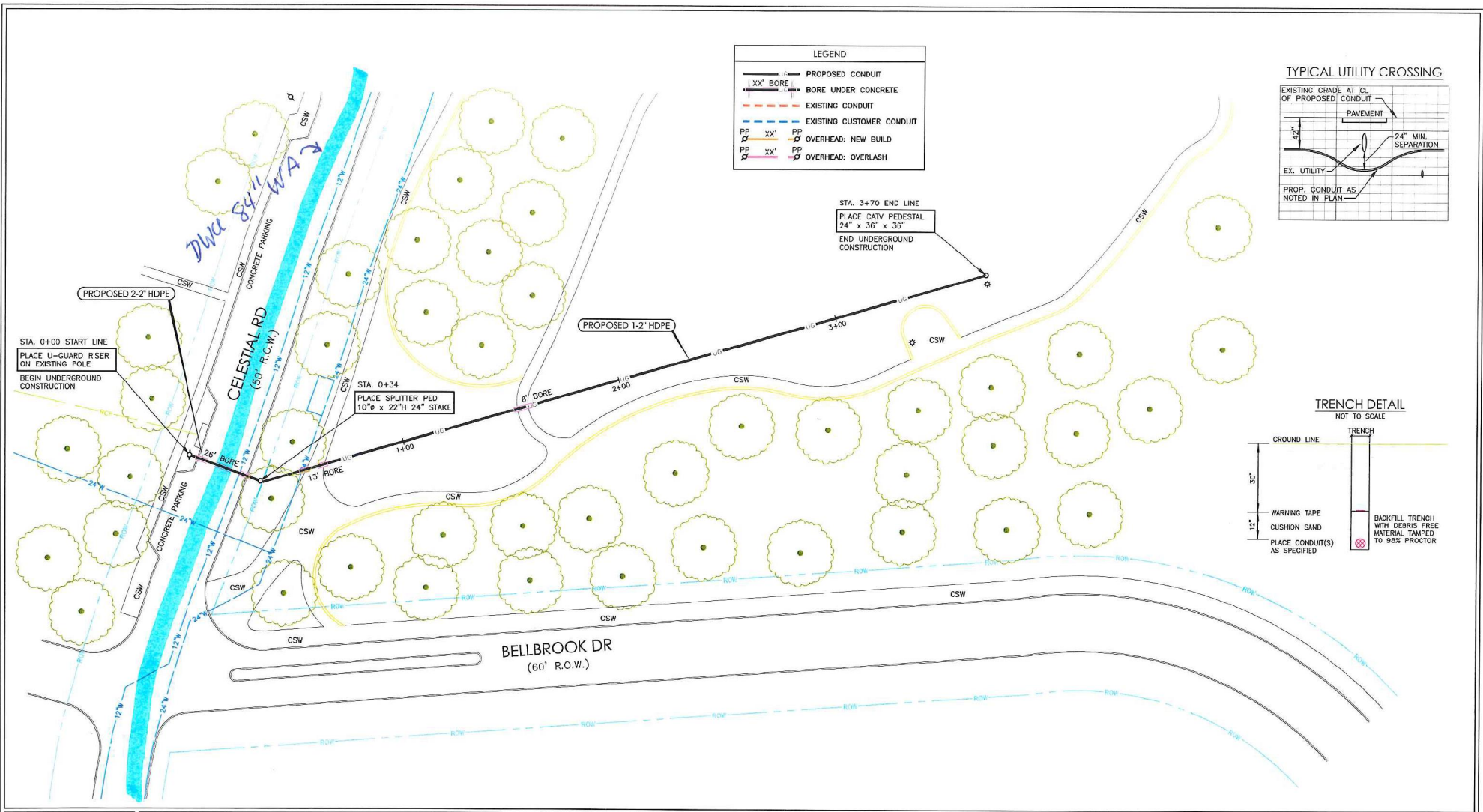

PREPARED BY:

DFWT CONTACT:
DAVID HATTON 972.670.2113

ESTIMATED SHEET TOTALS			
DESCRIPTION	QUANTITY	DESCRIPTION	QUANTITY
TRENCH & PLACE CONDUIT	323'	PLACE FLUSH MOUNT VAULT	
BORE & PLACE CONDUIT	47'	PLACE PEDESTAL	2
BORE & PLACE STEEL CASING		PLACE FLUSH DROP BUCKET	
PULL THROUGH EXISTING CONDUIT		PLACE POWER SUPPLY	
R & R CONCRETE SIDEWALK (SF)		PLACE WALL BOX & RISER	
R & R CONCRETE PAVEMENT (SF)		PLACE U-GUARD RISER	1
OVERHEAD: OVERLASH		OVERHEAD: NEW BUILD	



PROJECT: CELESTIAL PARK

ADDRESS: 5501 CELESTIAL RD
CITY, STATE: ADDISON, TEXAS

HORIZONTAL SCALE: 1" = 40'
VERTICAL SCALE: 1" = 10'

JOB NUMBER: DID - 1381192
DATE: 05-08-2017

