



FOR ADDISON USE ONLY
 Permit Number: W-1211
 Location: 16321 Addison Rd

APPLICATION

Right of Way Work Permit - PUBLIC UTILITY/CTP

(For Public Utility/CTP - Street Cut/Excavation/Lane Closure)

PLEASE PRINT LEGIBLY

Date of application: 8-22-17

Facility Owner Company: Charter Spectrum Company Phone #: _____
 Utility/CTP Representative: Kevin Causey Cell Phone #: _____
 General Contractor: Bridgepoint Communications Company Phone #: _____
 Site Supervisor Name: Joe Hirsch 24 hour phone #: 817-657-4448
 Work Site Address and Location: 16321 Addison Rd
 Purpose and general description of work: placing new service by underground bore.
 Proposed Start Work Date: 8-28-17 Estimated Completion Date: 9-28-17
 Pavement Cut? Yes No Directional Bore/Boring? Yes No
 Excavation? Yes No Lane Closure? Yes No Other: _____? Yes No
Chris Hill Applicant's Printed Name Chris Hill Signature Construction Supervisor Position with Company
 Applicant's Email: bpdallos@gmail.com Applicant's Phone Number: 469-643-6859
Steve Hill Direct Supervisor's Printed Name _____ Phone Number _____ Bridgepoint Communications Company Name

FOR ADDISON USE ONLY

Received By: Nicole S. Entered? Yes No Received Date: 8-22-17
 Approved By: Dave Wilde Inspector: JE Issue Date: 8/25/17
 Plans Submitted? Yes No N/A Traffic Control Plan Submitted? Yes No N/A Expiration Date: 9/11/17
 Insurance Provided? Yes No On File Performance/Maintenance Bond? Yes No On File N/A
 Fee Paid: NA Receipt#: LTP Date: 8-28-17 Processed By: Nicole S.
 Picked Up By: Mike Company: Bridgepoint Date & Time: 8-28-17 11:16AM

TOWN OF ADDISON INFRASTRUCTURE AND DEVELOPMENT SERVICES
 DEPARTMENT ATTN: RIGHT OF WAY PERMIT - DAVE WILDE 972-450-2847
 16801 WESTGROVE RD. ADDISON, TX 75001-9010
 PHONE: 972-450-2871 FAX: 972-450-2837

Spectrum

DFW AERO MECHANIX INC.
16321 ADDISON RD
ADDISON, TEXAS

VICINITY MAP

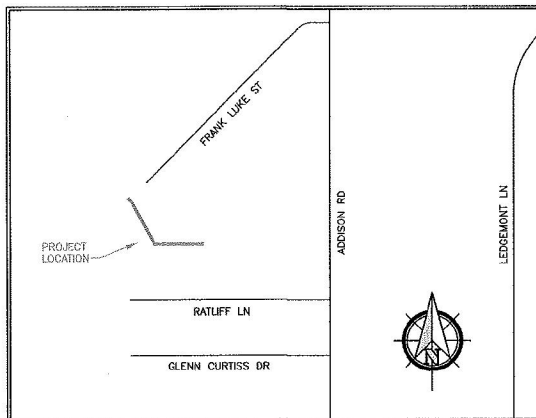

GENERAL PROJECT NOTES

1. ALL CONSTRUCTION WORK WITHIN THE PUBLIC RIGHT-OF-WAY SHALL BE DONE IN ACCORDANCE WITH THE ORDINANCES AND REGULATIONS OF THE MUNICIPALITY IN WHICH THE WORK IS TO BE PERFORMED.
2. EXISTING UTILITY LOCATIONS SHOWN ARE TAKEN FROM AVAILABLE RECORDS AND MAY NOT BE ALL INCLUSIVE. UTILITY LOCATIONS ARE GENERALLY SCHEMATIC IN NATURE AND MAY NOT ACCURATELY REFLECT THE SIZE AND LOCATION OF EACH PARTICULAR UTILITY. THE CONSTRUCTION CONTRACTOR SHALL ASSUME RESPONSIBILITY FOR ACTUAL LINE LOCATES IN THE FIELD AND THE PROTECTION OF ALL EXISTING FACILITIES WHETHER SHOWN OR NOT. THE CONSTRUCTION CONTRACTOR SHALL ALSO ASSUME RESPONSIBILITY FOR REPAIRS TO ANY EXISTING FACILITY DAMAGED AS A DIRECT RESULT OF THE CONSTRUCTION ACTIVITIES WHETHER THE FACILITY IS SHOWN ON THE DRAWINGS OR NOT.
3. THE CONSTRUCTION CONTRACTOR SHALL BE RESPONSIBLE FOR CONTACTING ALL DEPARTMENTS WITHIN THE MUNICIPALITY AND THE UTILITY COMPANIES AT LEAST TWO WORKING DAYS PRIOR TO THE COMMENCEMENT OF WORK.

CALL BEFORE YOU DIG

811

IT'S THE LAW

4. IT SHALL BE THE RESPONSIBILITY OF THE CONSTRUCTION CONTRACTOR TO: A) PREVENT DAMAGE TO PRIVATE AND PUBLIC PROPERTY. B) RESTORE ALL AREAS EFFECTED BY THE CONSTRUCTION TO ORIGINAL OR BETTER CONDITION.
5. BARRICADING AND TRAFFIC CONTROL SHALL BE THE RESPONSIBILITY OF THE CONSTRUCTION CONTRACTOR AND SHALL CONFORM TO THE "TEXAS MANUAL ON UNIFORM TRAFFIC CONTROL DEVICES". TRAFFIC FLOW AND ACCESS SHALL BE MAINTAINED DURING ALL PHASES OF CONSTRUCTION. THE CONSTRUCTION CONTRACTOR IS RESPONSIBLE FOR PROVIDING TRAFFIC SAFETY MEASURES FOR WORK ON THE PROJECT. THE WORK SITE SHALL BE SUITABLY LIT AND BARRICADED AT NIGHT.
6. THE CONSTRUCTION CONTRACTOR SHALL ABIDE BY ALL APPLICABLE FEDERAL, STATE AND LOCAL LAWS GOVERNING EXCAVATION. THE CONSTRUCTION CONTRACTOR SHALL PROVIDE ALL TRENCH SAFETY SYSTEMS THAT COMPLY WITH ALL LAWS GOVERNING EXCAVATION. THE CONSTRUCTION CONTRACTOR SHALL BE SOLELY RESPONSIBLE FOR ALL ASPECTS OF WORK RELATED TO EXCAVATION.
7. ALL CONCRETE USED IN ANY ROADWAY SHALL BE IN COMPLIANCE WITH THE SPECIFIED CLASSES OF CONCRETE IN THE STANDARD SPECIFICATIONS 5.8 "PORTLAND CEMENT CONCRETE PAVEMENT" AND 7.4.5 "QUALITY OF CONCRETE" AS AMENDED BY THE ADDENDUM TO THE NORTH CENTRAL TEXAS STANDARD SPECIFICATIONS FOR PUBLIC WORKS CONSTRUCTION -- 2004. ALL OTHER CONCRETE SHALL BE CLASS A CONCRETE.
8. ALL REINFORCING STEEL AND DOWEL BARS IN PAVEMENT SHALL BE SUPPORTED AND MAINTAINED AT THE CORRECT CLEARANCES BY THE USE OF BAR CHAINS OR OTHER APPROVED SUPPORT.
9. ALL CONDUIT MUST BE PLACED WITH A MINIMUM 42" OF COVER, UNLESS OTHERWISE SPECIFIED.
10. ALL BACKFILLING WILL BE MECHANICALLY TAMPED IN LIFTS TO A DENSITY OF 95% PROCTOR. THE REQUIRED DENSITY WILL BE OBTAINED BY USING TAMPERS, RAMMERS OR ROLLING EQUIPMENT. LIFTS MAY VARY ACCORDING TO THE TYPE OF EQUIPMENT USED TO OBTAIN THE REQUIRED DENSITY. SAND AND DEBRIS FREE MATERIAL WILL BE USED FOR BACKFILL.

DFWT CONTACT: DAVID HATTON 972.670.2113

PREPARED BY: DFW TELECOM, INC.

NAME: DFW Aero Mechanix Inc
 ADDRESS: 16321 Addison Rd Ste 150 Addison, TX 75001
 LOB: COAX COMMERCIAL NEW BUILD
 TYPE: STANDARD COAX
 DOCKID: 1505261
 CONST#: 831402
 SITE SURVEY#: 3029415
 POC: Juan Oviedo/(972) 250-2403/joviedo@dfwaero.com
 NODE/HUB: 1K02BB/1KA
 MAP: 3060-3369
 OU: NTX
 REC'D DATE: 7/29/2017
 WALKED BY: JM

BLE--1000	6	14	12
1K02BBB2C	21.5	22.4	2
	48	43.3	36
1K02F	1	82	

AFTER
 SOW
 * FROM ROW EXTEND COAX 268' UG TO BUILDING
 * INSTALL PEDESTAL

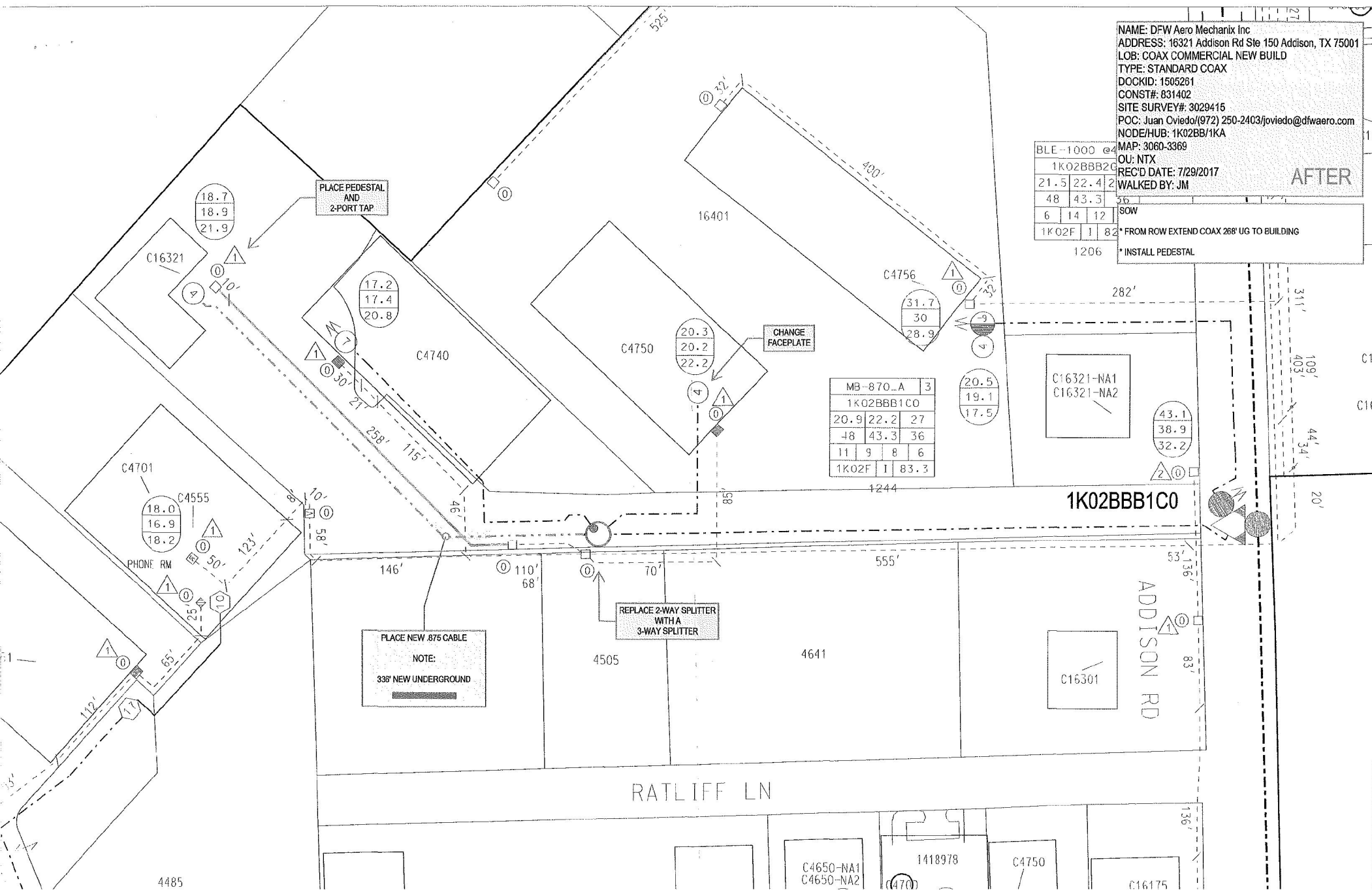

MB-870_A	3
1K02BBB1C0	20.9 22.2 27
	48 43.3 36
	11 9 8 6
1K02F	1 83.3

PLACE NEW .875 CABLE
 NOTE:
 338' NEW UNDERGROUND

REPLACE 2-WAY SPLITTER
 WITH A
 3-WAY SPLITTER