



**FOR ADDISON USE ONLY**  
 Permit Number: W-1283  
 Location: 4200 Sojourn

**APPLICATION**  
**Right of Way Work Permit-FRANCHISE**

(For Franchise Utility/CTP – Street Cut/Excavation/Lane Closure)

**PLEASE PRINT LEGIBLY**

Date of Application: 11-29-2017  
 Facility Owner Company: Spectrum Company Phone #: 214-320-7576  
 Utility/CTP Representative: Patrick Sauls Cell Phone #: 214-422-1537  
 Utility/CTP Representative E-mail: patrick.sauls@charter.com  
 General Contractor: Bridge Point Company Phone #: 972-670-2050  
 Site Supervisor Name: Steve Holt 24-hour Phone #: 972-670-2050  
 Contractor E-mail: Steve.Holt@bridgepoint.com Site Foreman E-mail: " "  
 Work Site Address and Location: Sojourn Dr.

Purpose and general description of work: Directional Boring  
 Proposed Start Work Date: 12-4-2017 Estimated Completion Date: 02-04-2018

Pavement Cut?  Yes  No Directional Bore/Boring?  Yes  No Excavation?  Yes  No  
 Lane Closure?  Yes  No Other: \_\_\_\_\_

Applicant's Printed Name: David Williams Signature: [Signature] Position with Company: Field Tech  
 Applicant's E-mail: perichol.kidderbeck@kiericonsulting.com Applicant's Phone #: 214-773-6918  
 Direct Supervisor's Name: Patrick Sauls Phone Number: 214-422-1537 Company Name: Spectrum  
 Supervisor's E-mail: Patrick.sauls@charter.com

**FOR ADDISON USE ONLY**

Received By: [Signature] Entered?  Yes  No Received Date: 11-29-17  
 Approved By: [Signature] Inspector: JC Issue Date: 12/5/17  
 Plans Submitted?  Yes  No  N/A Traffic Control Plan submitted?  Yes  No  N/A Expiration Date: 12/19/17  
 Insurance Provided?  Yes  No  On File Performance/Maintenance Bond?  Yes  No  On File  N/A  
 Fee Paid: N/A Receipt #: CTP Processed By: Mella Simpson  
 Picked Up By: John Company: bridgepoint Date & Time: 12-5-17

TOWN OF ADDISON INFRASTRUCTURE AND DEVELOPMENT SERVICES DEPARTMENT  
 ATTN.: RIGHT OF WAY PERMIT - DAVE WILDE 972-450-2847  
 16801 WESTGROVE RD. ADDISON, TX 75001-9010  
 PHONE: 972-450-2871 FAX: 972-450-2837



<b>FOR ADDISON USE ONLY</b>	
Permit Number:	<u>W-1283</u>
Location:	<u>4200 Sgiewon</u>

**APPLICATION**  
**Right of Way Work Permit -FRANCHISE**  
 (For Franchise Utility/CTP - Street Cut/Excavation/Lane Closure)

**Sub-Contractor List**

**PLEASE PRINT LEGIBLY**

General Contractor's Name: Bridge Point General Contractor's Phone #: 972-670-2050

**Sub-Contractor #1** Company Name: \_\_\_\_\_ Address: \_\_\_\_\_

Print Sub-Contractor's Name: \_\_\_\_\_ Sub-Contractor Phone #: \_\_\_\_\_

Sub-Contractor's E-mail: \_\_\_\_\_

Print Site Supervisor's Name: \_\_\_\_\_ Supervisor's Phone #: \_\_\_\_\_

Site Supervisor's E-mail: \_\_\_\_\_

Insurance Provided?  Yes  No  On File

**Sub-Contractor #2** Company Name: \_\_\_\_\_ Address: \_\_\_\_\_

Print Sub-Contractor's Name: \_\_\_\_\_ Sub-Contractor Phone #: \_\_\_\_\_

Sub-Contractor's E-mail: \_\_\_\_\_

Print Supervisor's Name: \_\_\_\_\_ Supervisor's Phone #: \_\_\_\_\_

Site Supervisor's E-mail: \_\_\_\_\_

Insurance Provided?  Yes  No  On File

**Sub-Contractor #3** Company Name: \_\_\_\_\_ Address: \_\_\_\_\_

Print Sub-Contractor's Name: \_\_\_\_\_ Sub-Contractor Phone #: \_\_\_\_\_

Sub-Contractor's E-mail: \_\_\_\_\_

Print Supervisor's Name: \_\_\_\_\_ Supervisor's Phone #: \_\_\_\_\_

Site Supervisor's E-mail: \_\_\_\_\_

Insurance Provided?  Yes  No  On File

RIGHT OF WAY, EXCAVATION &  
LANE CLOSURE PERMIT

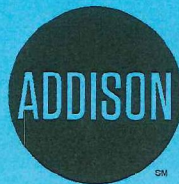

INFRASTRUCTURE &  
DEVELOPMENT SERVICES

16801 WESTGROVE DRIVE  
ADDISON, TEXAS 75001  
972.450.2871

**W-1283**

PERMIT NUMBER

**12/05/17**

START DATE

**2/04/18**

EST. COMPLETION DATE

**BRIDGEPOINT SPECTRUM**

CONTRACTOR

FOR

**4200 SOJOURN DR**

LOCATION (ADDRESS)

**FROM SOUTH ROW CROSSING STREET TO NORTH**

LOCATION (ACTUAL)

**RELOCATE AERIAL CABLE TO UNDERGROUND**

TYPE OF WORK

THIS CARD MUST BE DISPLAYED ON THE JOB SITE AT ALL TIMES.



Google earth

200 ft



RAKE OFF	QTY	RAKE OFF	QTY	RAKE OFF	QTY
TRENCH & PLACE CONDUIT		PULL THRU EXSITING CONDUIT		R & R CONCRETE SIDEWALK	
BORE & PLACE CONDUIT	271'	PLACE 3'X5'X3' HH		R & R CONCRETE PAVEMENT	
DIRECTIONAL BORE		PLACE 4'X4'X4' MH		R & R ASPHALT PAVEMENT	
BORE & PLACE 4" PVC	161'	PLACE VAULT		AERIAL NEWBUILD	
BORE & PLACE 4" SCHED 80 PVC		PLACE PED		AERIAL OVERLASH	276'

**PERMIT FOR RELOCATION**  
**DID1507456**  
**MAINT. SOJOURN DR RELO**  
**SOJOURN DR, ADDISON, TX 75001**



**KINETIC SOLUTIONS LLC.**  
**1585 JAMESON RD.**  
**VAN ALSTYNE TX. 75495**  
**888-519-9188**



**PERMIT FOR RELOCATION**

DID1507456  
 MAINT\_SOJOURN DR RELO  
 SOJOURN DR, ADDISON, TX 75001

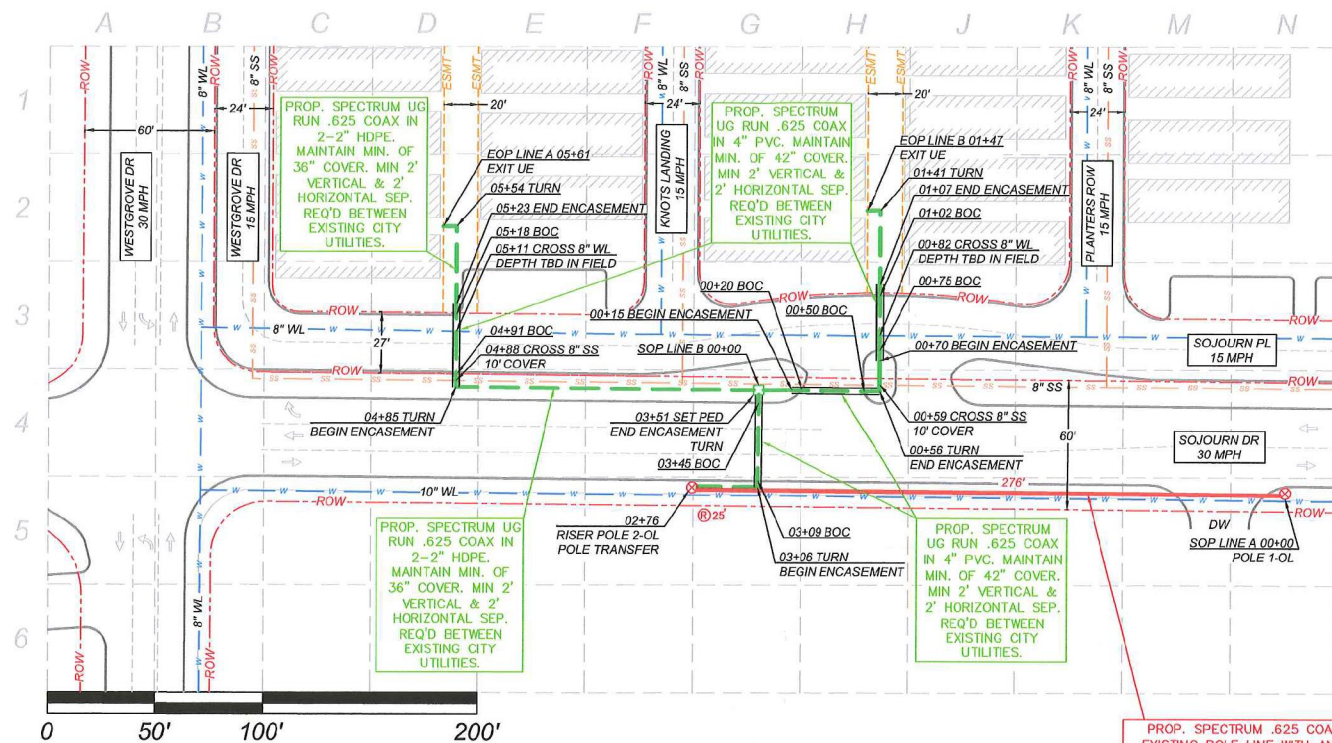

PROP. SPECTRUM .625 COAX OL ON EXISTING POLE LINE WITH AN 18" MIN. CLEARANCE TO BE MAINTAINED. POLES ARE TYP. 1' TO 3' INSIDE ROW

UG PROFILES LOCATED ON PG 2

**\*NOTE\***  
 FOR PERMIT PURPOSES ONLY.  
 DRAWINGS BASED ON RECORDS.  
 CALL FOR UTILITY LOCATES  
 PRIOR TO DIGGING.

LEGEND		LINE TYPES		REVISIONS			
—X—	EXISTING ANCHOR	—A—	AERIAL	NO.	CHANGES	DATE	BY
—X—	NEW ANCHOR	—U—	UNDERGROUND	1.)			
—X—	SIDEWALK GUY	—G—	U-GAS	2.)			
—X—	NEW SIDEWALK GUY	—S—	SAN. SWR	3.)			
—X—	POLE TO POLE GUY	—W—	STM. SWR	4.)			
—X—	OVERHEAD GUY	—W—	WATER	5.)			
—X—		—E—	ROW EASEMENT	6.)			
—X—		—S—	SIDEWALK	7.)			
—X—		—F—	FENCE	8.)			
—X—		—T—	TREE	9.)			
—X—		—SH—	SHRUB	10.)			

RAKE OFF	QTY	RAKE OFF	QTY	RAKE OFF	QTY
TRENCH & PLACE CONDUIT		PULL THRU EXISTING CONDUIT		R & R CONCRETE SIDEWALK	
BORE & PLACE CONDUIT	271'	PLACE 3'X5'X3' HH		R & R CONCRETE PAVEMENT	
DIRECTIONAL BORE		PLACE 4'X4'X4' MH		R & R ASPHALT PAVEMENT	
BORE & PLACE 4" PVC	161'	PLACE VAULT		AERIAL NEWBUILD	
BORE & PLACE 4" SCHED 80 PVC		PLACE PED		AERIAL OVERLASH	276'



CITY: ADDISON  
 COUNTY: DALLAS  
 STATE: TEXAS  
 DATE DRAFTED: 11/03/2017  
 1 OF 2  
**DISCLAIMER**

INFORMATION IN THIS DOCUMENT IS PROPRIETARY AND SHALL NOT BE USED, REPRODUCED, COPIED OR DISCLOSED IN WHOLE OR IN PART WITHOUT WRITTEN CONSENT FROM KINETIC SOLUTIONS LLC.  
 KINETIC SOLUTIONS LLC.  
 1585 JAMESON RD.  
 VAN ALSTYNE, TX 75495  
 888-519-9188